

PALMDALE BLDG. DIST. NO. 8.1

PROFILE ALIGNMENT AND GRADE OF P.C. 4588
 SANITARY SEWERS PAGE 1

TO BE CONSTRUCTED IN
**CAROLSIDE AVE.
 HOUSE LATERALS ONLY**
 PRIVATE CONTRACT NO. 4588

W.S. 65
 1 SHEETS, 2 PAGES

SCALE: VERT. 1" = 4'
 HORIZ. 1" = 40'
 OCTOBER, 1957

PREPARED IN THE OFFICES OF
R.L. STUCKEY CO., INC.

REG. C.E. NO. 5067
 FOR LEGEND SEE PLAN NO. S-A-64

- NOTES
- PROVIDE STAKES ON THE PROPERTY LINE OR PROPERTY LINES PRODUCED AT RIGHT ANGLES TO THE SEWER LINE AT THE CENTER LINE OF EACH MANHOLE.
 - NO REPRESENTATIVE OF THE COUNTY ENGINEER WILL SURVEY OR LAYOUT ANY PORTION OF THE WORK.
 - THE OWNER OR HIS AUTHORIZED REPRESENTATIVE SHALL FURNISH THE COUNTY ENGINEER WITH GRADE SHEETS AND STATIONING FOR ALL HOUSE LATERALS AND V BRANCHES AND SHALL PROVIDE STAKES FOR THEM AT THEIR PROPER LOCATIONS WITH STATIONING PLAINLY MARKED. ANY CHANGE IN LOCATION SHALL BE REQUESTED IN WRITING BY THE OWNER OR HIS REPRESENTATIVE.
 - NO REVISIONS SHALL BE MADE IN THESE PLANS WITHOUT THE APPROVAL OF THE COUNTY ENGINEER.
 - USE STANDARD MANHOLES, FRAMES AND COVERS, S.A.-64, S.A.-65, S.A.-66, S.A.-67.
 - USE STANDARD STRENGTH PIPE EXCEPT AS NOTED.
 - USE CEMENT MORTAR FOR ALL VITRIFIED CLAY PIPE JOINTS.
 - RESURFACE ALL TRENCH WITHIN PAVED AREA TO MEET L. A. COUNTY ROAD DEPT. OR CALIF. STATE HIGHWAY DEPT. SPECIFICATIONS IN ACCORDANCE WITH PERMITS.
 - ENCASE FOUR FEET OF SEWER AT POINTS OF INTERFERENCE WITH POLES, S.A.-119.
 - HOUSE LATERALS TO BE CONSTRUCTED WITH INVERTS AT PROPERTY LINE 6 INCHES BELOW CURB GRADE EXCEPT AS NOTED.
 - UNDESIRABLE GRADE TO BE CHANGED TO CONFORM WITH THE SPECIFICATIONS OF THE COUNTY ENGINEER.
 - FOR ALLOWABLE LEAKAGE TEST USE FORMULA NO. 1 SPEC. SEC. 14.
 - UNDESIRABLE POLES TO BE REMOVED OR CUT OFF TO CLEAR THE SEWER LINE TO THE PROPERTY LINE.
 - The Contractor is to notify Construction & Storm Drain Division by telephone Whitehall 28807 Ext 40 at least 24 hours before starting any work under this contract.
 - ALL ALL PIPE JOINTS WITH CEMENT MORTAR THAT ARE WITHIN 20' OF ALL PROPERTY LINES.
 - THE PRIVATE ENGINEER SHALL FURNISH THE HOUSE LATERAL DEPTH OF THE PROPERTY LINE BELOW THE TOP OF CURB ELEVATION FOR EACH HOUSE LATERAL ON THE GRADE SHEET.

B.M. U.S. 3187 6-426 El. 2636.369 0.6 mi. N. along the S.Pac. Co. R.R. from the station @ Palmdale Los Angeles Co., 3 1/4 miles (about 49 yds) S of milepost 43, about 85 yds N of rd. crossing 4131, 43' N of 1/2 of tracks, 60' E of U.S. Hwy 6 & 35' N of a pole, std. disk stamped 6-426, 1935, set in top of concrete post.

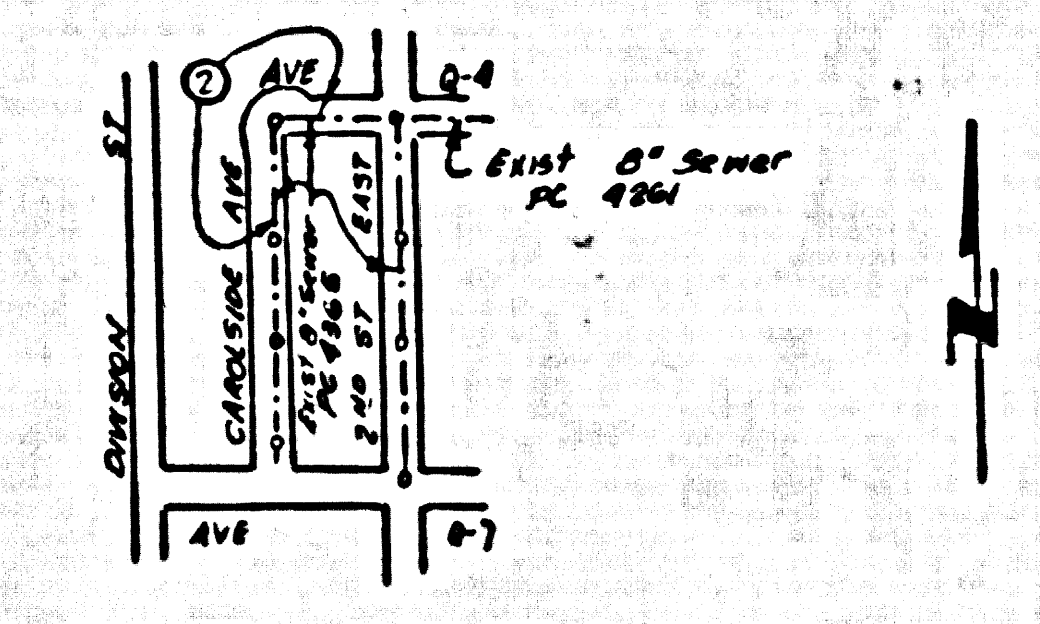

INDEX MAP
 Scale: 1" = 600'
 P.C. 4588

NO CHARGE FOR CONNECTIONS
 Money Order 10-11-57

NOTE: GRADES TO WHICH THIS IMPROVEMENT IS TO BE CONSTRUCTED ARE SHOWN ON PLANS AND PROFILE GRADE POINTS FOR TOP OF CURB, CENTER LINE OF STREET, OR CENTER LINE OF ALLEY ARE SHOWN BY CIRCLES ON PROFILES AT ALL POINTS BETWEEN DESIGNATED POINTS THE GRADE SHALL BE ESTABLISHED SO AS TO CONFORM TO A STRAIGHT LINE DRAWN BETWEEN SAID DESIGNATED POINTS.

ELEVATIONS ARE IN FEET ABOVE U.S.C. & G.S. SEA LEVEL DATUM OF 1929.

THIS DRAWING AND THE DATA HEREON ARE HEREBY MADE A PART OF THE SPECIFICATIONS.

BEFORE WORK CAN BE STARTED, THE CONTRACTOR MUST OBTAIN A PERMIT TO EXCAVATE IN COUNTY STREETS FROM THE L. A. COUNTY ROAD DEPT., 108 W. 5TH ST. AND MAKE A DEPOSIT WITH THE COUNTY ENGINEER, ROOM 324 PAN AMERICAN BUILDING, 222 SO. BROADWAY, SUFFICIENT TO COVER THE COST OF CONSTRUCTION INSPECTION AND RECORD PLANS.

APPROVAL OF THIS PLAN BY THE COUNTY OF LOS ANGELES DOES NOT CONSTITUTE A REPRESENTATION AS TO THE ACCURACY OF THE LOCATION OF OR THE EXISTENCE OR NON-EXISTENCE OF ANY UNDERGROUND UTILITY PIPE, OR STRUCTURE WITHIN THE LIMITS OF THIS PROJECT THIS NOTE APPLIES TO ALL PAGES.

WORK TO BE DONE IN A STATE HIGHWAY, A PERMIT MUST BE OBTAINED FROM THE STATE OF CALIFORNIA, DIVISION OF HIGHWAYS, 120 SOUTH SPRING STREET.

COUNTY OF LOS ANGELES, CALIFORNIA

APPROVED, JOHN A. LAMME, COUNTY ENGINEER

BY *[Signature]*
 Assistant Engineer

CHECKED BY *[Signature]* 10-14-57
 OFFICE OF COUNTY ENGINEER, 100 S. E. NO. 7860

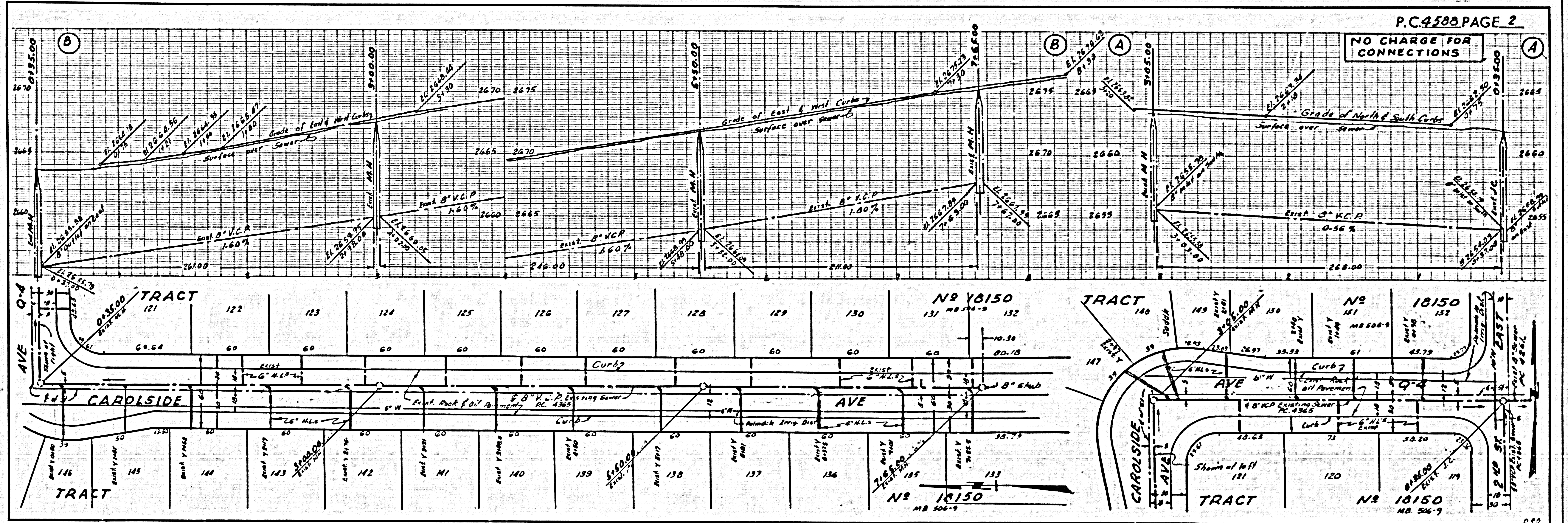

P.C. 4588 PAGE 2

NO CHARGE FOR CONNECTIONS