

B.M. YF 58 F.B. 2137 pg 23 Elev. 38.85G
 226th Ave. (E. Side) 60' N. of E. 226th St. (Pvt. St.)
 8" spk. in N. side of P.P. No. 1000295 E.

LOMITA BLDG. DIST. NO. 7.1

PROFILE ALIGNMENT AND GRADE OF **P.C. 4605**
SANITARY SEWERS PAGE **1**
 TO BE CONSTRUCTED IN

226TH STREET (Private St.) **25,560**

PRIVATE CONTRACT NO. 4605

W.S. 28

1 SHEET, 2 PAGES

SCALE: VERT. 1" = 4' HORIZ. 1" = 40' **OCTOBER, 1957**

PREPARED IN THE OFFICES OF

HARRY GILBERT

REG. C. E. NO. 1227

FOR LEGEND SEE PLAN NO. S-A-64

- NOTE:**
- PROVIDE STAKES ON THE PROPERTY LINE OR PROPERTY LINES PRODUCED AT 90° ANGLES TO THE SEWER LINE AT THE CENTER LINE OF EACH MANHOLE.
 - NO REPRESENTATIVE OF THE COUNTY ENGINEER WILL SURVEY OR LAY OUT ANY PORTION OF THE WORK.
 - THE OWNER OR HIS AUTHORIZED REPRESENTATIVE SHALL FURNISH THE COUNTY ENGINEER WITH GRADE SHEETS AND STATION FOR ALL HOUSE LATERALS AND IF BRANCHES AND SHALL PROVIDE STAKES FOR THEM AT THEIR PROPER LOCATIONS WITH STATION AND PLAINLY MARKED. ANY CHANGE IN LOCATION SHALL BE REQUESTED IN WRITING BY THE OWNER OR HIS REPRESENTATIVE.
 - NO ADJUSTMENTS SHALL BE MADE IN THESE PLANS WITHOUT THE APPROVAL OF THE COUNTY ENGINEER.
 - USE STANDARD MANHOLE FRAMES AND COVERS, S.A. 117, 18" DIA. 45" HIGH.
 - USE STANDARD STRENGTH FIVE-SEVEN-FOUR JOINTS.
 - SET CEMENT SIGHTS FOR ALL VENTED CLAY PIPE JOINTS.
 - RESURFACE ALL TRENCH WITHIN PAVED AREA TO MEET L. A. COUNTY ROAD DEPT. OR CALIF. STATE HIGHWAY DEPT. SPECIFICATIONS IN ACCORDANCE WITH PERMITS.
 - INDICATE FOUR FEET OF SEWER AT POINTS OF INTERFERENCE WITH POLES, S.A. 119.
 - SEWER LATERALS SHALL BE CONSTRUCTED WITHIN 10 FEET OF PROPERTY LINE UNLESS OTHERWISE SPECIFIED.
 - ALL STRUCTURES SHALL BE BRICK SEWER STRUCTURES, S.A. 104, 48" DIA. 48" HIGH.
 - FOR ALLOWABLE SEWAGE TEST USE FORMULA NO. 1, S.P.C.T., SEC. 54.
 - MANHOLE TOPS IN IMPROVED RIGHTS-OF-WAY TO BE 6" ABOVE FINISHED GRADE.

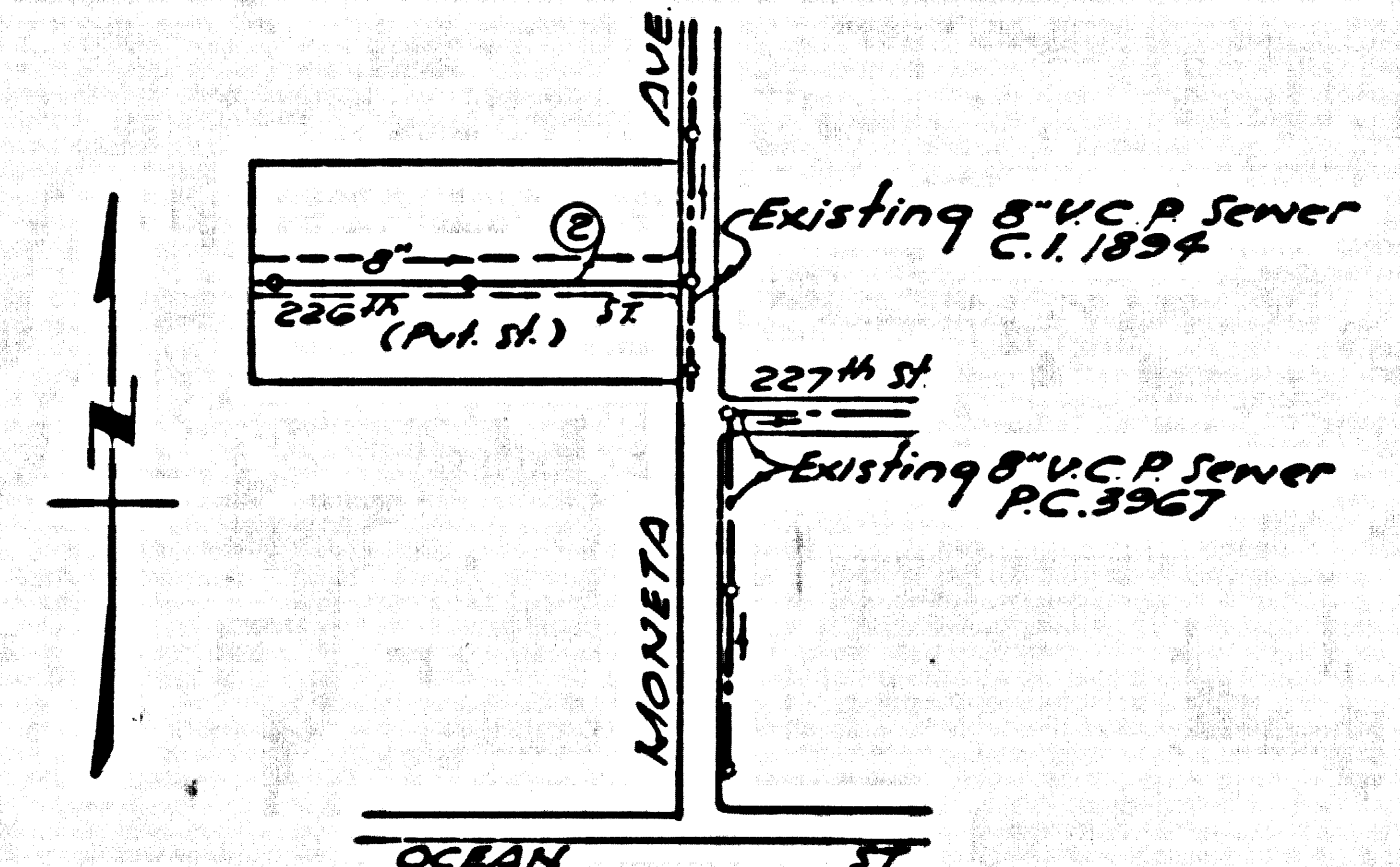

Note: Figure in circle indicates page number.

INDEX MAP
 226th STREET (Pvt. St.)
 P.C. - 4605
 SCALE: 1" = 400'

NO CHARGE FOR CONNECTIONS
 December 12-20-57

NOTE:
 GRADES TO WHICH THIS IMPROVEMENT IS TO BE CONSTRUCTED ARE SHOWN ON PLANS AND PROFILE. GRADE POINTS FOR TOP OF CURB, CENTER LINE OF STREET, OR CENTER LINE OF ALLEYS ARE SHOWN BY CIRCLES ON PROFILE. AT ALL POINTS BETWEEN DESIGNATED POINTS THE GRADE SHALL BE ESTABLISHED SO AS TO CONFORM TO A STRAIGHT LINE DRAWN BETWEEN SAID DESIGNATED POINTS.
 ELEVATIONS ARE IN FEET ABOVE U.S.C. & G.S. 1929. DATUM OF 1929.
 THIS DRAWING AND THE DATA HEREON ARE HEREBY MADE A PART OF THE SPECIFICATIONS.
 WORK SHALL BE CONSTRUCTED ACCORDING TO SPECIFICATIONS ON FILE IN THE OFFICE OF THE COUNTY ENGINEER AND SHALL BE PRODUCED ONLY BY THE PRESENCE OF THE COUNTY ENGINEER.
 BEFORE WORK CAN BE STARTED, THE CONTRACTOR MUST OBTAIN A PERMIT TO EXCAVATE IN COUNTY STREETS FROM THE L. A. COUNTY ROAD DEPT. AND MAKE A DEPOSIT WITH THE COUNTY ENGINEER, ROOM 201 SAN JUAN AVENUE, SAN FRANCISCO, CALIF. \$15.00. ROADWAY SURVEY TO COVER THE COST OF CONSTRUCTION INSPECTION AND ACCESS PLANS.
 APPROVAL OF THIS PLAN BY THE COUNTY OF LOS ANGELES DOES NOT CONSTITUTE A REPRESENTATION AS TO THE ACCURACY OF THE LOCATION OR THE EXISTENCE OR NON-EXISTENCE OF ANY UNDERGROUND UTILITY PIPE, OR STRUCTURE WITHIN THE LIMITS OF THIS PROJECT. THIS NOTE APPLIES TO ALL PAGES.
 IF WORK IS TO BE DONE IN A STATE HIGHWAY, A PERMIT MUST BE OBTAINED FROM THE STATE OF CALIFORNIA, DIVISION OF HIGHWAYS, 120 SOUTH SPRING STREET.

COUNTY OF LOS ANGELES, CALIFORNIA
 APPROVED, JOHN A. LAMBE, COUNTY ENGINEER
 APPROVED, A. M. BAWN, CHIEF ENGINEER
 BY *[Signature]* BY *[Signature]*
 SANITATION ENGINEER OFFICE ENGINEER
 CHECKED BY *[Signature]*
 OFFICE OF COUNTY ENGINEER, BLDG. C. E. NO. 2637

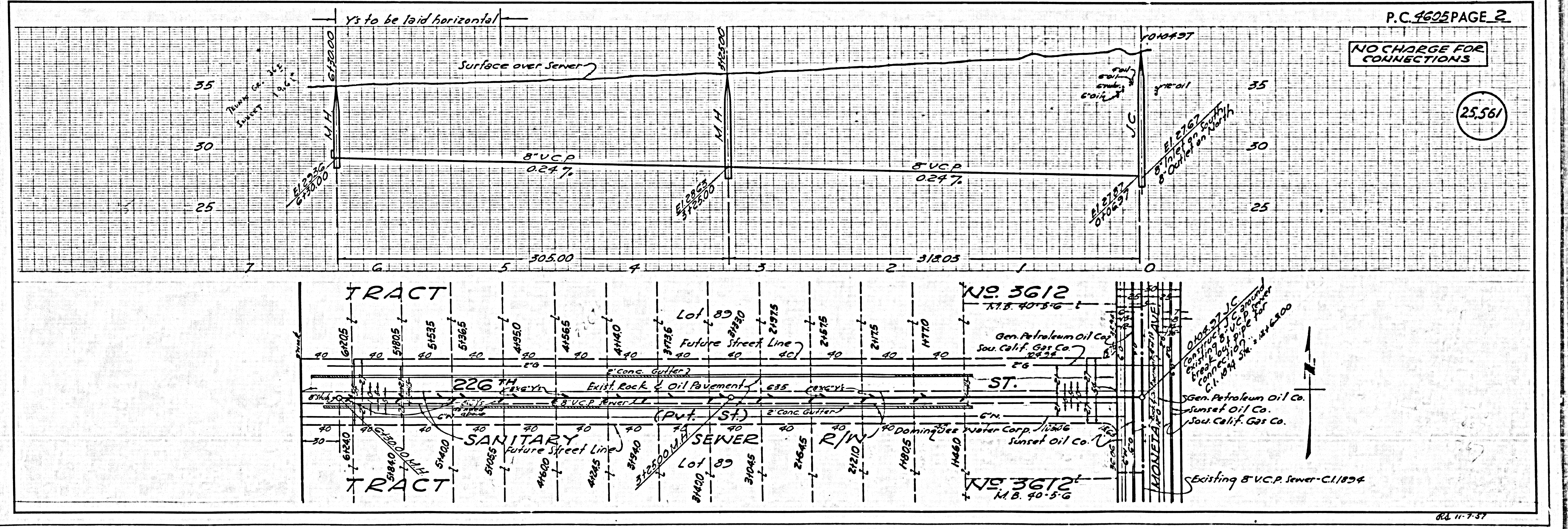

P.C. 4605 PAGE 2

NO CHARGE FOR CONNECTIONS

25,561

255 252