

LENNOX BLDG. DIST. NO. 7

PROFILE ALIGNMENT AND GRADE OF P.C. 4623
SANITARY SEWERS PAGE 1

TO BE CONSTRUCTED IN

REYES AVENUE

RANCHO SAN PEDRO INDUSTRIAL AREA
PRIVATE CONTRACT NO. 4623

W.S. 30

2 SHEETS, 3 PAGES

SCALE: VERT. 1" = 4' NOV. 1959

28,878

PREPARED IN THE OFFICES OF
QUINTON ENGINEERS, LTD.

By *H.W. Fanner*

REG. C. E. NO. 6422

FOR LEGEND SEE PLAN NO. S-A-64

BENCH MARK - LOS ANGELES COUNTY
ROAD DEPARTMENT. 5' x 3 1/2" x 1/2" QUAD
BRASS PLATE IN CONC. MONUMENT
2 1/2" DEEP, 50' W. OF E. OF SANTA FE. AVE.
AT N.C. 478+23.08
ADJ. 1951 ELEV. 48.768

ISSUE NO. CONNECTION PERMITS
UNTIL REYES AVE. IS DEDICATED

NO CHARGE FOR
CONNECTIONS
Arthur B. Ready

- NOTES:
- PROVIDE STAKES ON THE PROPERTY LINE OR PROPERTY LINES PRODUCED AT RIGHT ANGLES TO THE SEWER LINE AT THE CENTER LINE OF EACH MANHOLE.
 - NO REPRESENTATIVE OF THE COUNTY ENGINEER WILL SURVEY OR LAYOUT ANY PORTION OF THE WORK.
 - THE OWNER OR HIS AUTHORIZED REPRESENTATIVE SHALL FURNISH THE COUNTY ENGINEER WITH GRADE SHEETS AND STATION FOR ALL HOUSE LATERALS AND Y BRANCHES AND SHALL PROVIDE STAKES FOR THEM AT THEIR PROPER LOCATIONS WITH STATIONING AND PLAINLY MARKED. ANY CHANGE IN LOCATION SHALL BE INDICATED IN WRITING BY THE OWNER OR HIS REPRESENTATIVE. NO REVISIONS SHALL BE MADE IN THESE PLANS WITHOUT THE APPROVAL OF THE COUNTY ENGINEER.
 - USE STANDARD MANHOLE FRAMES AND COVERS, S-A-117, EXCEPT AS NOTED.
 - USE STANDARD STRENGTH PIPE EXCEPT AS NOTED.
 - USE CEMENT MORTAR FOR ALL VITRIFIED CLAY PIPE JOINTS.
 - RESURFACE ALL TRINCH WITHIN PAVED AREA TO MEET L.A. COUNTY ROAD DEPT., OR CALIF. STATE HIGHWAY DEPT. REQUIREMENTS IN ACCORDANCE WITH PERMITS.
 - REPLACE FOUR FEET OF SAWES AT POINTS OF INTERFERENCE WITH POLES, S-A-172, CASE III.
 - FOR ALLOWABLE LEAKAGE TEST USE FORMULA NO. 1 SPEC. SEC. 54.
 - ALL STRUCTURES SHALL BE BRICK SEWER STRUCTURES, S-A-104, EXCEPT AS NOTED.
 - THE CONTRACTOR SHALL NOTIFY THE CONSTRUCTION AND STORM DRAIN DIVISION BY TELEPHONE, MADISON 5-4747 EXT. 342, AT LEAST 24 HOURS BEFORE STARTING ANY WORK UNDER THIS CONTRACT.
 - CHECK EXISTING STUB ELEVATIONS PRIOR TO INITIATION OF CONSTRUCTION AND INFORM ENGINEER IMMEDIATELY OF RESULTS.
 - STANDARD SPECIFICATIONS DATED MAY 16, 1959 APPLY IN THE CONSTRUCTION OF THIS PROJECT.

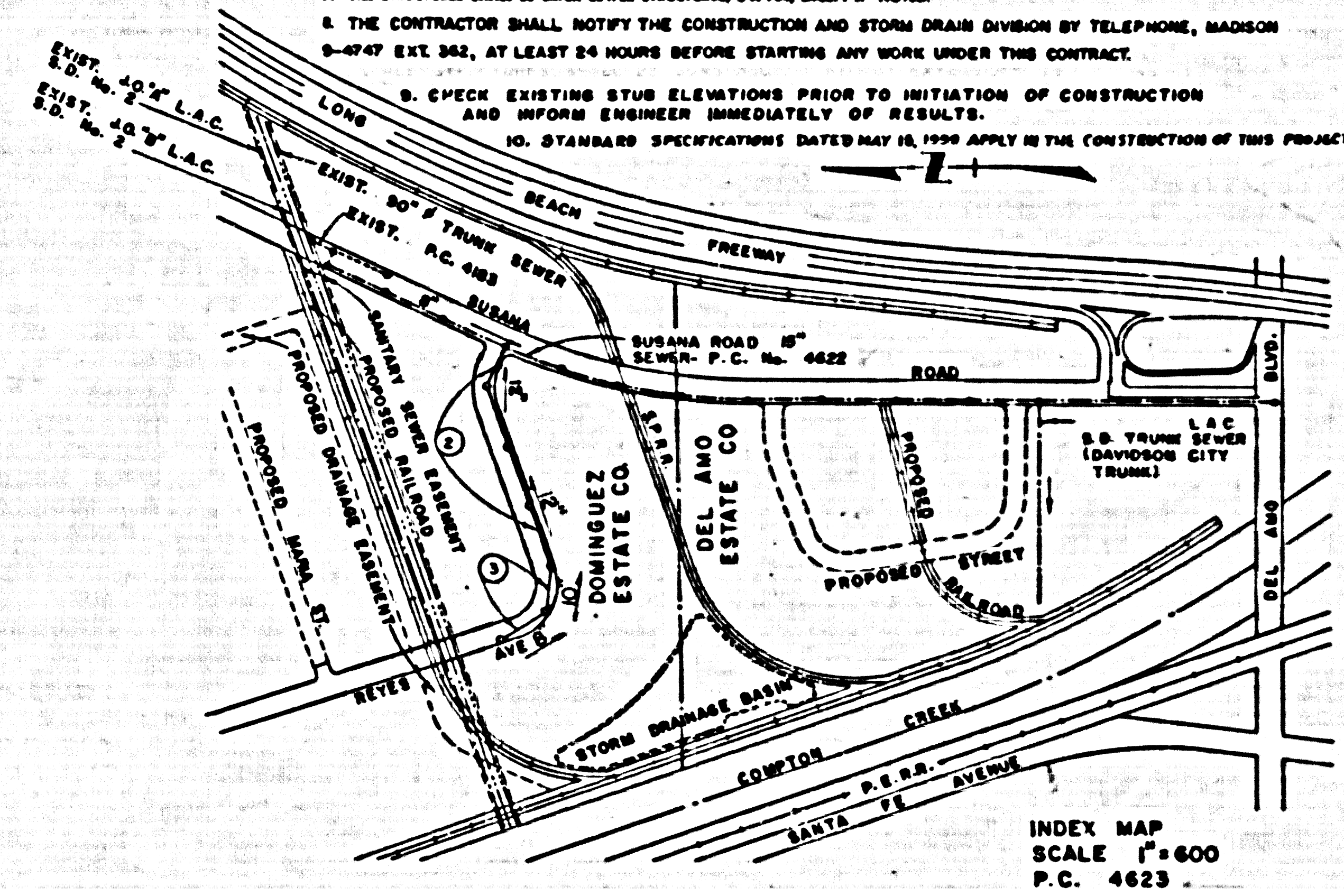

NOTE:
GRADES TO WHICH THE ELEVATIONS ARE TO BE CONSTRUCTED ARE SHOWN ON PLANS AND PROFILE GRADE POINTS FOR TOP OF CURBS, CENTER LINE OF STREETS, OR CENTER LINE OF ALLEYS ARE SHOWN BY CIRCLES ON PROFILES. AT ALL POINTS BETWEEN DESIGNATED POINTS THE GRADE SHALL BE ESTABLISHED SO AS TO CONFORM TO A STRAIGHT LINE DRAWN BETWEEN SAID DESIGNATED POINTS.
ELEVATIONS ARE IN FEET ABOVE M.S.L. S.E. SEA LEVEL, DATUM OF 1928.
THIS DRAWING AND THE DATA HEREON ARE HEREBY MADE A PART OF THE SPECIFICATIONS.
WORK SHALL BE CONSTRUCTED ACCORDING TO SPECIFICATIONS ON FILE IN THE OFFICE OF THE COUNTY ENGINEER AND SHALL BE PROCEEDED ONLY IN THE PRESENCE OF THE COUNTY ENGINEER.
BEFORE WORK CAN BE STARTED, THE CONTRACTOR MUST OBTAIN A PERMIT TO EXCAVATE IN COUNTY STREETS FROM THE L.A. COUNTY ROAD DEPT., DIST. OFFICE NO. 3 AND MAKE A REPORT WITH THE COUNTY ENGINEER, ROOM 124 PAM AMERICAN BLDG., 333 SO. BRADWAY, SUFFICIENT TO COVER THE COST OF CONSTRUCTION INSPECTION AND RECORD PLANS.
APPROVAL OF THIS PLAN BY THE COUNTY OF LOS ANGELES DOES NOT CONSTITUTE A REPRESENTATION AS TO THE ACCURACY OF THE LOCATION OF OR THE EXISTENCE OR NON-EXISTENCE OF ANY UNDERGROUND UTILITY PIPES OR STRUCTURES WITHIN THE LIMITS OF THE PROJECT. THIS NOTE APPLIES TO ALL PAGES.
IF WORK IS TO BE DONE IN A STATE HIGHWAY, A PERMIT MUST BE OBTAINED FROM THE STATE OF CALIFORNIA, DIVISION OF HIGHWAYS, 128 SOUTH SPRING STREET.

COUNTY OF LOS ANGELES, CALIFORNIA

APPROVED, JOHN A. LAMBE, COUNTY ENGINEER

APPROVED C. R. COMPTON, CHIEF ENGINEER

BY *C. E. Fanner* ASSISTANT SANITATION ENGINEER

CHECKED BY *S. G. Wade* 11-13-59 OFFICE OF COUNTY ENGINEER, REG. C. E. NO. 5486

APPROVED, INDUSTRIAL WASTE DIVISION
BY *Bernard Valasek* 11/14/59

INDEX MAP
SCALE 1" = 600
P.C. 4623

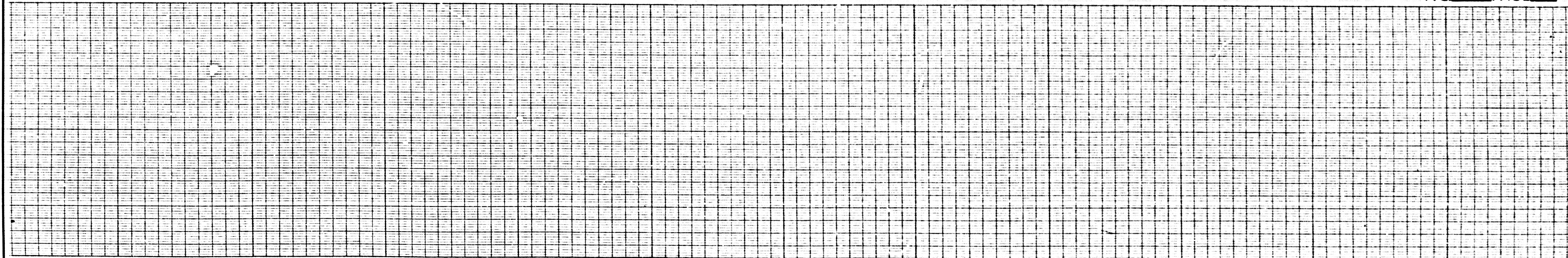

NO CHARGE FOR CONNECTIONS

28,879

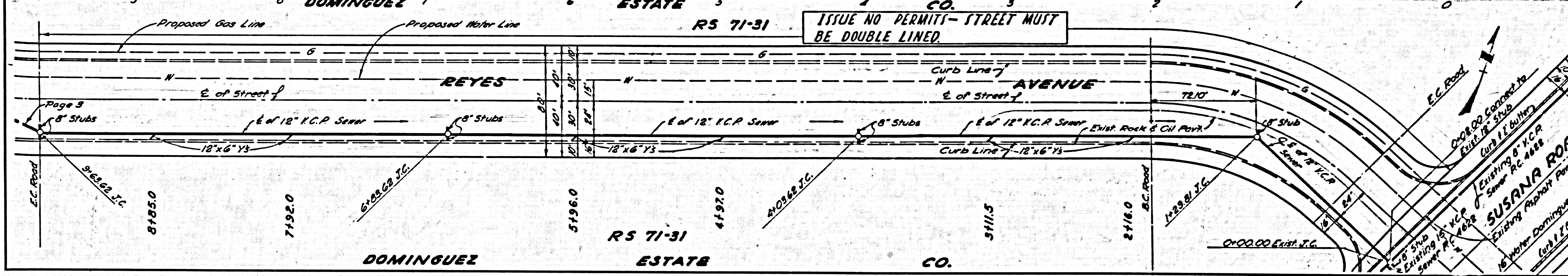
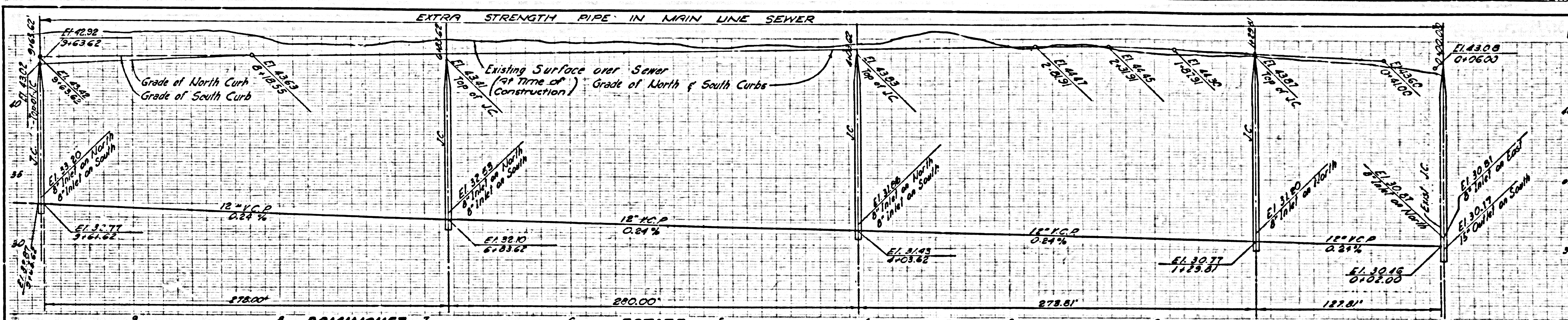

ISSUE NO PERMITS - STREET MUST BE DOUBLE LINED

NO CHARGE FOR CONNECTIONS

28,880

