

B.M. No 56792 Elev 507.555
 Duarte Rd and Muscatel Ave.
 Spk. in Conc. Cr. - 14" Dia. & Duarte Rd. E. W. & Muscatel Ave.

NOTE:
 THE CONTRACTOR SHALL NOTIFY THE CONSTRUCTION AND
 STORM DRAIN DIVISION BY TELEPHONE, MADISON 9-4777,
 EXT. 362, AT LEAST 24 HOURS BEFORE STARTING ANY
 WORK UNDER THIS CONTRACT.

CONNECTION CHARGES
 AS INDICATED

72.77 @ 100.00 = 7277.00

TEMPLE CITY BLDG. DIST. NO. 5

- NOTES:
- PROVIDE STAKES ON THE PROPERTY LINE OR PROPERTY LINES PRODUCED AT RIGHT ANGLES TO THE SEWER LINE AT THE CENTER LINE OF EACH MANHOLE.
 - NO REPRESENTATIVE OF THE COUNTY ENGINEER WILL SURVEY OR LAYOUT ANY PORTION OF THE WORK.
 - THE OWNER OR HIS AUTHORIZED REPRESENTATIVE SHALL FURNISH THE COUNTY ENGINEER WITH GRADE SHEETS AND STATIONING FOR ALL HOUSE LATERALS AND BRANCHES AND SHALL PROVIDE STAKES FOR THEM AT THEIR PROPER LOCATIONS WITH STATIONING AND PLANS MARKED. ANY CHANGE IN LOCATION SHALL BE REQUESTED IN WRITING BY THE OWNER OR HIS REPRESENTATIVE.
 - NO REVISIONS SHALL BE MADE IN THESE PLANS WITHOUT THE APPROVAL OF THE COUNTY ENGINEER.
 - USE STANDARD MANHOLE FRAMES AND COVERS, S.A-117, EXCEPT AS NOTED.
 - USE STANDARD STRENGTH PIPE EXCEPT AS NOTED.
 - USE CEMENT MORTAR "WEDGE-LOCK" OR "WEDGE-SEAL" FOR ALL WATERFIGHT CLAY PIPE JOINTS PER S.P.C.C. SEC. 36 & 44.
 - RESURFACE ALL TRENCH WITHIN PAVED AREA TO MEET L. A. COUNTY ROAD DEPT., OR CALIF. STATE HIGHWAY DEPT., REQUIREMENTS IN ACCORDANCE WITH PERMITS.
 - ENCASE FOUR FEET OF SEWER AT POINTS OF INTERFERENCE WITH POLES, S.A-119.
 - HOUSE LATERALS TO BE CONSTRUCTED WITH INVERTS AT EASEMENT LINE 18" FEET BELOW FINISHED SURFACE OVER SEWER.
 - ALL STRUCTURES SHALL BE BRICK SEWER STRUCTURES, S.A-104, EXCEPT AS NOTED.
 - FOR ALLOWABLE LEAKAGE TEST USE FORMULA NO. 1000 S.P.C.C. SEC. 34.
 - MANHOLE TOPS IN IMPROVED PORTS-OF-WAY TO BE LEVEL WITH FINISHED GRADE.
 - THE PRIVATE ENGINEER IS TO FURNISH THE HOUSE LATERAL DEPTH AT THE 18" LINE BELOW THE ELEVATION OF THE FINISHED SURFACE OVER SEWER FOR EACH HOUSE LATERAL ON THE GRADE SHEET.

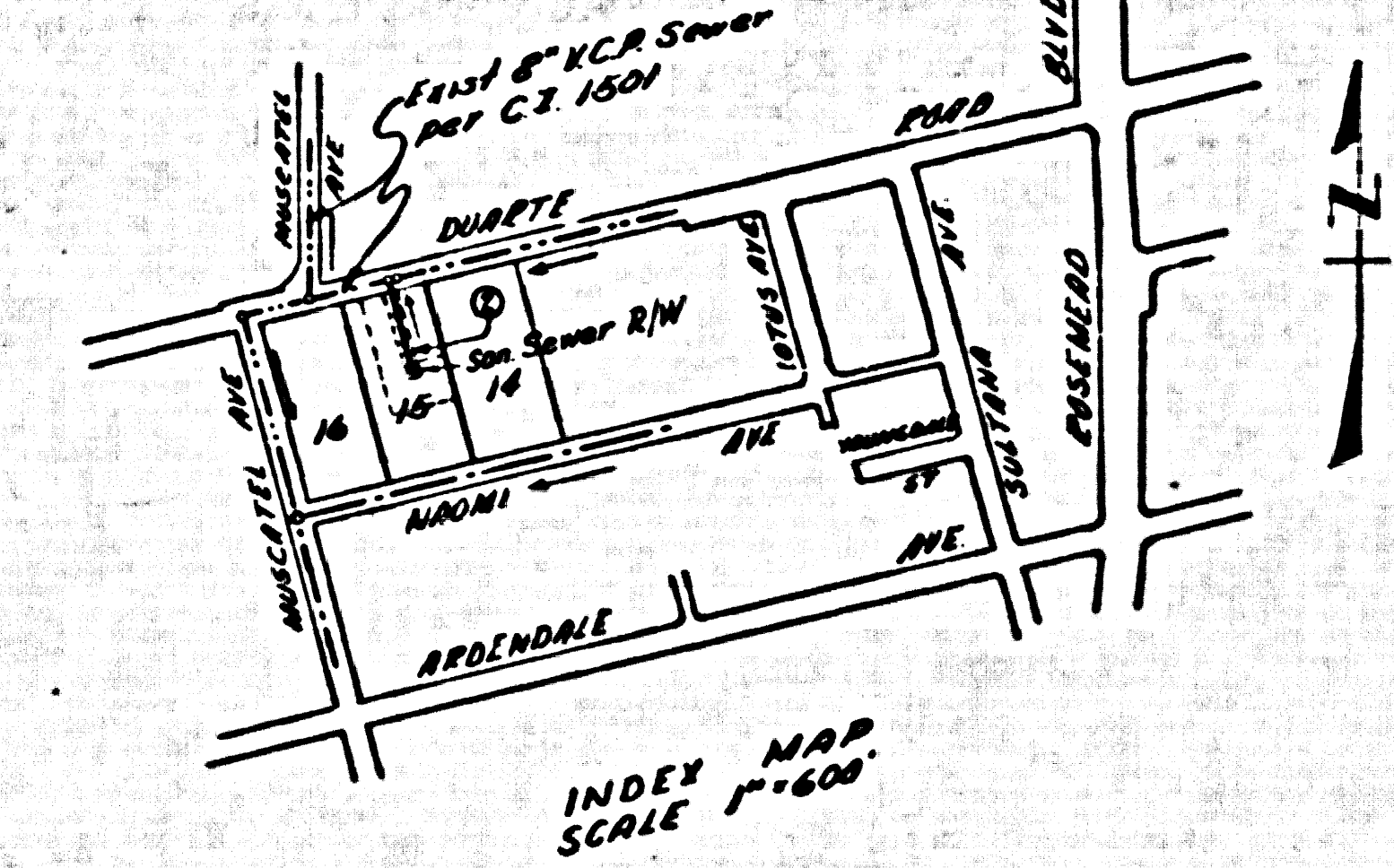

PROFILE ALIGNMENT AND GRADE OF P.C. 4665
 SANITARY SEWERS PAGE 1

TO BE CONSTRUCTED IN
 DUARTE ROAD AND A

SANITARY SEWER RIGHT OF WAY
 PRIVATE CONTRACT NO. 4665

W.S. 44

1 SHEET, 2 PAGES

SCALE: VERT. 1"=4' HORIZ. 1"=40'

JANUARY, 1953

PREPARED BY THE OFFICES OF

Pond ENGINEERING CO.
 BY: *Wendell L. Pond*
 REG. C. E. NO. 8182

FOR LEGEND SEE PLAN NO. S.A-64

NOTE:
 GRADES TO WHICH THIS IMPROVEMENT IS TO BE CONSTRUCTED ARE SHOWN ON PLANS AND PROFILE. GRADE POINTS FOR TOP OF CURB, CENTER LINE OF STABLE, OR CENTER LINE OF ALLEYS ARE SHOWN BY CIRCLES ON PROFILES AT ALL POINTS BETWEEN DESIGNATED POINTS. THE GRADE SHALL BE ESTABLISHED SO AS TO CONFORM TO A STRAIGHT LINE DRAWN BETWEEN SAID DESIGNATED POINTS.
 ELEVATIONS ARE IN FEET ABOVE U.S. SEA LEVEL DATUM OF 1929.
 THIS DRAWING AND THE DATA HEREON ARE HEREBY MADE A PART OF THE SPECIFICATIONS.
 WORK SHALL BE CONSTRUCTED ACCORDING TO SPECIFICATIONS ON FILE IN THE OFFICE OF THE COUNTY ENGINEER AND SHALL BE PROSECUTED ONLY IN THE PRESENCE OF THE COUNTY ENGINEER.
 BEFORE WORK CAN BE STARTED, THE CONTRACTOR MUST OBTAIN A PERMIT TO ENCROACH ON COUNTY STREETS FROM THE L. A. COUNTY ROAD DEPT., 126 W. 5TH ST. AND MAKE A DEPOSIT WITH THE COUNTY ENGINEER, ROOM 324 PALM AVENUE BUILDING, 324 PALM AVENUE, LOS ANGELES, CALIF. TO COVER THE COST OF CONSTRUCTION INSPECTION AND RECORD PLANS.
 APPROVAL OF THIS PLAN BY THE COUNTY OF LOS ANGELES DOES NOT CONSTITUTE A REPRESENTATION AS TO THE ACCURACY OF THE LOCATION OF OR THE EXISTENCE OR NON-EXISTENCE OF ANY UNDERGROUND UTILITY PIPE, OR STRUCTURE WITHIN THE LIMITS OF THIS PROJECT. THIS NOTE APPLIES TO ALL PAGES.
 IF WORK IS TO BE DONE IN A STATE HIGHWAY, A PERMIT MUST BE OBTAINED FROM THE STATE OF CALIFORNIA, DIVISION OF HIGHWAYS, 120 SOUTH SPRING STREET.

COUNTY OF LOS ANGELES, CALIFORNIA

APPROVED, JOHN A. LAMBE, COUNTY ENGINEER

APPROVED, A. M. RAWN, CHIEF ENGINEER

BY: *W. A. Hughes* SANITATION ENGINEER
 BY: *W. A. Rawns* CHIEF ENGINEER
 CHECKED BY: *S. K. White* 2-10-53
 OFFICE OF COUNTY ENGINEER, REG. C. E. NO. 34756

P.C. 4665 PAGE 2

CONNECTION CHARGES AS INDICATED

25763

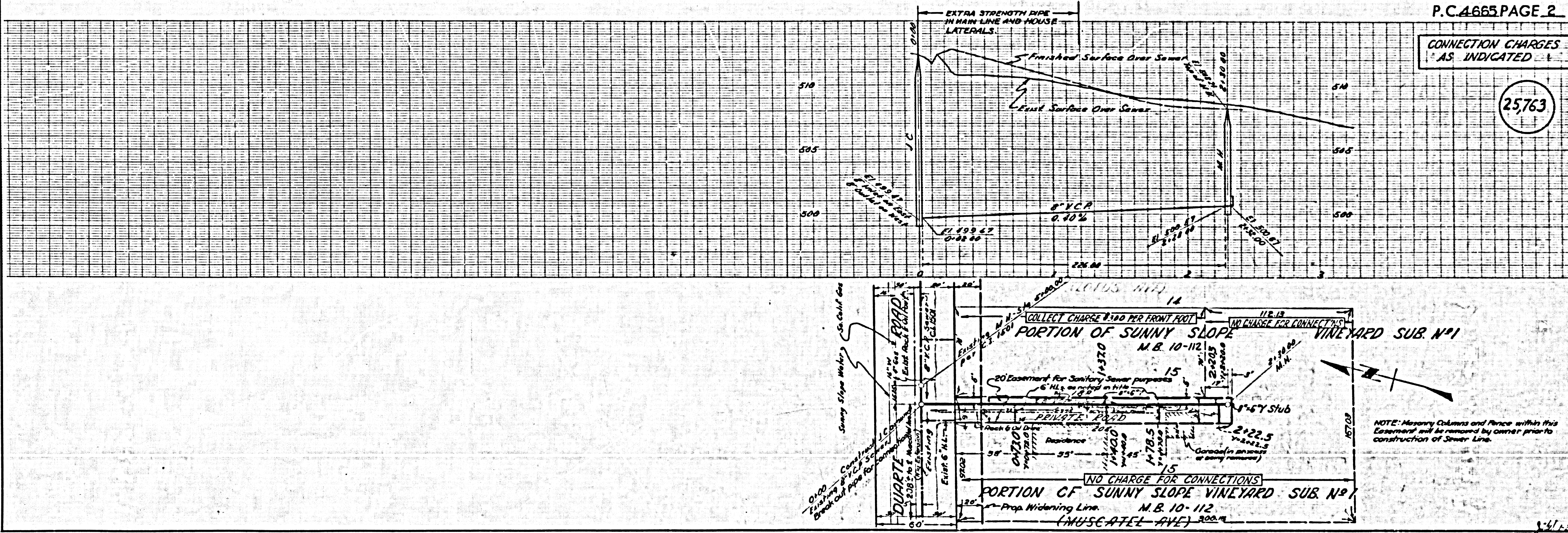

NOTE: Masonry Columns and Piers within this Easement will be removed by owner prior to construction of Sewer Line.