

**NOTE:**  
 Provide stakes on the property lines or property lines produced at right angles to the sewer line at the center line of each manhole.  
 No representative of the County Engineer will survey or layout any portion of the work. The owner or his authorized representative shall furnish the County Engineer with grade sheets and stations for all house laterals and Y branches and shall provide stakes for them at their proper locations with stationing plainly marked. Any change in location shall be requested in writing by the owner or his representative.  
 No revisions shall be made in these plans without the approval of the County Engineer.

1. Use standard manhole frames and covers, S-a-117.
2. Use standard strength pipe except as noted.
3. Use cement mortar or "Speed-seal" or "Wedge-lock" for all V.C.P. joints per Spec's, Secs. 36 & 48.
4. Resurface all trench within paved area to meet L.A. County Road Dept. or Calif. State Highway Dept. requirements in accordance with permit.
5. Encase four feet of sewer at points of interference with poles, Case III, S-a-172.
6. All structures shall be brick sewer structures, S-a-104.
7. Manhole tops in unimproved Rights-Of-Way to be 6" above finish grade.
8. For allowable leakage test, use Formula No. 1, Spec's, Sec. 54.
9. The contractor shall notify the County & Storm Drain Div. by telephone, (ADJ-3-4747, Ext. 362, at least 24 hrs. before starting work under this contract.

B.M. T.E. 365 EL. 433.219  
 T.S. 1408-133  
 Street Blvd & Camino Real Ave.  
 NE Cor. Bl. spk. in curb 6" S.  
 of E. end C.R.V.

PROFILE, ALIGNMENT AND GRADE OF **PC 4683**  
**SANITARY SEWERS** PAGE ONE  
 TO BE CONSTRUCTED IN  
**SANITARY SEWER EASEMENT**  
**EAST OF TEMPLE CITY BLVD** (25,772)

PRIVATE CONTRACT NO. **4683**  
 W.S. 44  
 SHEET 1 OF 1 SHEET  
 Scale: VERT. 1"=4' HORIZ. 1"=40'  
 FEBRUARY 1958  
 PREPARED IN THE OFFICES OF  
**John D. Bell** Reg. C. E. No. 7837  
 FOR LEGEND SEE PLAN NO. S-a-64

**NOTE:**  
 Grades to which this improvement is to be constructed are shown on plans and profiles. Grade points for top of curbs, center line of streets, or center line of alleys are shown by circles on profiles. At all points between designated points the grade shall be established so as to conform to a straight line drawn between said designated points.  
 Elevations are in feet above U.S.C. & G.S. Sea Level Datum of 1929.  
 This drawing and the data hereon are hereby made a part of the specifications.  
 Work shall be constructed according to specifications on file in the office of the County Engineer and shall be prosecuted only in the presence of the County Engineer.  
 Before work can be started, the contractor must obtain a permit to excavate in County streets from the L.A. County Road Dept., 108 W. 2nd St. and make a deposit with the County Engineer, Room 314 City Attorney Building, sufficient to cover the cost of construction inspection and record plans: 253 So. Broadway.  
 Approval of this plan by the County of Los Angeles does not constitute a representation as to the accuracy of the location of or the existence or non-existence of any underground utility, pipe, or structure within the limits of this project. This note applies to all sheets.  
 If work is to be done in a State Highway, a permit must be obtained from the State of California, Division of Highways, 120 South Spring Street.

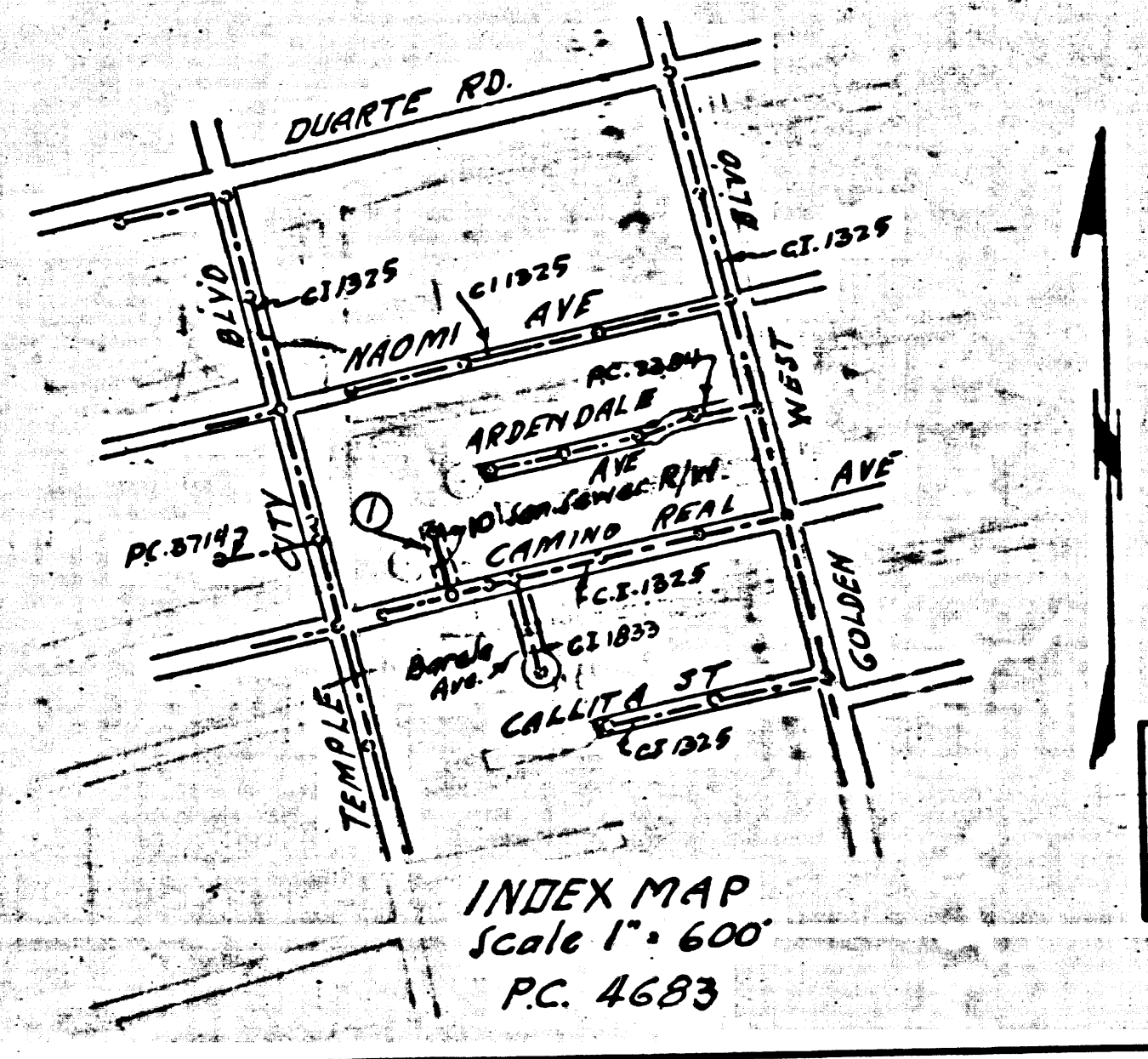

**NO CHARGE FOR CONNECTIONS**  
 3-15-58

COUNTY OF LOS ANGELES, CALIFORNIA  
 Approved, **John A. Lambie** County Engineer  
 Approved, **A. M. Rovm** CHIEF ENG. CO. SAN. DIST. NO. 15  
**Sanitary Engineer** **Office Engineer**  
 Office of County Engineer, Reg. C. E. No. 7837