

B.M. SY 846 Elev. 133.820
 LST near M.C.R. @ NE Cor
 Washington Blvd. & Eastern Ave.
 River Gued.

NOTE:
 THE CONTRACTOR SHALL NOTIFY THE CONSTRUCTION AND
 STORM DRAIN DIVISION BY TELEPHONE, MADISON 9-4747,
 EXT. 362, AT LEAST 24 HOURS BEFORE STARTING ANY
 WORK UNDER THIS CONTRACT.

NO CHARGE FOR
 CONNECTIONS
 7/27/58 Dennis 4-158

E. LOS ANGELES BLDG. DIST. NO. 6

- NOTES:
 PROVIDE STAKES ON THE PROPERTY LINE OR PROPERTY LINES PRODUCED AT RIGHT ANGLES TO THE SEWER LINE AT THE CENTER
 LINE OF EACH MANHOLE.
 NO REPRESENTATIVE OF THE COUNTY ENGINEER WILL SURVEY OR LAY OUT ANY PORTION OF THE WORK.
 THE OWNER OR HIS AUTHORIZED REPRESENTATIVE SHALL FURNISH THE COUNTY ENGINEER WITH GRADE SHEETS AND STATION
 FOR ALL HOUSE LATERALS AND Y BRANCHES AND SHALL PROVIDE STAKES FOR THEM AT THEIR PROPER LOCATIONS WITH STATION
 AND PLAINLY MARKED. ANY CHANGE IN LOCATION SHALL BE REQUESTED IN WRITING BY THE OWNER OR HIS REPRESENTATIVE.
 NO IMPROVEMENTS SHALL BE MADE IN THESE PLANS WITHOUT THE APPROVAL OF THE COUNTY ENGINEER.
 1. USE STANDARD MANHOLE FRAMES AND COVERS, S.A.-117, EXCEPT AS NOTED.
 2. USE STANDARD MANHOLE FRAMES AND COVERS, S.A.-117, EXCEPT AS NOTED.
 3. USE CEMENT MORTAR "RED-DOG-LATCH" TYPE "J" JOINTS FOR ALL WYTHAMED CLAY PIPE JOINTS, PER SPEC'S, S.A. 117 & 118.
 4. RESURFACE ALL TRENCH WITHIN PAVED AREA TO MEET L. A. COUNTY ROAD DEPT. OR CALIF. STATE HIGHWAY DEPT. SPECIFICATIONS
 IN ACCORDANCE WITH PERMITS.
 5. EXCAVE FOUR FEET OF SEWER AT POINTS OF INTERFERENCE WITH POLES, S.A.-119.
 6. HOUSE LATERALS TO BE CONSTRUCTED WITH INVERTS AT PROPERTY LINE... SEE SPEC'S SHOW GRADE OF CENTERLINE OF ALLEY.
 7. ALL STRUCTURES SHALL BE BACK SEWER STRUCTURES, S.A.-104, EXCEPT AS NOTED.
 8. FOR ALLOWABLE LEAKAGE TEST USE FORMULA NO. 1 SPEC'S, SEC. 04.
 9. MANHOLE TOPS IN UNIMPROVED RIGHTS-OF-WAY TO BE 6" ABOVE FINISHED GRADE.
 10. THE PRIVATE ENGINEER IS TO FURNISH THE HOUSE LATERAL DEPTH AT THE PROPERTY
 LINE BELOW THE ELEVATION OF THE CENTERLINE OF ALLEY FOR EACH HOUSE LATERAL
 ON THE GRADE SHEET.

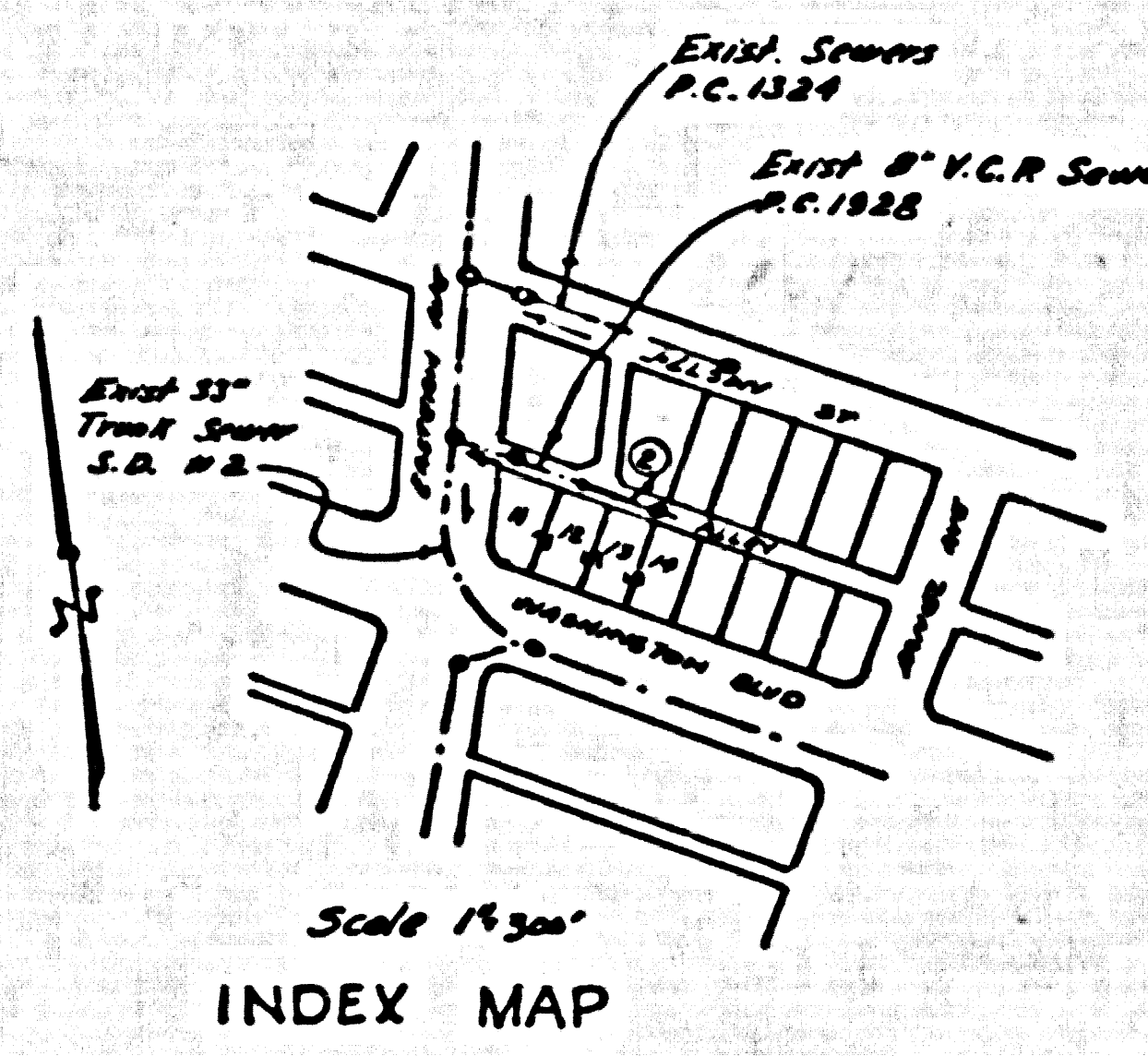

PROFILE ALIGNMENT AND GRADE OF P.C. 4630
 SANITARY SEWERS PAGE 1

TO BE CONSTRUCTED IN
 FIRST ALLEY NORTH OF WASHINGTON BOULEVARD
 BETWEEN A POINT 140 FT EASTERLY AND A POINT
 215 FT EASTERLY OF EASTERN AVENUE

PRIVATE CONTRACT NO. 4630

W.S. 36

1 SHEET OF 2 PAGES

SCALE: VERT. 1" = 4' HORIZ. 1" = 40'

January, 1958

26350

PREPARED IN THE OFFICES OF
 Delta Engineering & Surveying Co.
 7016 Wilshire Blvd.
 Beverly Hills, Cal. 90210

By: *Robert Stewart*
 REG. C. E. NO. 8752

FOR LEGEND SEE PLAN NO. S-A-64

NOTES:
 GRADES TO WHICH THIS IMPROVEMENT IS TO BE CONSTRUCTED ARE SHOWN ON PLANS AND PROFILE. GRADE POINTS FOR
 TOP OF CURB, CENTER LINE OF STREETS, OR CENTER LINE OF ALLEYS ARE SHOWN BY CIRCLES ON PROFILES. AT ALL POINTS BETWEEN
 DESIGNATED POINTS THE GRADE SHALL BE ESTABLISHED SO AS TO CONFORM TO A STRAIGHT LINE DRAWN BETWEEN SAID DESIGNATED
 POINTS.
 ELEVATIONS ARE IN FEET ABOVE M.S.C.F.S. SEA LEVEL DATUM OF 1929.
 THE SEWERING AND THE DATE HEREON ARE HEREBY MADE A PART OF THE SPECIFICATIONS.
 WORK SHALL BE CONSTRUCTED ACCORDING TO SPECIFICATIONS ON FILE IN THE OFFICE OF THE COUNTY ENGINEER AND SHALL
 BE SUPERVISED ONLY IN THE PRESENCE OF THE COUNTY ENGINEER.
 BEFORE WORK CAN BE STARTED, THE CONTRACTOR MUST OBTAIN A PERMIT TO EXCAVATE IN COUNTY STREETS FROM THE
 L. A. COUNTY ROAD DEPT., 100 W. 2ND ST. AND MAKE A DEPOSIT WITH THE COUNTY ENGINEER, ROOM 204 PAN AMERICAN BUILDING,
 250 S.O. HIGHWAY, SUFFICIENT TO COVER THE COST OF CONSTRUCTION INSPECTION AND RECORD PLANS.
 APPROVAL OF THIS PLAN BY THE COUNTY OF LOS ANGELES DOES NOT CONSTITUTE A REPRESENTATION AS TO THE ACCURACY
 OF THE LOCATION OR OF THE EXISTENCE OR NON-EXISTENCE OF ANY UNDERGROUND UTILITY PIPE OR STRUCTURE WITHIN THE
 LIMITS OF THIS PROJECT. THIS NOTE APPLIES TO ALL PAGES.
 IF WORK IS TO BE DONE IN A STATE HIGHWAY, A PERMIT MUST BE OBTAINED FROM THE STATE OF CALIFORNIA, DIVISION OF
 HIGHWAYS, 130 SOUTH SPRING STREET.

COUNTY OF LOS ANGELES, CALIFORNIA

APPROVED, JOHN A. LAMBE, COUNTY ENGINEER
 APPROVED, A. M. RAWIN, CHIEF ENGINEER
 BY: *John A. Lambe* SANITATION ENGINEER BY: *A. M. Rawin* CHIEF ENGINEER
 CHECKED BY: *Robert Stewart* 4-23-58
 OFFICE OF COUNTY ENGINEER, M.S.C.F.S. NO. 3450

APPROVED BY
 INDUSTRIAL WASTE DIVISION
 BY: *James Stewart* DATE 2/19/58

P.C. 4630 PAGE 2

NO CHARGE FOR
 CONNECTIONS

26350

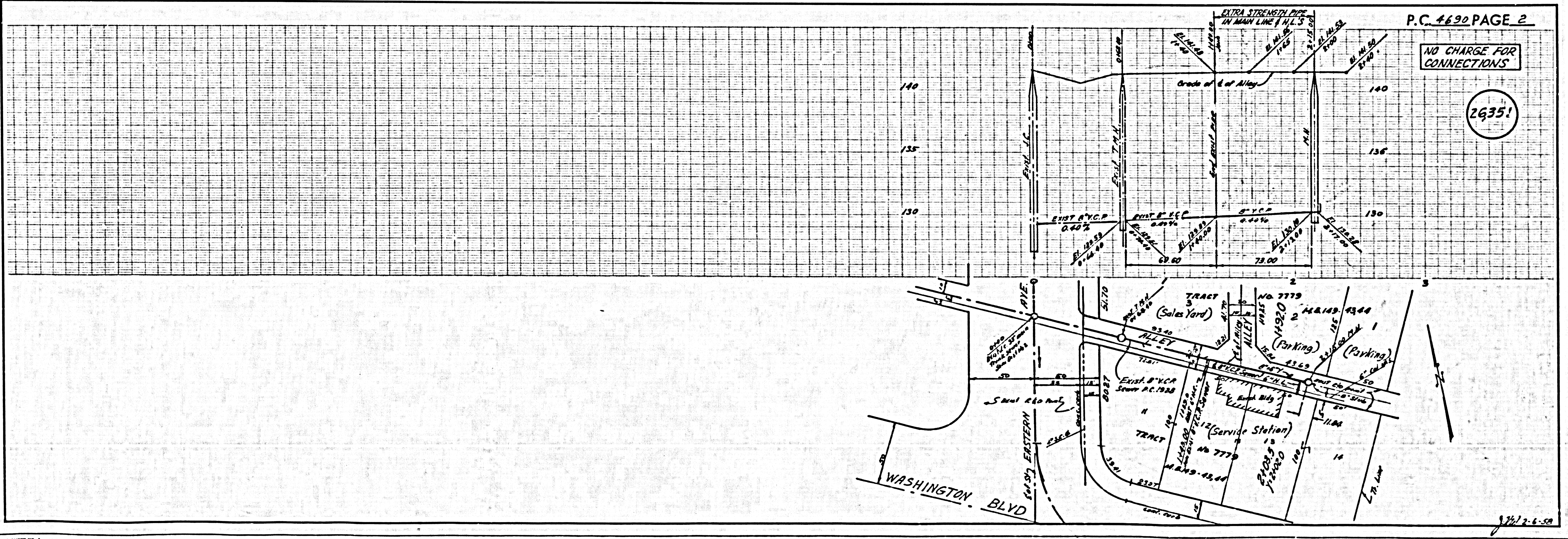

2/12-6-58