

LENNOX BLDG. DIST. NO. 7

PROFILE ALIGNMENT AND GRADE OF P.C. 4713  
 SANITARY SEWERS PAGE 1

TO BE CONSTRUCTED IN  
**SLAUSON AVENUE** (25,735)  
 AND THE  
 FIRST ALLEY WEST OF  
 SHENANDOAH AVENUE  
 PRIVATE CONTRACT NO. 4713

W.S. 24

1 SHEET OF 2 PAGES

SCALE: HORIZ. 1" = 40' VERT. 1" = 4'

FEBRUARY, 1958

PREPARED IN THE OFFICES OF  
**NATIONAL ENGINEERING CO.**

By *Edward J. Egan*  
 REG. E. NO. 5028

FOR LEGEND SEE PLAN NO. S.A-64

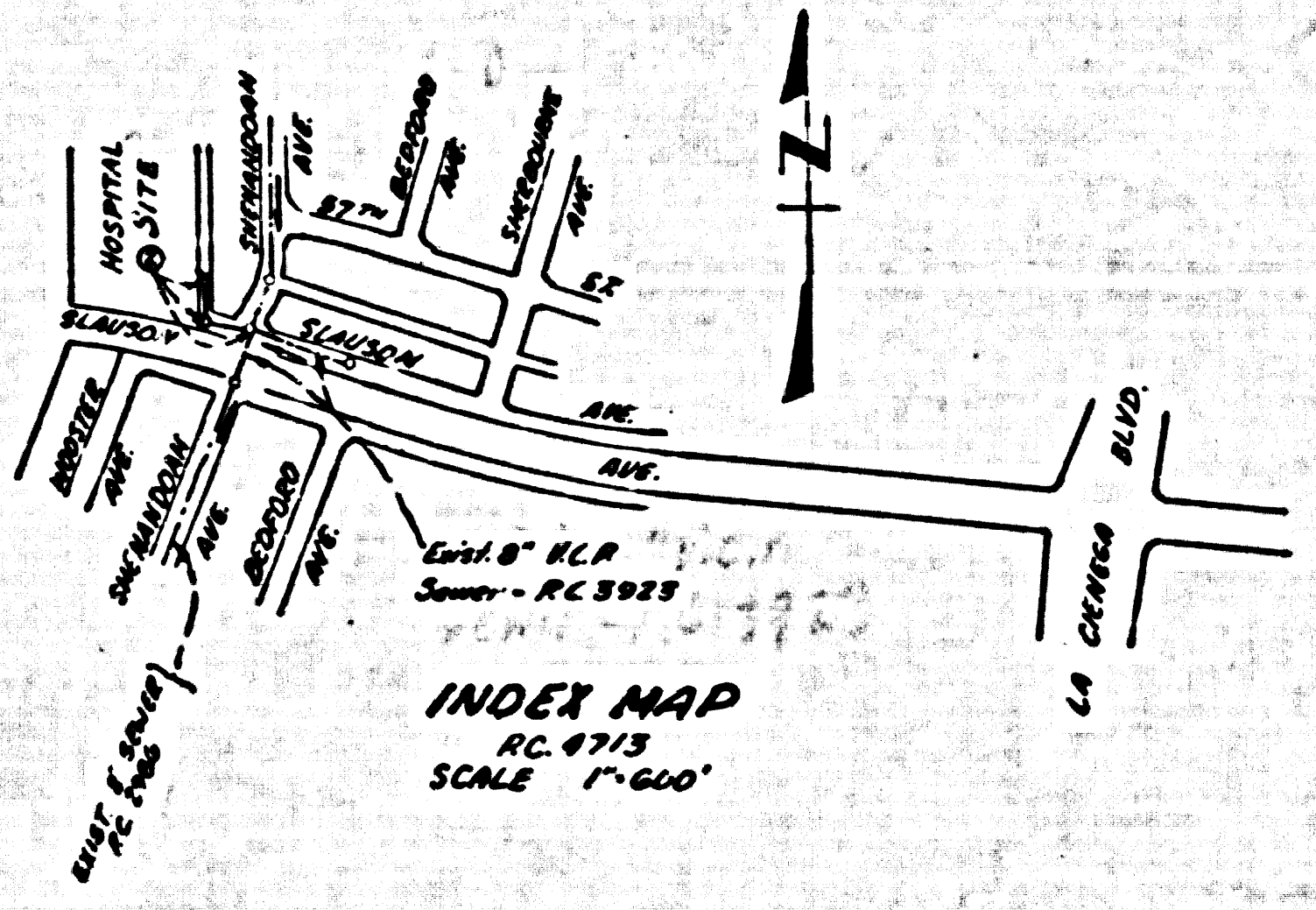

- NOTES:
- PROVIDE STAKES ON THE PROPERTY LINE OR PROPERTY LINE LOCATED AT RIGHT ANGLES TO THE SEWER LINE AT THE CENTER LINE OF EACH MANHOLE.
  - NO REPRESENTATIVE OF THE COUNTY ENGINEER WILL SURVEY OR LAYOUT ANY PORTION OF THE WORK.
  - THE OWNER OR HIS AUTHORIZED REPRESENTATIVE SHALL FURNISH THE COUNTY ENGINEER WITH GRADE SHEETS AND STATION FOR ALL HOUSE LATERALS AND T-BRANCHES AND SHALL PROVIDE STAKES FOR THEM AT THEIR PROPER LOCATIONS WITH STATIONING PLAINLY MARKED. ANY CHANGE IN LOCATION SHALL BE REQUESTED IN WRITING BY THE OWNER OR HIS REPRESENTATIVE.
  - NO REVISIONS SHALL BE MADE IN THESE PLANS WITHOUT THE APPROVAL OF THE COUNTY ENGINEER.
  - USE STANDARD MANHOLE FRAMES AND COVERS, S.A-117, EXCEPT AS NOTED.
  - USE STANDARD STRENGTH PIPE EXCEPT AS NOTED.
  - USE CAMBRET MORTAR, "WEDGE-LOCK" OR "SPEED-SEAL" FOR ALL VITRIFIED CLAY PIPE JOINTS PER SPEC'S SEC'S 36 & 40.
  - RESURFACE ALL TRINCH WITHIN PAVING AREA TO MEET L.A. COUNTY ROAD DEPT. OR CALIF. STATE HIGHWAY DEPT. REQUIREMENTS IN ACCORDANCE WITH PERMITS.
  - SHOULDER FOUR FEET OF SEWER AT POINTS OF INTERFERENCE WITH POLES, S.A-119.
  - ALL STRUCTURES SHALL BE BRICK SEWER STRUCTURES, S.A-106, EXCEPT AS NOTED.
  - FOR ALLOWABLE MESSAGE TEE USE FORMULA NO. 1, SPEC. SEC. 54.
  - MANHOLE TOPS ON UNIMPROVED SHORTCUTS-OF-WAY TO BE 6" ABOVE FINISHED GRADE.

NOTE:  
 THE CONTRACTOR SHALL NOTIFY THE CONSTRUCTION AND STORM DRAIN DIVISION BY TELEPHONE, MADISON 9-6447, EXT. 352 AT LEAST 24 HOURS BEFORE STARTING ANY WORK UNDER THIS CONTRACT.

CONNECTION CHARGES AS INDICATED  
 7/27/58 Dennis 3-21-58

BENCH MARK: B.M. 29-7  
 La Cienega Blvd @ Pt. 50 of Slauson Ave.  
 E.T. West of the West end of La Cienega Blvd.  
 Set in concrete 1' below surface, L.A. Ed. Dept.  
 Square Brass Cap Manometer, L.A. Co. Engr. R.B. 1551-E, 1953 AD.  
 ELEV. 160.947

APPROVED, INDUSTRIAL WASTE DIVISION  
 By *J.H. Stewart* 2/23/58

NOTES:  
 GRADES TO WHICH THE IMPROVEMENT IS TO BE CONSTRUCTED ARE SHOWN ON PLANS AND PROFILE GRADE POINTS FOR TOP OF CURBS, CENTER LINE OF STREETS, OR CENTER LINE OF ALLEYS ARE SHOWN BY CIRCLES ON PROFILES AT ALL POINTS BETWEEN DESIGNATED POINTS. THE GRADE SHALL BE ESTABLISHED SO AS TO CONFORM TO A STRAIGHT LINE BETWEEN SAID DESIGNATED POINTS.  
 SITUATIONS ARE IN FEET ABOVE SEA LEVEL UNLESS OTHERWISE NOTED.  
 THE DRAWING AND THE DATA HEREON ARE HEREBY MADE A PART OF THE SPECIFICATIONS.  
 WORK SHALL BE CONSTRUCTED ACCORDING TO SPECIFICATIONS ON FILE IN THE OFFICE OF THE COUNTY ENGINEER AND SHALL BE PROSECUTED ONLY IN THE PRESENCE OF THE COUNTY ENGINEER.  
 BEFORE WORK CAN BE STARTED, THE CONTRACTOR MUST OBTAIN A PERMIT TO EXCAVATE IN COUNTY SHEETS FROM THE L.A. COUNTY ROAD DEPT., 120 W. 2ND ST. AND MAKE A DEPOSIT WITH THE COUNTY ENGINEER, ROOM 304 AMERICAN BLDG., 153 SO. BROADWAY SUFFICIENT TO COVER THE COST OF CONSTRUCTION INSPECTION AND RECORD PLANS.  
 APPROVAL OF THIS PLAN BY THE COUNTY OF LOS ANGELES DOES NOT CONSTITUTE A REPRESENTATION AS TO THE ACCURACY OF THE LOCATION OF OR THE EXISTENCE OR NON-EXISTENCE OF ANY UNDERGROUND UTILITY PIPES, OR STRUCTURE WITHIN THE LIMITS OF THE PROJECT. THIS NOTE APPLIES TO ALL PAGES.  
 IF WORK IS TO BE DONE ON A STATE HIGHWAY, A PERMIT MUST BE OBTAINED FROM THE STATE OF CALIFORNIA, DIVISION OF HIGHWAYS, 120 SOUTH SPRING STREET.

COUNTY OF LOS ANGELES, CALIFORNIA

APPROVED, JOHN A. LAMBE, COUNTY ENGINEER

APPROVED, A. M. BAWN, CHIEF ENGINEER

By *Ed. Hughes* SANITATION ENGINEER  
 By *E. Matthews* OFFICE ENGINEER  
 CHECKED BY *Carl H. Pomeroy* 2/23/58  
 OFFICE OF COUNTY ENGINEER, REG. C. E. NO. 4-612

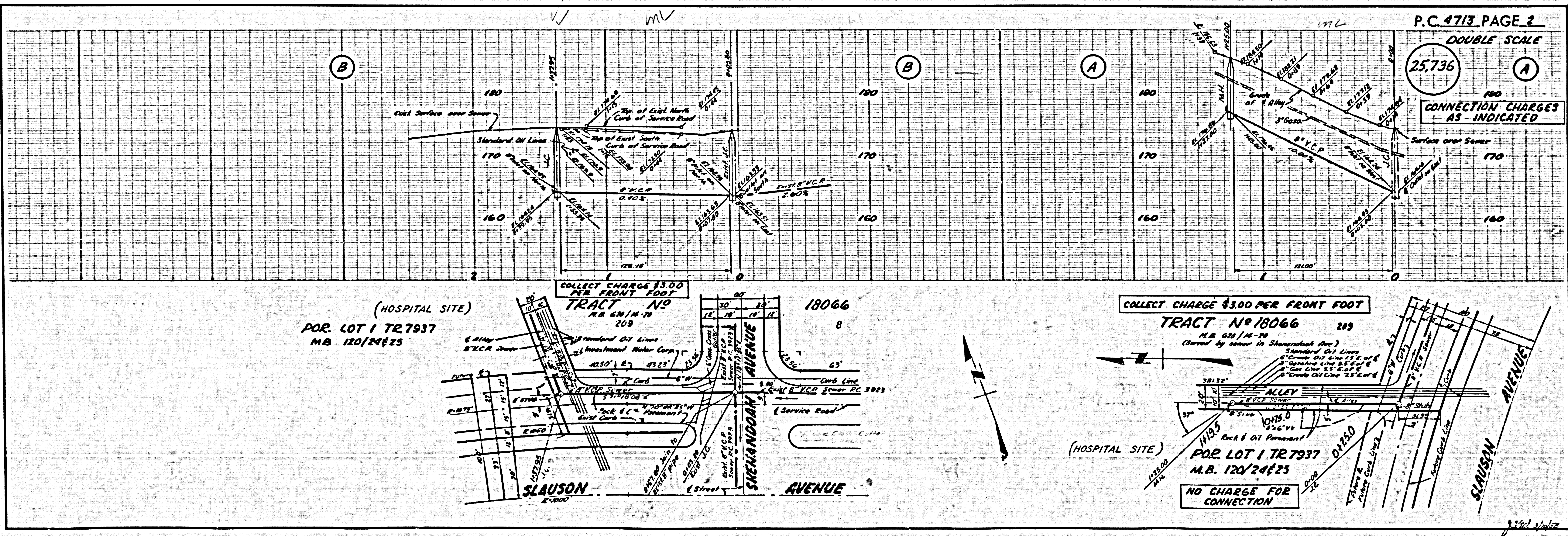

P.C. 4713 PAGE 2  
 DOUBLE SCALE  
 (25,736)  
 CONNECTION CHARGES AS INDICATED

COLLECT CHARGE \$3.00 PER FRONT FOOT  
 TRACT NO 18066  
 M.B. 120/24623  
 (HOSPITAL SITE)  
 NO CHARGE FOR CONNECTION