

PROFILE OF SEWER  
SCALE: HORIZONTAL 1"=40'  
VERTICAL 1"=4'

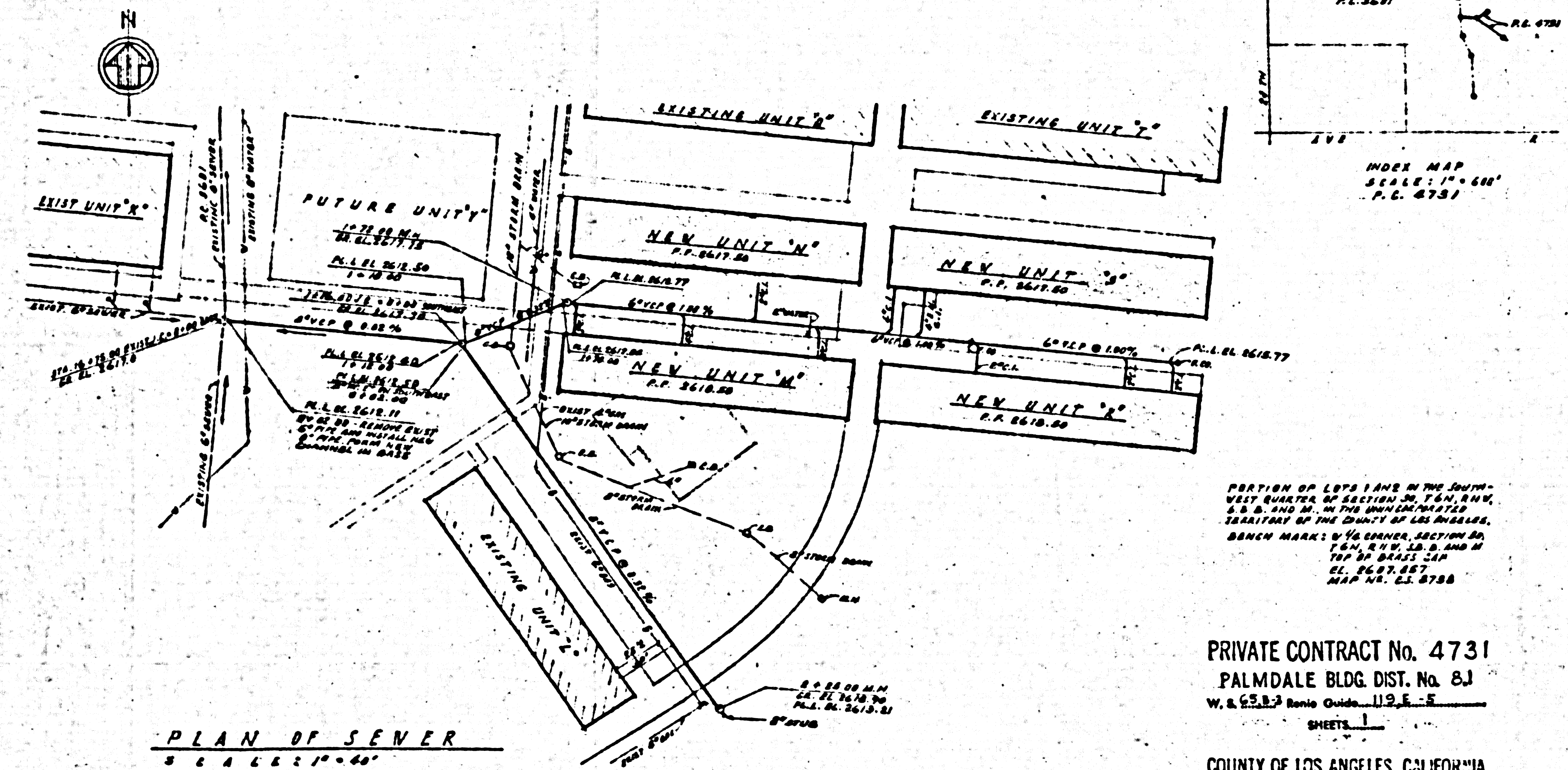

PLAN OF SEWER  
SCALE: 1"=60'

- Note:  
No representative of the County Engineer will survey or layout any portion of the work.  
No revisions shall be made in these plans without approval of the County Engineer.
1. Use standard manhole frames and covers, S-117, except as noted.
  2. Use standard strength pipe, except as noted.
  3. Use standard "Wedge-Lock" Manhole-Lock for all vitrified clay pipe joints, per Spec. Sec. 36.4.4.8
  4. Resurface all trench within paved areas to meet Los Angeles County Road Department or California State Highway requirements, in accordance with permit.
  5. Excavate four feet of cover at points of interference with poles as per S-119.
  6. All structures shall be brick sewer structures S-104, except as noted.
  7. For allowable leakage test use Formula No. 1, Spec., Sec. 34.

- Note:  
Elevations are in feet above U.S.C. & G.S. Sea Level Datum of 1929.  
This Drawing and the data hereon are hereby made a part of the specifications.  
Work shall be constructed according to specifications on file in the office of the County Engineer and shall be prosecuted only in the presence of the County Engineer.
- Before work can be started, the contractor must obtain a permit to excavate in County streets from the L.A. County Road Department, 108 West Second Street and a permit to cover construction inspection and record plans from the County Engineer, Room 324, 253 South Broadway.
- If work is to be done in a state highway, a permit must be obtained from the State of California, Division of Highways, 120 South Spring Street.
- Approval of this plan by the County of Los Angeles does not constitute a representation as to the accuracy of the location of, or the existence or non-existence of, any underground utility, pipe, or structure within the limits of this project.

PRIVATE CONTRACT No. 4731  
PALMDALE BLDG. DIST. No. 8J  
W. & 65th St. Davis, Cal. 91315  
SHEETS 1

COUNTY OF LOS ANGELES, CALIFORNIA  
APPROVED, JOHN A. LAMBE, County Engineer  
By *[Signature]*  
Sanitation Engineer  
APPROVED, A. M. RAYM, Chief Engineer  
Co. Sec. Dist. No. \_\_\_\_\_  
By \_\_\_\_\_  
Office Engineer  
Checked *[Signature]* 4-17-58  
Office of County Engineer Reg. C.E. No. 2446...

NOTE:  
The above approval by the County Engineer applies to the following:  
(a) All 8 inch or larger sanitary sewer lines.  
(b) All manholes

NOTE:  
THE CONTRACTOR SHALL NOTIFY THE TELEPHONE AND STORM DRAIN DIVISION BY TELEPHONE, MADISON 9-4747, EXT. 362, AT LEAST 24 HOURS BEFORE STARTING ANY WORK UNDER THIS CONTRACT.

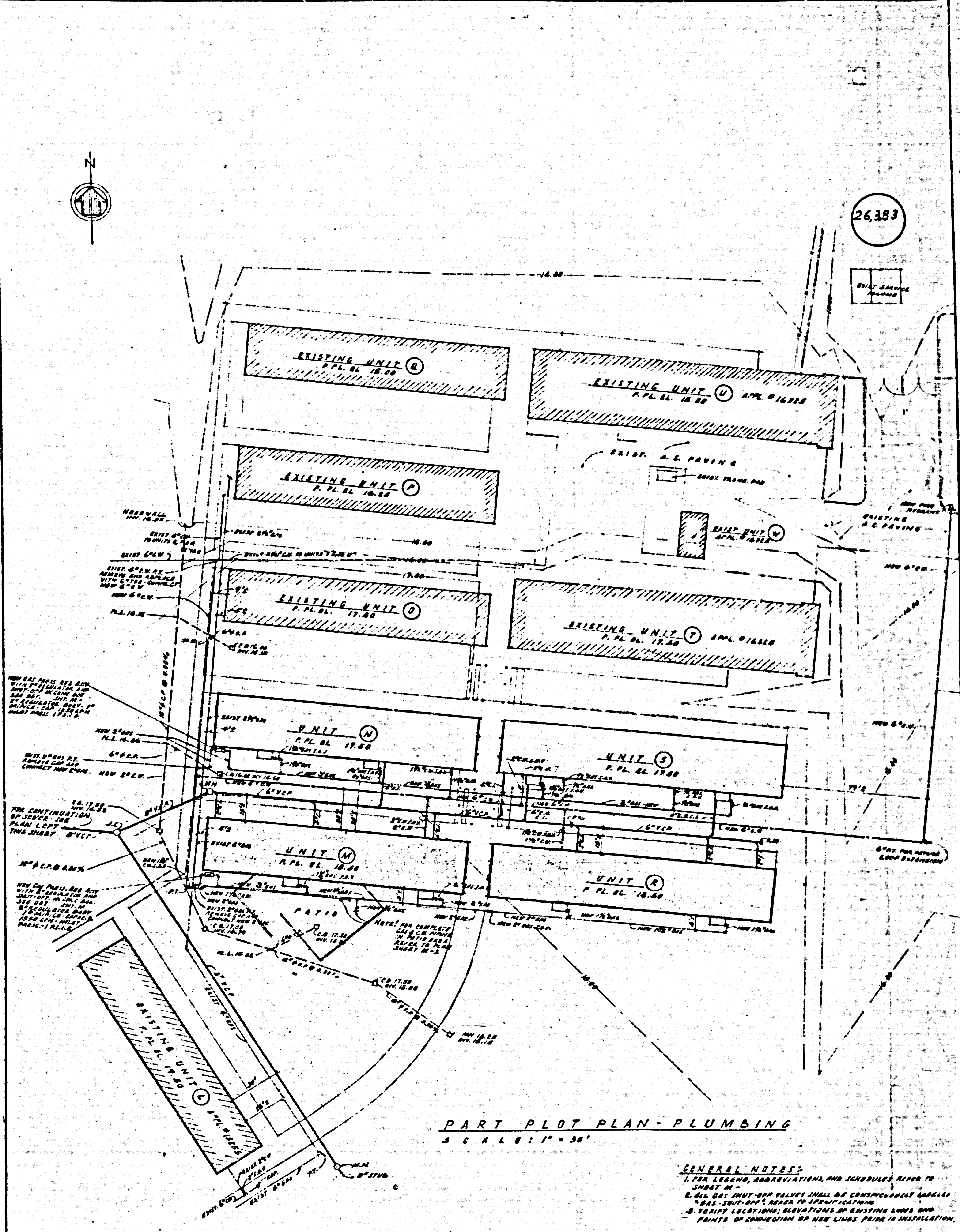

PART PLOT PLAN - PLUMBING  
SCALE: 1"=30'

GENERAL NOTES:  
1. FOR LEGEND, ABBREVIATIONS, AND SCHEDULES, REFER TO SHEET M-1.  
2. ALL GAS UNIT-APP VALVES SHALL BE CONSPICUOUSLY LABELED.  
3. VERIFY EXISTING AND PROPOSED EXISTING LINES AND POINTS OF CONNECTION OF NEW LINES PRIOR TO INSTALLATION.

PALMDALE HIGH SCHOOL ADDITIONS  
UNITS M N R & S  
ANTELOPE VALLEY JOINT UNION HIGH SCHOOL DISTRICT  
LANCASTER CALIFORNIA

M. K. SHIELDS CO. MECHANICAL ENGINEERS 1200 WEST 10TH STREET LOS ANGELES 4, CALIFORNIA	STATE OF CALIFORNIA DEPARTMENT OF PUBLIC WORKS DIVISION OF ARCHITECTURE	H. L. GOGERTY, F.A.I.A., ARCHITECT D. STEWART KERR, A.I.A., ASSOCIATE 8122 WEST ELEVENTH STREET LOS ANGELES 4, CALIFORNIA	PLOT PLAN - PLUMBING SEWER PLAN & PROFILE	652-12 SHEET NO. M-1
APPROVED	APPROVED			

UNITS M, N, R & S PALM