

WHITTIER BLDG. DIST. NO. 11

PROFILE ALIGNMENT AND GRADE OF  
**SANITARY SEWERS** PAGE 1  
 TO BE CONSTRUCTED IN  
 TRACT No 22667 **28,086**

PRIVATE CONTRACT NO. 4782

W.S. 34  
 1 SHEETS, 2 PAGES

SCALE: HORIZ. 1" = 40' VERT. 1" = 4'  
 MAY, 1958  
 PREPARED IN THE OFFICES OF  
**OLSON SURVEYING SERVICE**

BY: *[Signature]*  
 REG. C. E. NO. 2112

FOR LEGEND SEE PLAN NO. S-A-64

B.M. 51292 El. 154.133 (1955 Adj.)  
 14.17k in W. edge of Curb Dr.  
 143 E. of Lat. Elmore Ave. 20' 1/2 S. of E. of Broadway  
 (Sonly Fe Quad)

- NOTES:
- PROVIDE STAKES ON THE PROPERTY LINE OR PROPERTY LINES PRODUCED AT RIGHT ANGLES TO THE SEWER LINE AT THE CENTER LINE OF EACH MANHOLE.
  - NO REPRESENTATIVE OF THE COUNTY ENGINEER WILL SURVEY OR LAYOUT ANY PORTION OF THE WORK.
  - THE OWNER OR HIS AUTHORIZED REPRESENTATIVE SHALL FURNISH THE COUNTY ENGINEER WITH GRADE SHEETS AND STATION FOR ALL HOUSE LATERALS AND Y BRANCHES AND SHALL PROVIDE STAKES FOR THEM AT THEIR PROPER LOCATIONS WITH STATIONING PLAINLY MARKED. ANY CHANGE IN LOCATION SHALL BE REQUESTED IN WRITING BY THE OWNER OR HIS REPRESENTATIVE.
  - NO REVISIONS SHALL BE MADE IN THESE PLANS WITHOUT THE APPROVAL OF THE COUNTY ENGINEER.
  - USE STANDARD MANHOLE FRAMES AND COVERS, S-A-177.
  - USE STANDARD STRENGTH PIPE EXCEPT AS NOTED.
  - USE CEMENT MORTAR OR "WEDGE-LOCK" OR "SPRUE-SEAL" FOR ALL WITHEDED CLAY PIPE JOINTS PER S.E.C. 5-117, CASE II.
  - RESURFACE ALL TRENCH WITHIN PAVED AREA TO MEET L.A. COUNTY ROAD DEPT., OR CALIF. STATE HIGHWAY DEPT. REQUIREMENTS IN ACCORDANCE WITH PERMITS.
  - ENCASE FOUR FEET OF SEWER AT POINTS OF INTERFERENCE WITH POLES, S-A-177, CASE II.
  - HOUSE LATERALS TO BE CONSTRUCTED WITH INVERTS AT PROPERTY LINE 6 FEET BELOW CURB GRADE EXCEPT AS NOTED.
  - ALL STRUCTURES SHALL BE BRICK SEWER STRUCTURES, S-A-194.
  - FOR ALLOWABLE LEAKAGE TEST USE FORMULA NO. 1 SPEC'G, SEC. 54.
  - MANHOLE TOPS IN UNIMPROVED RIGHTS-OF-WAY TO BE 6" ABOVE FINISHED GRADE.
  - THE PRIVATE ENGINEER IS TO FURNISH THE HOUSE LATERAL DEPTH AT THE PROPERTY LINE BELOW THE TOP OF CURB ELEVATION FOR EACH HOUSE LATERAL ON THE GRADE SHEET.

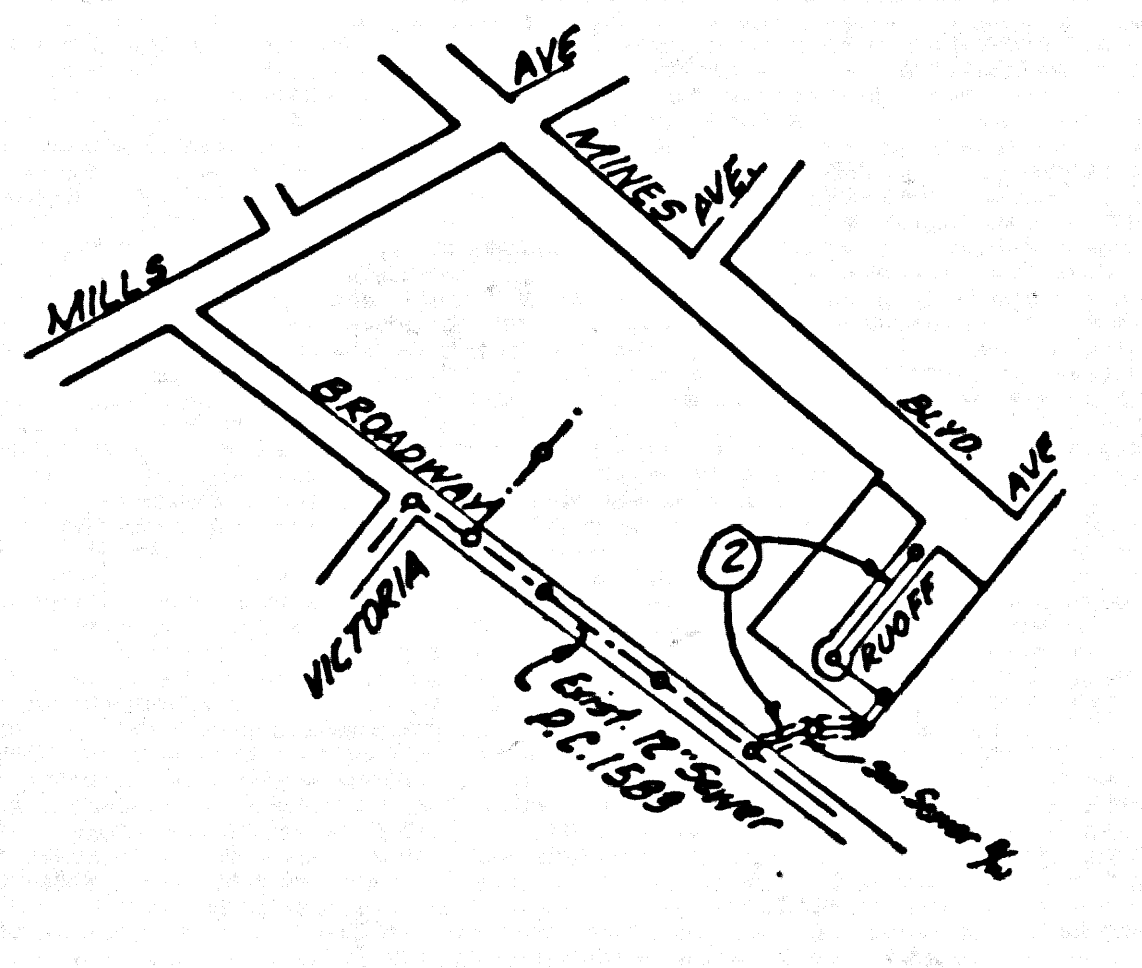

INDEX MAP  
 P.C. 4782  
 TRACT No 22667  
 SCALE: 1" = 600'

THE CONTRACTOR SHALL NOTIFY THE CONSTRUCTION AND STORM DRAIN DIVISION BY TELEPHONE MADISON 9-4747 EXT. 362 AT LEAST 24 HOURS BEFORE STARTING ANY WORK UNDER THIS CONTRACT.

COLLECT CHARGES AS INDICATED  
 E. L. ... 6-11-58

REVISION  
 Revise R/W on Page 2-A  
 Checked by: *[Signature]*  
 REG. C. E. No 12137

NOTE:  
 GRADES TO WHICH THIS IMPROVEMENT IS TO BE CONSTRUCTED ARE SHOWN ON PLANS AND PROFILE. GRADE POINTS FOR TOP OF CURB, CENTER LINE OF STREETS, OR CENTER LINE OF ALLEYS ARE SHOWN BY CIRCLES ON PROFILE. AT ALL POINTS BETWEEN INDICATED POINTS THE GRADE SHALL BE ESTABLISHED SO AS TO CONFORM TO A STRAIGHT LINE DRAWN BETWEEN SAID INDICATED POINTS.  
 ELEVATIONS ARE IN FEET ABOVE U.S.C. & G.S. MEAN SEA LEVEL, DATUM OF 1929.  
 THE DRAWING AND THE DATA HEREON ARE HEREBY MADE A PART OF THE SPECIFICATIONS.  
 WORK SHALL BE CONSTRUCTED ACCORDING TO SPECIFICATIONS ON FILE IN THE OFFICE OF THE COUNTY ENGINEER AND SHALL BE PROSECUTED ONLY IN THE PRESENCE OF THE COUNTY ENGINEER.  
 BEFORE WORK CAN BE STARTED, THE CONTRACTOR MUST OBTAIN A PERMIT TO EXCAVATE IN CURB STREETS FROM THE L.A. COUNTY ROAD DEPT., 2151 S. BROADWAY AND MAKE A DEPOSIT WITH THE COUNTY ENGINEER, ROOM 224 MAIN AMERICAN BLDG., 100 S. BROADWAY SUFFICIENT TO COVER THE COST OF CONSTRUCTION INSPECTION AND RECORD PLANS.  
 APPROVAL OF THIS PLAN BY THE COUNTY OF LOS ANGELES DOES NOT CONSTITUTE A REPRESENTATION AS TO THE ACCURACY OF THE LOCATION OF OR THE EXISTENCE OR NON-EXISTENCE OF ANY UNDERGROUND UTILITY PIPE, OR STRUCTURE WITHIN THE LIMITS OF THIS PROJECT. THIS NOTE APPLIES TO ALL PAGES.  
 IF WORK IS TO BE DONE IN A STATE HIGHWAY, A PERMIT MUST BE OBTAINED FROM THE STATE OF CALIFORNIA, DIVISION OF HIGHWAYS, 138 SOUTH SPRING STREET.

COUNTY OF LOS ANGELES, CALIFORNIA

APPROVED, JOHN A. LAMBE, COUNTY ENGINEER  
 APPROVED, A. M. RAWN, CHIEF ENGINEER  
 BY: *[Signature]* BY: *[Signature]*  
 SANITATION ENGINEER OFFICE ENGINEER  
 CHECKED BY: *[Signature]*  
 OFFICE OF COUNTY ENGINEER, REG. C. E. NO. 14,632  
 SUBMITTED BY: *[Signature]* 6-11-58  
 LOS ANGELES REGIONAL ENGINEER REG. C. E. NO. 24,307

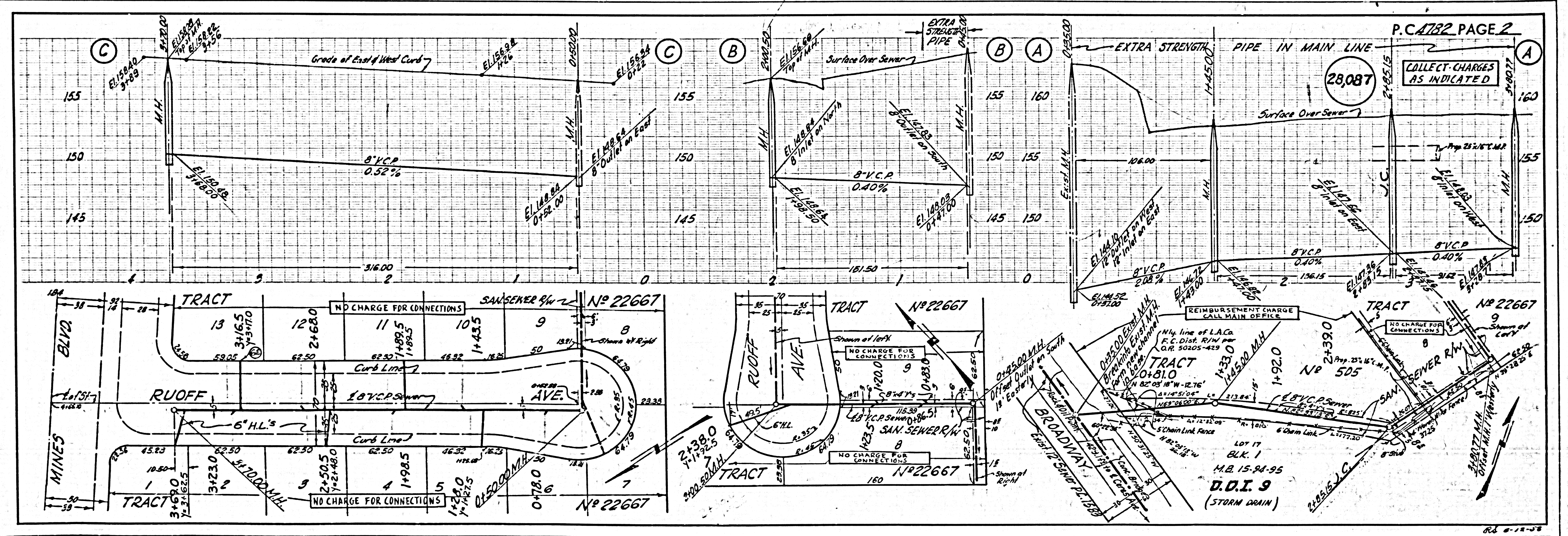

P.C. 4782 PAGE 2  
**28,087**  
 COLLECT CHARGES AS INDICATED

REIMBURSEMENT CHARGE CALL MAIN OFFICE  
 1/4 line of L.A.C. F.C. Dist. R/W per O.R. 50205-429  
 TRACT No 22667  
 133.0  
 145.00 M.H.  
 192.0  
 No 23390  
 505  
 15.94-95  
 D.D.I. 9  
 (STORM DRAIN)