

LOMITA BLDG. DIST. NO. 7.I

PROFILE ALIGNMENT AND GRADE OF P.C. 4792  
 SANITARY SEWERS PAGE 1  
 TO BE CONSTRUCTED IN

223 RD STREET

PRIVATE CONTRACT NO. 4792

W.S. 28  
 1 SHEETS, 2 PAGES

SCALE: VERT. 1" = 4'  
 HORIZ. 1" = 40'

MAY, 1958  
 PREPARED IN THE OFFICES OF  
 V.C. CASE  
 1450 ORANGE AVENUE  
 LONG BEACH, CALIFORNIA

By: *J. H. Marshall*  
 REG. C. E. NO. 3615  
 FOR LEGEND SEE PLAN NO. S-A-64

BENCH MARK: No. 23-10  
 Avalon Blvd. & 223rd St., 16' E. &  
 58' N. & Int. (Std. C.S.B.M. in hand  
 hole)  
 Elev. 27.940, Co. Eng. F.B. 1595  
 page 131.

- NOTES
- PROVIDE STAKES ON THE PROPERTY LINE OR PROPERTY LINES PRODUCED AT RIGHT ANGLES TO THE SEWER LINE AT THE CENTER LINE OF EACH MANHOLE.
  - NO REPRESENTATIVE OF THE COUNTY ENGINEER WILL SURVEY OR LAYOUT ANY PORTION OF THE WORK.
  - THE OWNER OR HIS AUTHORIZED REPRESENTATIVE SHALL FURNISH THE COUNTY ENGINEER WITH GRADE SHEETS AND STATIONING FOR ALL HOUSE LATERALS AND Y BRANCHES AND SHALL FURNISH STAKES FOR THEM AT THEIR PROPER LOCATIONS WITH STATIONING PLAINLY MARKED. ANY CHANGE IN LOCATION SHALL BE REQUESTED IN WRITING BY THE OWNER OR HIS REPRESENTATIVE.
  - NO REVISIONS SHALL BE MADE IN THESE PLANS WITHOUT THE APPROVAL OF THE COUNTY ENGINEER.
  - USE STANDARD MANHOLE FRAMES AND COVERS, S-A-117, EXCEPT AS NOTED.
  - USE STANDARD STRENGTH PIPE EXCEPT AS NOTED.
  - USE CEMENT MORTAR JOINT "WEDGE LOCK" OR "SPREAD SEAL" FOR ALL VITRIFIED CLAY PIPE JOINTS, PER SPEC. 26.4.48
  - RESURFACE ALL TRENCH WITHIN PAVED AREA TO MEET L.A. COUNTY ROAD DEPT. OR CALIF. STATE HIGHWAY DEPT. REQUIREMENTS IN ACCORDANCE WITH PERMITS.
  - ENCASE FOUR FEET OF SEWER AT POINTS OF INTERFERENCE WITH POLES, S-A-117, CASE III.
  - HOUSE LATERAL TO BE CONSTRUCTED WITH 1/2" PER FOOT TO PROPERTY LINE.
  - ALL STRUCTURES SHALL BE BRICK SEWER STRUCTURES, S-A-104, EXCEPT AS NOTED.
  - FOR ALLOWABLE LEAKAGE TEST USE FORMULA NO. 1 SPEC. 2, SEC. 8.4
  - MANHOLE TOPS IN UNIMPROVED RIGHTS-OF-WAY TO BE 4" ABOVE FINISHED GRADE.
  - THE PRIVATE ENGINEER SHALL FURNISH THE HOUSE LATERAL DEPTH AT THE PROPERTY LINE BELOW THE TOP OF CURB ELEVATION FOR EACH HOUSE LATERAL ON THE GRADE SHEETS.

NO CHARGE FOR CONNECTIONS

APPROVED:  
*L. Austin* 6-4-58

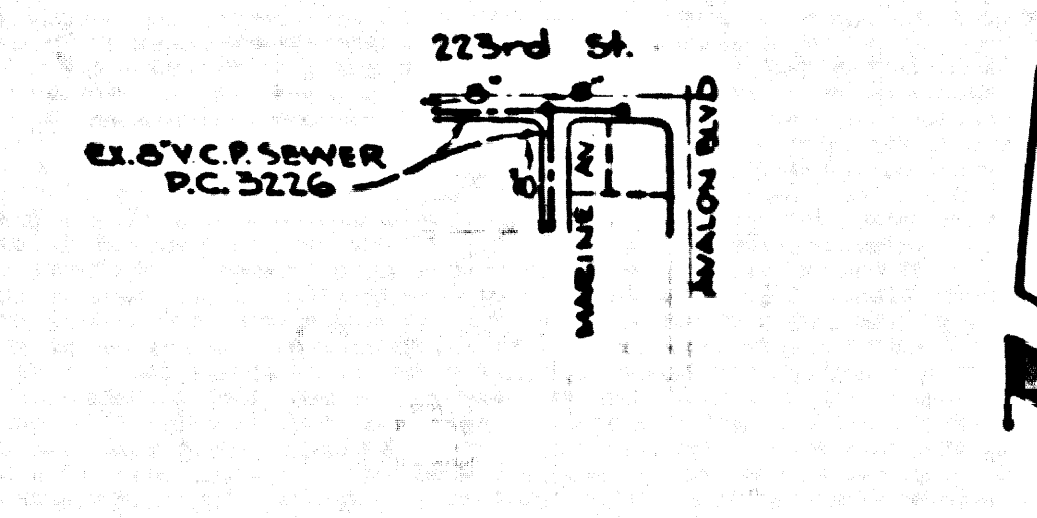

INDEX MAP  
 Scale 1" = 600'  
 223rd St. & AVALON BLVD  
 P.C. 4792

Note:  
 The contractor shall notify the construction and storm drain division by telephoning, Madison 9-4747, Ext. 362, at least 24 hours before starting any work under this contract.

REVISION  
 Revised grade between  
 Sta. 0+07 to 1+56.00  
 Col. J. H. Marshall 5-27-58

NOTES

GRADES TO WHICH THIS IMPROVEMENT IS TO BE CONSTRUCTED ARE SHOWN ON PLANS AND PROFILE. GRADE POINTS FOR TOP OF CURB, CENTER LINE OF STREETS OR CENTER LINE OF ALLEYS ARE SHOWN BY CIRCLES OR SQUARES. AT ALL POINTS BETWEEN DESIGNATED POINTS THE GRADE SHALL BE ESTABLISHED SO AS TO CONFORM TO A STRAIGHT LINE DRAWN BETWEEN SAID DESIGNATED POINTS.

ELEVATIONS ARE IN FEET ABOVE M.C. & G.S. SEA LEVEL DATUM OF 1929.

THIS DRAWING AND THE DATA HEREON ARE HEREBY MADE A PART OF THE SPECIFICATIONS.

WORK SHALL BE CONSTRUCTED ACCORDING TO SPECIFICATIONS ON FILE IN THE OFFICE OF THE COUNTY ENGINEER AND SHALL BE PROSECUTED ONLY IN THE PRESENCE OF THE COUNTY ENGINEER.

BEFORE WORK CAN BE STARTED, THE CONTRACTOR MUST OBTAIN A PERMIT TO EXCAVATE IN COUNTY STREETS FROM THE L.A. COUNTY ROAD DEPT., DISTRICT 10'S AND MAKE A REPORT WITH THE COUNTY ENGINEER, ROOM 288 PAN AMERICAN BUILDING, 223 RD. BROADWAY, SUFFICIENT TO COVER THE COST OF CONSTRUCTION INSPECTION AND RECORD PLANS.

APPROVAL OF THIS PLAN BY THE COUNTY OF LOS ANGELES DOES NOT CONSTITUTE A REPRESENTATION AS TO THE ACCURACY OF THE LOCATION OF OR THE EXISTENCE OR NON-EXISTENCE OF ANY UNDERGROUND UTILITY PIPE, OR STRUCTURE WITHIN THE LIMITS OF THIS PROJECT. THIS NOTE APPLIES TO ALL PAGES.

IF WORK IS TO BE DONE IN A STATE HIGHWAY, A PERMIT MUST BE OBTAINED FROM THE STATE OF CALIFORNIA, DIVISION OF HIGHWAYS, 120 BOWEN BRIDGE STREET.

COUNTY OF LOS ANGELES, CALIFORNIA

APPROVED, JOHN A. LAMBE, COUNTY ENGINEER  
*J. H. Marshall*  
 SANITATION DIVISION

APPROVED, A. M. RAWL, CHIEF ENGINEER  
*A. M. Rawl*  
 DIST. NO. 0  
 OFFICE ENGINEER

CHECKED BY: *J. H. Marshall* 6-4-58  
 OFFICE OF COUNTY ENGINEER, REG. C. E. NO. 3615

APPROVED BY  
 INDUSTRIAL WASTE DIVISION  
*J. H. Marshall* 5-27-58

P.C. 4792 PAGE 2

NO CHARGE FOR CONNECTIONS

26,022

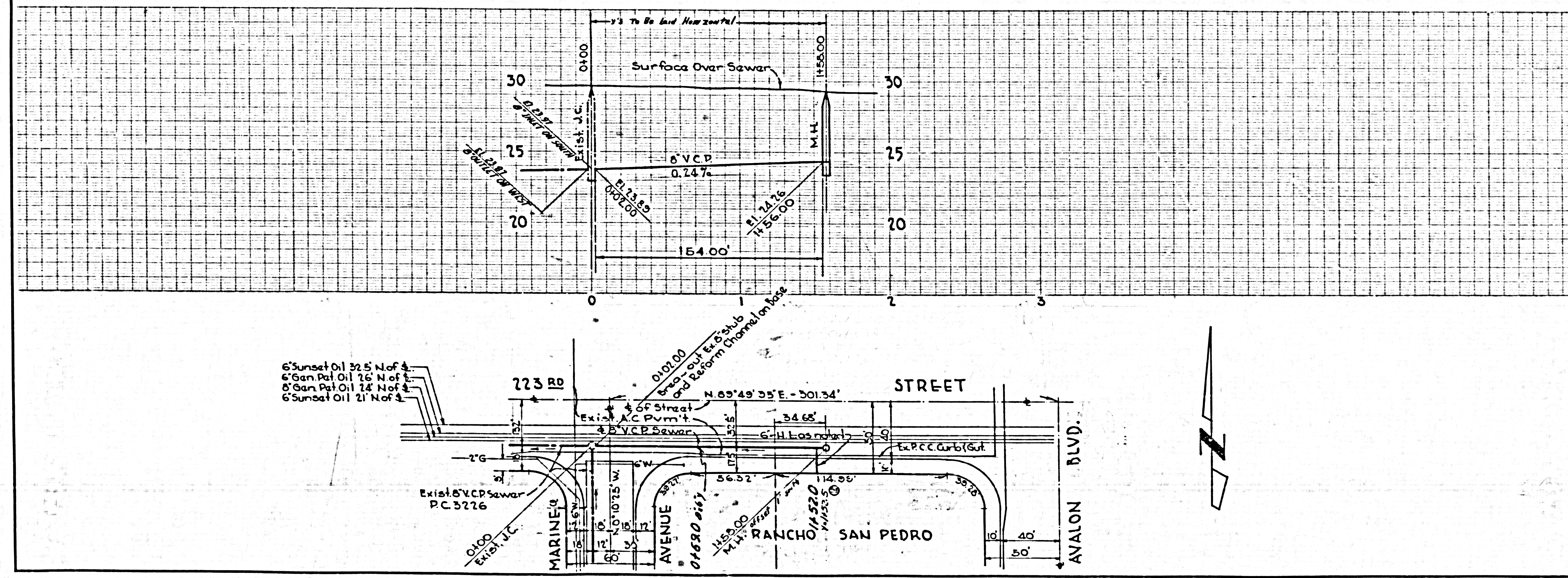

6-4-58