

NO CHARGE FOR CONNECTIONS  
L. Curtis 7-10-58

B.M. Y-149 Elev. 81.651  
L.A. Co. Road Department  
Rosecrans Avenue and Aviation  
Boulevard, N.W. Cor. in N. End of N.  
Abutment. A Copper Disk. C.E.F.B. 1391-23

P.C. No 4803  
INDEX MAP  
SCALE: 1"=300'

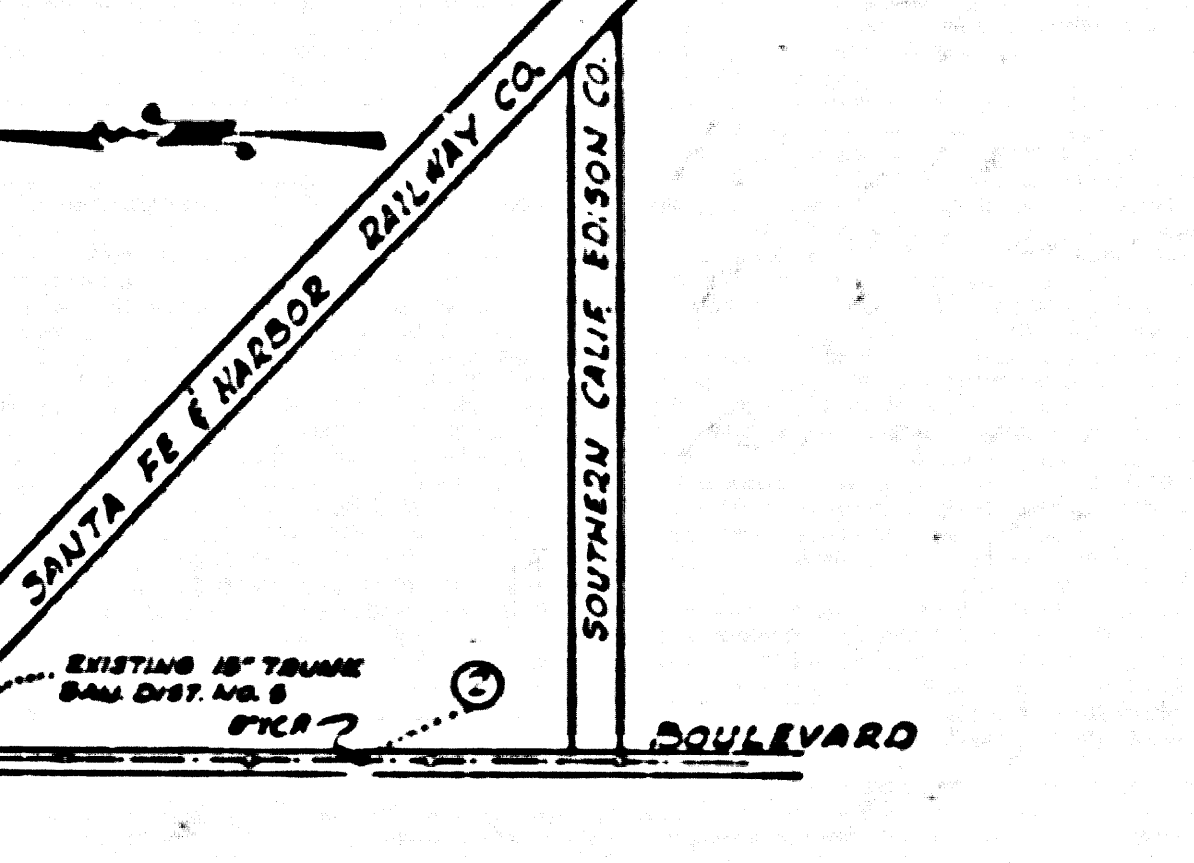

LENNOX BLDG. DIST. NO. 7

- NOTES
- PROVIDE STAKES ON THE PROPERTY LINE OR PROPERTY LINES PRODUCED AT RIGHT ANGLES TO THE SEWER LINE AT THE CENTER LINE OF EACH MANHOLE.
  - NO REPRESENTATIVE OF THE COUNTY ENGINEER WILL SURVEY OR LAYOUT ANY PORTION OF THE WORK.
  - THE OWNER OR HIS AUTHORIZED REPRESENTATIVE SHALL FURNISH THE COUNTY ENGINEER WITH GRADE SHEETS AND STATIONING FOR ALL HOUSE LATERALS AND Y BRANCHES AND SHALL PROVIDE STAKES FOR THEM AT THEIR PROPER LOCATIONS WITH STATIONING PLAINLY MARKED. ANY CHANGE IN LOCATION SHALL BE REQUESTED IN WRITING BY THE OWNER OR HIS REPRESENTATIVE.
  - NO REVISIONS SHALL BE MADE IN THESE PLANS WITHOUT THE APPROVAL OF THE COUNTY ENGINEER.
  - USE STANDARD MANHOLE FRAMES AND COVERS, SA 207, EXCEPT AS NOTED.
  - USE EXTRA STRENGTH PIPE.
  - USE CONCRETE BOSTON OR "ROBERT-LOCK" OR "SPIND-SEAL" FOR ALL V.C.P. JOINTS PER SPECS. SECS. 36 & 64B.
  - RESURFACE ALL TRENCH WITHIN PAVED AREA TO MEET L.A. COUNTY ROAD DEPT. OR CALIF. STATE HIGHWAY DEPT. REQUIREMENTS IN ACCORDANCE WITH PERMITS.
  - EXCAVE FOUR FEET OF MUDS AT POINTS OF INTERFERENCE WITH POLES, PER CALIF. ST. 9-3-17E.
  - HOUSE LATERALS TO BE CONSTRUCTED WITH 1/2" RISE PER FT. TO PROPERTY LINE.
  - THE PRIVATE OWNER SHALL FURNISH THE HOUSE LATERAL DEPTH AT THE PROPERTY LINE BELOW THE GRADE OF 6" OF STREET.
  - FOR ALLOWABLE LEAKAGE TEST USE FORMULA NO. 1 SPECS. SEC. 14.
  - THE CONTRACTOR SHALL NOTIFY THE CONSTRUCTION & STORM DRAIN DIVISION BY TELEPHONE, MADISON 94747, EXT. 462, AT LEAST 24 HRS. BEFORE STARTING ANY WORK UNDER THIS CONTRACT.

TO BE CONSTRUCTED IN  
AVIATION BLVD (PRIVATE SEWERS) 26,348

PRIVATE CONTRACT NO. 4803

W.S. 25  
SHEET 1 OF 2 PAGES

SCALE: 1"=10' HORIZ. 1"=2' VERT. MAY 1958

PREPARED IN THE OFFICES OF  
H. R. LOVETT & ASSOCIATES, INC.

By: J.A. Patterson  
REG. C. E. NO. 10410

FOR LEGEND SEE PLAN NO. S-A-64

NOTE: GRADES TO WHICH THIS IMPROVEMENT IS TO BE CONSTRUCTED ARE SHOWN ON PLANS AND PROFILES. GRADE POINTS FOR TOP OF CURBS, CENTER LINE OF STREETS, OR CENTER LINE OF ALLEYS ARE SHOWN BY CIRCLES ON PROFILES AT ALL POINTS BETWEEN DESIGNATED POINTS. THE GRADE SHALL BE ESTABLISHED SO AS TO CONFORM TO A STRAIGHT LINE DRAWN BETWEEN SAID DESIGNATED POINTS. ELEVATIONS ARE IN FEET ABOVE U.S.C. & G.S. MEAN LEVEL. DEPTUM DIV. 75-2-25. THIS DRAWING AND THE DATA HEREON ARE HEREBY MADE A PART OF THE SPECIFICATIONS. WORK SHALL BE CONSTRUCTED ACCORDING TO SPECIFICATIONS ON FILE IN THE OFFICE OF THE COUNTY ENGINEER AND SHALL BE PROSECUTED ONLY IN THE PRESENCE OF THE COUNTY ENGINEER. BEFORE WORK CAN BE STARTED THE CONTRACTOR MUST OBTAIN A PERMIT TO EXCAVATE IN COUNTY STREETS FROM THE L.A. COUNTY ROAD DEPT., DIST. NO. 3, AND MAKE A REPORT WITH THE COUNTY ENGINEER, ROOM 320 PAV. AMERICAN BLDG. 333 SO. BROADWAY SUFFICIENT TO COVER THE COST OF CONSTRUCTION INSPECTION AND RECORD PLANS. APPROVAL OF THIS PLAN BY THE COUNTY OF LOS ANGELES DOES NOT CONSTITUTE A REPRESENTATION AS TO THE ACCURACY OF THE LOCATION OF OR ITS EXISTENCE OR NON-EXISTENCE OF ANY UNDERGROUND UTILITY PIPE, OR STRUCTURE WITHIN THE LIMITS OF THIS PROJECT. THIS NOTE APPLIES TO ALL PAGES. IF WORK IS TO BE DONE ON A STATE HIGHWAY, A PERMIT MUST BE OBTAINED FROM THE STATE OF CALIFORNIA, DIVISION OF HIGHWAYS, 120 SOUTH SPRING STREET.

COUNTY OF LOS ANGELES, CALIFORNIA

APPROVED, JOHN A. LAMETZ, COUNTY ENGINEER  
APPROVED, A. M. RAWIN, CHIEF ENGINEER  
BY: [Signature] SANITATION ENGINEER  
BY: [Signature] OFFICE ENGINEER  
CHECKED BY: [Signature] 7-11-58  
OFFICE OF COUNTY ENGINEER, REG. C. E. NO. 9406  
APPROVED BY: [Signature] INDUSTRIAL WASTE DIVISION  
BY: [Signature] DATE 6/10/58  
BY: [Signature] DATE 7/11/58

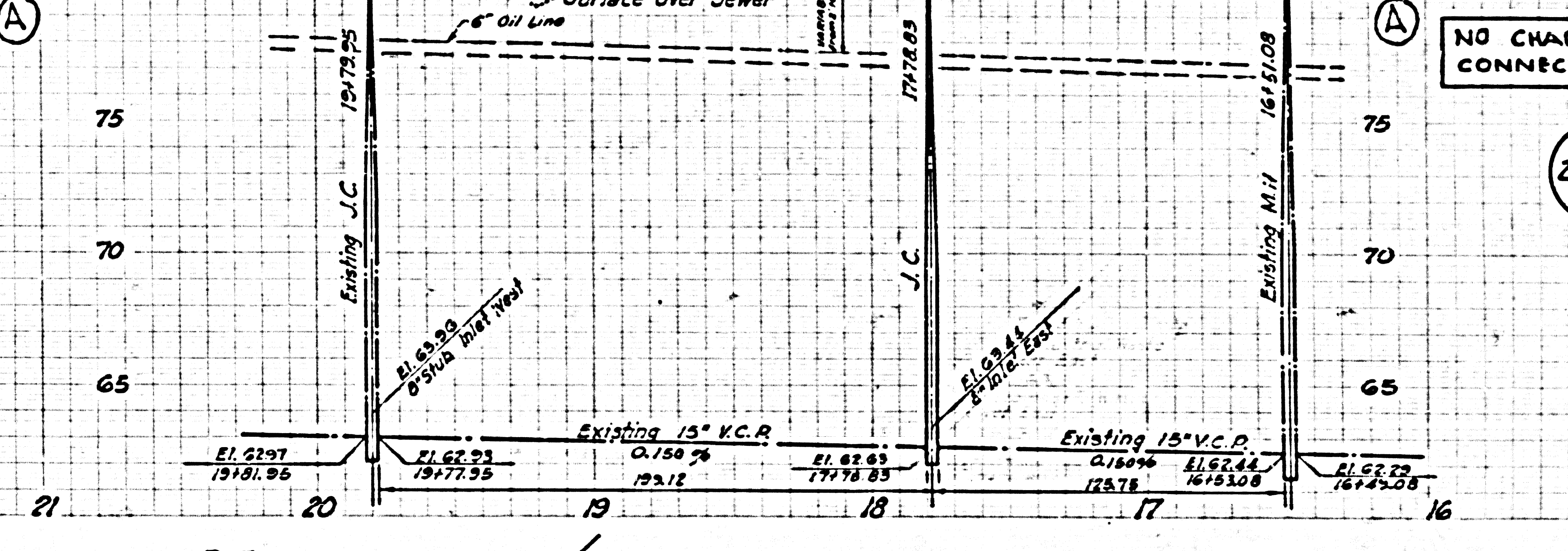
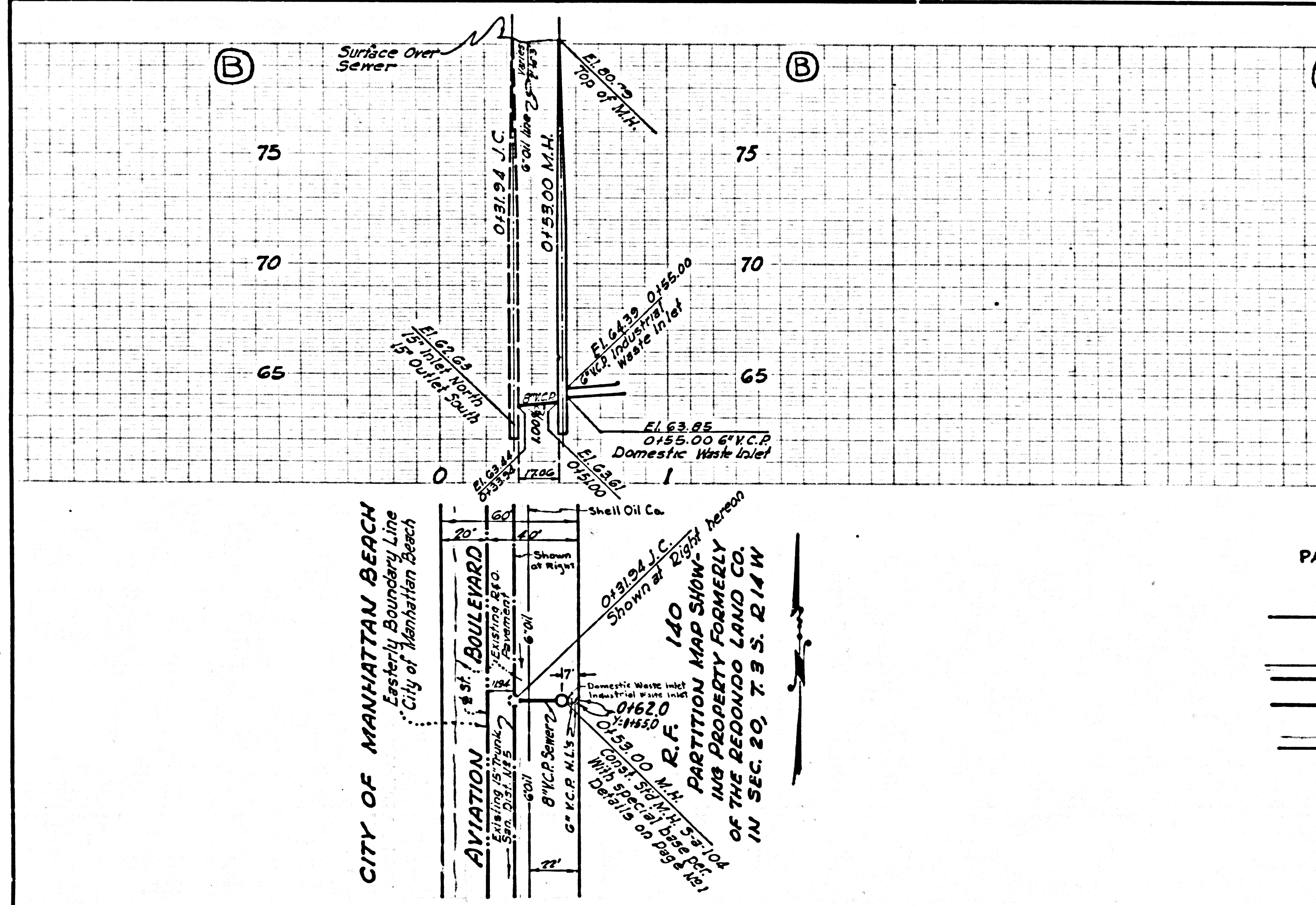

NO CHARGE FOR CONNECTIONS  
26,349

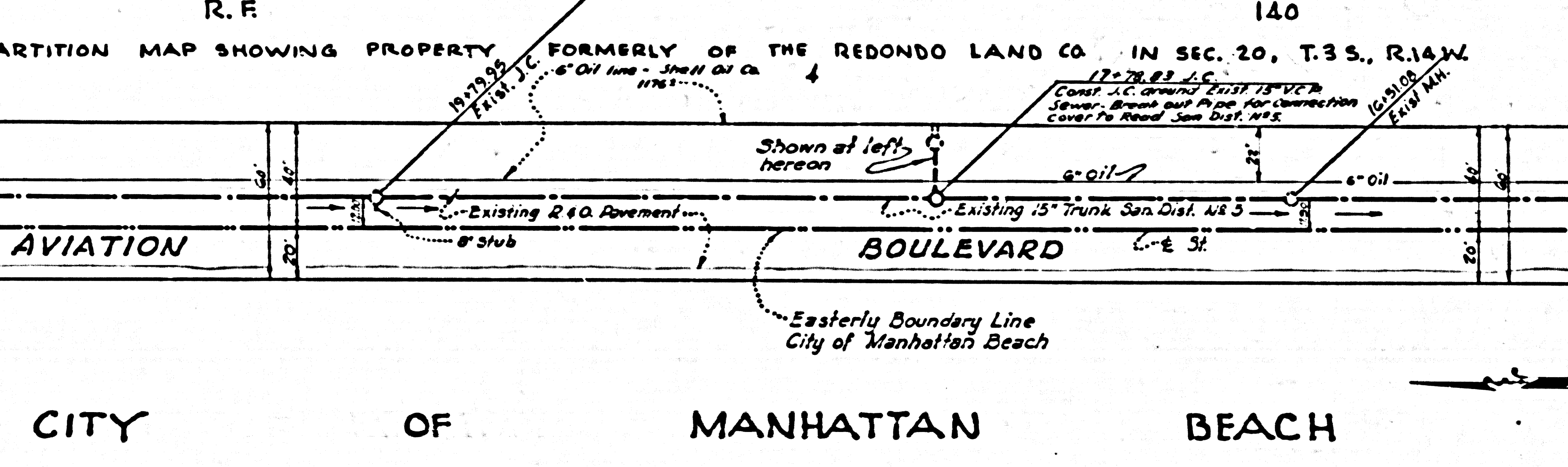
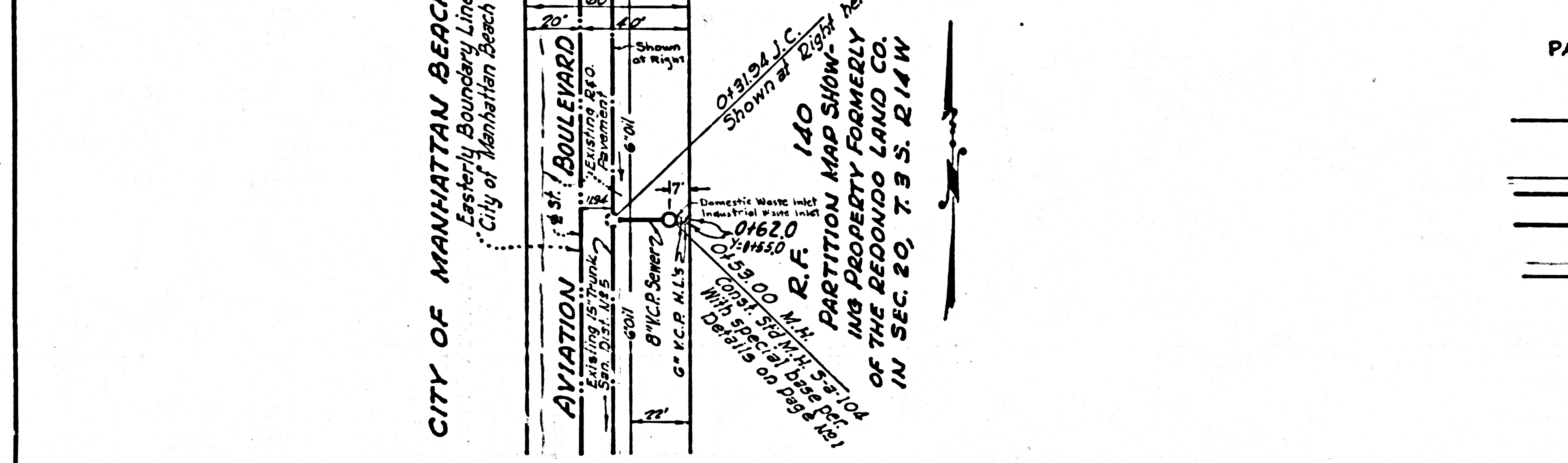

CITY OF MANHATTAN BEACH

P.C. 4803