

B. M. C-1 Elev. 66.681' F. B. 878 Pg. 115  
 E. Side of Overland Ave. in front of House No 4182  
 12' So. of So. Prop. Line of Bldg. Site  
 B.P. Spike in Curb

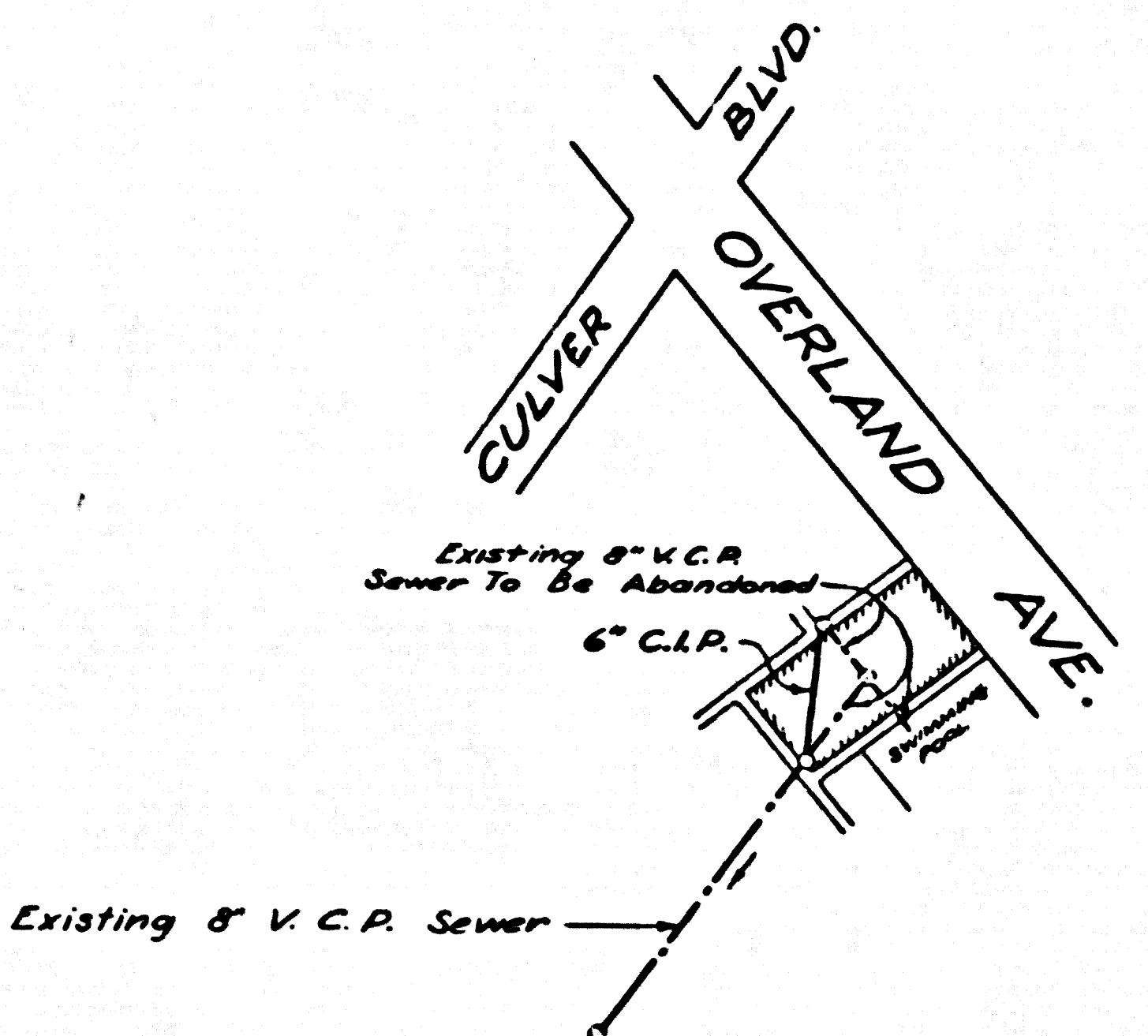

Index Map  
 Scale 1" = 200'  
 P. C. No 4805  
 Job No 0814.19

ALL CONSTRUCTION SHALL BE DONE UNDER LOS ANGELES COUNTY SPECIFICATIONS AS OF JUNE 1957.

USE 6" WATER CAST IRON PIPE (BELL & SPIGOT) No WW-P-421.

ALL JOINTS TO BE LEAD CAULKED PER SEC. 48 OF SPECIFICATIONS.

ALL STRUCTURES SHALL BE BRICK SEWER STRUCTURES AS PER PLAN NO. S-A-104, EXCEPT AS NOTED.

USE STANDARD MANHOLE FRAMES AND COVERS AS PER PLAN NO. S-A-112, EXCEPT AS NOTED.

RESURFACE TRENCH WITHIN CONCRETE PAVED AREA TO MEET CULVER CITY REQUIREMENTS

USE FORMULA NO. 1 SEC. 54 OF SPECIFICATIONS TO COMPUTE ALLOWABLE LEAKAGE

THE CONTRACTOR SHALL NOTIFY THE CONSTRUCTION AND STORM DRAIN DIVISION BY TELEPHONE MADISON 9-4747, EXT. 362 AT LEAST 24 HOURS BEFORE STARTING ANY WORK UNDER THIS CONTRACT.

THE CONTRACTOR SHALL OBTAIN ALL NECESSARY PERMITS REQUIRED BY CULVER CITY. AS NOTED.

FIGURES IN CIRCLES AT ENDS OF HOUSE LATERALS INDICATE DEPTH BELOW CURB GRADE, OR GRADE OF CENTER LINE OF STREET.

FIGURES IN CIRCLES AT ENDS OF HOUSE LATERALS INDICATE HOUSE LATERALS SHALL BE CONSTRUCTED WITH W-RISE PER FOOT TO PROPERTY LINE.

WORDS IN CIRCLES AT ENDS OF HOUSE LATERALS INDICATE THEY SHALL BE LAID HORIZONTAL AND HOUSE LATERALS SHALL BE CONSTRUCTED WITH W-RISE PER FOOT TO PROPERTY LINE.

CONSTRUCTION IN STATE HIGHWAYS SHALL CONFORM WITH STATE HIGHWAY PERMIT.

Note:  
 Approval of this plan by the County of Los Angeles does not constitute a representation as to the accuracy of the location of or existence or non-existence of any underground utility pipe, or structure within the limits of this project. This note applies to all sheets.

P. C. 4805  
 JOB NO. 0814.19

PROFILE, ALIGNMENT AND GRADE OF  
 SANITARY SEWERS  
 TO BE CONSTRUCTED IN

CULVER CITY BRANCH LIBRARY SITE

PAGE 1 OF 2 PAGES

SCALE VERT. 1" = 4 FT.  
 HORIZ. 1" = 40 FT. JUNE, 1958

COUNTY OF LOS ANGELES, CALIFORNIA

JOHN A. LAMBIE COUNTY ENGINEER

SUBMITTED *[Signature]* APPROVED *[Signature]*  
 ALLIANCE ENGINEERING ENGINEER SANITATION ENGINEER

APPROVED *[Signature]*  
 CITY ENGINEER CULVER CITY

FOR LEGEND  
 SET PLAN NO. S-A-66

NOTE:  
 GRADES TO WHICH THIS IMPROVEMENT IS TO BE CONSTRUCTED ARE SHOWN ON PLANS AND PROFILES. GRADE POINTS FOR TOP OF CURB, CENTER LINE OF STREET OR CENTER LINE OF ALLEY ARE SHOWN BY CIRCLES ON PROFILES. AT ALL POINTS BETWEEN DESIGNATED POINTS THE GRADE SHALL BE ESTABLISHED SO AS TO CONFORM TO A STRAIGHT LINE DRAWN BETWEEN SAID DESIGNATED POINTS.  
 ELEVATIONS ARE IN FEET ABOVE U. S. C. & G. S. MEAN SEVER BARS AS OF 1929  
 UNIT PRICES FOR ADDITIONAL WORK WHICH MAY BE REQUIRED BUT WHICH CANNOT BE ASCERTAINED IN ADVANCE, SHALL BE SUBMITTED IN THE PROPOSAL.  
 THIS DRAWING AND THE DATA HEREON ARE HEREBY MADE A PART OF THE SPECIFICATIONS

REFERENCES		
W. S. 23	DESIGNED	S. V. Grimaldi JUNE 1958
A. B.	TRACED	S. V. Grimaldi JUNE 1958
F. B. 878 PG. 115	CHECKED	G. W. Kriegel JUNE 1958

P. C. 4805 PAGE 2

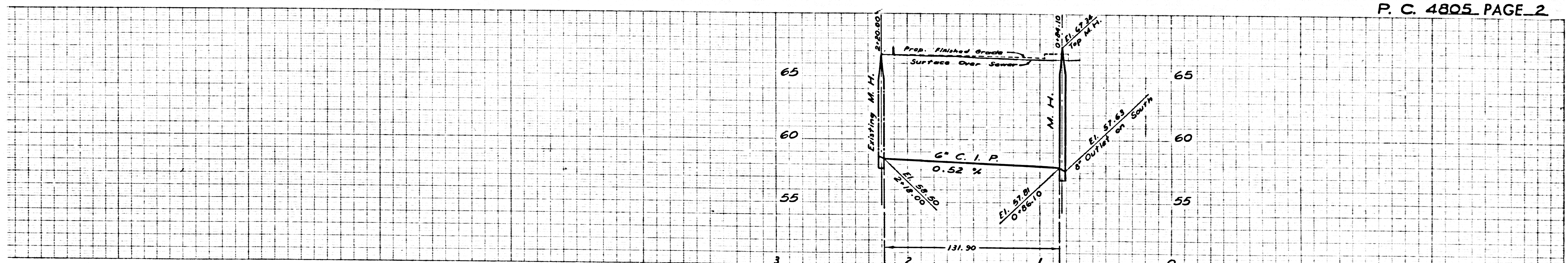

Note:  
 Service to Manhole at Sta. 2+20.00  
 Shall be Maintained at All Times.  
 This Manhole Serves the Public Auditorium.

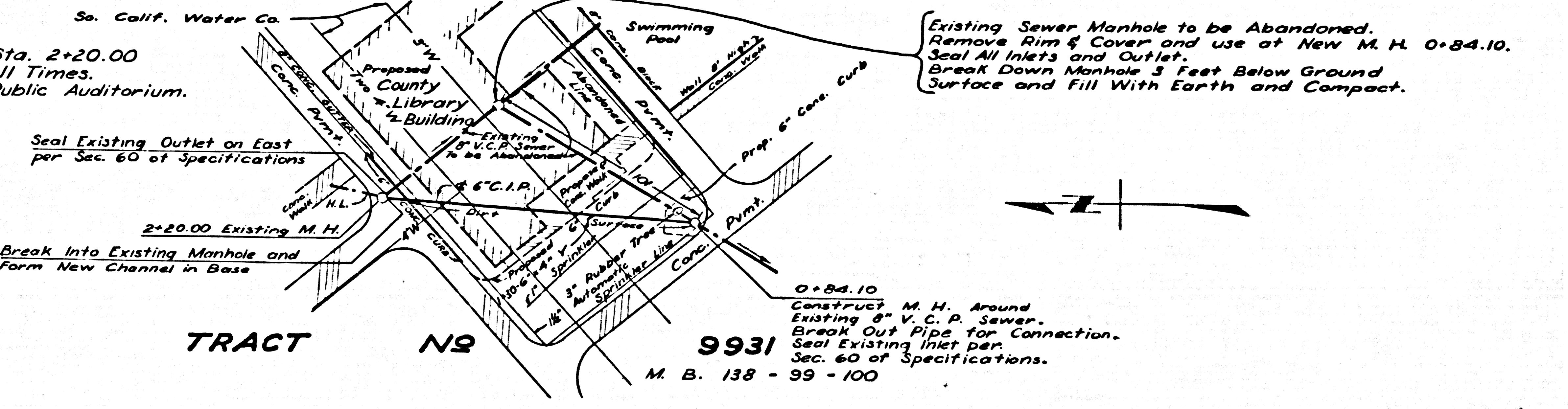

0+84.10  
 Construct M.H. Around Existing 8" V.C.P. Sewer. Break Out Pipe for Connection. Seal Existing Inlet per Sec. 60 of Specifications.

M. B. 138 - 99 - 100

Topo. & X- Sec F. B. 878 -122-134

U.S. 08 6-24-58

*[Signature]*  
 6-24-58