

WHITTIER BLDG. DIST. NO. 11

PROFILE ALIGNMENT AND GRADE OF P.C. 4817
 SANITARY SEWERS PAGE 1
 TO BE CONSTRUCTED IN
MULBERRY DRIVE 26,282

PRIVATE CONTRACT NO. 4817
 W.S. 34
 1 SHEET, 2 PAGES
 SCALE: VERT. 1" = 4'
 HORIZ. 1" = 40'
 MAY, 1958
 PREPARED IN THE OFFICES OF
KEMMERS & ENGINEERING CO., INC.
 BY: Wm. C. Thomas
 REG. C. E. NO. 26282

- NOTES:
- PROVIDE STAKES ON THE PROPERTY LINE OR PROPERTY LINES PRODUCED AT RIGHT ANGLES TO THE SEWER LINE AT THE CENTER LINE OF EACH MANHOLE.
 - NO REPRESENTATIVE OF THE COUNTY ENGINEER WILL SURVEY OR LAY OUT ANY PORTION OF THE WORK.
 - THE OWNER OR HIS AUTHORIZED REPRESENTATIVE SHALL FURNISH THE COUNTY ENGINEER WITH GRADE SHEETS AND STATION FOR ALL HOUSE LATERALS AND Y BRANCHES AND SHALL PROVIDE STAKES FOR THEM AT THEIR PROPER LOCATIONS WITH STATIONING PLANTY MARKERS. ANY CHANGE IN LOCATION SHALL BE REQUESTED IN WRITING BY THE OWNER OR HIS REPRESENTATIVE.
 - NO IMPROVEMENTS SHALL BE MADE IN THESE PLANS WITHOUT THE APPROVAL OF THE COUNTY ENGINEER.
 - USE STANDARD MANHOLE FRAMES AND COVERS, S.A.-117, 20077-22-10000.
 - USE STANDARD STRENGTH PIPE 8" DIA. 40' LENGTH.
 - USE CEMENT MORTAR "B-2008 LOCK" OR "B-2008 SEAL" FOR ALL WITHEDED CLAY PIPE JOINTS PER SPEC. SEC. 11.
 - RESURFACE ALL TRUCKS WITHIN PAVED AREA TO MEET L. A. COUNTY ROAD DEPT. OR CALIF. STATE HIGHWAY DEPT. REQUIREMENTS IN ACCORDANCE WITH PERMITS.
 - ENCASE FOUR FEET OF SEWER AT POINTS OF INTERFERENCE WITH POLES, S.A.-178 CASE III.
 - HOUSE LATERALS TO BE CONSTRUCTED WITH INVERTS AT PROPERTY LINE 4' FEET BELOW GRADE OF CENTERLINE OF STREET.
 - ALL STRUCTURES SHALL BE BRICK SEWER STRUCTURES, S.A.-104, 20077-22-10000.
 - FOR ALLOWABLE LEAKS SEE TEST USE FORMULA NO. 1, SPEC. SEC. 11.
 - MANHOLE TOPS IN UNIMPROVED HIGHWAYS TO BE 4" ABOVE FINISHED GRADE.
 - THE PRIVATE ENGINEER IS TO FURNISH THE HOUSE LATERAL DEPTH AT THE PROPERTY LINE BELOW THE ELEVATION OF CENTERLINE OF STREET FOR EACH HOUSE LATERAL, ON THE BANDO SHEET.
 - THE CONTRACTOR SHALL NOTIFY THE CONSTRUCTION AND STORM DRAIN DIVISION BY TELEPHONE IMMEDIATELY 24 HRS. PRIOR TO AT LEAST 24 HOURS BEFORE STARTING ANY WORK UNDER THIS CONTRACT.

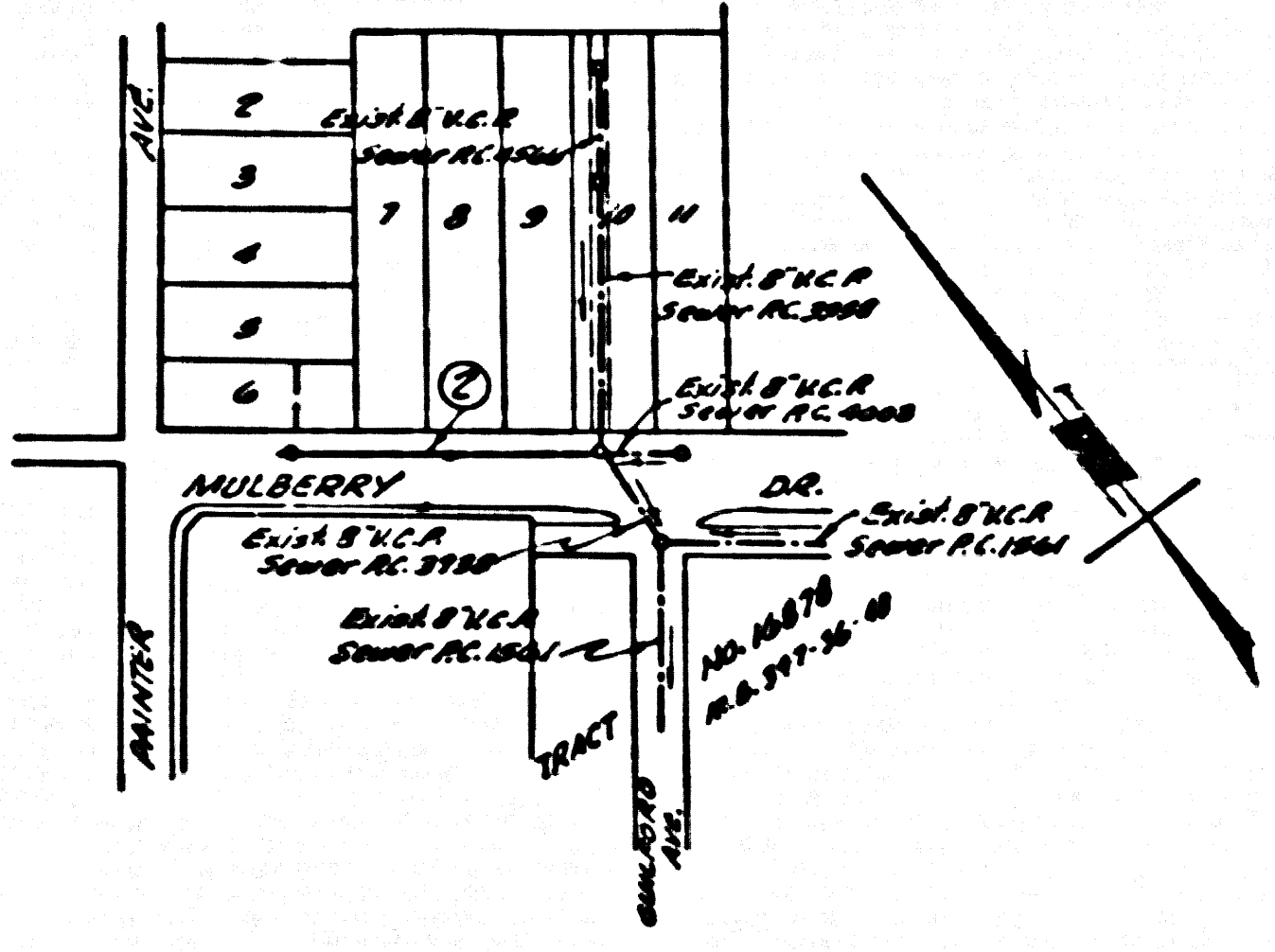

INDEX MAP
 R.C. 4817 Scale: 1" = 300'

B. M. S.V. 1198 L. & T. in No. end of CONC. step of house # 9180 85' E. N. of Mulberry 855' E. of Painter Ave. E.L. 149.934 1254 Adj.

NO CHARGE FOR CONNECTIONS
W.C. Thomas

NOTE:
 GRADES TO WHICH THIS IMPROVEMENT IS TO BE CONSTRUCTED ARE SHOWN ON PLANS AND PROFILES. GRADE POINTS FOR 100' OF CURB, CENTER LINE OF STREET, OR CENTER LINE OF ALLEYS ARE SHOWN BY CIRCLES ON PROFILES. AT ALL POINTS BETWEEN DESIGNATED POINTS THE GRADE SHALL BE ESTABLISHED SO AS TO COMPOSE TO A STEADY LINE BETWEEN SAID DESIGNATED POINTS.
 ELEVATIONS ARE IN FEET ABOVE U.S.C. & G.S. SEA LEVEL, DATUM OF 1929.
 THIS DRAWING AND THE DATA HEREON ARE HEREBY MADE A PART OF THE SPECIFICATIONS.
 WORK SHALL BE CONSTRUCTED ACCORDING TO SPECIFICATIONS ON FILE IN THE OFFICE OF THE COUNTY ENGINEER AND SHALL BE PROSECUTED ONLY IN THE PRESENCE OF THE COUNTY ENGINEER.
 BEFORE WORK CAN BE STARTED, THE CONTRACTOR MUST OBTAIN A PERMIT TO EXCAVATE IN COUNTY STREETS FROM THE L. A. COUNTY ROAD DEPT., 207707, AND MAKE A DEPOSIT WITH THE COUNTY ENGINEER, ROOM 334 PAN AMERICAN BUILDING, 333 SO. BROADWAY, SUFFICIENT TO COVER THE COST OF CONSTRUCTION INSPECTION & RECORD PLANS.
 APPROVAL OF THIS PLAN BY THE COUNTY OF LOS ANGELES DOES NOT CONSTITUTE A REPRESENTATION AS TO THE ACCURACY OF THE LOCATION OF OR THE EXISTENCE OR NON-EXISTENCE OF ANY UNDERGROUND UTILITY PIPE, OR STRUCTURE WITHIN THE LIMITS OF THIS PROJECT. THIS NOTE APPLIES TO ALL PAGES.
 IF WORK IS TO BE DONE IN A STATE HIGHWAY, A PERMIT MUST BE OBTAINED FROM THE STATE OF CALIFORNIA, DIVISION OF HIGHWAYS, 128 SOUTH SPRING STREET.

COUNTY OF LOS ANGELES, CALIFORNIA
 APPROVED, JOHN A. LAMBE, COUNTY ENGINEER
 APPROVED, A. M. BAWN, CHIEF ENGINEER
 BY: W.C. Thomas LAMINATION ENGINEER
 BY: W.C. Thomas OFFICE ENGINEER
 CHECKED BY: W.C. Thomas
 OFFICE OF COUNTY ENGINEER, REG. C. E. NO. 26282
 SUBMITTED BY: John L. Estlin 7-9-58
 LOS CERRITOS REGIONAL ENGINEER REG. C. E. NO. 26271

P.C. 4817 PAGE 2

NO CHARGE FOR CONNECTIONS

26,283

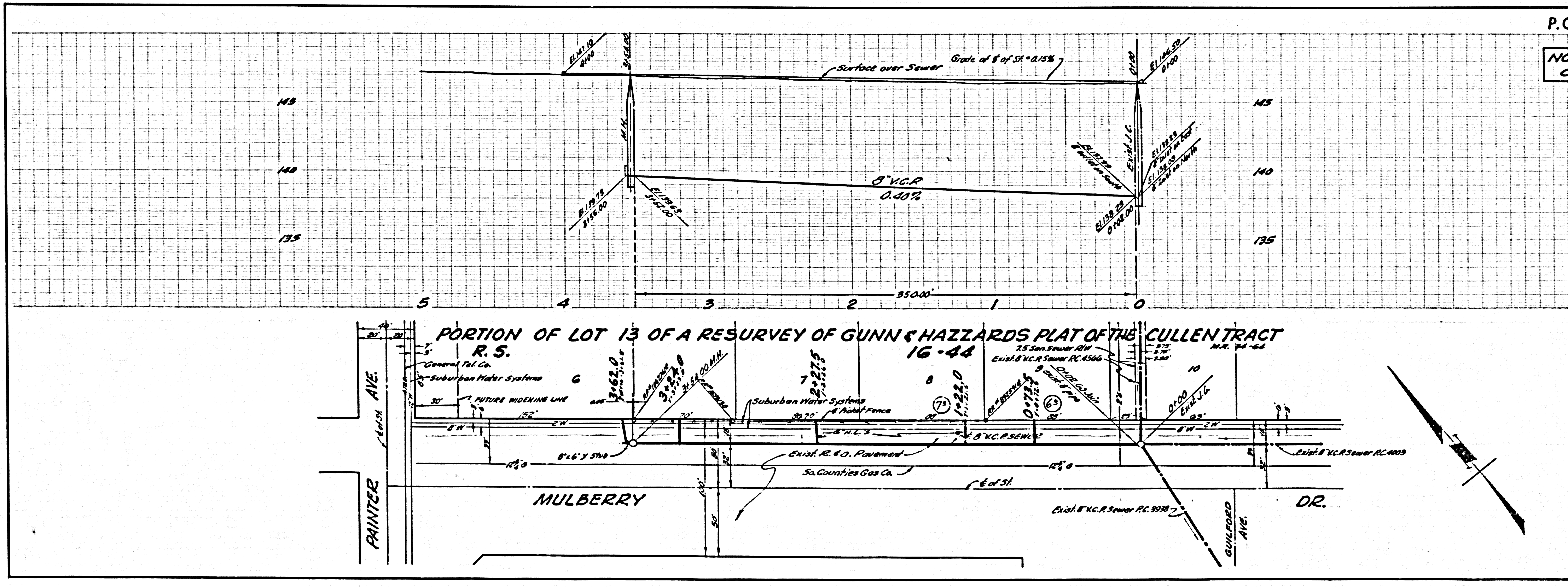

W.C. Thomas