

TEMPLE CITY BLDG. DIST. NO. 5

PROFILE ALIGNMENT AND GRADE OF P.C. 4872
 SANITARY SEWERS PAGE 1
 TO BE CONSTRUCTED IN

DEL MAR AVENUE
 AT POTRERO GRANDE ROAD

26,635

PRIVATE CONTRACT NO. 4872

W.S. 36

1 SHEET, 2 PAGES

SCALE: VERT. 1" = 4' HORIZ. 1" = 40'

AUG. 1938

PREPARED IN THE OFFICES OF

KEMMERER ENGINEERING CO., INC.

By Kana C. Sherman
 REG. C. E. NO. 2444

FOR LEGEND SEE PLAN NO. S-A-64

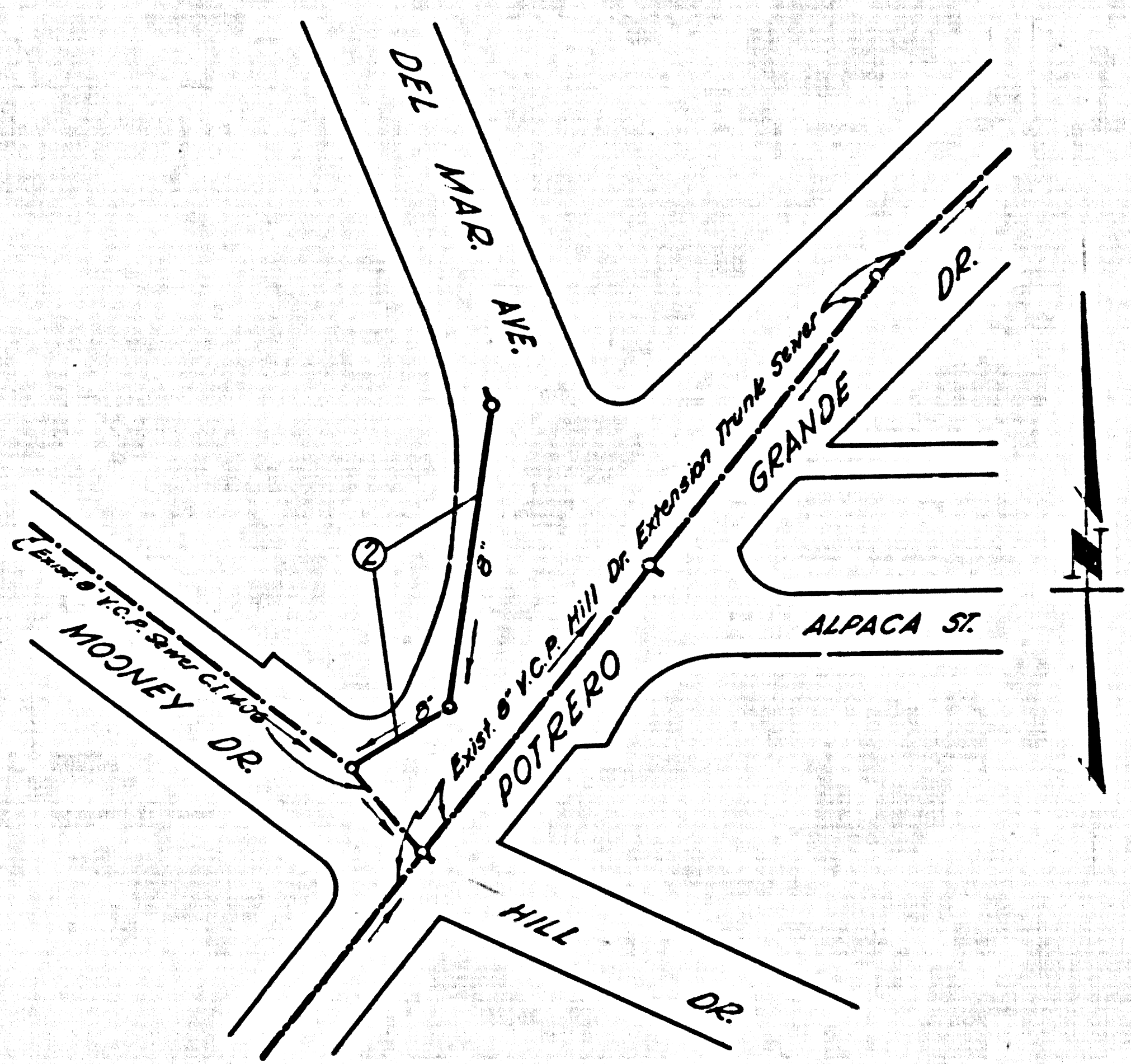

INDEX MAP
 P.C. 4872 Scale: 1" = 100'

B.M. S.X. 3333 Co. Sur. Datum Elev. 342.62
 (1935) Fd. L. & B. nail 5a end conc. hole,
 ± 20' E'ly. & Potrero Grande Dr. ± 250' So
 of Hill Dr. (Rivers Quad)

- NOTES
- PROVIDE STAKES ON THE PROPERTY LINE OR PROPERTY LINES PRODUCED AT 8' HIGH ANGLES TO THE NEWLY LINED AT THE CENTER LINE OF EACH MANHOLE.
 - NO REPRESENTATIVE OF THE COUNTY ENGINEER WILL SURVEY OR LAYOUT ANY PORTION OF THE WORK.
 - THE OWNER OR HIS AUTHORIZED REPRESENTATIVE SHALL FURNISH THE COUNTY ENGINEER WITH GRADE SHEETS AND STATION FOR ALL HOUSE LATERALS AND T BRANCHES AND SHALL PROVIDE STAKES FOR 1000' AS THESE FROM LOCATIONS WITH STATIONING PLAINLY MARKED. ANY CHANGE IN LOCATION SHALL BE REQUESTED IN WRITING BY THE OWNER OR HIS REPRESENTATIVE.
 - NO REVISIONS SHALL BE MADE IN THESE PLANS WITHOUT THE APPROVAL OF THE COUNTY ENGINEER.
 - USE STANDARD MANHOLE FRAMES AND COVERS, S.A.-117.
 - USE STANDARD STRENGTH PIPE.
 - USE CEMENT MORTAR "WEDGE JOINT" OR "SPREAD-BED" FOR ALL JOINTS IN PIPE JOINTS, PER SAN. SEC. 20-6-48.
 - RESURFACE ALL TRENCH WITHIN PAVED AREA TO MEET L. A. COUNTY ROAD DEPT. OR CALIF. STATE HIGHWAY DEPT. REQUIREMENTS IN ACCORDANCE WITH PERMITS.
 - ENCASE FOUR FEET OF SEWER AT POINTS OF INTERFERENCE WITH POLES, S.A.-178 CASE 37.
 - HOUSE LATERALS TO BE CONSTRUCTED WITH INVERTS AT PROPERTY LINE, 6" BELOW FINISH GRADE OF STREET.
 - 7/4 STRUCTURES SHALL BE SINCE SEWER STRUCTURES, S.A.-104.
 - FOR ALLOWABLE SLOPES USE THE FORMULA: NO. _____, SPEC. SEC. 84.
 - MANHOLE TOPS IN UNIMPROVED AREAS TO BE 4" ABOVE FINISH GRADE.
 - THE PRIVATE ENGINEER IS TO FURNISH THE HOUSE LATERAL DEPTH AT THE PROPERTY LINE BELOW THE 6" OF SET-ELLEVATION FOR EACH HOUSE LATERAL ON THE GRADE SHEET.
 - THE CONTRACTOR SHALL NOTIFY THE CONSTRUCTION & STORM DRAIN DIVISION BY TELEPHONE, MAILBOX 6-4742, EXT. 882 AT LEAST 24 HOURS BEFORE STARTING ANY WORK UNDER THIS CONTRACT.

NO CHARGE FOR CONNECTIONS
B. M. Cadwell 15-1938

NOTES

GRADES TO WHICH THIS IMPROVEMENT IS TO BE CONSTRUCTED ARE SHOWN ON PLANS AND PROFILE. GRADE POINTS FOR TOP OF CURB, CENTER LINE OF STREET, OR CENTER LINE OF ALLEYS ARE SHOWN BY CIRCLES ON PROFILES. SET ALL POINTS BETWEEN INFORMATION POINTS. THE GRADE SHALL BE ESTABLISHED SO AS TO CONFORM TO A STRAIGHT LINE DRAWN BETWEEN SAID DESIGNATED POINTS.

ELEVATIONS ARE IN FEET ABOVE U.S.C. & G.S. MEAN LEVEL, DATUM OF 1929.

THIS DRAWING AND THE DATA HEREON ARE HEREBY MADE A PART OF THE SPECIFICATIONS.

WORK SHALL BE CONSTRUCTED ACCORDING TO SPECIFICATIONS ON FILE IN THE OFFICE OF THE COUNTY ENGINEER AND SHALL BE PROSECUTED ONLY IN THE PRESENCE OF THE COUNTY ENGINEER.

BEFORE WORK CAN BE STARTED, THE CONTRACTOR MUST OBTAIN A PERMIT TO EXCAVATE IN COUNTY STREETS FROM THE L. A. COUNTY ROAD DEPT., DISTRICT 7, M.L.E. AND MAKE A DEPOSIT WITH THE COUNTY ENGINEER, ROOM 324 SAN AMERICAN BUILDING, 232 3/4 BROADWAY, SUFFICIENT TO COVER THE COST OF CONSTRUCTION INSPECTION AND RECORD PLANS.

APPROVAL OF THIS PLAN BY THE COUNTY OF LOS ANGELES DOES NOT CONSTITUTE A REPRESENTATION AS TO THE ACCURACY OF THE LOCATION OR OF THE EXISTENCE OR NON-EXISTENCE OF ANY UNDERGROUND UTILITY PIPE, OR STRUCTURE WITHIN THE LIMITS OF THIS PROJECT. THIS NOTE APPLIES TO ALL PAGES.

IF WORK IS TO BE DONE IN A STATE HIGHWAY, A PERMIT MUST BE OBTAINED FROM THE STATE OF CALIFORNIA, DIVISION OF HIGHWAYS, 126 SOUTH BRINDLEY STREET.

COUNTY OF LOS ANGELES, CALIFORNIA

APPROVED, JOHN A. LAMBE, COUNTY ENGINEER

APPROVED, C. E. Conroy, CHIEF ENGINEER

BY Edith Hughes SANITATION ENGINEER

BY G. J. Posthumus OFFICE ENGINEER

CHECKED BY W. W. Quinn

OFFICE OF COUNTY ENGINEER, REG. C. E. NO. 2444

SUBMITTED BY K. F. Brander
 SAN GABRIEL VALLEY REGIONAL ENGINEER

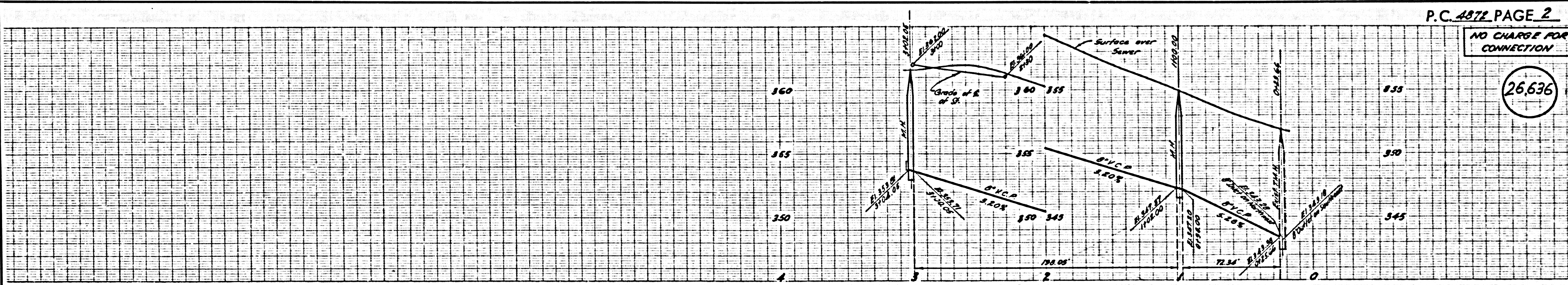

P.C. 4872 PAGE 2

NO CHARGE FOR CONNECTION

26,635

