

# LENNOX BLDG. DIST. NO. 7

# CAPITAL PROJECT NO. 8848.14

PROFILE, ALIGNMENT AND GRADE OF  
SANITARY SEWERS

27952

## ATHENS PARK AND OTHER RIGHTS OF WAY PRIVATE CONTRACT NO. 4876 PAGE 1 OF 3 PAGES

SCALE: VERT. 1" = 4 FT.  
HORIZ. 1" = 40 FT.  
OCTOBER, 1958  
COUNTY OF LOS ANGELES, CALIFORNIA

JOHN A. LAMBIE COUNTY ENGINEER

SUBMITTED: *[Signature]* APPROVED: *[Signature]*

C. R. COMPTON  
COUNTY ENGINEER OF COUNTY  
SANITATION DISTRICT NO. 1

FOR LEGEND  
SEE PLAN NO. S-A-44

NOTE: GRADES TO WHICH THIS IMPROVEMENT IS TO BE CONSTRUCTED ARE SHOWN ON PLANS AND PROFILES. GRADE POINTS FOR TOP OF CURB, CENTER LINE OF STREET OR CENTER LINE OF ALLEY ARE SHOWN BY CIRCLES ON PROFILES. AT ALL POINTS BETWEEN REGULARLY SPACED POINTS THE GRADE SHALL BE ESTABLISHED SO AS TO COMFORM TO A SMOOTH LINE BEYOND WHICH SAID SPACED POINTS. ELEVATIONS ARE IN FEET ABOVE U.S.C. & G.S. SEA LEVEL DATUM OF 1929. SURVEY POINTS FOR ADDITIONAL WORK WHICH MAY BE REQUIRED BUT WHICH CANNOT BE ASCERTAINED IN ADVANCE, SHALL BE SHOWN BY THE PROFILES. THIS DRAWING AND THE DATA HEREON ARE HEREBY MADE A PART OF THE SPECIFICATIONS.

| REFERENCES    | DESIGNED | WYTTN       | Oct 1958 |
|---------------|----------|-------------|----------|
| W.S. 26 B-C-2 | TRACED   | WYTTN       | Oct 1958 |
| A.B. 95-14    | CHECKED  | G.W. KRIEGL | Jan 1959 |
| F.B. 115      |          |             |          |

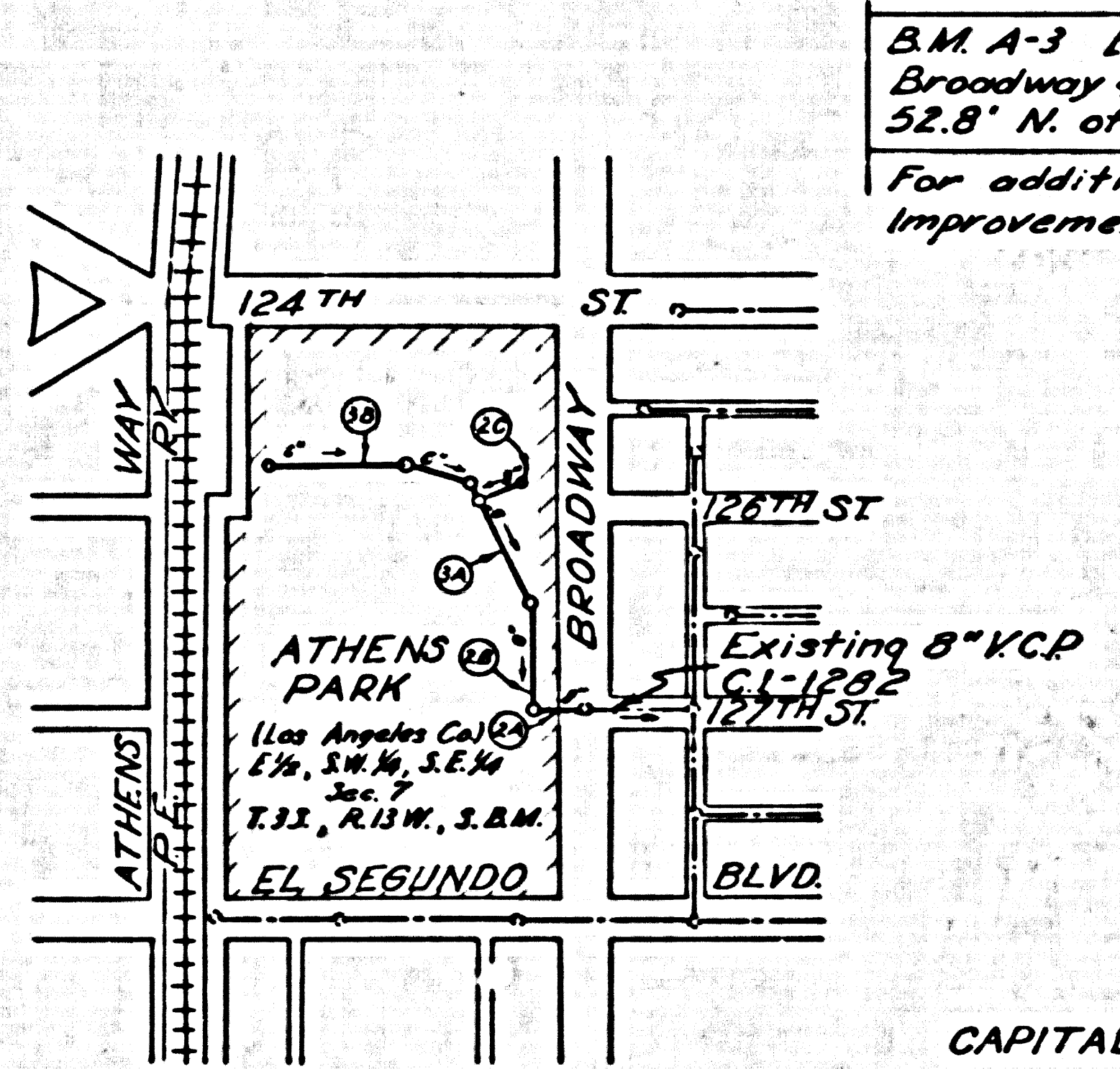

B.M. A-3 Elev. 156.309 F.B. 115 Pg. 19  
Broadway at 127th St., N.E. Cor. 1.57 in Curb  
52.8' N. of N. Prop. L. 127th St. Chis. B.M. A-3  
For additional B.M.s used on this  
Improvement, see printed list.

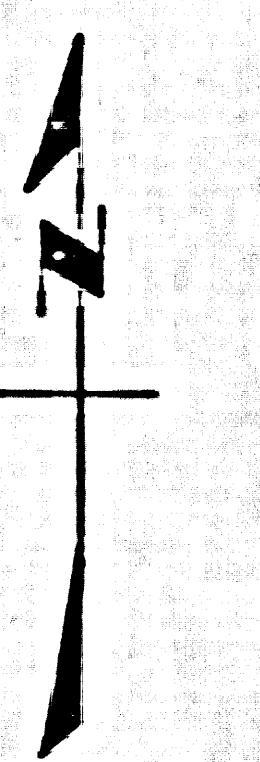

SCALE 1" = 400  
INDEX MAP  
CAPITAL PROJECT NO. 8848.14  
P.C. NO. 4876

- USE STANDARD STRENGTH PIPE EXCEPT AS NOTED.
- USE CEMENT MORTAR FOR ALL VITRIFIED CLAY PIPE JOINTS.
- CONSTRUCT HOUSE LATERALS WITH INVERTS AT CURB, OR PROPERTY LINE, FEET BELOW CURB GRADE, OR GRADE OF CENTER LINE OF STREET EXCEPT AS NOTED.
- CONSTRUCT HOUSE LATERALS WITH 1/4 INCH RISE PER FT. TO PROPERTY LINE, EXCEPT AS NOTED.
- ALL STRUCTURES SHALL BE BRICK SEWER STRUCTURES AS PER PLAN NO. S-A-104, EXCEPT AS NOTED.
- USE STANDARD MANHOLE FRAMES AND COVERS AS PER PLAN NO. S-A-117, EXCEPT AS NOTED.
- RESURFACE TRENCH WITHIN PAVED AREA WITH PREMIX ROCK AND OIL 4 INCHES IN THICKNESS EXCEPT AS NOTED ON 8 INCHES OF AGGREGATE BASE MATERIAL.
- FIGURES IN CIRCLES AT ENDS OF HOUSE LATERALS INDICATE DEPTH BELOW CURB GRADE, OR GRADE OF CENTER LINE OF STREET.
- CONSTRUCTION IN STATE HIGHWAYS SHALL CONFORM WITH STATE HIGHWAY PERMITS.
- USE FORMULA NO. 1 SEC. 51 OF SPECIFICATIONS TO COMPUTE ALLOWABLE LEAKAGE.

NOTE: APPROVAL OF THIS PLAN BY THE COUNTY OF LOS ANGELES DOES NOT CONSTITUTE A REPRESENTATION AS TO THE ACCURACY OF THE LOCATION OF OR EXISTENCE OR NON-EXISTENCE OF ANY UNDERGROUND UTILITY PIPE OR STRUCTURE WITHIN THE LIMITS OF THIS PROJECT. THIS NOTE APPLIES TO ALL SHEETS.

NOTE: CONTRACTOR WILL BE REQUIRED TO PERFORM WORK ON PARK SITE WHILE OTHER WORK IS BEING PERFORMED BY OTHER CONTRACTORS ON THIS SITE.

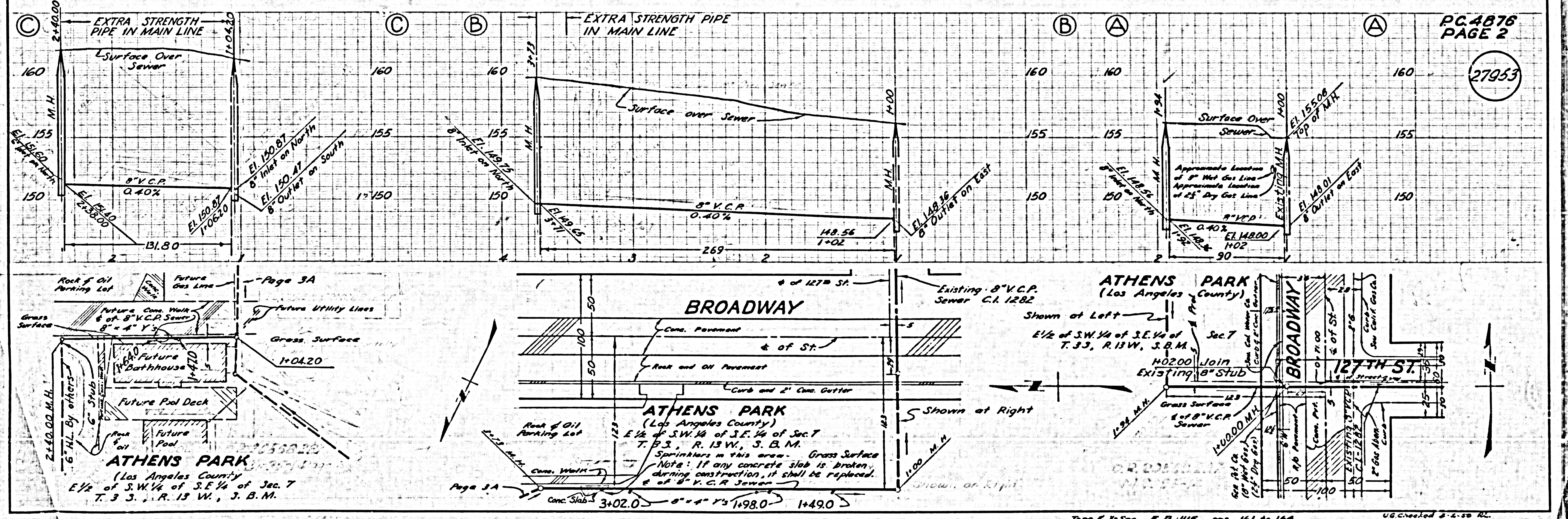

PC 4876  
PAGE 2

27953

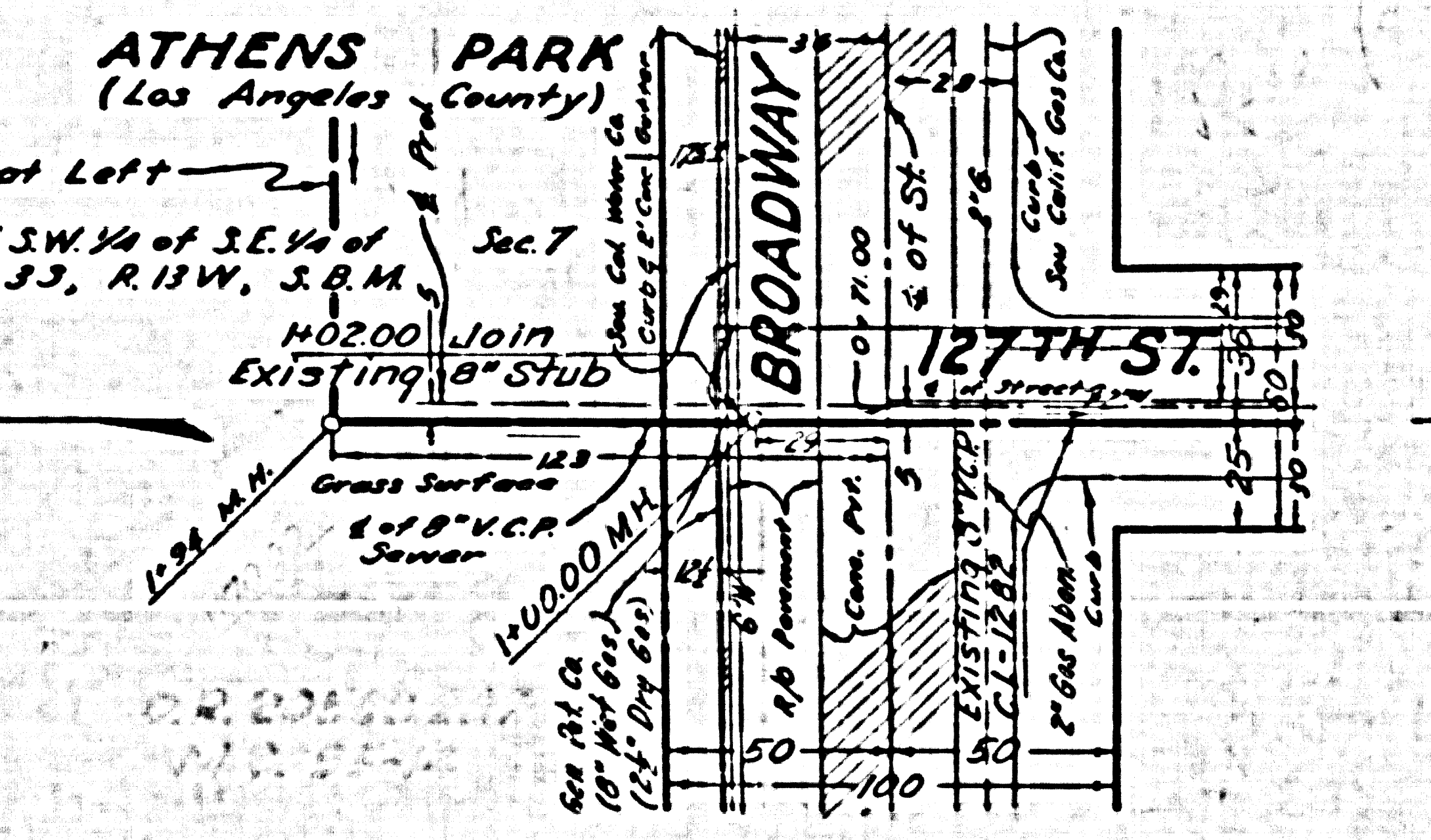
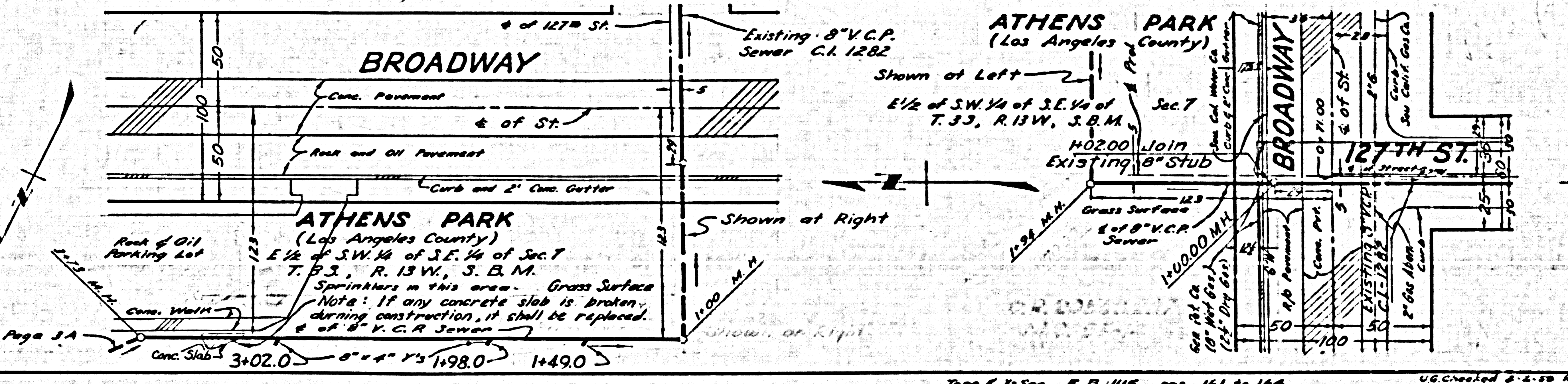
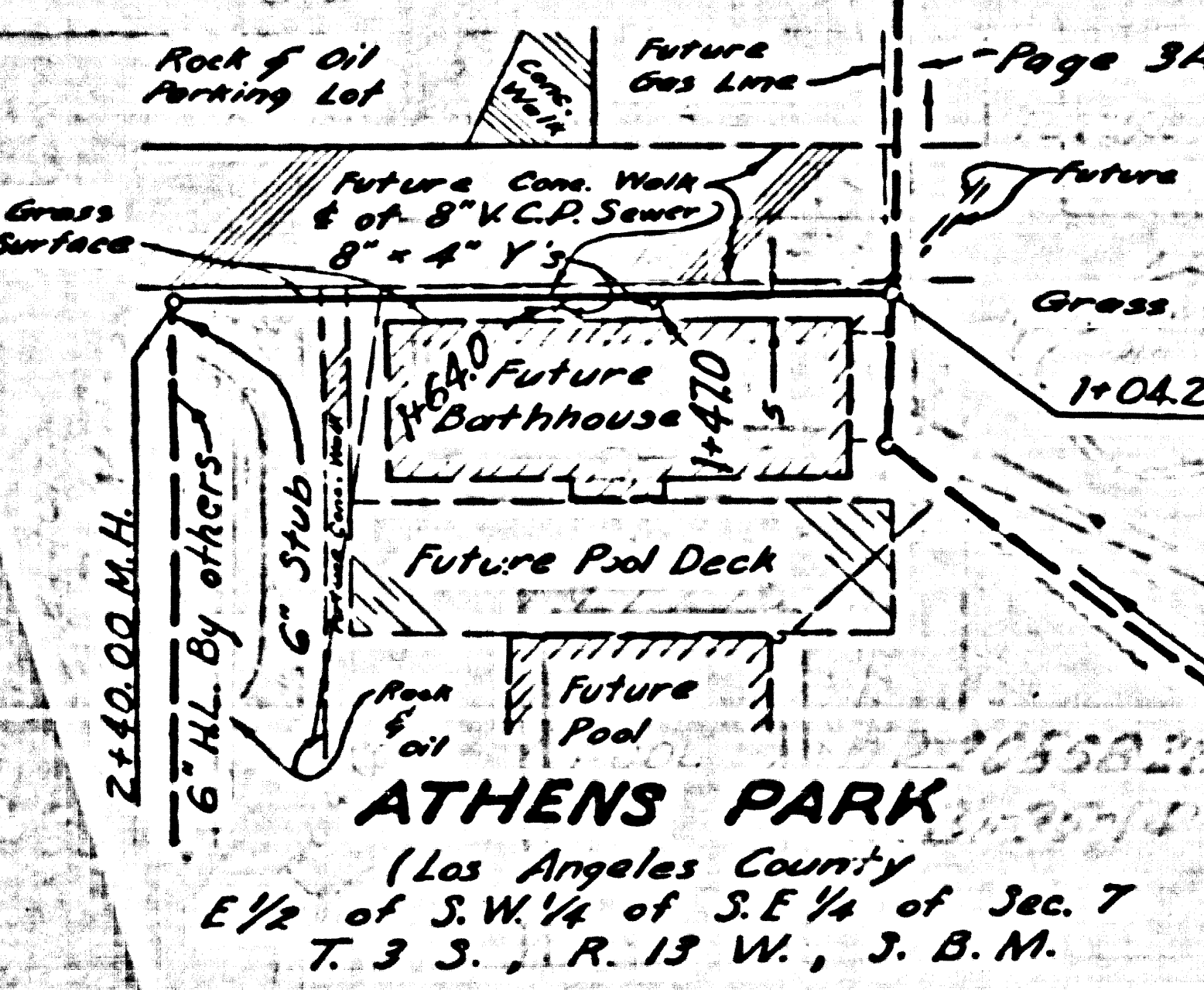

Top of 1st Sec. F.B. 115 pgs 161 to 164  
U.S. created 8-2-58 RL



27954

