

LOMITA BLDG. DIST. NO. 7.1

PROFILE ALIGNMENT AND GRADE OF P.C.4880
SANITARY SEWERS PAGE 1

TRACT No 21144

PRIVATE CONTRACT NO. 4880

W.S.28

2 SHEETS, 4 PAGES

26,356

SCALE: 1" = 4' AUGUST, 1958.

PREPARED IN THE OFFICES OF

Edward L. Peterson
REG. C. E. NO. 2783

FOR LEGEND SEE PLAN NO. S-A-64

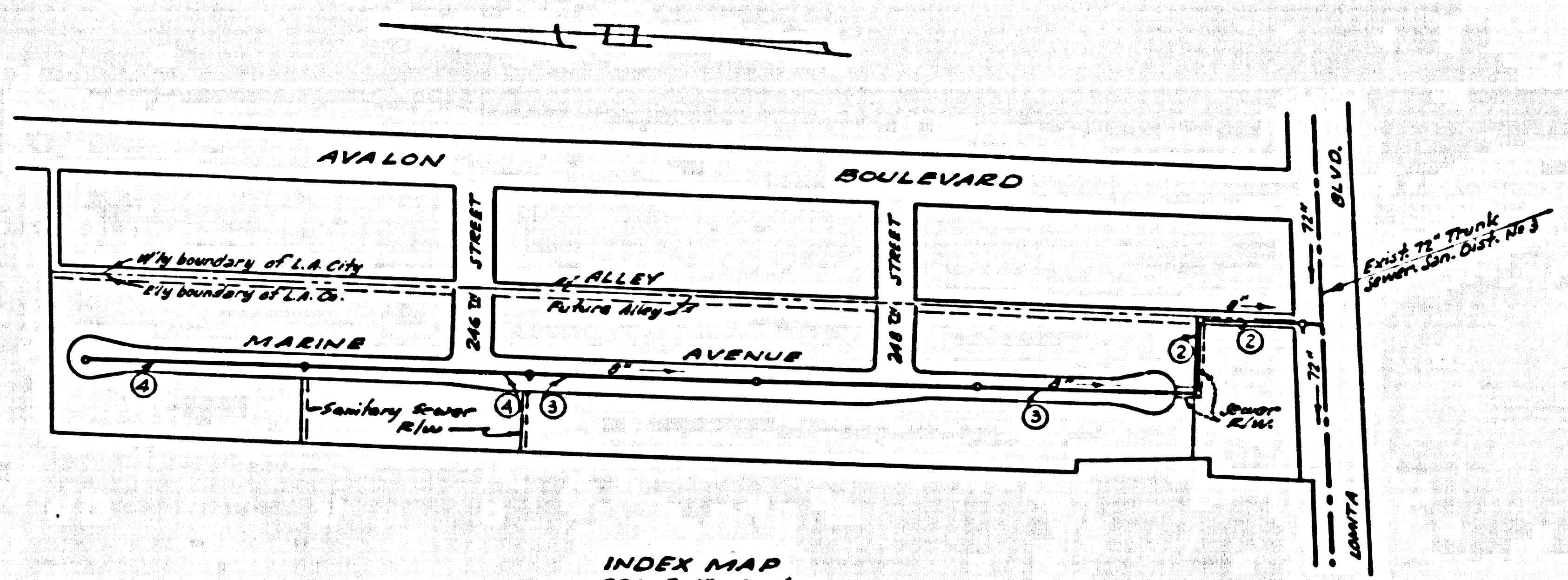

INDEX MAP
SCALE 1" = 800'
TRACT No 21144
P.C. 4880

NO CHARGE FOR CONNECTIONS
L. Custer 9-10-58

- NOTES
1. PROFILE GRADES ON THE PROPERTY LINE OR PROPERTY LINES PRODUCED AT RIGHT ANGLES TO THE SEWER LINE AT THE CENTER LINE OF EACH MANHOLE.
 2. NO REPRESENTATIVE OF THE COUNTY ENGINEER WILL SURVEY OR LAYOUT ANY PORTION OF THE WORK.
 3. THE OWNER OR HIS AUTHORIZED REPRESENTATIVE SHALL FURNISH THE COUNTY ENGINEER WITH GRADE SHEETS AND STATION FOR ALL HOUSE LATERALS AND Y BRANCHES AND SHALL PROVIDE STAKES FOR THEM AT THEIR PROPER LOCATIONS WITH STATIONING PLAINLY MARKED. ANY CHANGE IN LOCATION SHALL BE REQUESTED IN WRITING BY THE OWNER OR HIS REPRESENTATIVE.
 4. NO EXCAVATIONS SHALL BE MADE IN THESE PLANS WITHOUT THE APPROVAL OF THE COUNTY ENGINEER.
 5. USE STANDARD MANHOLE FRAMES AND COVERS, S-A-117, EXCEPT AS NOTED.
 6. USE COUNTY MOTOR GR. "WATER LOCK" OR "POWER SEAL" FOR ALL V.C.R. JUNCTIONS PER SPEC. SEC. 36.100
 7. INSURANCE ALL TRENCHES WITHIN PAVING AREA TO MEET L.A. COUNTY ROAD DEPT. OR CAMP. STAIN HIGHWAY DEPT. REQUIREMENTS IN ACCORDANCE WITH PERMITS.
 8. SHALOE FOUR FEET OF SEWER AT POINTS OF INTERFERENCE WITH POLES, S-A-119.
 9. HOUSE LATERALS TO BE CONSTRUCTED WITH INVERTS AT PROPERTY LINE... FEET BELOW CURB GRADE EXCEPT AS NOTED.
 10. ALL STRUCTURES SHALL BE BRICK SEWER STRUCTURES, S-A-104, EXCEPT AS NOTED.
 11. FOR ALLOWABLE LEAKAGE TEST USE FORMOSA H.L. EXCEPT, SEC. 33.
 12. MANHOLE POLES IN UNIMPROVED RIGHTS-OF-WAY TO BE 6" ABOVE FINISHED GRADE.
 13. ALL THE LOCATIONS SHOWN FOR EXISTING SUBSTRUCTURES HAVE BEEN TAKEN FROM RECORDS AND THEIR CORRECTNESS AND COMPLETENESS IS IN NO WAY GUARANTEED. IT SHALL BE THE CONTRACTOR'S RESPONSIBILITY ALONE TO DEFINITELY LOCATE ALL UNDERGROUND LINES OF EVERY NATURE WHETHER SHOWN HEREON OR NOT, AND PROTECT THEM FROM DAMAGE. THE CONTRACTOR SHALL BEAR THE TOTAL EXPENSE OF REPAIR TO ANY LINE DAMAGED BY ANY OPERATION IN CONNECTION WITH THE PROSECUTION OF THIS WORK.
 14. THE PRIVATE ENGINEER IS TO FURNISH THE HOUSE LATERAL DEPTH AT THE PROPERTY LINE BELOW THE TOP OF CURB ELEVATION FOR EACH HOUSE LATERAL, ON THE GRADE SHEET.
- NOTE:
THE CONTRACTOR SHALL NOTIFY THE CONSTRUCTION AND STORM DRAIN DIVISION BY TELEPHONE, BARISOM 8-4747, EXT. 802 AT LEAST 24 HOURS BEFORE STARTING ANY WORK UNDER THIS CONTRACT.

B.M. S.V. 3093 (1925) Elev. 42.802
Ft. spike 4' from West curb Marine Ave.,
23' 4" So. of Lomita Blvd 2' 4" So. of end
of curb.

Before breaking into any existing structures
and before final acceptance of this work,
County Sanitation District should be notified
in order that required inspection may be made.

NOTE:
GRADES TO WHICH THE IMPROVEMENT IS TO BE CONSTRUCTED ARE SHOWN ON PLANS AND PROFILES. GRADE POINTS FOR TOP OF CURB, CENTER LINE OF RIGHTS, OR CENTER LINE OF ALLEYS ARE SHOWN BY CIRCLES ON PROFILES. AT ALL POINTS BETWEEN SEPARATED POINTS THE GRADE SHALL BE ESTABLISHED SO AS TO CONFORM TO A STRAIGHT LINE DRAWN BETWEEN SAID SEPARATED POINTS.
ELEVATIONS ARE IN FEET ABOVE U.S.C. & G.S. SEA LEVEL DATUM OF 1929.
THE DRAWINGS AND DATA HEREON ARE HEREBY MADE A PART OF THE SPECIFICATIONS.
WORK SHALL BE CONSTRUCTED ACCORDING TO SPECIFICATIONS ON FILE IN THE OFFICE OF THE COUNTY ENGINEER AND SHALL BE PROSECUTED ONLY IN THE PRESENCE OF THE COUNTY ENGINEER.
BEFORE WORK CAN BE STARTED, THE CONTRACTOR MUST OBTAIN A PERMIT TO EXCAVATE IN COUNTY STREETS FROM THE L.A. COUNTY ROAD DEPT. PERMITS AND MAKE A REPORT WITH THE COUNTY ENGINEER, ROOM 334 PAN AMERICAN BUILDING, 120 SOUTH SPRING STREET TO COVER THE COST OF CONSTRUCTION INSPECTION AND RECORD PLANS.
APPROVAL OF THIS PLAN BY THE COUNTY OF LOS ANGELES DOES NOT CONSTITUTE A REPRESENTATION AS TO THE ACCURACY OF THE LOCATION OF OR THE EXISTENCE OR NON-EXISTENCE OF ANY UNDERGROUND UTILITY LINE OR STRUCTURE WITHIN THE LIMITS OF THIS PROJECT. THIS NOTE APPLIES TO ALL PAGES.
IF WORK IS TO BE DONE IN A SEWER RIGHTWAY, A PERMIT MUST BE OBTAINED FROM THE STATE OF CALIFORNIA, DIVISION OF HIGHWAYS, 120 SOUTH SPRING STREET.

COUNTY OF LOS ANGELES, CALIFORNIA

APPROVED, JOHN A. LAMME, COUNTY ENGINEER
APPROVED, A. M. RAWM, CHIEF ENGINEER
L. H. Hughes *J. C. Peterson*
SANTITATION DISTRICT OFFICE ENGINEER
CHECKED BY *L. C. Oude* 9-10-58
OFFICE OF COUNTY ENGINEER, ROOM C. E. NO. 3406

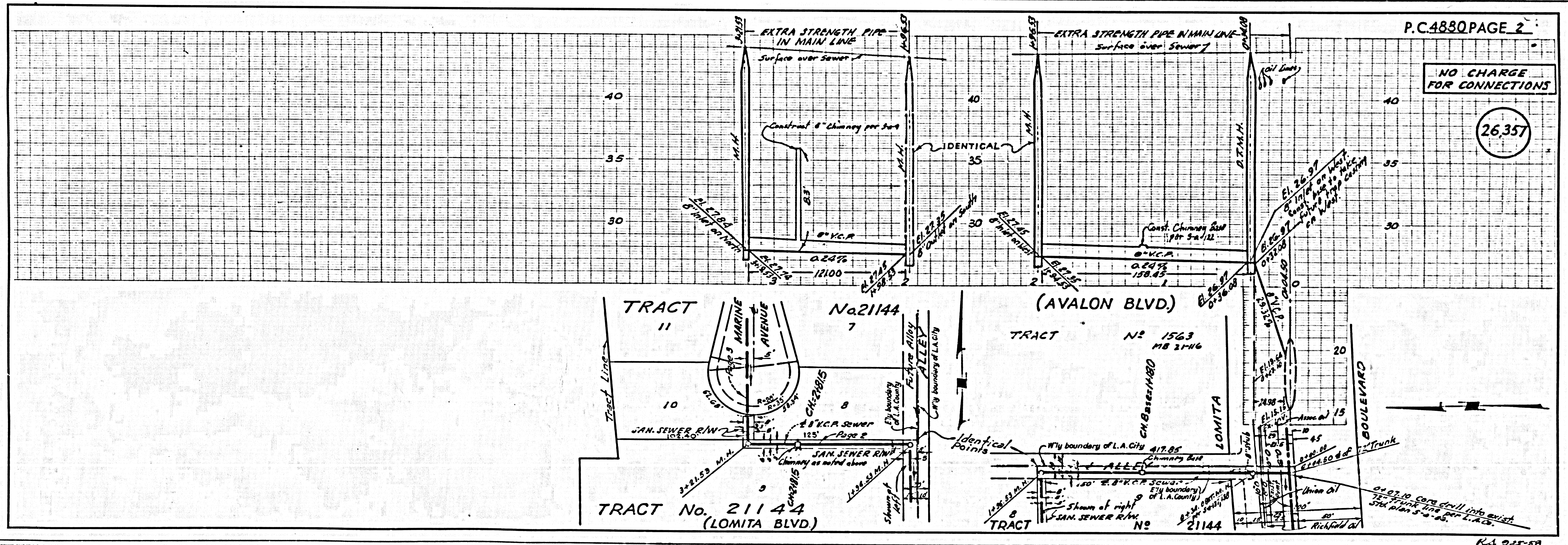

P.C.4880 PAGE 2

NO CHARGE FOR CONNECTIONS

26,357

K.S. 9-15-58

