

The Record outlet Invert elevation (111.21) of exist. M.H. at Little Lake Rd. & Fairford Ave. as shown on Plan and Profile of Improvement No. P.C. 1953 sheet 3A is used as the basis of all elevations shown on this proposed Improvement.

NO CHARGE FOR CONNECTIONS
E. Beveler 11-13-58

DOWNEY BLDG. DIST. NO. 4.03

PROFILE ALIGNMENT AND GRADE OF
SANITARY SEWERS PAGE 1
TO BE CONSTRUCTED IN

LITTLE LAKE ROAD CROSSING
PRIVATE CONTRACT NO. 4894

W.S. 33
1 SHEETS, 2 PAGES

26,571

SCALE: VERT. 1" = 4'
HORIZ. 1" = 40' AUG. 28, 1958

PREPARED IN THE OFFICES OF
BECHTEL CORPORATION

William R. Spriggs
REG. C. E. NO. 8581

FOR LEGEND SEE PLAN NO. S-A-64

NOTES:
GRADES TO WHICH THE IMPROVEMENT IS TO BE CONSTRUCTED ARE SHOWN ON PLANS AND PROFILE GRADE POINTS FOR TOP OF CURBS, CENTER LINE OF STREETS, OR CENTER LINE OF ALLEYS ARE SHOWN BY CIRCLES OR TRIANGLES AT ALL POINTS BETWEEN DESIGNATED POINTS THE GRADE SHALL BE ESTABLISHED SO AS TO CONFORM TO A STRAIGHT LINE BETWEEN SAID DESIGNATED POINTS.
ELEVATIONS ARE IN FEET ABOVE U.S.C. & G.S. SEA LEVEL DATUM OF 1929.
THIS DRAWING AND THE DATA HEREON ARE HEREBY MADE A PART OF THE SPECIFICATIONS.
WORK SHALL BE CONSTRUCTED ACCORDING TO SPECIFICATIONS ON FILE IN THE OFFICE OF THE COUNTY ENGINEER AND SHALL BE PROSECUTED ONLY IN THE PRESENCE OF THE COUNTY ENGINEER.
BEFORE WORK CAN BE STARTED, THE CONTRACTOR MUST OBTAIN A PERMIT TO EXCAVATE IN CITY STREETS FROM THE CITY ENGINEER, CITY OF DOWNEY.
TOWNSHIP 1 AND RANGE 4 ARE MADE A DEPOSIT WITH THE CITY OF DOWNEY, 8413 E. 34th ST., DOWNEY, CA 91744.
APPROVAL OF THIS PLAN BY THE COUNTY OF LOS ANGELES DOES NOT CONSTITUTE A REPRESENTATION AS TO THE ACCURACY OF THE LOCATION OF OR THE EXISTENCE OR NON-EXISTENCE OF ANY UNDERGROUND UTILITY PIPES, OR STRUCTURE WITHIN THE LIMITS OF THE PROJECT. THIS NOTE APPLIES TO ALL PAGES.
IF WORK IS TO BE DONE ON A STATE HIGHWAY, A PERMIT MUST BE OBTAINED FROM THE STATE OF CALIFORNIA, DIVISION OF HIGHWAYS, 120 SOUTH SPRING STREET.

CITY OF DOWNEY, CALIFORNIA
APPROVED, JOHN A. LAMBE, COUNTY ENGINEER
APPROVED, A. M. RAWN, CHIEF ENGINEER
BY *[Signature]* BY *[Signature]*
SANITATION ENGINEER OFFICE ENGINEER
CHECKED BY *[Signature]*
OFFICE OF COUNTY ENGINEER, REG. C. E. NO. 7486

SUBMITTED BY *[Signature]* 11-18-58
JOB CERRITOS REGIONAL ENGINEER, S.E.A. NO. 504

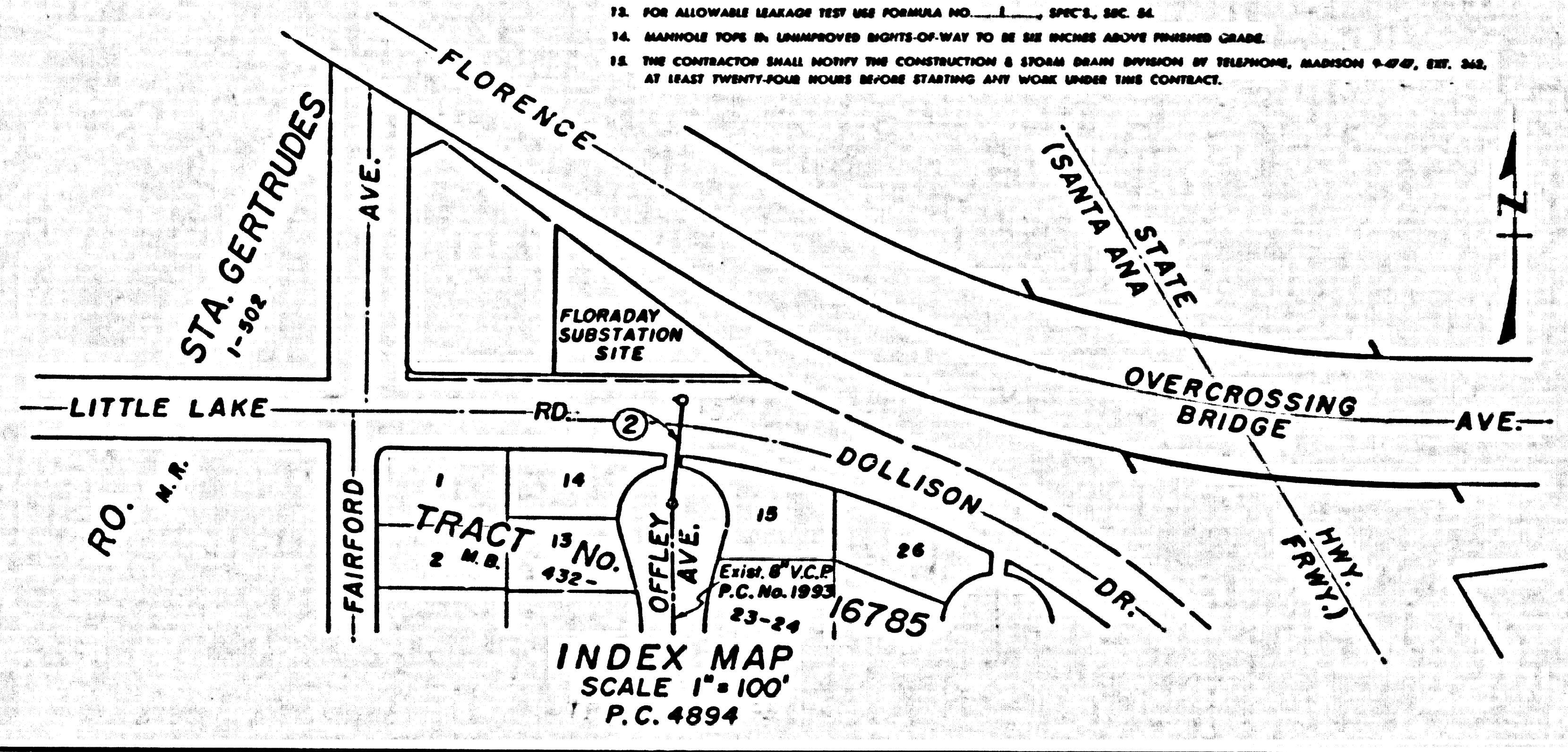

P.C. 4894 PAGE 2

NO CHARGE FOR CONNECTIONS

26,571

