

LAKELWOOD BLDG. DIST. NO. 4.3

PROFILE ALIGNMENT AND GRADE OF P.C. 4928
 SANITARY SEWERS PAGE 1
 TO BE CONSTRUCTED IN

NORWALK BLVD. R/W

PRIVATE CONTRACT NO. 4928

W.S. 31

1 SHEETS, 2 PAGES

SCALE: VERT. 1" = 4' AUG. 1958

PREPARED IN THE OFFICES OF
 MANNING ENGINEERING CO.

By: J. J. Manning
 REG. C. E. NO. 7476

FOR LEGEND SEE PLAN NO. S-A-64

BENCH MARK SY 3861 Elev. 29.678
 L.A. Co. Sur. Control System and Diag.
 2 46' N. & Carson St. 7 2 46' W. of Norwalk Blvd.

- NOTES
- PROVIDE STAKES ON THE PROPERTY LINE OR PROPERTY LINES PRODUCED AT RIGHT ANGLES TO THE SEWER LINE AT THE CENTER LINE OF EACH MANHOLE.
 - NO REPRESENTATIVE OF THE COUNTY ENGINEER WILL SURVEY OR LAYOUT ANY PORTION OF THE WORK.
 - THE OWNER OR HIS AUTHORIZED REPRESENTATIVE SHALL FURNISH THE COUNTY ENGINEER WITH GRADE SHEETS AND STATIONING FOR ALL HOUSE LATERALS AND T-BRANCHES AND SHALL PROVIDE STAKES FOR THEM AT THEIR PROPER LOCATIONS WITH STATIONING AND PLAINLY MARKED. ANY CHANGE IN LOCATION SHALL BE REQUESTED IN WRITING BY THE OWNER OR HIS REPRESENTATIVE.
 - NO REVISIONS SHALL BE MADE IN THESE PLANS WITHOUT THE APPROVAL OF THE COUNTY ENGINEER.
 - USE STANDARD MANHOLE FRAMES AND COVERS, S-A-117
 - USE STANDARD STRENGTH PIPES
 - USE COUNTY MOTAR, WEDGE-LOCK OF SPEED-SEAL FOR ALL VCP JOINTS PER SPECS SEC'S 36-48
 - RESURFACE ALL PAVEMENT WITHIN PAVED AREA TO MEET L.A. COUNTY ROAD DEPT., OR CALIF. STATE HIGHWAY DEPT. REQUIREMENTS IN ACCORDANCE WITH PLANS.
 - ENCASE FOUR FEET OF SEWER AT POINTS OF INTERFERENCE WITH POLES, S-A-173 - CASE III
 - HOUSE LATERALS TO BE CONSTRUCTED WITH 1/4" RISE PER FOOT TO EDGE OF RIGHT OF WAY LINE.
 - ALL STRUCTURES SHALL BE BRICE SEWER STRUCTURE, S-A-154
 - FOR ALLOWABLE LEAKAGE TEST USE FORMULA NO. 1 SPECS, SEC. 64
 - MANHOLE TOPS IN UNIMPROVED RIGHTS-OF-WAY TO BE LEVEL WITH FINISHED GRADE.
 - THE PRIVATE ENGINEER SHALL FURNISH THE HOUSE LATERAL DEPTH AT THE PROPERTY LINE BELOW THE ELEVATION OF THE 8" OF R/W FOR EACH HOUSE LATERAL ON THE GRADE SHEET.

NO CHARGE
 FOR CONNECTIONS

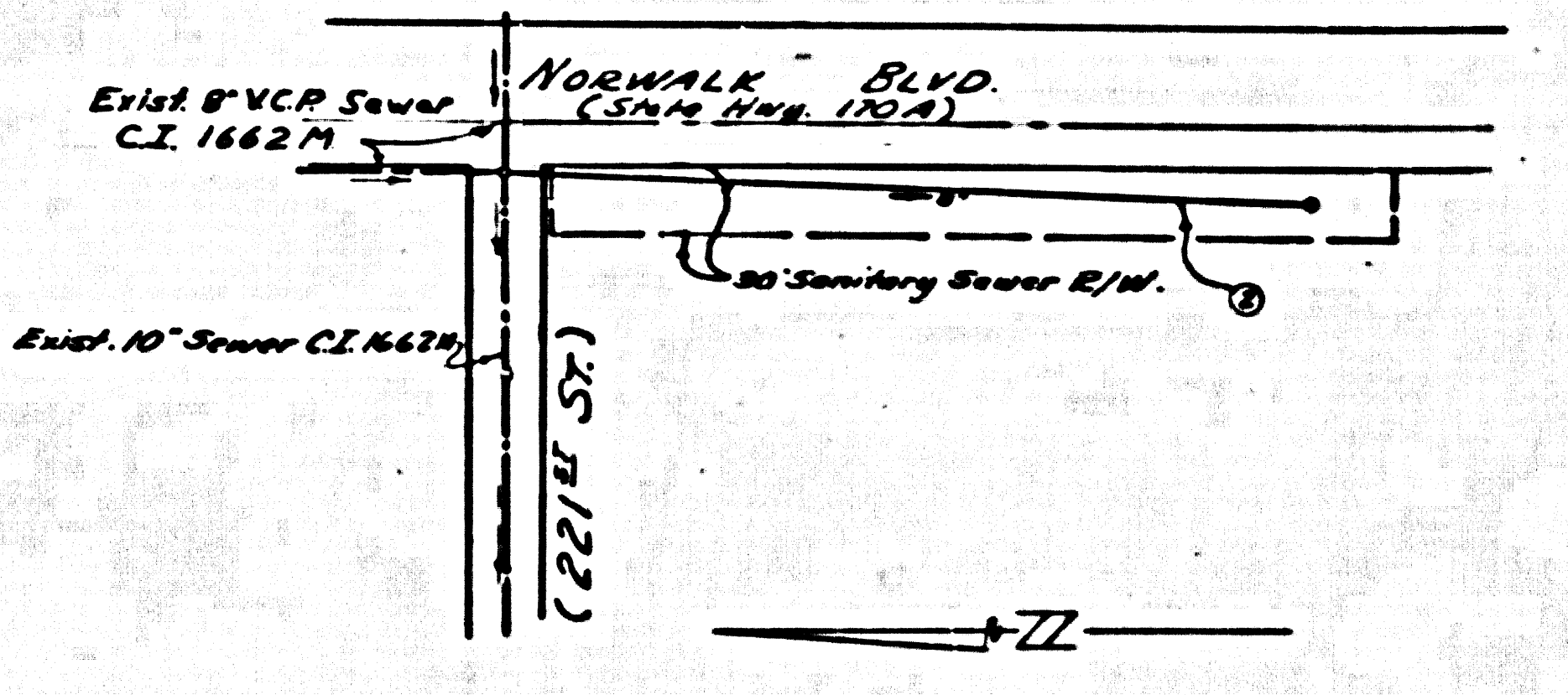

INDEX MAP
 PC 4928
 SCALE 1" = 100'

NOTE:
 THE CONTRACTOR SHALL NOTIFY THE CONSTRUCTION AND STORAGE DIVISION BY TELEPHONE, MADISON 9-4747, EX. 312, AT LEAST 24 HOURS BEFORE STARTING ANY WORK UNDER THIS CONTRACT.

NOTE:
 GRADES TO WHICH THIS IMPROVEMENT IS TO BE CONSTRUCTED ARE SHOWN ON PLANS AND PROFILES. GRADE POINTS FOR TOP OF CURB, CENTER LINE OF STREET, OR CENTER LINE OF ALLEYS ARE SHOWN BY CIRCLES ON PROFILES AT ALL POINTS BETWEEN DESIGNATED POINTS THE GRADE SHALL BE ESTABLISHED SO AS TO CONFORM TO A STRAIGHT LINE BETWEEN SAID DESIGNATED POINTS.
 ELEVATIONS ARE IN FEET ABOVE U.S.C. (F.S. SEA LEVEL DATUM OF 1929)
 THIS DRAWING AND THE DATA HEREON ARE HEREBY MADE A PART OF THE SPECIFICATIONS.
 WORK SHALL BE CONSTRUCTED ACCORDING TO SPECIFICATIONS ON FILE IN THE OFFICE OF THE COUNTY ENGINEER AND SHALL BE PROSECUTED ONLY IN THE PRESENCE OF THE COUNTY ENGINEER.
 BEFORE WORK CAN BE STARTED, THE CONTRACTOR MUST OBTAIN A PERMIT TO EXCAVATE IN COUNTY RIGHTS FROM THE L.A. COUNTY ROAD DEPT., DIST. #18 AND MAKE A REPORT WITH THE COUNTY ENGINEER, ROOM 304 PAN AMERICAN BUILDING, 210 S.W. BROADWAY SUFFICIENT TO COVER THE COST OF CONSTRUCTION INSPECTION AND RECORD PLANS.
 APPROVAL OF THIS PLAN BY THE COUNTY OF LOS ANGELES DOES NOT CONSTITUTE A REPRESENTATION AS TO THE ACCURACY OF THE LOCATION OF OR THE EXISTENCE OR NON-EXISTENCE OF ANY UNDERGROUND UTILITY PIPE, OR STRUCTURE WITHIN THE LIMITS OF THE PROJECT. THIS NOTE APPLIES TO ALL PAGES.
 IF WORK IS TO BE DONE IN A STATE HIGHWAY, A PERMIT MUST BE OBTAINED FROM THE STATE OF CALIFORNIA, DIVISION OF HIGHWAYS, 120 BOURNE AVENUE, SEASIDE.

COUNTY OF LOS ANGELES, CALIFORNIA

APPROVED, JOHN A. LAMBE, COUNTY ENGINEER APPROVED, C. E. CHAPMAN, CHIEF ENGINEER

BY: [Signature] OFFICE ENGINEER

CHECKED BY: [Signature] OFFICE OF COUNTY ENGINEER, INC. C. E. NO. [Signature]

SUBMITTED BY: LOS CERRITOS REGIONAL ENGINEER R.C.E. 3871

P.C. 4928 PAGE 2

NO CHARGE
 FOR CONNECTION

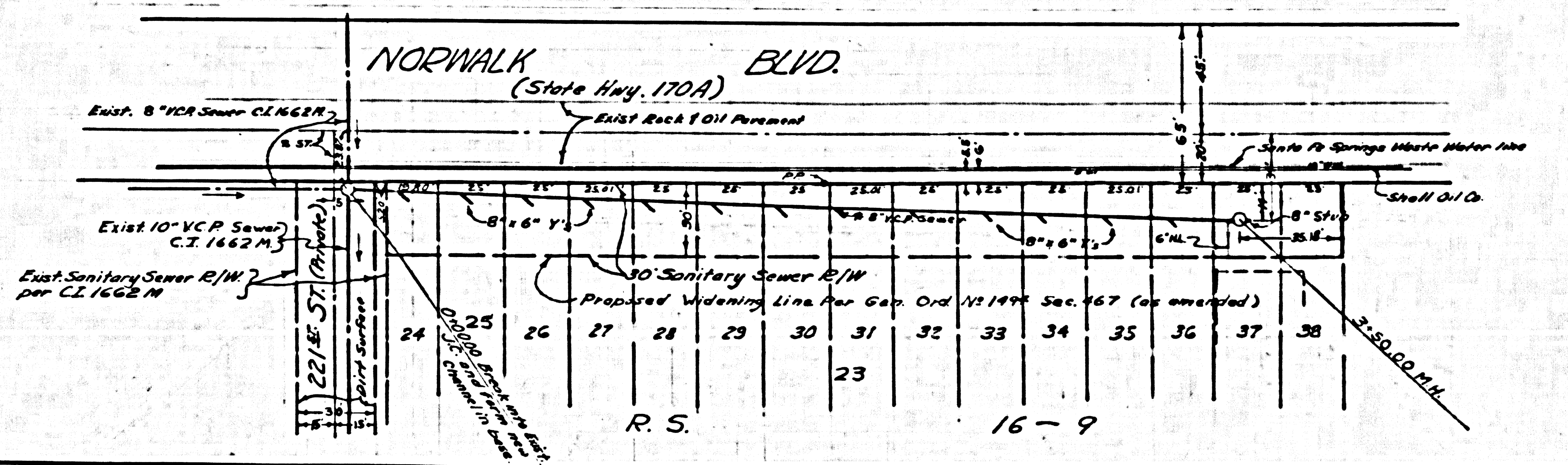
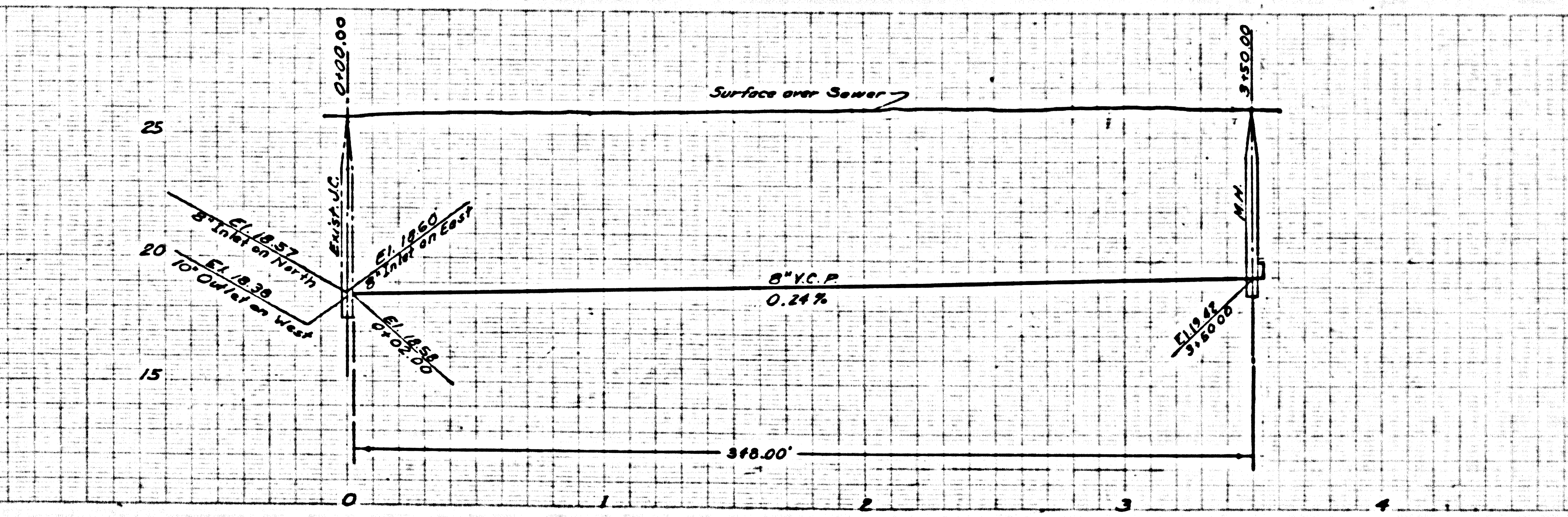

R. S. 16-9