

BRANCH MARKED BY 3021
 1 FT W. CURB NORMANVILLE ST
 S. OF THE CURB WET. SW. COR.
 182ND ST & NORMANVILLE. ELEV. 43.837
 GARDENA QUAD 11585

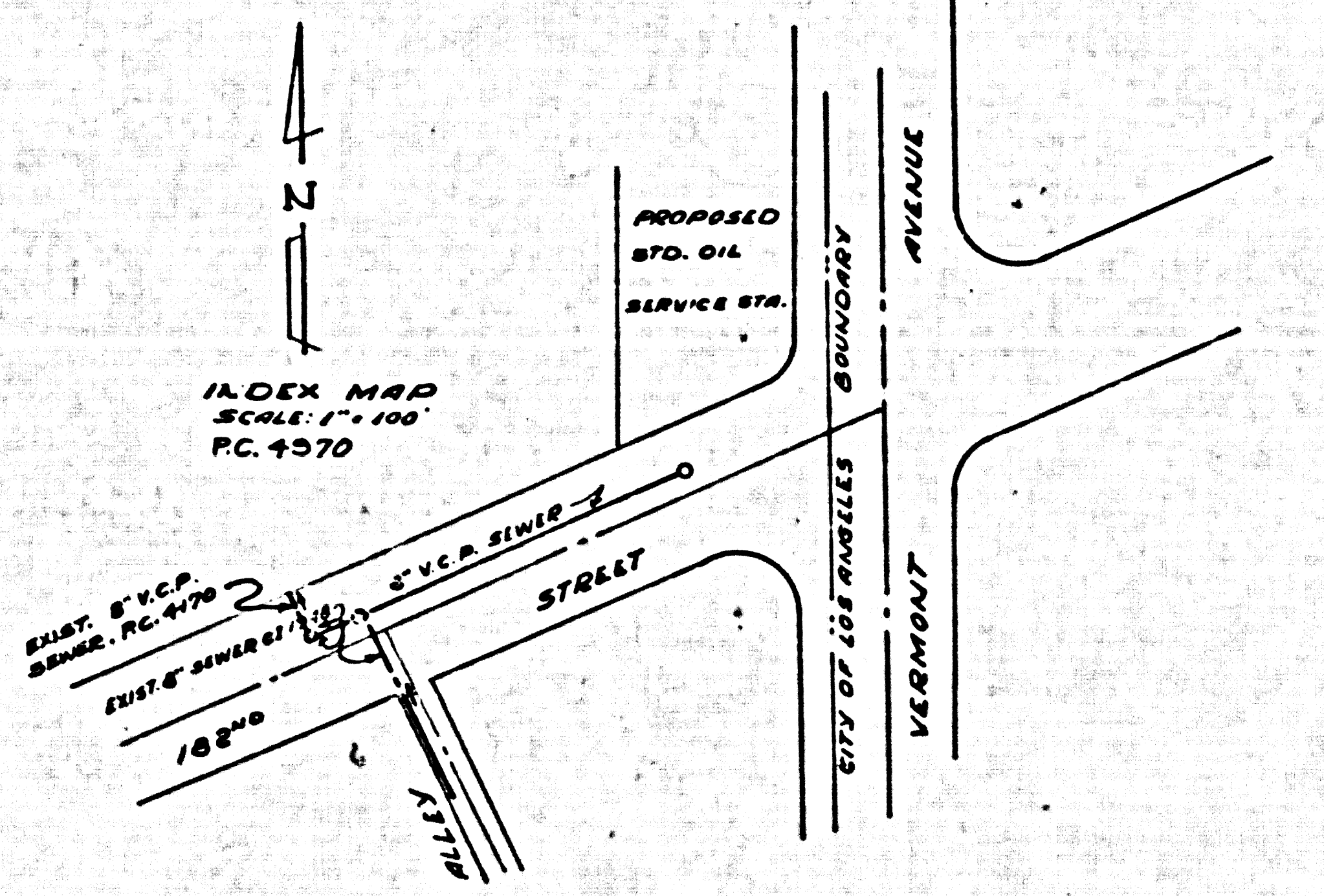

CONNECTION CHARGES
 AS INDICATED.
Col. H. A. Owen 12-2-58

LENNOX BLDG. DIST. NO. 7

- NOTES
1. PROVIDE STAKES ON THE PROPERTY LINE OR PROPERTY LINES PRODUCED AT RIGHT ANGLES TO THE SEWER LINE AT THE CENTER LINE OF EACH BRANCH.
 2. NO REPRESENTATIVE OF THE COUNTY ENGINEER WILL SURVEY OR LAY OUT ANY PORTION OF THE WORK.
 3. THE OWNER OR HIS AUTHORIZED REPRESENTATIVE SHALL FURNISH THE COUNTY ENGINEER WITH GRADE SHEETS AND STATIONING FOR ALL HOUSE LATERALS AND T BRANCHES AND SHALL PROVIDE STAKES FOR THEM AT THEIR PROPER LOCATIONS WITH STATIONING PLAINLY MARKED. ANY CHANGE IN LOCATION SHALL BE REQUESTED IN WRITING BY THE OWNER OR HIS REPRESENTATIVE.
 4. THE PRIVATE ENGINEER SHALL FURNISH THE HOUSE LATERAL BATH AS THE PROPERTY LINE BELOW THE TOP OF CURB ELEVATION FOR EACH HOUSE LATERAL ON THE GRADE SHEET.
 5. NO REVISIONS SHALL BE MADE IN THESE PLANS WITHOUT THE APPROVAL OF THE COUNTY ENGINEER.
 6. USE STANDARD BATHING FRAMES AND COVERS, S-117, EXCEPT AS NOTED.
 7. USE STANDARD BATHING PANS AND COVERS, S-117, EXCEPT AS NOTED.
 8. USE CEMENT MORTAR OR "WEDGELOCK" OR "SPRIG-SEAL" FOR ALL V.C.P. JOINTS PER SPECS., SECS. 26 & 61.
 9. RESURFACE ALL TRENCH WITHIN PAVED AREA TO MEET L.A. COUNTY ROAD DEPT. OR CALIF. STATE HIGHWAY REQUIREMENTS IN ACCORDANCE WITH PERMITS.
 10. INCASE POLE MEET AT POINTS OF INTERFERENCE WITH POLES, CASE NO. S-117.
 11. HOUSE LATERALS TO BE CONSTRUCTED WITH 1/2" RISE PER FOOT TO PROPERTY LINE.
 12. ALL STRUCTURES SHALL BE BRICK SEWER STRUCTURES, S-119, EXCEPT AS NOTED.
 13. FOR ALLOWABLE LEAKAGE TEST USE FORMULA NO. 1, SPECS., SEC. 64.
 14. MAINLINE POLE IN UNIMPROVED RIGHTS-OF-WAY TO BE SIX INCHES ABOVE FINISHED GRADE.
 15. THE CONTRACTOR SHALL NOTIFY THE CONSTRUCTION & STORM DRAIN DIVISION BY TELEPHONE, MARSHON 9-22, EXT. 302, AT LEAST TWENTY-FOUR HOURS BEFORE STARTING ANY WORK UNDER THIS CONTRACT.

PROFILE ALIGNMENT AND GRADE OF P.C. 4970
 SANITARY SEWERS PAGE 1
 TO BE CONSTRUCTED IN
 182ND STREET (26564)

PRIVATE CONTRACT NO. 4970
 W.S. 26
 1 SHEET; 2 PAGES
 SCALE: VERT. 1" = 4' HORIZ. 1" = 40'
 OCT. 31, 1958
 PREPARED IN THE OFFICES OF
 VOORHEES, TRINDLE, NELSON INC.
 3435 WESTMINSTER AVENUE
 WESTMINSTER, CALIFORNIA
 BY: *C.P. DeLeon*
 REG. C. E. NO. 8781
 FOR LEGEND SEE PLAN NO. S-A-64

NOTE:
 GRADES TO WHICH THIS IMPROVEMENT IS TO BE CONSTRUCTED ARE SHOWN ON PLANS AND PROFILES. GRADE POINTS FOR TOP OF CURB, CENTER LINE OF STREETS, OR CENTER LINE OF ALLEYS ARE SHOWN BY CIRCLES ON PROFILES. AT ALL POINTS BETWEEN DESIGNATED POINTS THE GRADE SHALL BE ESTABLISHED SO AS TO CONFORM TO A STRAIGHT LINE DRAWN BETWEEN SAID DESIGNATED POINTS.
 ELEVATIONS ARE IN FEET ABOVE U.S.C. & G.S. MEAN DATUM OF 1929.
 THIS DRAWING AND THE DATA HEREON ARE HEREBY MADE A PART OF THE SPECIFICATIONS.
 BEFORE WORK CAN BE STARTED, THE CONTRACTOR MUST OBTAIN A PERMIT TO EXCAVATE IN COUNTY STREETS FROM THE L.A. COUNTY ROAD DEPT., DISTRICT OFFICE NO. 3, AND MAKE A DEPOSIT WITH THE COUNTY ENGINEER, ROOM 324 PARI AMERICAN BUILDING, 343 WESTMINSTER AVENUE, WESTMINSTER, CALIFORNIA, TO COVER THE COST OF CONSTRUCTION INSPECTION AND RECORD PLANS.
 APPROVAL OF THIS PLAN BY THE COUNTY OF LOS ANGELES DOES NOT CONSTITUTE A REPRESENTATION AS TO THE ACCURACY OF THE LOCATION OF OR THE EXISTENCE OR NON-EXISTENCE OF ANY UNDERGROUND UTILITY PIPE, OR STRUCTURE WITHIN THE LIMITS OF THE PROJECT. THIS NOTE APPLIES TO ALL PAGES.
 IF WORK IS TO BE DONE ON A STATE HIGHWAY, A PERMIT MUST BE OBTAINED FROM THE STATE OF CALIFORNIA, D. DIV. OF HIGHWAYS, 120 SOUTH SPRING STREET.

COUNTY OF LOS ANGELES, CALIFORNIA
 APPROVED, JOHN A. LAMBE, COUNTY ENGINEER
 APPROVED, C.E. CAMPING, CHIEF ENGINEER
 BY: *John A. Lambe* COUNTY ENGINEER
 BY: *C.E. Camping* CHIEF ENGINEER
 CHECKED BY: *W. D. ...*
 OFFICE OF COUNTY ENGINEER, REG. C. E. NO. 9266
 APPROVED BY: *Slattery 11/25/58*, INDUSTRIAL WASTE DIVISION

P.C. 4970 PAGE 2

CONNECTION CHARGES
 AS INDICATED

26565

