

PALMDALE BLDG. DIST. NO. 8P

PROFILE ALIGNMENT AND GRADE OF P.C. 4980  
 SANITARY SEWERS PAGE 1  
 TO BE CONSTRUCTED FOR  
 TUMBLEWEED SCHOOL

PRIVATE CONTRACT NO. 4980

W.S. 65  
 1 SHEET, 2 PAGES  
 27,760

SCALE: VERT. 1" = 4'  
 HORIZ. 1" = 40'  
 NOV. 1958.  
 PREPARED IN THE OFFICES OF  
 SUBDIVISION ENGINEERING CO.  
 BY *W. L. Douglas*  
 REG. C. E. NO. 4818  
 3-12-58.  
 FOR LEGEND SEE PLAN NO. S-A-64

- NOTE:
1. PROVIDE STAKES ON THE PROPERTY LINE OR PROPERTY LINES PRODUCED AT RIGHT ANGLES TO THE SEWER LINE AT THE CENTER LINE OF EACH MANHOLE.
  2. NO REPRESENTATIVE OF THE COUNTY ENGINEER WILL SURVEY OR LIFT OUT ANY PORTION OF THE WORK.
  3. THE OWNER OR HIS AUTHORIZED REPRESENTATIVE SHALL FURNISH THE COUNTY ENGINEER WITH GRAB SHEETS AND STATIONING FOR ALL HOUSE LATERALS AND Y BRANCHES AND SHALL PROVIDE STAKES FOR THEM AT THEIR PROPER LOCATIONS WITH STATIONING PLAINLY MARKED. ANY CHANGE IN LOCATION SHALL BE REQUESTED IN WRITING BY THE OWNER OR HIS REPRESENTATIVE.
  4. THE PRIVATE ENGINEER SHALL FURNISH THE HOUSE LATERAL BATHS AT THE PROPERTY LINE BELOW THE TOP OF CURB ELEVATION FOR EACH HOUSE LATERAL ON THE GRADE SHEET.
  5. NO DIVERSIONS SHALL BE MADE IN THESE PLANS WITHOUT THE APPROVAL OF THE COUNTY ENGINEER.
  6. USE STANDARD MANHOLES, FRAMES AND COVERS, 1-117.
  7. USE STANDARD STRENGTH PIPE.
  8. USE "WELLS-JOICE" OR "PREF-BEAT" FOR ALL V.C.P. JOINTS PER SPEC'S. SECS. 28 & 29.
  9. RESURFACE ALL TRENCH WITHIN PAVED AREAS TO MEET L.A. COUNTY ROAD DEPT. OR CALIF. STATE HIGHWAY AGREEMENTS BY ACCORDANCE WITH PERMITS.
  10. SHOW FOUR FEET OF SEWER AT POINTS OF INTERFERENCE WITH POLES, CASE NO. 5-172.
  11. HOUSE LATERALS TO BE CONSTRUCTED WITH 1/2" RISE PER FOOT TO P.C.
  12. ALL STRUCTURES SHALL BE BRICK SEWER STRUCTURES, 6-194, EXCEPT AS NOTED.
  13. FOR ALLOWABLE LEAKAGE TEST USE FORMULA NO. 1, SPEC'S. SEC. 54.
  - 14.
  15. THE CONTRACTOR SHALL NOTIFY THE CONSTRUCTION & STORM DRAIN DIVISION BY TELEPHONE, 941-4444 EXT. 64, AT LEAST TWENTY-FOUR HOURS BEFORE STARTING ANY WORK UNDER THIS CONTRACT.

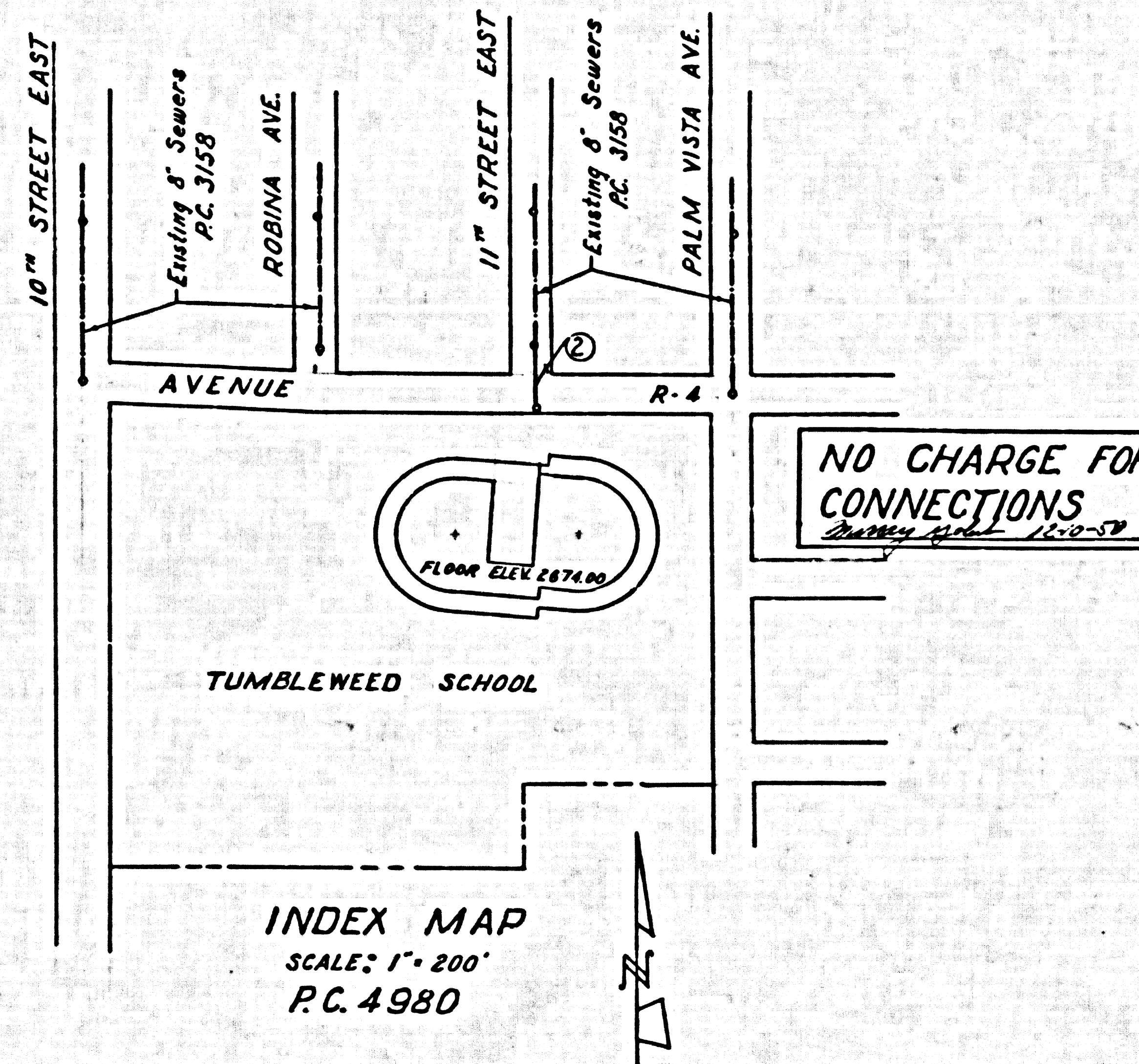

BENCH MARK:  
 USBMX-426 SET IN TOP OF A CONC. POST  
 APPROX. 0.5 MI. So. of Palmdale S.R.R. Station, 12' East of  
 S.P. Signal No. 4143, 38 yds. So. of RR Xing 00142, 34' East  
 of S.P. Main Line, & 48' W. of E. U.S. Highway No. 6.  
 ELEV. = 2671.56

WORKS:  
 GRABETS TO WHICH THIS IMPROVEMENT IS TO BE CONSTRUCTED ARE SHOWN ON PLANS AND PROFILES. GRADE POINTS FOR TOP OF CURBS, CENTER LINE OF STREETS, OR CENTER LINE OF ALLEYS ARE SHOWN BY CIRCLES ON PROFILES. AT ALL POINTS BETWEEN REGULARLY SPACED POINTS THE GRADE SHALL BE DETERMINED SO AS TO COMFORM TO A GRADE LINE DRAWN BETWEEN SAID REGULAR POINTS.  
 ELEVATIONS ARE IN FEET ABOVE U.S.C. & G.S. SEA LEVEL DATUM OF 1929.  
 THE DRAWING AND THE DATA HEREON ARE HEREBY MADE A PART OF THE SPECIFICATIONS.  
 WORK SHALL BE CONSTRUCTED ACCORDING TO SPECIFICATIONS ON FILE IN THE OFFICE OF THE COUNTY ENGINEER AND SHALL BE PROSECUTED ONLY IN THE PRESENCE OF THE COUNTY ENGINEER.  
 BEFORE WORK CAN BE STARTED THE CONTRACTOR MUST OBTAIN A PERMIT TO EXCAVATE IN COUNTY STREETS FROM THE COUNTY ROAD DEPT., DISTRICT OFFICE NO. 8, AND MAKE A REPORT WITH THE COUNTY ENGINEER, ROOM 524 FARM ANGLEMAN BUILDING, 218 S. BROADWAY SUPPLEMENT TO COVER THE COST OF CONSTRUCTION INSPECTION AND RECORD PLANS.  
 APPROVAL OF THIS PLAN BY THE COUNTY OF LOS ANGELES DOES NOT CONSTITUTE A REPRESENTATION AS TO THE ACCURACY OF THE LOCATION OF OR THE EXISTENCE OR NON-EXISTENCE OF ANY UNDISCOVERED UTILITY PIPE, OR STRUCTURE WITHIN THE LIMITS OF THE PROJECT. THE OWNER APVES TO ALL PAGES.  
 IF WORK IS TO BE DONE IN A STATE HIGHWAY, A PERMIT MUST BE OBTAINED FROM THE STATE OF CALIFORNIA, DIVISION OF HIGHWAYS, 120 SOUTH SPRING STREET.  
 COUNTY OF LOS ANGELES, CALIFORNIA  
 APPROVED, JOHN A. LAMBE, COUNTY ENGINEER  
 APPROVED, C. R. COMPTON, CHIEF ENGINEER  
 COL. LHM. SER. NO. 12  
 BY *W. L. Douglas* SANITATION ENGINEER  
 BY *C. R. Compton* OFFICE ENGINEER  
 CHECKED BY *Sammy Sida* 12-16-58  
 OFFICE OF COUNTY ENGINEER, SEC. 6 & NO. 2406  
 RECOMMENDED BY *Robert E. Kellum* ASSISTANT ENGINEER

