

PALMDALE BLDG. DIST. NO. 8.1

PROFILE ALIGNMENT AND GRADE OF P.C. 5000
 SANITARY SEWERS PAGE 1
 TO BE CONSTRUCTED IN
 TRACT No 22035 (26.718)
 M.B. 600-46/48

B.M. AV. 153
 C.S.F.B. 2181-10 Beachdale Dr
 N. Side @ 11th St. W. 87' Spk. in Ch.
 5' W. of 6' Prod. 11th St. W.
 El. 2687.85

Note: Subtract .85 from all elev. Shown
 to be on C.S. Adj. elev.

CONNECTION CHARGES
 AS INDICATED
 Murray, Robert 12-17-58

- NOTE:
 PROFILE GRADES ON THE PROPERTY LINE OR PROPERTY LINES PRODUCED AT RIGHT ANGLES TO THE SEWER LINE AT THE CENTER LINE OF EACH PARCEL.
 NO REPRESENTATIVE OF THE COUNTY ENGINEER WILL SURVEY OR LAYOUT ANY PORTION OF THE WORK.
 THE OWNER OR HIS AUTHORIZED REPRESENTATIVE SHALL FURNISH THE COUNTY ENGINEER WITH GRAB SHEETS AND STATION FOR ALL HOUSE LATERALS AND T-BRANCHES AND SHALL PROVIDE THEM AT THEIR PROPER LOCATIONS WITH STATIONING AND PLAINLY MARKED. ANY CHANGE IN LOCATION SHALL BE REQUESTED IN WRITING BY THE OWNER OR HIS REPRESENTATIVE.
 NO REVISIONS SHALL BE MADE IN THESE PLANS WITHOUT THE APPROVAL OF THE COUNTY ENGINEER.
1. USE STANDARD MANHOLE FRAMES AND COVERS, S-A-117, EXCEPT AS NOTED.
 2. USE STANDARD STRENGTH PIPE EXCEPT AS NOTED.
 3. USE COUNTY DESIGN OR STANDARD-GALVANIZED STEEL PIPE PER S.C.E. SPEC. 5000-10-36-130.
 4. REINFORCE ALL TRENCHES WITHIN PAVED AREA TO MEET L.A. COUNTY ROAD DEPT. OR CALIF. STATE HIGHWAY DEPT. SPECIFICATIONS IN ACCORDANCE WITH PERMITS.
 5. ENCASE FOUR FEET OF SEWER AT POINTS OF INTERFERENCE WITH POLES, S-A-119.
 6. HOUSE LATERALS TO BE CONSTRUCTED WITH INVERTS AT PROPERTY LINE. SEE SPEC. FOR SLOPE CURB GRADE EXCEPT AS NOTED.
 7. ALL STRUCTURES SHALL BE SINCE SEWER STRUCTURES, S-A-104, EXCEPT AS NOTED.
 8. FOR ALLOWABLE LEAKAGE TEST USE FORMULA NO. 1 SPEC. SEC. 11.
 9. MANHOLE TOPS IN UNIMPROVED DRIVE-OR-WAY TO BE 6" ABOVE FINISHED GRADE.

NOTE:
 THE CONTRACTOR SHALL NOTIFY THE CONSTRUCTION AND STORM DRAIN DIVISION BY TELEPHONE WHITEHALL 2-8401, EXT. 40 AT LEAST 24 HOURS BEFORE STARTING ANY WORK UNDER THIS CONTRACT.
 Ball all pipe joints with 4" Cement mortar tapers within 20' of all property lines or within 50' sewer limit. Except unless using wedge lock or Speed seal joints.

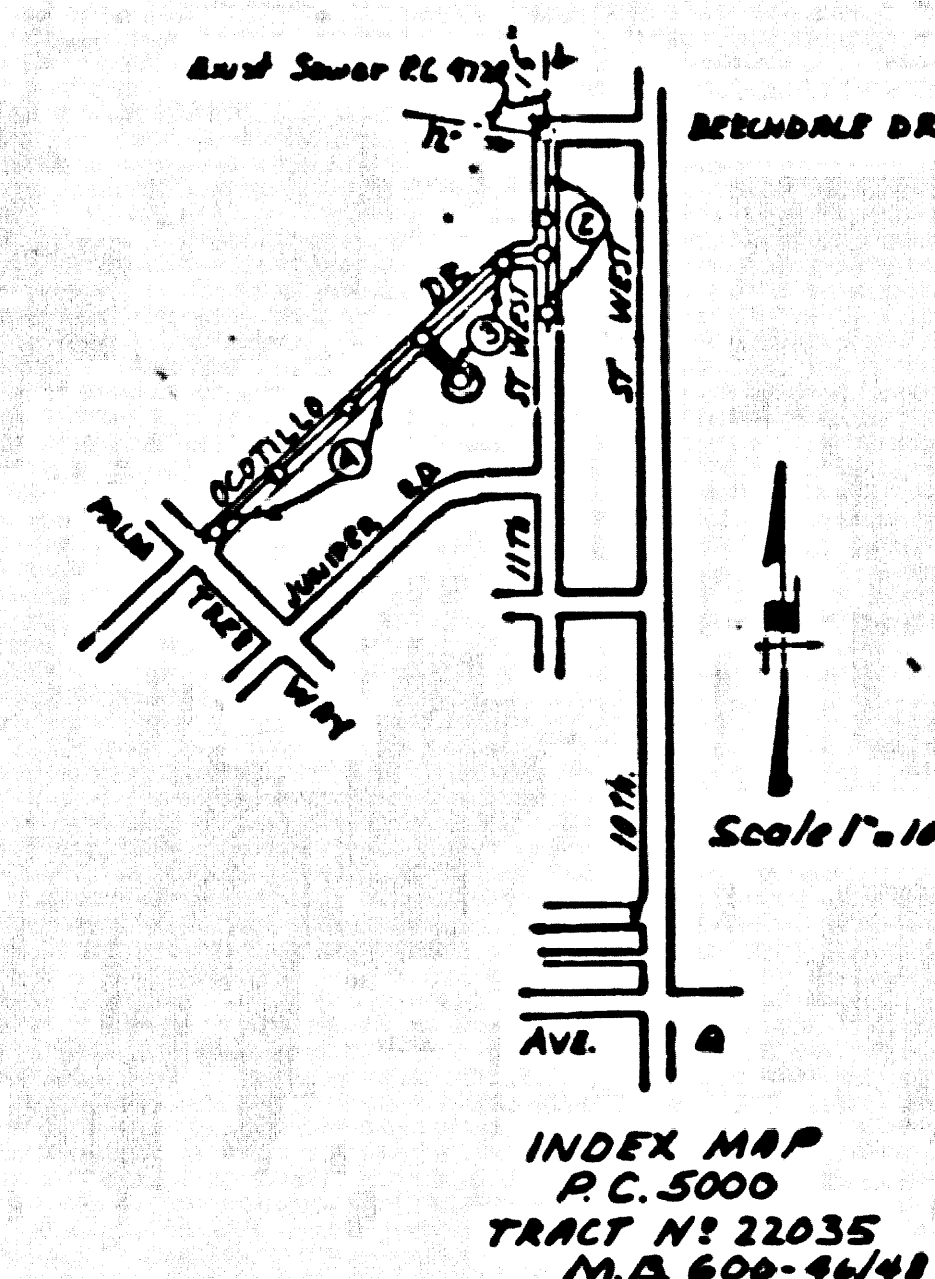

PRIVATE CONTRACT NO. 5000 ☆
 W.S. 64
 2 SHEETS, 4 PAGES
 SCALE: VERT. 1" = 4' HORIZ. 1" = 40'
 DECEMBER, 1958
 PREPARED IN THE OFFICES OF
 RALPH B. NUNNELLEY
 by Ralph B. Nunnelley
 REG. C.E. NO. 2020
 FOR LEGEND SEE PLAN NO. S-A-54

NOTE:
 GRADES TO WHICH THIS IMPROVEMENT IS TO BE CONSTRUCTED ARE SHOWN ON PLANS AND PROFILES. GRADE POINTS FOR TOP OF CURB, CENTER LINE OF STREET, OR CENTER LINE OF ALLEY ARE SHOWN BY CIRCLES ON PROFILES AT ALL POINTS BETWEEN DESIGNATED POINTS THE GRADE SHALL BE ESTABLISHED SO AS TO CONFORM TO A STRAIGHT LINE DRAWN BETWEEN SAID DESIGNATED POINTS.
 ELEVATIONS ARE IN FEET ABOVE U.S.C. & G.S. MEAN LEVEL, DATUM OF 1929.
 THE DRAWING AND THE DATA HEREON ARE HEREBY MADE A PART OF THE SPECIFICATIONS.
 WORK SHALL BE CONSTRUCTED ACCORDING TO SPECIFICATIONS ON FILE IN THE OFFICE OF THE COUNTY ENGINEER AND SHALL BE PROSECUTED ONLY IN THE PRESENCE OF THE COUNTY ENGINEER.
 BEFORE WORK CAN BE STARTED, THE CONTRACTOR MUST OBTAIN A PERMIT TO EXCAVATE IN COUNTY SHEETS FROM THE L.A. COUNTY ROAD DEPT., AND MAKE A DEPOSIT WITH THE COUNTY ENGINEER, ROOM 504 PAN AMERICAN BUILDING, 150 SO. BROADWAY, SUFFICIENT TO COVER THE COST OF CONSTRUCTION INSPECTION AND RECORD PLANS.
 APPROVAL OF THIS PLAN BY THE COUNTY OF LOS ANGELES DOES NOT CONSTITUTE A REPRESENTATION AS TO THE ACCURACY OF THE LOCATION OR OF THE EXISTENCE OR NON-EXISTENCE OF ANY UNDERGROUND UTILITY PIPE, OR STRUCTURE WITHIN THE LIMITS OF THIS PROJECT. THIS NOTE APPLIES TO ALL PAGES.
 IF WORK IS TO BE DONE ON A STATE HIGHWAY, A PERMIT MUST BE OBTAINED FROM THE STATE OF CALIFORNIA, DIVISION OF HIGHWAYS, 120 SOUTH BRIDGE STREET.

COUNTY OF LOS ANGELES, CALIFORNIA
 APPROVED, JOHN A. LAMBE, COUNTY ENGINEER
 APPROVED, C.R. COMPTON, CH. ENG.
 CO. SAN. ENG. NO. 20
 BY J. A. Lamb BY C. R. Compton
 SEALATION ENGINEER SEALATION ENGINEER
 CHECKED BY Cal. J. P. Pouch
 OFFICE OF COUNTY ENGINEER, REG. C.E. NO. 10337
 Recommended by R. E. Vukobratovic
 Regional Engineer

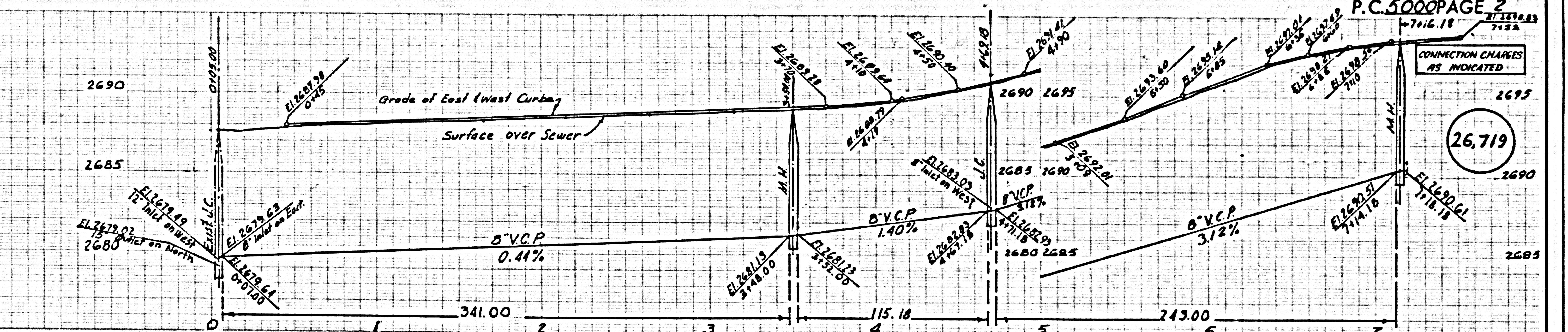

NO	CHARGE	FOR	CONNECTIONS
24	1-0.000 1/2" x 10' 10' 10'		
25	1-0.000 1/2" x 10' 10' 10'		
26	1-0.000 1/2" x 10' 10' 10'		
27	1-0.000 1/2" x 10' 10' 10'		
28	1-0.000 1/2" x 10' 10' 10'		
29	1-0.000 1/2" x 10' 10' 10'		
30	1-0.000 1/2" x 10' 10' 10'		
31	1-0.000 1/2" x 10' 10' 10'		
32	1-0.000 1/2" x 10' 10' 10'		
33	1-0.000 1/2" x 10' 10' 10'		
34	1-0.000 1/2" x 10' 10' 10'		
35	1-0.000 1/2" x 10' 10' 10'		
36	1-0.000 1/2" x 10' 10' 10'		
37	1-0.000 1/2" x 10' 10' 10'		
38	1-0.000 1/2" x 10' 10' 10'		
39	1-0.000 1/2" x 10' 10' 10'		
40	1-0.000 1/2" x 10' 10' 10'		
41	1-0.000 1/2" x 10' 10' 10'		
42	1-0.000 1/2" x 10' 10' 10'		
43	1-0.000 1/2" x 10' 10' 10'		
44	1-0.000 1/2" x 10' 10' 10'		
45	1-0.000 1/2" x 10' 10' 10'		
46	1-0.000 1/2" x 10' 10' 10'		
47	1-0.000 1/2" x 10' 10' 10'		
48	1-0.000 1/2" x 10' 10' 10'		
49	1-0.000 1/2" x 10' 10' 10'		
50	1-0.000 1/2" x 10' 10' 10'		
51	1-0.000 1/2" x 10' 10' 10'		
52	1-0.000 1/2" x 10' 10' 10'		
53	1-0.000 1/2" x 10' 10' 10'		
54	1-0.000 1/2" x 10' 10' 10'		
55	1-0.000 1/2" x 10' 10' 10'		
56	1-0.000 1/2" x 10' 10' 10'		
57	1-0.000 1/2" x 10' 10' 10'		
58	1-0.000 1/2" x 10' 10' 10'		
59	1-0.000 1/2" x 10' 10' 10'		
60	1-0.000 1/2" x 10' 10' 10'		
61	1-0.000 1/2" x 10' 10' 10'		
62	1-0.000 1/2" x 10' 10' 10'		
63	1-0.000 1/2" x 10' 10' 10'		
64	1-0.000 1/2" x 10' 10' 10'		
65	1-0.000 1/2" x 10' 10' 10'		
66	1-0.000 1/2" x 10' 10' 10'		
67	1-0.000 1/2" x 10' 10' 10'		
68	1-0.000 1/2" x 10' 10' 10'		
69	1-0.000 1/2" x 10' 10' 10'		
70	1-0.000 1/2" x 10' 10' 10'		

P.C. 5000 PAGE 2
 26.719
 CONNECTION CHARGES
 AS INDICATED

REIMBURSEMENT CHARGE
 CALL MAIN OFFICE

