

TRACT NO. 24717
PRIVATE CONTRACT NO. 5020

W.S. 33
 2 SHEETS, 4 PAGES
 SCALE: VERT. 1"=6'
 HORIZ. 1"=40'
 DEC. 1, 1950
 PREPARED IN THE OFFICES OF

KEMMERER ENGR. CO. INC.
 BY Robert R. Flinn
 REG. C. E. NO. 11339

FOR LEGEND SEE PLAN NO. S-A-64

NOTE: GRADES TO WHICH THIS IMPROVEMENT IS TO BE CONSTRUCTED ARE SHOWN ON PLANS AND PROFILES. GRADE POINTS FOR TOP OF CURB, CENTER LINE OF STREETS, OR CENTER LINE OF ALLEYS ARE SHOWN BY CIRCLES ON PROFILES. AT ALL POINTS BETWEEN DESIGNATED POINTS THE GRADE SHALL BE ESTABLISHED SO AS TO CONFORM TO A STRAIGHT LINE DRAWN BETWEEN SAID DESIGNATED POINTS.

ELEVATIONS ARE IN FEET ABOVE U.S.C. & G. SEA LEVEL, DATUM OF 1929.

THIS DRAWING AND THE DATA HEREON ARE HEREBY MADE A PART OF THE SPECIFICATIONS.

WORK SHALL BE CONSTRUCTED ACCORDING TO SPECIFICATIONS ON FILE IN THE OFFICE OF THE CITY ENGINEER AND SHALL BE PROSECUTED ONLY IN THE PRESENCE OF THE CITY ENGINEER.

BEFORE WORK CAN BE STARTED, THE CONTRACTOR MUST OBTAIN A PERM TO EXCAVATE IN ALL STREETS FROM THE L.A. COUNTY ROAD DEPT. AND MAKE A DEPOSIT WITH THE CITY OF NORWALK THE COST OF CONSTRUCTION INSPECTION AND RECORD PLANS.

APPROVAL ON THIS PLAN BY THE CITY OF NORWALK DOES NOT CONSTITUTE A REPRESENTATION AS TO THE ACCURACY OF THE LOCATION OF OR THE EXISTENCE OF ANY UTILITIES OR ANY STRUCTURE WITHIN THE LIMITS OF THIS PROJECT. THIS NOTE APPLIES TO ALL PAGES.

IF WORK IS TO BE DONE IN A STATE HIGHWAY, A PERMIT SHALL BE OBTAINED FROM THE STATE OF CALIFORNIA, DIVISION OF HIGHWAYS, 120 SOUTH SPRING STREET.

CITY OF NORWALK, CALIFORNIA

APPROVED, JOHN A. LAIBER, CITY ENGINEER
 APPROVED, C.E. SHANNON, CHIEF ENGINEER
 CO. SEAL NO. 100

BY G. H. Hughes SANITATION ENGINEER
 BY J. P. ... OFFICE ENGINEER

CHECKED BY De Oude 2-17-51
 OFFICE OF CITY ENGINEER, REG. C. E. NO. 9426

SUBMITTED BY: John J. Peter 2-5-51
 JUS. CERTIFICADO RESUMAL ENGINEER REG. NO. 9878

NORWALK BLDG. DIST. NO. 406

- NOTE: PROVIDE STAKES ON THE PROPERTY LINE OR PROPERTY LINES PRODUCED AT RIGHT ANGLES TO THE SEWER LINE AT THE CENTER LINE OF EACH MANHOLE.
- NO REPRESENTATIVE OF THE CITY ENGINEER WILL SURVEY OR LAYOUT ANY PORTION OF THE WORK.
- THE OWNER OR HIS AUTHORIZED REPRESENTATIVE SHALL FURNISH THE CITY ENGINEER WITH GRADE SHEETS AND STATION FOR ALL HOUSE LATERALS AND Y BRANCHES AND SHALL PROVIDE STAKES FOR THEM AT THEIR PROPER LOCATIONS WITH STATION AND PLAINLY MARKED. ANY CHANGE IN LOCATION SHALL BE REQUESTED IN WRITING BY THE OWNER OR HIS REPRESENTATIVE.
- NO HYPOTHESIS SHALL BE MADE IN THESE PLANS WITHOUT THE APPROVAL OF THE CITY ENGINEER.
- USE STANDARD MANHOLE'S HEADS AND COVERS, S-A-117.
 - USE STANDARD STRENGTH PIPE EXCEPT AS NOTED.
 - USE 6" CONCRETE MANHOLE-TUBES-HEADS-AND-COVERS-EXCEPT-WHERE-SPECIFIED-OTHERWISE-ON-PLANS-OR-IN-RECORD-SPEC. SEC. 34.26.48.
 - RESURFACE ALL TRINCH WITHIN PAVED AREA TO MEET L. A. COUNTY ROAD DEPT. OR CALIF. STATE HIGHWAY DEPT. REQUIREMENTS IN ACCORDANCE WITH PERMITS.
 - ENCASE FOUR FEET OF SEWER AT POINTS OF INTERFERENCE WITH POLES, S-A-79, CASE II.
 - HOUSE LATERALS TO BE CONSTRUCTED WITH INVERTS AT PROPERTY LINE 6" FEET BELOW CURB GRADE EXCEPT AS NOTED.
 - ALL STRUCTURES SHALL BE BRICK SEWER STRUCTURES, S-A-104, EXCEPT AS NOTED.
 - FOR ALLOWABLE SEWAGE TEST USE FORMULA NO. 2 SPEC'S, SEC. 54.
 - MANHOLE TOPS IN UNIMPROVED RIGHTS-OF-WAY TO BE 6" ABOVE FINISHED GRADE.
 - THE PRIVATE ENGINEER IS TO FURNISH THE HOUSE LATERAL DEPTH AT THE PROPERTY LINE AS SHOWN THE TOP OF CURB ELEVATION FOR EACH HOUSE LATERAL ON THE GRADE SHEET.
 - USE JOINT COMPRISING "WATER-TIGHT" OR "WATER-TIGHT" FOR ALL WROUGHT IRON JOINTS AND BRICK SEC'S 34.26.48 & 34.26.49. GROUND WATER IS ENCOUNTERED USE METAL POINTS & QUALITY "WATER-TIGHT" OR "WATER-TIGHT" FOR ALL JOINTS PER SPEC'S SEC'S 34.26.46, & 48.

B.M. 3 1/2" DIA SPIKE & LEAD 15' E. OF CURB RETURN AT N.E. COR. ALONDREA & HARVEST AVE. ELEV. 71.679

NOTE: THE CONTRACTOR SHALL NOTIFY THE CONSTRUCTION AND STORM DRAIN DIVISION BY TELEPHONE, MADISON 9-4747, EX. 332, AT LEAST 24 HOURS BEFORE STARTING ANY WORK UNDER THIS CONTRACT.

REVISION: May 1953
 Changed lot Numbers, lot dimensions. Removed a few lots. Moved Harvest Ave. 3' Easterly. Changed Curb Elev. on 165th St.
 Checked by J. P. ...

NOTE: Lot 62 is to be served by sewer in 163rd St. see P.C. 5031.

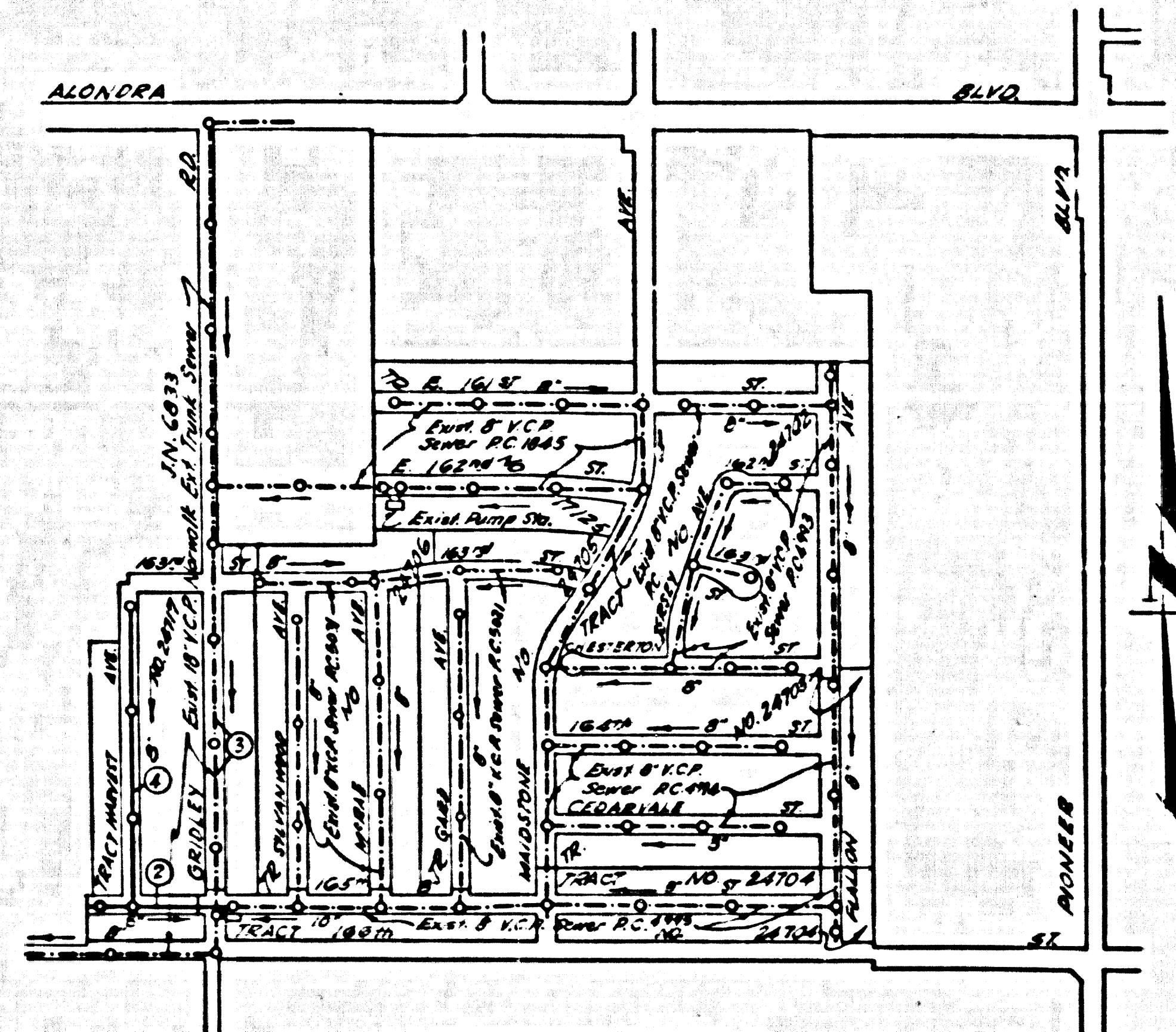

INDEX MAP
 TRACT NO. 24717
 P.C. 5020 SCALE: 1"=500'

NO CHARGE FOR CONNECTIONS
2-17-51

