

BENCH MARK No. 27-77 F.C.B.M. 114-53 ELEV. 47.731
 C.S.P. 1933-65-833 Dominguez Channel at 139th St. and W.
 side of channel 162' E. of centerline Crenshaw Blvd. on
 centerline prod. of 13.7th St. 22' W. of a 6" concrete wall,
 55' S. of a 2" I.P. marker. A std. F.C. Mon. stamped B.M. 114-53,
 R.Y. 114-9, 1948 set in concrete 12" below surface.

NO CHARGES
 FOR CONNECTIONS
 7/1/57

LENNOX BLDG. DIST. NO. 7

- NOTES
1. PROVIDE STAKES ON THE PROPERTY LINE OR PROPERTY LINES PRODUCED AT RIGHT ANGLES TO THE SEWER LINE AT THE CENTER LINE OF EACH MANHOLE.
 2. NO REPRESENTATIVE OF THE COUNTY ENGINEER WILL SURVEY OR LAY OUT ANY PORTION OF THE WORK.
 3. THE OWNER OR HIS AUTHORIZED REPRESENTATIVE SHALL FURNISH THE COUNTY ENGINEER WITH GRAB SHEETS AND STATIONING FOR ALL HOUSE LATERALS AND Y BRANCHES AND SHALL PROVIDE STAKES FOR THEM AT THEIR PROPER LOCATIONS WITH STATIONING PLAINLY MARKED. ANY CHANGE IN LOCATION SHALL BE REQUESTED IN WRITING BY THE OWNER OR HIS REPRESENTATIVE.
 4. THE PRIVATE ENGINEER SHALL FURNISH THE HOUSE LATERAL DEPTH AT THE PROPERTY LINE BELOW THE TOP OF CURB ELEVATION FOR EACH HOUSE LATERAL ON THE GRADE SHEET.
 5. NO REVISIONS SHALL BE MADE IN THESE PLANS WITHOUT THE APPROVAL OF THE COUNTY ENGINEER.
 6. USE STANDARD MANHOLE FRAMES AND COVERS, S-117, EXCEPT AS NOTED.
 7. USE STANDARD STRENGTH PIPE EXCEPT AS NOTED.
 8. USE CEMENT MORTAR OR "WEDGE-LOCK" OR "SPREAD-SEAL" FOR ALL V.C.P. JOINTS PER SPEC., SPEC. 26 & 48.
 9. RESURFACE ALL TRENCH WITHIN PAVED AREA TO MEET L.A. COUNTY ROAD DEPT. OR CALIF. STATE HIGHWAY REQUIREMENTS IN ACCORDANCE WITH PERMITS.
 10. INDICATE FOUR FEET OF SEWER AT POINTS OF "REFERENCE" IN V. POLAR, CASE NO. S-4-172.
 11. HOUSE LATERALS TO BE CONSTRUCTED WITH 18" V.C.P. PER SPEC. 26, SPEC. 26, SEC. 54.
 12. ALL STRUCTURES SHALL BE EXIST STRUCTURES, S-116, EXCEPT AS NOTED.
 13. FOR ALLOWABLE LEAKAGE TEST USE FORMULA NO. 1, SPEC. 26, SEC. 54.
 14. MANHOLE YARDS IN UNIMPROVED RIGHTS-OF-WAY TO BE SIX INCHES ABOVE FINISHED GRADE.
 15. THE CONTRACTOR SHALL NOTIFY THE CONSTRUCTION & STORM DRAIN DIVISION BY TELEPHONE, MADISON 9-674, EXT. 242, AT LEAST TWENTY FOUR HOURS BEFORE STARTING ANY WORK UNDER THIS CONTRACT.

PROFILE ALIGNMENT AND GRADE OF P.C. 5081
 SANITARY SEWERS PAGE 1
 TO BE CONSTRUCTED IN J.N. 0350. 42

TRACT NO. 24536
 PRIVATE CONTRACT NO. 5081

W.S. 25
 1 SHEETS, 2 PAGES
 SCALE: VERT. 1" = 4'
 HORIZ. 1" = 40'
 MARCH, 1957
 PREPARED IN THE OFFICE OF

29,730

Glenwood
 REG. C. E. NO. 2491
 FOR LEGEND SEE PLAN NO. S-A-64

NOTE
 GRADES TO WHICH THIS IMPROVEMENT IS TO BE CONSTRUCTED ARE SHOWN ON PLANS AND PROFILES. GRADE POINTS FOR TOP OF CURB, CENTER LINE OF STREETS, OR CENTER LINE OF ALLEYS ARE SHOWN BY CIRCLES ON PROFILES. AT ALL POINTS BETWEEN DESIGNATED POINTS THE GRADE SHALL BE ESTABLISHED SO AS TO CONFORM TO A STRAIGHT LINE DRAWN BETWEEN SAID DESIGNATED POINTS.
 ELEVATIONS ARE IN FEET ABOVE U.S.C. & G.S. SEA LEVEL DATUM OF 1929.
 THIS DRAWING AND THE DATA HEREON ARE HEREBY MADE A PART OF THE SPECIFICATIONS.
 WORK SHALL BE CONSTRUCTED ACCORDING TO SPECIFICATIONS ON FILE IN THE OFFICE OF THE COUNTY ENGINEER AND SHALL BE PROCEEDED ONLY IN THE PRESENCE OF THE COUNTY ENGINEER.
 BEFORE WORK CAN BE STARTED, THE CONTRACTOR MUST OBTAIN A PERMIT TO EXCAVATE IN COUNTY STREETS FROM THE L.A. COUNTY ROAD DEPT., DISTRICT OFFICE NO. 10, 3300 S. MAIN ST., LOS ANGELES, CALIF. MAKE A DEPOSIT WITH THE COUNTY ENGINEER, ROOM 324 MAIN AMERICAN BUILDING, 125 SO. JACKSON ST. TO COVER THE COST OF CONSTRUCTION INSPECTION AND RECORD PLANS.
 APPROVAL OF THIS PLAN BY THE COUNTY OF LOS ANGELES DOES NOT CONSTITUTE A REPRESENTATION AS TO THE ACCURACY OF THE LOCATION OR OF THE EXISTENCE OR NON-EXISTENCE OF ANY UNRECORDED UTILITY PIPE, OR STRUCTURE WITHIN THE LIMITS OF THIS PROJECT. THIS NOTE APPLIES TO ALL PAGES.
 IF WORK IS TO BE DONE IN A STATE HIGHWAY, A PERMIT MUST BE OBTAINED FROM THE STATE OF CALIFORNIA, DIVISION OF HIGHWAYS, 120 SOUTH SPRING STREET.

COUNTY OF LOS ANGELES, CALIFORNIA
 APPROVED, JOHN A. LAMBE, COUNTY ENGINEER
 APPROVED, A. M. RAWN, CHIEF ENGINEER
 CO. SAN. DIST. NO. 5
 BY *[Signature]* BY *[Signature]*
 SANITATION ENGINEER OFFICE ENGINEER
 CHECKED BY *[Signature]* E-159
 OFFICE OF COUNTY ENGINEER, REG. C. E. NO. 2491
 REVISION APPROVED: *[Signature]* 7-21-57
 NOTE: 8" V.C.P. Sewer in Slayton St. revised to connect to
 Exist. J.C. in Cerise Ave. (New 8" V.C.P. Sewer
 Constructed West of 25" P.C.P. Storm Drain.)
 Ref. C. E. 1211 Proj. No. 536. July 25, 1950.

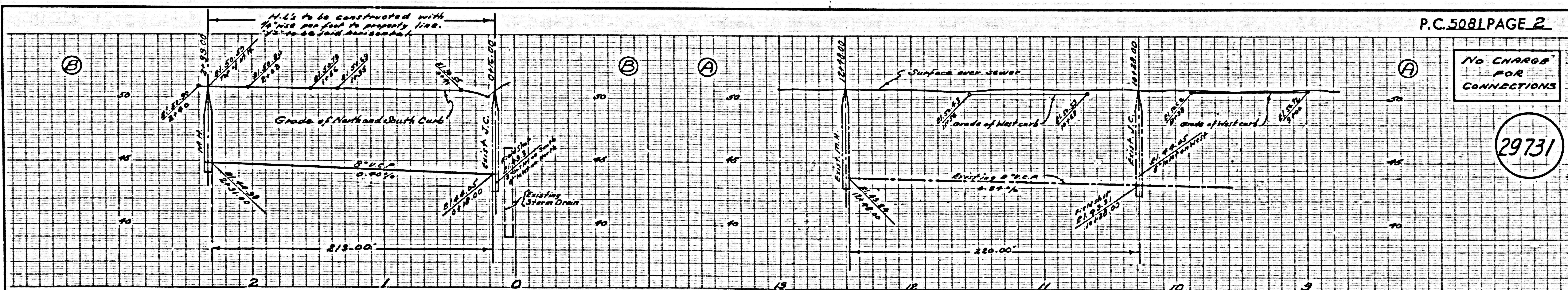
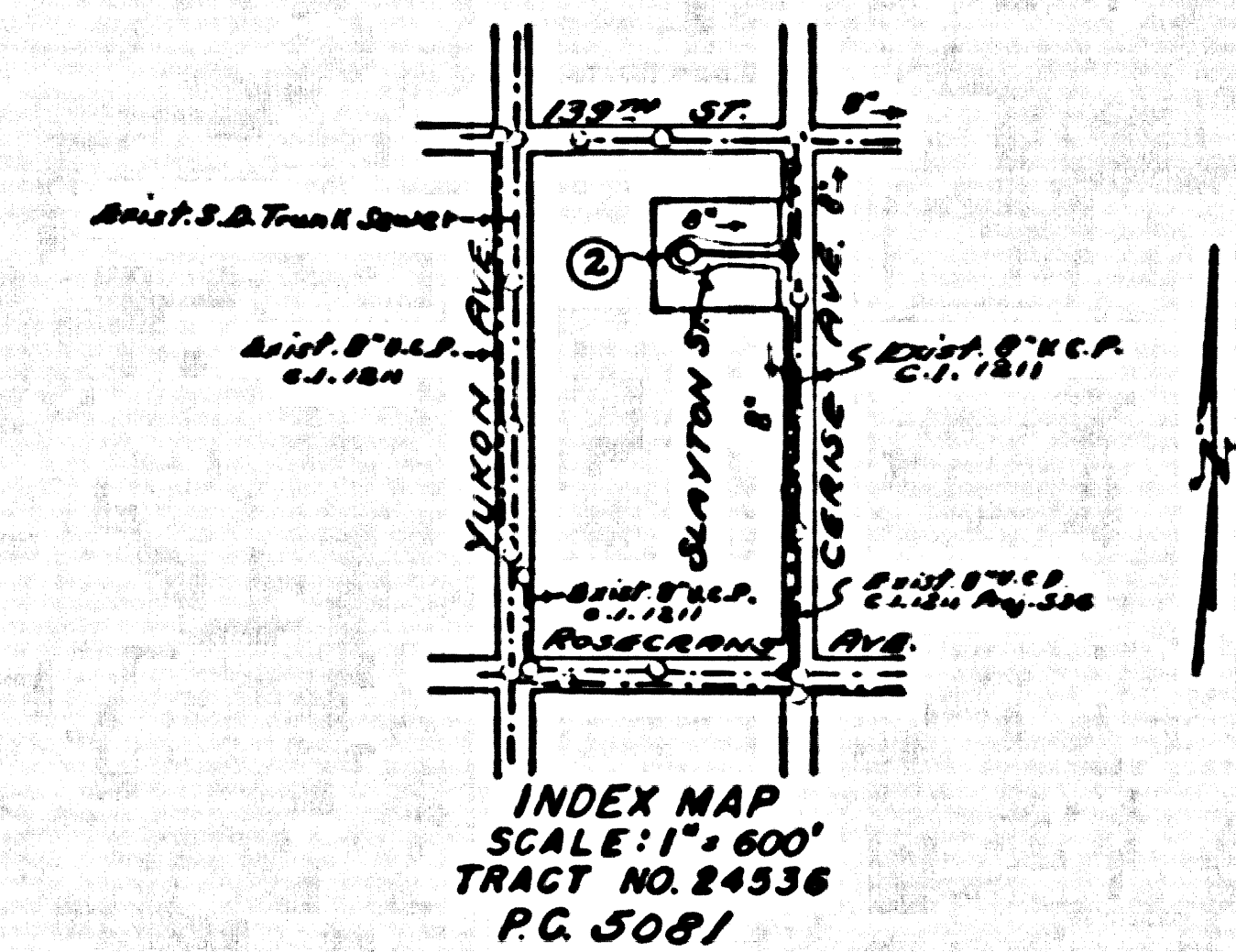

P.C. 5081 PAGE 2

NO CHARGES FOR CONNECTIONS

29,731

