

S.M. PL. DIST. SY 998 N.W. COR. CRENSHAW BLVD. & EL SEGUNDO BLVD. LEAD & BT. MAIL E. COR. CATHY BASIN ELEV. = 99.234 (1955 ADJ.) BASE LINE 115.

INDEX TABLE

SHEETS	PAGES
1	2

CONNECTION CHARGES AS INDICATED
F. K. K. 4-28-57

LENNOX BLDG. DIST. NO. 7

- NOTE:
- PROVIDE 8" X 8" ON THE PROPERTY LINE OR PROPERTY LINES PRODUCED AT RIGHT ANGLES TO THE SEWER LINE AT THE CENTER LINE OF EACH MANHOLE.
 - NO REPRESENTATIVE OF THE COUNTY ENGINEER WILL SURVEY OR LAY OUT ANY PORTION OF THE WORK.
 - THE OWNER OR HIS AUTHORIZED REPRESENTATIVE SHALL FURNISH THE COUNTY ENGINEER WITH GRADE SHEETS AND STATIONINGS FOR ALL HOUSE LATERALS AND V BRANCHES AND SHALL PROVIDE STAKES FOR THEM AT THEIR PROPER LOCATIONS WITH STATIONING PLAINLY MARKED. ANY CHANGE IN LOCATION SHALL BE REQUESTED IN WRITING BY THE OWNER OR HIS REPRESENTATIVE.
 - THE PRIVATE BUSINESS SHALL FURNISH THE HOUSE LATERAL DEPTH AT THE PROPERTY LINE BELOW THE TOP OF CURB ELEVATION FOR EACH HOUSE LATERAL ON THE GRADE SHEET.
 - NO REVISIONS SHALL BE MADE IN THESE PLANS WITHOUT THE APPROVAL OF THE COUNTY ENGINEER.
 - USE STANDARD MANHOLE FRAMES AND COVERS, S-117, SLEPT AS NOTED.
 - USE STANDARD TRENCHING PIPE PER SPEC. AS NOTED.
 - USE CHAINING MORTAR OR "WEDGE-LOCK" OR "WEDGE-BEAR" FOR ALL V.C.P. JOINTS PER SPEC., SECS. 11 & 12.
 - RESURFACE ALL TRENCH WITHIN PAVED AREA TO MEET L.A. COUNTY ROAD DEPT. OR CALIF. STATE HIGHWAY DEPARTMENT'S IN ACCORDANCE WITH PERMITS.
 - ENCASE FOUR FEET OF SEWER AT POINTS OF INTERFERENCE WITH POLES, CASE 11, S-172.
 - HOUSE LATERALS TO BE CONSTRUCTED WITH 1/2" RIS PER FOOT TO "PROPERTY LINE" GRADE.
 - ALL STRUCTURES SHALL BE BRICK SAWS STRUCTURAL, S-104, EXCEPT AS NOTED.
 - FOR ALLOWABLE SEWAGE TREATMENT USE FORMULA NO. 1, SPEC., SEC. 84.
 - MANHOLE TOPS IN UNIMPROVED RIGHTS-OF-WAY TO BE SIX INCHES ABOVE FINISHED GRADE.
 - THE CONTRACTOR SHALL NOTIFY THE CONSTRUCTION & SPERM BRANCH DIVISION BY TELEPHONE, MADISON 9-874, EXT. 342, AT LEAST TWENTY-FOUR HOURS BEFORE STARTING ANY WORK UNDER THIS CONTRACT.

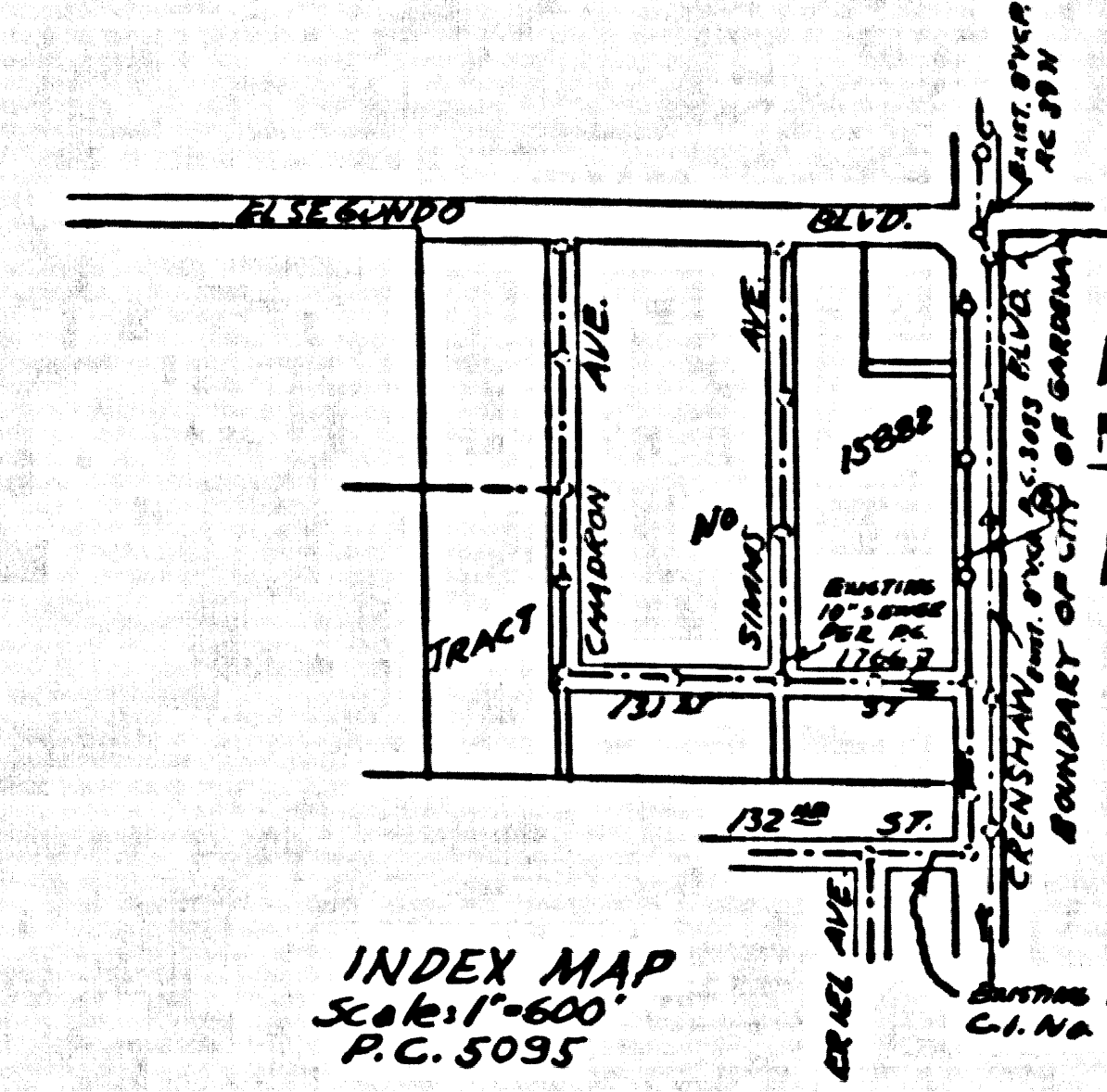

PROFILE ALIGNMENT AND GRADE OF **P.C. 5095**
SANITARY SEWERS PAGE 1
 TO BE CONSTRUCTED IN
CRENSHAW BLVD.
 FROM 131ST ST. TO 180 FT. SOUTH OF
 EL SEGUNDO BLVD.

PRIVATE CONTRACT NO. 5095

W.S. 25
 1 SHEET, 2 PAGES

SCALE: VERT. 1" = 4' HORIZ. 1" = 20'
 FEB. 27, 1959
 PREPARED IN THE OFFICE OF
L.D. LEEPER

27753

FOR LEGEND SEE PLAN NO. S-A-64

NOTES:
 GRADES TO WHICH THIS IMPROVEMENT IS TO BE CONSTRUCTED ARE SHOWN ON PLANS AND PROFILE. GRADE POINTS FOR TOP OF CURB, CENTER LINE OF STREET, OR CENTER LINE OF ALLEY ARE SHOWN BY CIRCLES ON PROFILES AT ALL POINTS BETWEEN DESIGNATED POINTS THE GRADE SHALL BE ESTABLISHED SO AS TO CONFORM TO A STRAIGHT LINE DRAWN BETWEEN SAID DESIGNATED POINTS.
 ELEVATIONS ARE IN FEET ABOVE U.S.C. & G.S. SEA LEVEL DATUM OF 1929.
 THIS DRAWING AND THE DATA HEREON ARE HEREBY MADE A PART OF THE SPECIFICATIONS.
 WORK SHALL BE CONSTRUCTED ACCORDING TO SPECIFICATIONS ON FILE IN THE OFFICE OF THE COUNTY ENGINEER AND SHALL BE PROSECUTED ONLY IN THE PRESENCE OF THE COUNTY ENGINEER.
 BEFORE WORK CAN BE STARTED, THE CONTRACTOR MUST OBTAIN A PERMIT TO EXCAVATE IN COUNTY ENGINEER'S ROOM IN THE L.A. COUNTY ROAD DEPT., DISTRICT OFFICE NO. 3, AND MAKE A REPORT WITH THE COUNTY ENGINEER, ROOM 234 FARM ARCADE BLDG., 230 S. HOUGHWAY, SUPERVISOR TO COVER THE COST OF CONSTRUCTION INSPECTION AND RECORD PLANS. APPROVAL OF THIS PLAN BY THE COUNTY OF LOS ANGELES DOES NOT CONSTITUTE A REPRESENTATION AS TO THE ACCURACY OF THE LOCATION OF OR THE EXISTENCE OR NON-EXISTENCE OF ANY UNDERGROUND UTILITY PIPE, OR STRUCTURE WITHIN THE LIMITS OF THE PROJECT. THIS NOTE APPLIES TO ALL PAGES.
 IF WORK IS TO BE DONE IN A STATE HIGHWAY, A PERMIT MUST BE OBTAINED FROM THE STATE OF CALIFORNIA, DIVISION OF HIGHWAYS, 120 SOUTH BRIDGE STREET.

COUNTY OF LOS ANGELES, CALIFORNIA

APPROVED, JOHN A. LAMME, COUNTY ENGINEER
 APPROVED, C. C. MATTY, CHIEF ENGINEER
 BY *L. D. Leeper* BY *C. C. Matty*
 LAMME ENGINEER MATTY CHIEF ENGINEER
 CHECKED BY *G. J. White* 4-27-59
 OFFICE OF COUNTY ENGINEER, 800 S. E. NO. 9486
 Approved By *Bernard J. Valerius* 5/20/59
 Industrial Waste Division

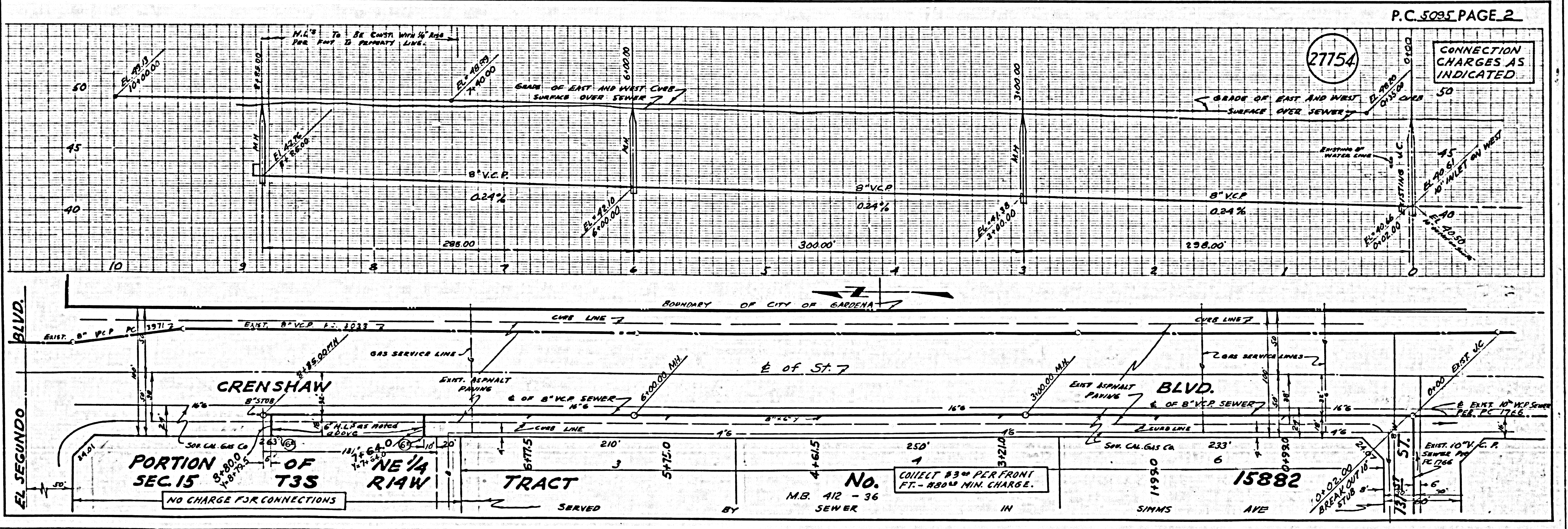

P.C. 5095 PAGE 2

27754

CONNECTION CHARGES AS INDICATED.

U.S.G. & G.S. 1929, 1943, 1955, 1960, 1963, 1967, 1971, 1973, 1975, 1978, 1980, 1983, 1985, 1988, 1990, 1993, 1995, 1998, 2000, 2003, 2005, 2008, 2010, 2013, 2015, 2018, 2020, 2023, 2025