

E. LOS ANGELES BLDG. DIST. NO. 6

PROFILE ALIGNMENT AND GRADE OF P.C. 5134
 SANITARY SEWERS PAGE 1
 TO BE CONSTRUCTED IN J.N. 0350.78

BEVERLY BOULEVARD

PRIVATE CONTRACT NO. 5134

W.S. 36

1 SHEET, 2 PAGES

SCALE: VERT. 1" = 4' HORIZ. 1" = 40'

APRIL, 1959

PREPARED IN THE OFFICES OF

SULLIVAN, PSONAS AND YOUNG

ENGINEERS SURVEYORS

BY: *[Signature]* REG. C. E. NO. 1518

FOR LEGEND SEE PLAN NO. S-A-64

28,221

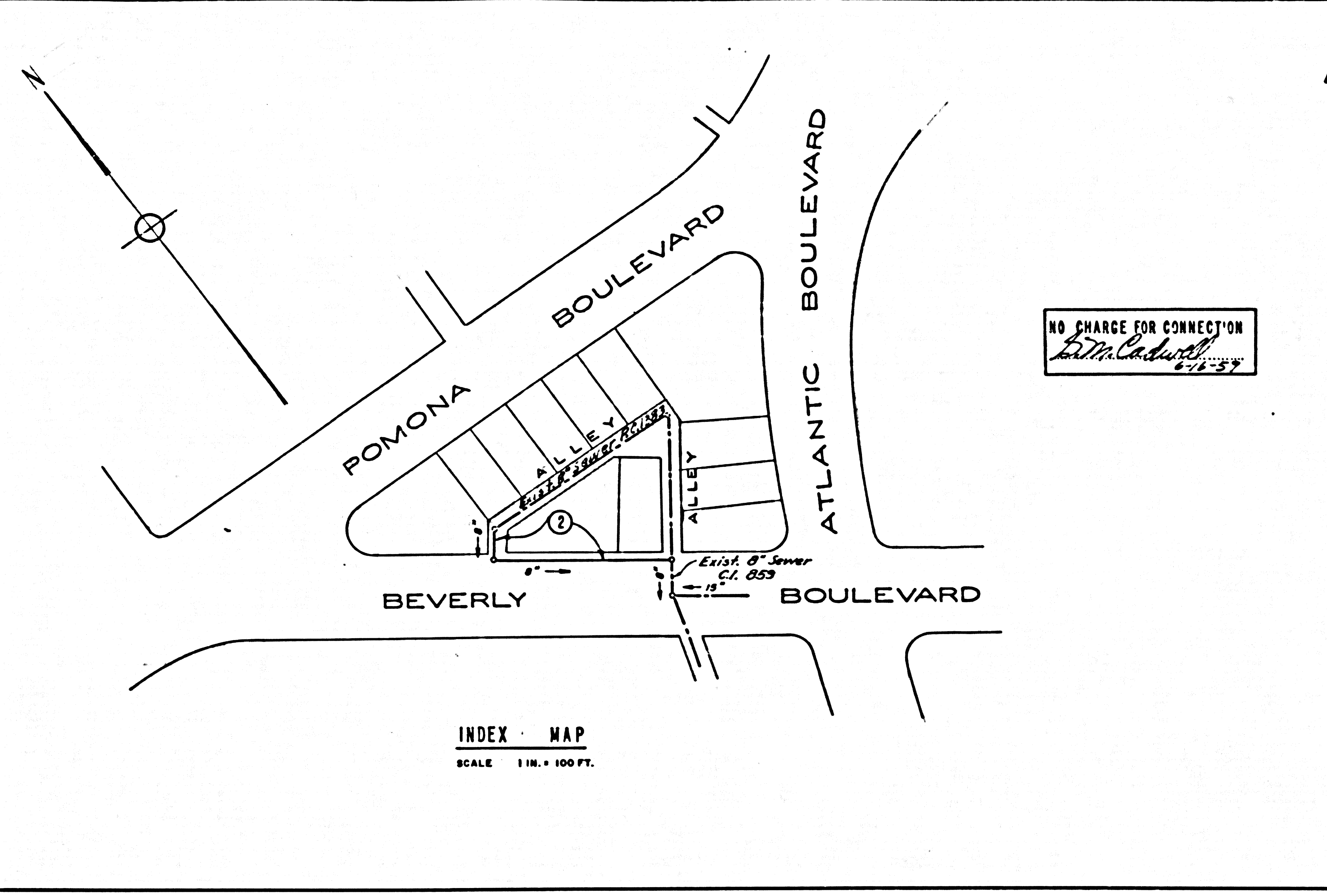

NO CHARGE FOR CONNECTION
[Signature]
 6-15-57

- NOTES
- PROVIDE STAKES ON THE PROPERTY LINE OR PROPERTY LINES PRODUCED AT RIGHT ANGLES TO THE SEWER LINE AT THE CENTER LINE OF EACH MANHOLE.
 - NO REPRESENTATIVE OF THE COUNTY ENGINEER WILL SURVEY OR LAY OUT ANY PORTION OF THE WORK.
 - THE OWNER OR HIS AUTHORIZED REPRESENTATIVE SHALL FURNISH THE COUNTY ENGINEER WITH GRADY SHIFTS AND STATIONING FOR ALL HOUSE LATERALS AND Y BRANCHES AND SHALL PROVIDE STAKES FOR THEM AT THEIR PROPER LOCATIONS WITH STATIONING PLAINLY MARKED. ANY CHANGE IN LOCATION SHALL BE REQUESTED IN WRITING BY THE OWNER OR HIS REPRESENTATIVE.
 - THE PRIVATE ENGINEER SHALL FURNISH THE HOUSE LATERAL DEPTH AT THE PROPERTY LINE BELOW THE TOP OF CURB ELEVATION FOR EACH HOUSE LATERAL ON THE GRADE SHEET.
 - NO DIFFERENCES SHALL BE MADE IN THESE PLANS WITHOUT THE APPROVAL OF THE COUNTY ENGINEER.
 - USE STANDARD MANHOLE FRAMES AND COVERS, S-117.
 - USE STANDARD STRENGTH PIPE EXCEPT AS NOTED.
 - USE CEMENT MORTAR OR "WOOD BLOCK" OR "SHEB SEAL" FOR ALL V.C.P. JOINTS PER SPECS., SECS. 24 & 25.
 - RESURFACE ALL TRENCH WITHIN PAVED AREA TO MEET L.A. COUNTY ROAD DEPT. OR CALIF. STATE HIGHWAY REQUIREMENTS IN ACCORDANCE WITH PERMITS.
 - ENCASE FOUR FEET OF SEWER AT POINTS OF INTERFERENCE WITH POLES, CASE III, S-1-1/2.
 - HOUSE LATERALS TO BE CONSTRUCTED WITH INVERTS OF PROPOSED 8" V.C.P. TO BE AT LEAST TWENTY-FOUR INCHES ABOVE FINISHED GRADE.
 - ALL STRUCTURES SHALL BE BRICK SEWER STRUCTURES, S-1-104.
 - FOR ALLOWABLE LEAKAGE TEST USE FORMULA NO. 1, SPECS., SEC. 24.
 - MANHOLE TOPS IN UNIMPROVED RIGHTS-OF-WAY TO BE SIX INCHES ABOVE FINISHED GRADE.
 - THE CONTRACTOR SHALL NOTIFY THE CONSTRUCTION & STORM DRAIN DIVISION BY TELEPHONE, MADISON 9-270, EXT. 342, AT LEAST TWENTY-FOUR HOURS BEFORE STARTING ANY WORK UNDER THIS CONTRACT.
 - STANDARD SPECIFICATIONS DATED MAY 18, 1953 APPLY IN THE CONSTRUCTION OF THIS PROJECT.
 - CONTRACTOR SHALL ADVISE MR. HANWETT OF THE COUNTY TRAFFIC AND LIGHTING DIVISION AT CAPITOL 2-5811 AND MR. CARL M. FORTNER OF THE CALIFORNIA WATER SERVICE CO. AT ANGELUS 1-218 PRIOR TO BEGINNING EXCAVATION AT THIS LOCATION.

B.M. No. SY 4184, Elev. = 240.868, L.A. Co. Rd. Dept. B.M. P-333
 320 Street and Atlantic Blvd. SW corner, L & T in concrete base
 of traffic signal island, 46' South and 46' West of intersection.

NOTE:
 GRADES TO WHICH THIS IMPROVEMENT IS TO BE CONSTRUCTED ARE SHOWN ON PLANS AND PROFILES. GRADE POINTS FOR TOP OF CURB, CENTER LINE OF STREETS OR CENTER LINE OF ALLEYS ARE SHOWN ON PROFILES AT ALL POINTS BETWEEN DESIGNATED POINTS. THE GRADE SHALL BE ESTABLISHED SO AS TO COMPARE TO A STRAIGHT LINE DRAWN BETWEEN SAID DESIGNATED POINTS.
 ELEVATIONS ARE IN FEET ABOVE U.S.C. & G.S. MEAN LEVEL DATUM OF 1929.
 THE DRAWING AND THE DATA HEREON ARE HEREBY MADE A PART OF THE SPECIFICATIONS.
 WORK SHALL BE CONSTRUCTED ACCORDING TO SPECIFICATIONS ON FILE IN THE OFFICE OF THE COUNTY ENGINEER AND SHALL BE PROSECUTED ONLY IN THE PRESENCE OF THE COUNTY ENGINEER.
 BEFORE WORK CAN BE STARTED, THE CONTRACTOR MUST OBTAIN A PERMIT TO EXCAVATE IN COUNTY STREETS FROM THE L.A. COUNTY ROAD DEPT., DISTRICT OFFICE NO. 6, AND MAKE A DEPOSIT WITH THE COUNTY ENGINEER, ROOM 323 SAN AMERICAN BUILDING, 210 SO. BROADWAY SUFFICIENT TO COVER THE COST OF CONSTRUCTION INSPECTION AND RECORD PLANS.
 APPROVAL OF THIS PLAN BY THE COUNTY OF LOS ANGELES DOES NOT CONSTITUTE A REPRESENTATION AS TO THE ACCURACY OF THE LOCATION OF OR THE EXISTENCE OR NON-EXISTENCE OF ANY UNRECORDED UTILITY PIPE, OR STRUCTURE WITHIN THE LIMITS OF THIS PROJECT. THIS NOTE APPLIES TO ALL PAGES.
 IF WORK IS TO BE DONE IN A STATE HIGHWAY, A PERMIT MUST BE OBTAINED FROM THE STATE OF CALIFORNIA, DIVISION OF HIGHWAYS, 120 SOUTH SPRING STREET.

COUNTY OF LOS ANGELES, CALIFORNIA

APPROVED, JOHN A. LAMBE, COUNTY ENGINEER
 APPROVED, E.R. COMPTON - CHIEF ENGINEER
 TO SAN. DIST. NO. 6

BY: *[Signature]* BY: *[Signature]*
 SANITATION ENGINEER OFFICE ENGINEER

CHECKED BY: *[Signature]*
 OFFICE OF COUNTY ENGINEER, REG. C. E. NO. 9406

SUBMITTED: *[Signature]*
 SAN GABRIEL VALLEY REGIONAL ENGINEER

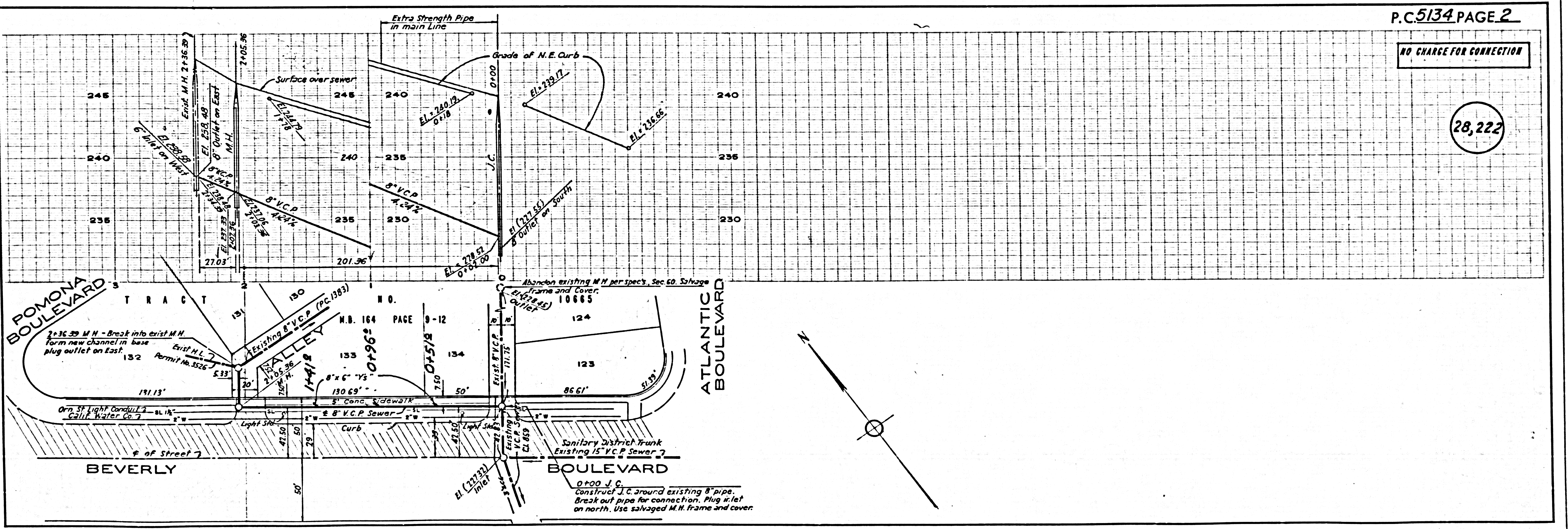

P.C. 5134 PAGE 2

NO CHARGE FOR CONNECTION

28,222