

**WHITTIER BLDG. DIST. NO. 11**

PROFILE ALIGNMENT AND GRADE OF **P.C. 5139**  
**SANITARY SEWERS PAGE 1**  
 TO BE CONSTRUCTED IN **J.N. 0350.81**  
**RIGHT OF WAY**  
**SOUTH OF WASHINGTON BLVD**

**PRIVATE CONTRACT NO. 5139**  
**JOB NUMBER 0350.81**  
 W.S. 37

27918

1 SHEET, 2 PAGES  
 SCALE: V.E. 1" = 20' HORIZ. 1" = 2' VERT.  
 APR., 1959

PREPARED IN THE OFFICES OF  
**KEMMERER ENGINEERING CO. INC.**  
 BY Robert R. Flores  
 REG. C. E. NO. 11249

FOR LEGEND SEE PLAN NO. S-A-64

- NOTES:**
- PROVIDE STAKES ON THE PROPERTY LINE OR PROPERTY LINES PRODUCED AT RIGHT ANGLES TO THE SEWER LINE AT THE CENTER LINE OF EACH MANHOLE.
  - NO REPRESENTATIVE OF THE COUNTY ENGINEER WILL SURVEY OR LAYOUT ANY PORTION OF THE WORK.
  - THE OWNER OR HIS AUTHORIZED REPRESENTATIVE SHALL FURNISH THE COUNTY ENGINEER WITH GRADE SHEETS AND STATION FOR ALL HOUSE LATERALS AND Y BRANCHES AND SHALL PROVIDE STAKES FOR THESE AT THEIR PROPER LOCATIONS WITH STATIONING PLAINLY MARKED. ANY CHANGE IN LOCATION SHALL BE REQUESTED BY WRITING BY THE OWNER OR HIS REPRESENTATIVE.
  - NO REVISIONS SHALL BE MADE IN THESE PLANS WITHOUT THE APPROVAL OF THE COUNTY ENGINEER.
  - USE STANDARD MANHOLE FRAMES AND COVERS, S.A. 117, EXCEPT AS NOTED.
  - USE STANDARD STRENGTH PIPE.
  - USE CEMENT MORTAR FOR ALL VITRIFIED CLAY PIPE JOINTS.
  - RESURFACE ALL TRENCH WITHIN PAVED AREA TO MEET L. A. COUNTY ROAD DEPT., OR CALIF. STATE HIGHWAY DEPT. REQUIREMENTS IN ACCORDANCE WITH PERMITS.
  - ENCASE FOUR FEET OF SEWER AT POINTS OF INTERFERENCE WITH POLES, S.A. 172 - CASE III.
  - ALL STRUCTURES SHALL BE BUILT SEWER STRUCTURES, S-A-104, EXCEPT AS NOTED.
  - FOR ALLOWABLE SIZES SEE FORMULA NO. 1 SPEC. SEC. 54.
  - MANHOLE TOPS IN UNIMPROVED RIGHTS-OF-WAY TO BE LEVEL WITH FINISH GRADE.
- Standard Specifications dated May 15, 1959 apply in the construction of this project.

**NOTE:**  
 THE CONTRACTOR SHALL NOTIFY THE CONSTRUCTION AND STORM DRAIN DIVISION BY TELEPHONE, MADISON 9-4747, EX. 302, AT LEAST 24 HOURS BEFORE STARTING ANY WORK UNDER THIS CONTRACT.

**NO CHARGE FOR CONNECTIONS**  
 E. Order 5-21-59

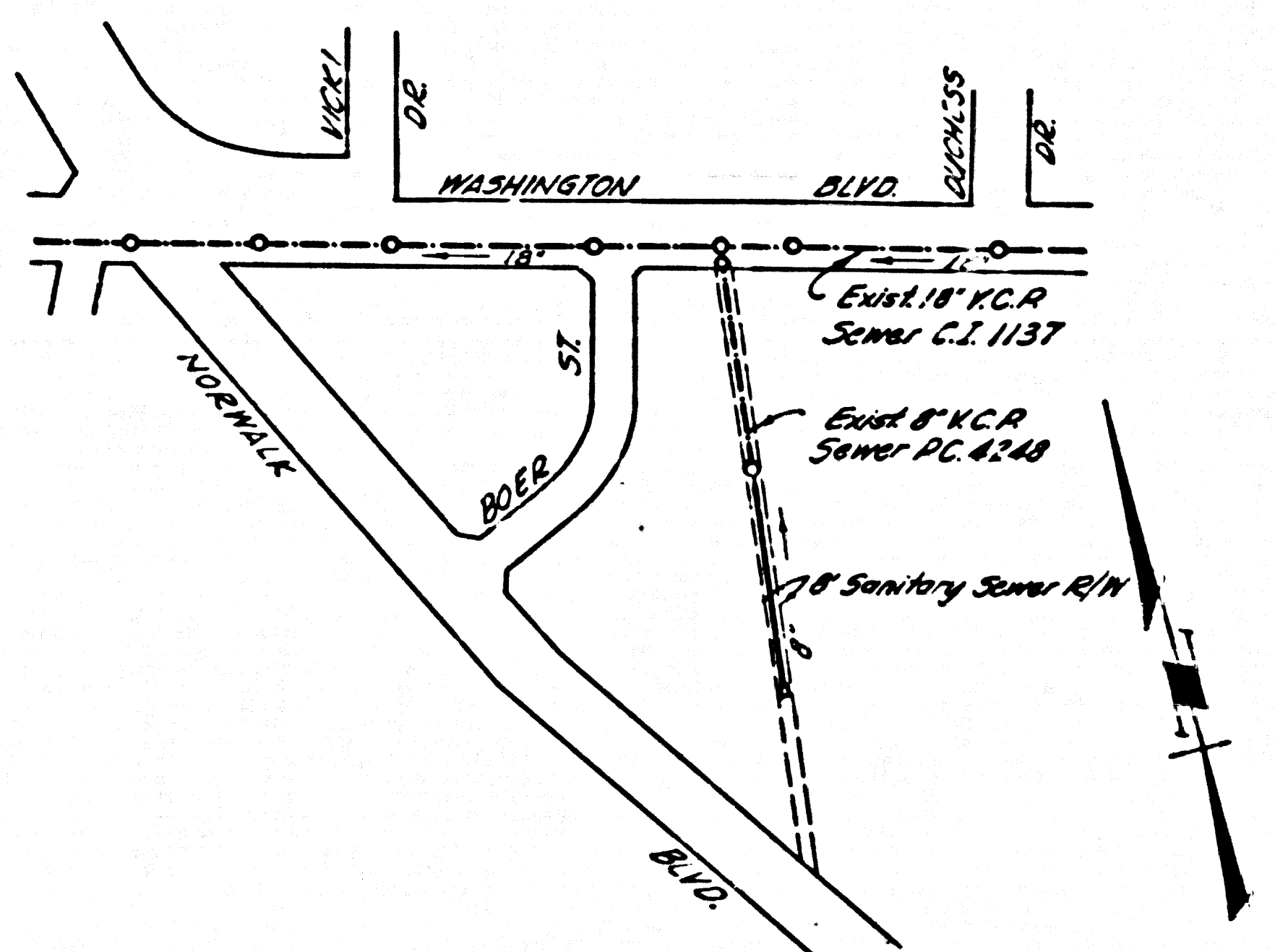

**INDEX MAP**  
 P.C. 5139 SCALE: 1" = 300'

**NOTES:**  
 GRADES TO WHICH THIS IMPROVEMENT IS TO BE CONSTRUCTED ARE SHOWN ON PLANS AND PROFILE. GRADE POINTS FOR TOP OF CURB, CENTER LINE OF SEWER, OR CENTER LINE OF ALLEY ARE SHOWN BY CIRCLES ON PROFILE. AT ALL POINTS BETWEEN BEING-TO-BE POINTS THE GRADE SHALL BE ESTABLISHED SO AS TO CONFORM TO A STRAIGHT LINE DRAWN BETWEEN SAID BEING-TO-BE POINTS.  
 ELEVATIONS ARE IN FEET ABOVE U.S.C. & G.S. SEA LEVEL. SURVEY OF 1959.  
 THIS DRAWING AND THE DATA HEREON ARE HEREBY MADE A PART OF THE SPECIFICATIONS.  
 WORK SHALL BE CONSTRUCTED ACCORDING TO SPECIFICATIONS ON FILE IN THE OFFICE OF THE COUNTY ENGINEER AND SHALL BE PROSECUTED ONLY IN THE PRESENCE OF THE COUNTY ENGINEER.  
 BEFORE WORK CAN BE STARTED, THE CONTRACTOR MUST OBTAIN A PERMIT TO EXCAVATE IN COUNTY STREETS FROM THE L. A. COUNTY ROAD DEPT., THE W. STATE AND MAKE A REPORT WITH THE COUNTY ENGINEER ROOM 354 MAIN AMERICAN BUILDING, 312 SO. HOUSTON ST. TO COVER THE COST OF CONSTRUCTION INSPECTION AND RECORD PLANS.  
 APPROVAL OF THIS PLAN BY THE COUNTY OF LOS ANGELES DOES NOT CONSTITUTE A REPRESENTATION AS TO THE ACCURACY OF THE LOCATION OF OR THE EXISTENCE OR NON-EXISTENCE OF ANY UNDERGROUND UTILITY PIPE, OR STRUCTURE WITHIN THE LIMITS OF THIS PROJECT. THIS NOTE APPLIES TO ALL PAGES.  
 IF WORK IS TO BE DONE IN A STATE HIGHWAY, A PERMIT MUST BE OBTAINED FROM THE STATE OF CALIFORNIA, DIVISION OF HIGHWAYS, 120 SOUTH SPRING STREET.

COUNTY OF LOS ANGELES, CALIFORNIA  
 APPROVED, JOHN A. LAMBE, COUNTY ENGINEER  
 APPROVED, R. R. COMPEN, CHIEF ENGINEER  
 CO. SEAL NO. 11  
 BY John L. Estor SANITATION ENGINEER  
 BY E. P. Kemmerer OFFICE ENGINEER  
 CHECKED BY St. O. Oida 6-2-59  
 OFFICE OF COUNTY ENGINEER, REG. C. E. NO. 9406

SUBMITTED BY: John L. Estor 5-21-59  
 LOS CERRITOS REGIONAL ENGINEER, R. C. E. No.

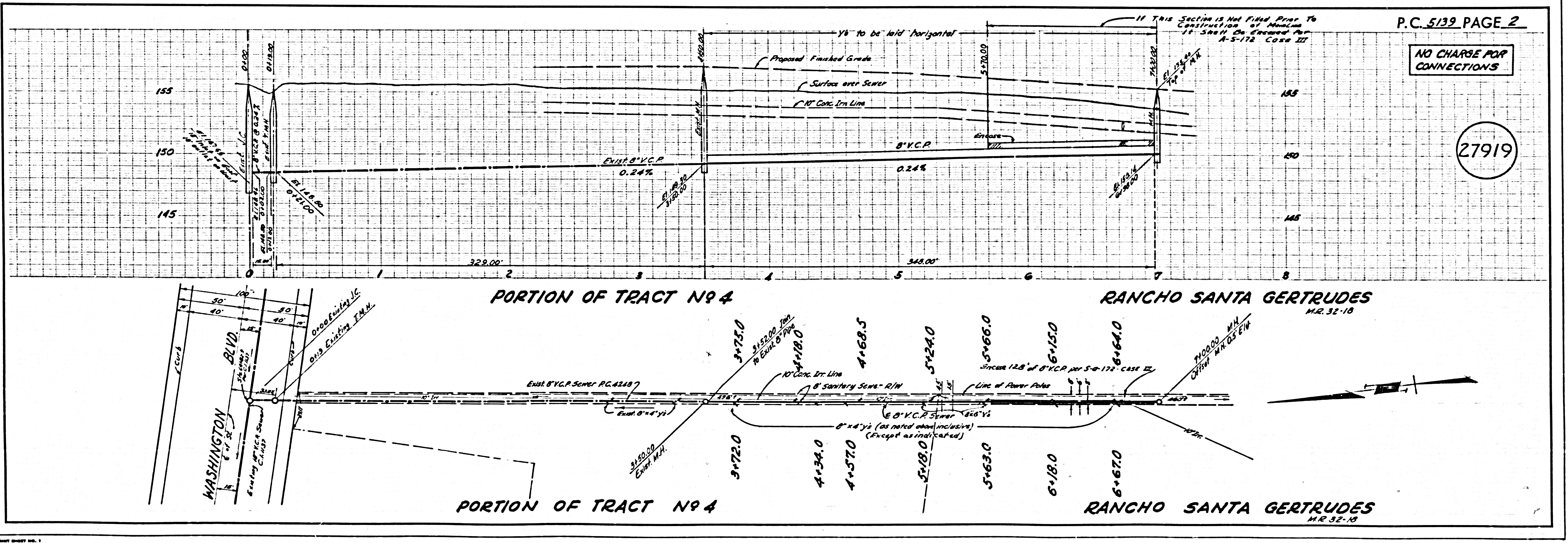

P.C. 5139 PAGE 2

**NO CHARGE FOR CONNECTIONS**

27919