

WOODRUFF AVENUE AND SOUTH STREET (WOODRUFF)

B.M. SY 3694, Elev. 54.441, L.A. County Road
 Dept. B.M. 235' W. of Curve Return at S.W.
 Corner of Woodruff Ave & South St. Intersection
 24' W. of Drwy. to Gas Station. L & B.N.
 For Additional B.M.'s Used on this Job See
 Printed List.

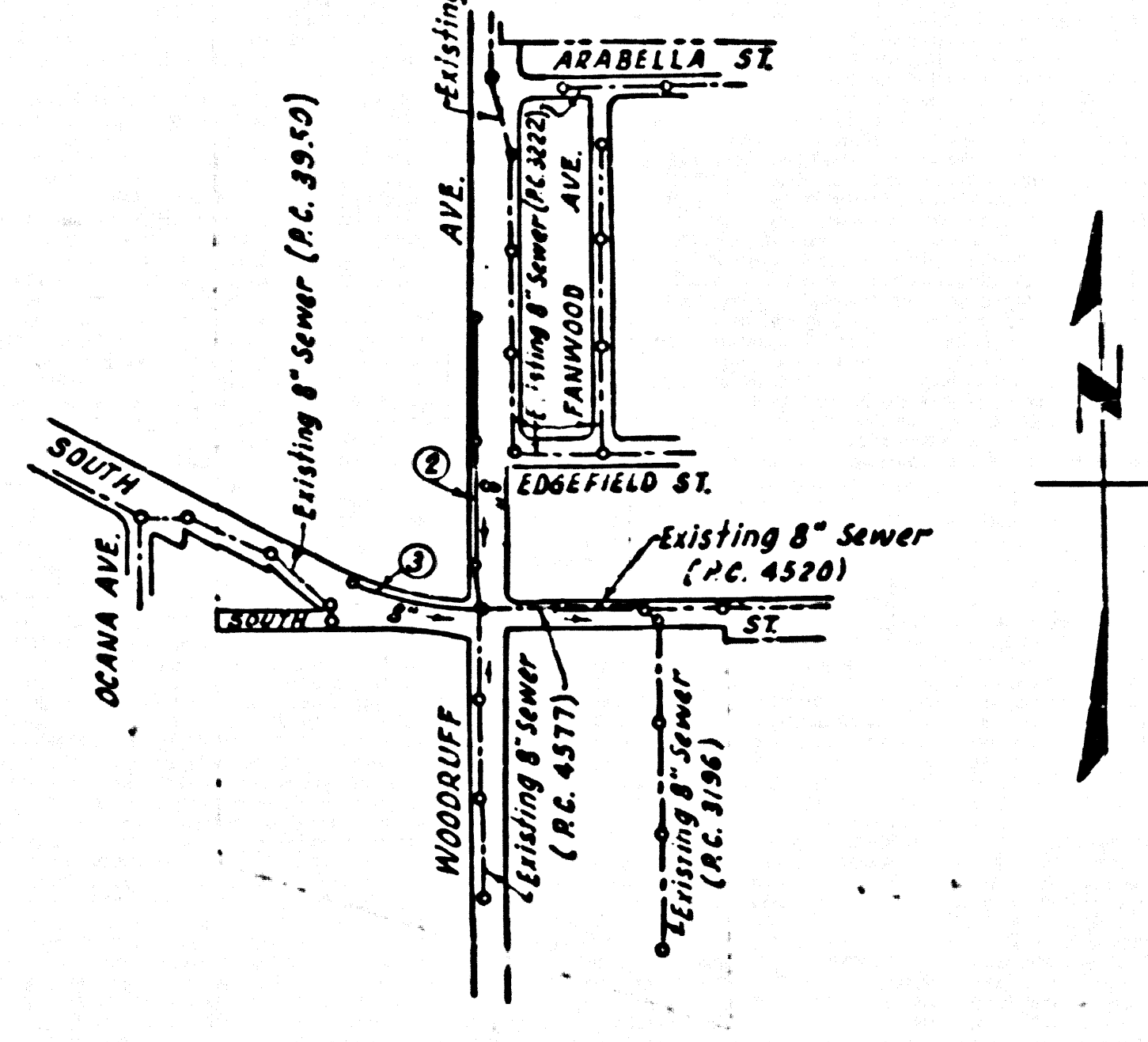

INDEX MAP
WOODRUFF AVENUE AND SOUTH STREET
P.C. 5146
 Scale: 1" = 600'

BELFLOWER BUILDING DISTRICT NO. 4

- USE STANDARD STRENGTH PIPE, EXCEPT AS NOTED.
- USE CEMENT MORTAR FOR ALL VITRIFIED CLAY PIPE JOINTS.
- ALL STRUCTURES SHALL BE BRICK SEWER STRUCTURES AS PER PLAN NO. S.A-104, EXCEPT AS NOTED.
- USE STANDARD MANHOLE FRAMES AND COVERS AS PER PLAN NO. S.A-117, EXCEPT AS NOTED.
- RESURFACE TRENCH WITHIN PAVED AREA WITH PREMIUM ROCK AND OR INCHES IN THICKNESS EXCEPT AS NOTED.
- USE FORMULA NO. 1 SEC. 54 OF SPECIFICATIONS TO COMPUTE ALLOWABLE LEAKAGE.
- THE CONTRACTOR SHALL NOTIFY THE CONSTRUCTION AND STORM DRAIN DIVISION BY TELEPHONE MADISON 9-4747, EXT. 362 AT LEAST 24 HOURS BEFORE STARTING ANY WORK UNDER THIS CONTRACT.
- CONSTRUCT HOUSE LATERALS WITH INVERTS AT PROPERTY LINE.
- 6 FEET BELOW CURB GRADE, OR GRADE OF CENTER LINE OF STREET EXCEPT AS NOTED.
- FIGURES IN CIRCLES AT ENDS OF HOUSE LATERALS INDICATE DEPTH BELOW CURB GRADE, OR GRADE OF CENTER LINE OF STREET.
- FIGURES IN CIRCLES AT ENDS OF HOUSE LATERALS INDICATE HOUSE LATERALS SHALL BE CONSTRUCTED WITH W% RISE PER FOOT TO PROPERTY LINE.
- WORDS IN CIRCLES AT ENDS OF HOUSE LATERALS INDICATE Y'S SHALL BE LAID HORIZONTAL AND HOUSE LATERALS SHALL BE CONSTRUCTED WITH W% RISE PER FOOT TO PROPERTY LINE.
- CONSTRUCTION IN STATE HIGHWAYS SHALL CONFORM WITH STATE HIGHWAY PERMIT.
- WORDS IN CIRCLES INDICATE Y'S SHALL BE LAID HORIZONTAL.

P.C. 5146
 PAGE 1
 NO CHARGE
 FOR CONNECTIONS

JOB NO. 0860.22
 PROFILE, ALIGNMENT AND GRADE OF
SANITARY SEWERS
 TO BE CONSTRUCTED IN
WOODRUFF AVENUE AND SOUTH STREET
 P.C. 5146
 PAGE 1 OF 3 PAGES

28,093

SCALE: VERT. 1" = 4 FT.
 HORIZ. 1" = 25 FT.
 MAY 1959
 CITY OF LAKEWOOD, CALIFORNIA
 JOHN A. LAMBE, CITY ENGINEER
 SUBMITTED: [Signature] ASSISTANT SANITATION ENGINEER
 APPROVED: [Signature] SANITATION ENGINEER
 C.R. COMPTON, CHIEF ENGINEER OF COUNTY SANITATION DISTRICT NO. 3
 BY: [Signature] OFFICE ENGINEER

FOR LEGEND SEE PLAN NO. S-4-44

NOTE: GRADES TO WHICH THIS IMPROVEMENT IS TO BE CONSTRUCTED ARE SHOWN ON PLANS AND PROFILES. GRADE POINTS FOR TOP OF CURB, CENTER LINE OF STREET OR CENTER LINE OF ALLEY ARE SHOWN BY CIRCLES ON PROFILES. AT ALL POINTS BETWEEN DESIGNATED POINTS THE GRADE SHALL BE ESTABLISHED SO AS TO COMFORM TO A STRAIGHT LINE DRAWN BETWEEN SAID DESIGNATED POINTS.

ELEVATIONS ARE IN FEET ABOVE U. S. C. & G. S. SEA LEVEL DATUM AS OF 1929.

UNIT PRICES FOR ADDITIONAL WORK WHICH MAY BE REQUIRED AND WHICH CANNOT BE ASCERTAINED IN ADVANCE, SHALL BE SUBMITTED IN THE PROPOSAL.

THIS DRAWING AND THE DATA HEREON ARE HEREBY MADE A PART OF THE SPECIFICATIONS.

REFERENCES			
W. S. 33	DESIGNED	R. ARZOLA	MAY, 1959
A. B. 351 Pt. 3	TRACED	R. ARZOLA	MAY, 1959
F. B. 232, 237, 274, 360, 2160	CHECKED	S. KAWAKITA	MAY, 1959

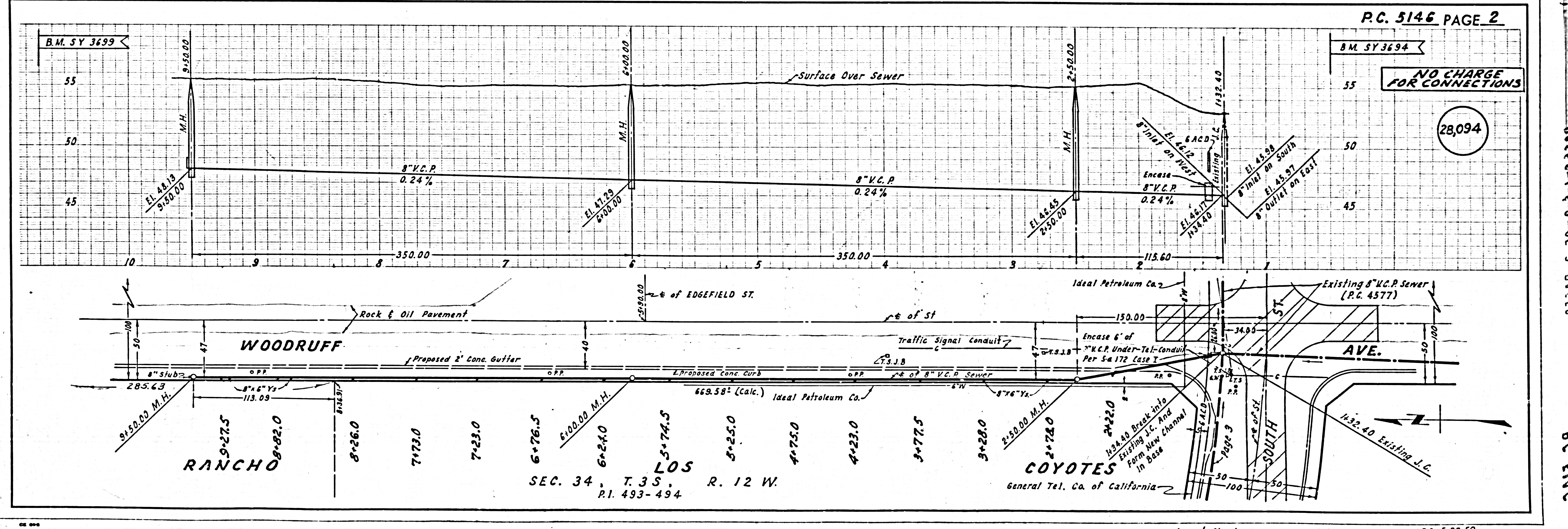

P.C. 5146 PAGE 2
 NO CHARGE
 FOR CONNECTIONS
 28,094

Topo. F.B. 237-16, F.B. 274-98, F.B. 360-16, 30
 x. Sect. F.B. 232-47-57

