

B.M. 31 4070 E. 39.83 Ad. L. of Road in
 at 2.0' E. of curb return of N.W. corner of
 Meyer St. & 223rd St.

LOMITA BLDG. DIST. NO. 71

PROFILE ALIGNMENT AND GRADE OF **P.C. 5149**
SANITARY SEWERS PAGE 1
 TO BE CONSTRUCTED IN **J.N. 0350.89**

TRACT N° 24832

PRIVATE CONTRACT NO. 5149
 W.S. 20

SHEET 2 PAGES **28,113**

SCALE: $\frac{1}{4}'' = 1'$ MAY, 1959
 PREPARED IN THE OFFICES OF

BARCLAY PEARSON CO., INC.

BY *Edward J. Pearson*
 REG. C. E. NO. 2213
 FOR LEG'ND SEE PLAN NO. S-A-64

- NOTES
1. PROFILE STATIONS ON THE PROPERTY LINES OR PROPERTY LINES PRODUCED AT RIGHT ANGLES TO THE SEWER LINE AT THE CENTER LINE OF EACH BUILDING.
 2. NO REPRESENTATIVE OF THE COUNTY ENGINEER WILL SURVEY OR LAY OUT ANY PORTION OF THE WORK.
 3. THE OWNER OR HIS AUTHORIZED REPRESENTATIVE SHALL FURNISH THE COUNTY ENGINEER WITH GRADE SHEETS AND STATIONING FOR ALL HOUSE LATERALS AND T BRANCHES AND SHALL PROVIDE SETBACKS FOR THESE AT THEIR PROPER LOCATIONS WITH STATIONING PLANNED MARKERS. ANY CHANGES IN LOCATION SHALL BE REQUESTED IN WRITINGS BY THE OWNER OR HIS REPRESENTATIVE.
 4. THE PRIVATE ENGINEER SHALL FURNISH THE HOUSE LATERAL DEPTH AT THE PROPERTY LINE BELOW THE TOP OF CURB ELEVATION FOR EACH HOUSE LATERAL ON THE GRADE SHEET.
 5. NO SETBACKS SHALL BE MADE IN THESE PLANS WITHOUT THE APPROVAL OF THE COUNTY ENGINEER.
 6. USE STANDARD HANDED FRAMES AND LOGS, 8-117, EXCEPT AS NOTED.
 7. USE STANDARD STRENGTH PIPE (VCP) AS NOTED.
 8. USE CHUTE HOOKS OR "WEDGE-JOINT" OR "SPUR-BEAM" FOR ALL V.C.P. JOINTS PER SPEC. S, SEC. 5 & 6.
 9. RESURFACE ALL TRACES WITHIN PAVED AREA TO MEET L.A. COUNTY ROAD DEPT. OR CALIF. STATE HIGHWAY REQUIREMENTS IN ACCORDANCE WITH PERMITS.
 10. SHOWN POLE PART OF SEWER AT POINTS OF INTERFERENCE WITH POLES, CASE III, S-172.
 11. HOUSE LATERALS TO BE CONSTRUCTED WITH INVERTS AT PROPERTY LINE $\frac{1}{2}$ FOOT BELOW CURB GRADE EXCEPT AS NOTED.
 12. ALL STRUCTURES SHALL BE BRICK SEWER STRUCTURES, S-104, EXCEPT AS NOTED.
 13. FOR ALLOWABLE LEAKAGE TEST USE FORMULA NO. 2 - SPEC. S, SEC. 61.
 14. MANHOLE TOPS IN UNIMPROVED RIGHTS OF WAY TO BE SIX INCHES ABOVE FINISHED GRADE.
 15. THE CONTRACTOR SHALL NOTIFY THE CONSTRUCTION & STORM DRAIN DIVISION BY TELEPHONE, MADISON 9-82, EXT. 342, AT LEAST TWENTY-FOUR HOURS BEFORE STARTING ANY WORK UNDER THIS CONTRACT.
 16. Standard Specifications dated May 15, 1958 apply to the construction of this project.
 17. All loadings shown for existing structures have been taken from records & their correctness & completeness is no way guaranteed. It shall be the contractor's responsibility to verify the accuracy of all measurements & data of every nature whether shown hereon or not & protect same from damage. The contractor shall bear the total expense or repair to any line damaged by any operation in connection with the prosecution of this work.

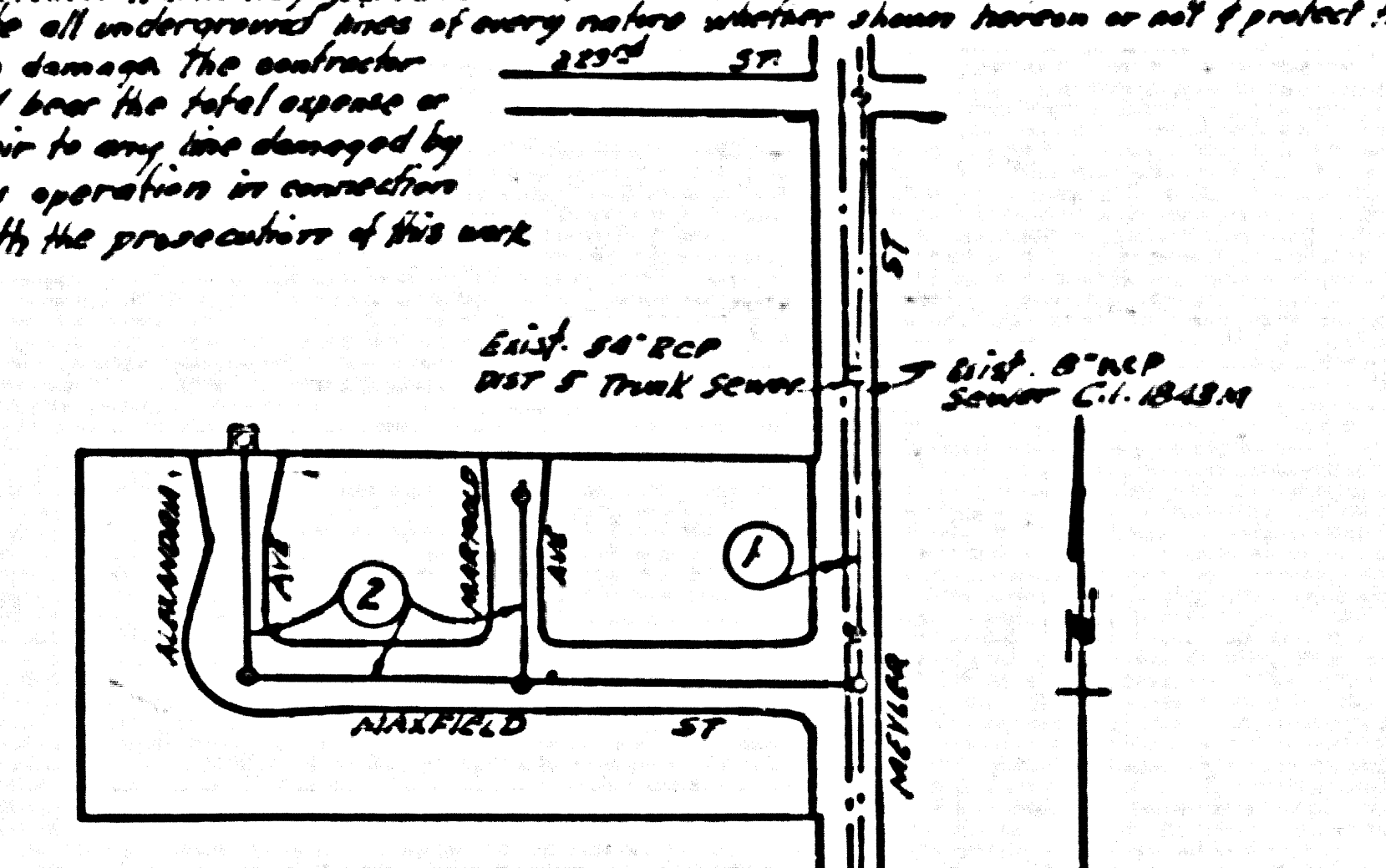

NO CHARGE FOR CONNECTIONS
J. Klem 5-29-59

