

B.M. 57961 El. 77.152 (1955)  
 ± 55' W. of Woodruff Ave. ± 47' near S.  
 edge conc. dr. to line #15529 (Norwalk Quad)

BELLFLOWER BLDG. DIST. NO. 407

PROFILE ALIGNMENT AND GRADE OF P.C. 5155  
 SANITARY SEWERS PAGE 1  
 TO BE CONSTRUCTED IN J.N. 0871.26

RIGHT OF WAY SOUTH OF  
 ROSECRANS AVENUE.  
 PRIVATE CONTRACT NO. 5155

W.S. 33  
 1 SHEET, 2 PAGES

SCALE: VERT. 1" = 4'  
 HORIZ. 1" = 40' MAY, 1959  
 PREPARED IN THE OFFICES OF  
 OLSON SURVEYING SERVICE

28005

FOR LEGEND SEE PLAN NO. S-A-64

- NOTES:
1. PROVIDE STAKES ON THE PROPERTY LINE OR PROPERTY LINES PRODUCED AT RIGHT ANGLES TO THE SEWER LINE AT THE CENTER LINE OF EACH MANHOLE.
  2. NO REPRESENTATIVE OF THE CITY ENGINEER WILL SURVEY OR LAY OUT ANY PORTION OF THE WORK.
  3. THE OWNER OR HIS AUTHORIZED REPRESENTATIVE SHALL FURNISH THE CITY ENGINEER WITH GRADE SHEETS AND STATIONING FOR ALL HOUSE LATERALS AND BRANCHES AND SHALL FURNISH STAKES FOR THEM AT THREE HOUSE LOCATIONS WITH STATIONING PLAINLY MARKED. ANY CHANGE IN LOCATION SHALL BE REQUESTED IN WRITING BY THE OWNER OR HIS REPRESENTATIVE.
  4. THE PRIVATE ENGINEER SHALL FURNISH THE HOUSE LATERAL DEPTH AT THE PROPERTY LINE BELOW THE TOP OF CURB ELEVATION FOR EACH HOUSE LATERAL ON THE GRADE SHEET.
  5. NO REVISIONS SHALL BE MADE IN THESE PLANS WITHOUT THE APPROVAL OF THE CITY ENGINEER.
  6. USE STANDARD MANHOLE FRAMES AND COVERS, S-117, 60000-60-100000.
  7. USE STANDARD STRENGTH PIPE 8" V.C.P. 48-100000.
  8. USE CEMENT MORTAR OR "WEDGE-LOCK" OR "SPREAD SEAL" FOR ALL V.C.P. JOINTS PER SPEC., SECS. 26 & 48.
  9. RESURFACE ALL TRENCH WITHIN PAVED AREA TO MEET L.A. COUNTY ROAD DEPT. OR CALIF. STATE HIGHWAY REQUIREMENTS IN ACCORDANCE WITH PERMITS.
  10. EXPOSE FOUR FEET OF SEWER AT POINTS OF INTERFERENCE WITH POLES, CASE NO. S-172.
  11. HOUSE LATERALS TO BE CONSTRUCTED WITHIN BOUNDS OF PROPERTY.
  12. ALL STRUCTURES SHALL BE BRICK SEWER STRUCTURES, S-104, EXCEPT AS NOTED.
  13. FOR ALLOWABLE LEAKAGE TEST USE FORMULA NO. 1, SPEC., SEC. 54.
  14. MANHOLE TOPS IN UNIMPROVED RIGHTS-OF-WAY TO BE LEVEL WITH FINISHED GRADE.
  15. THE CONTRACTOR SHALL NOTIFY THE CONSTRUCTION & SPERM DEPARTMENT BY TELEPHONE, MADISON 9-477, EXT. 362, AT LEAST TWENTY-FOUR HOURS BEFORE STARTING ANY WORK UNDER THIS CONTRACT.
  16. STANDARD SPECIFICATIONS DATED MAY 15, 1959 APPLY IN THE CONSTRUCTION OF THIS PROJECT.

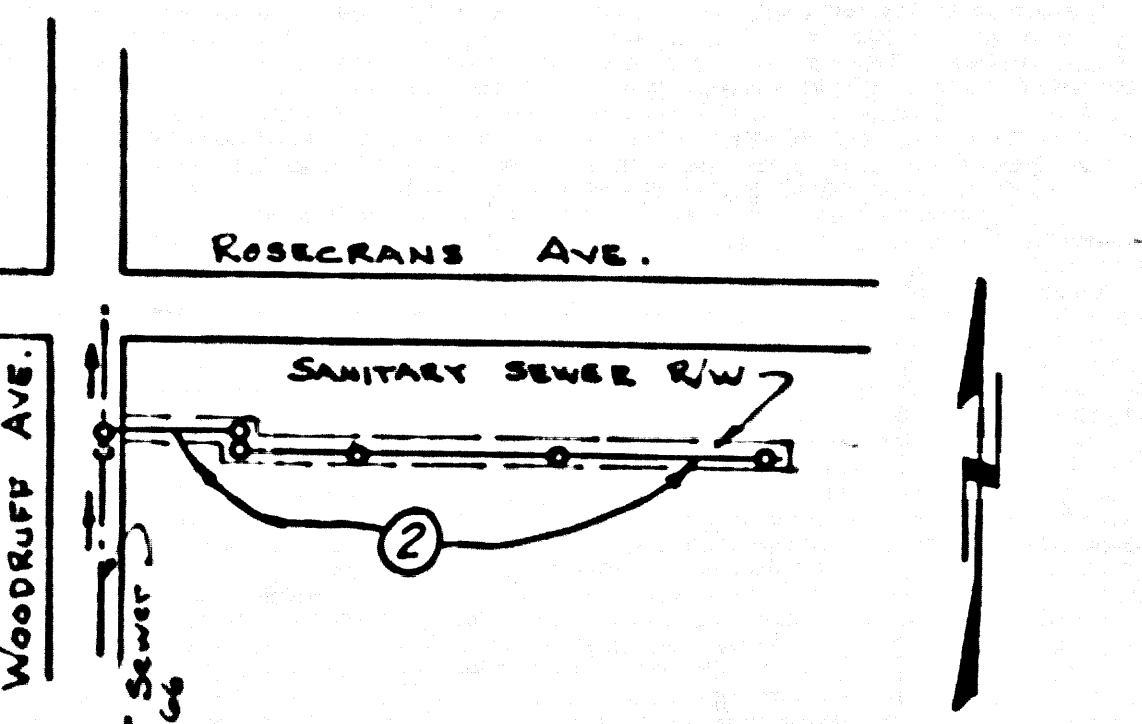

INDEX MAP  
 SCALE: 1" = 400'  
 P.C. 5155  
 J.N. 0871.26

ISSUE NO PERMITS UNTIL EASEMENT  
 HAS BEEN DEDICATED AND ACCEPTED  
 BY THE CITY OF BELLFLOWER

NO CHARGE FOR  
 CONNECTIONS

NOTE:  
 GRADES TO WHICH THIS IMPROVEMENT IS TO BE CONSTRUCTED ARE SHOWN ON PLANS AND PROFILE. GRADE POINTS FOR TOP OF CURB, CENTER LINE OF STREETS, OR CENTER LINE OF ALLEYS ARE SHOWN BY CIRCLES ON PROFILES AT ALL POINTS BETWEEN MANHOLES. POINTS BETWEEN THE GRADE SHALL BE ESTABLISHED SO AS TO CONFORM TO A STRAIGHT LINE BEYOND EACH MANHOLE. GRADE POINTS  
 ELEVATIONS ARE IN FEET ABOVE U.S.C. & G.S. SEA LEVEL. DATE OF 1959.  
 THIS DRAWING AND THE DATA HEREON ARE HEREBY MADE A PART OF THE SPECIFICATIONS.  
 WORK SHALL BE CONSTRUCTED ACCORDING TO SPECIFICATIONS ON FILE IN THE OFFICE OF THE CITY ENGINEER AND SHALL BE PROSECUTED ONLY IN THE PRESENCE OF THE CITY ENGINEER.  
 BEFORE WORK CAN BE STARTED, THE CONTRACTOR MUST OBTAIN A PERMIT TO EXCAVATE IN CITY STREETS FROM THE L.A. COUNTY ROAD DEPT., DISTRICT OFFICE NO. 4 AND MAKE A DEPOSIT WITH THE CITY OF BELLFLOWER.  
 THE COST OF CONSTRUCTION INSPECTION AND RECORD PLANS SHALL BE PAID BY THE CITY OF BELLFLOWER. THE COST OF CONSTRUCTION INSPECTION AND RECORD PLANS SHALL BE PAID BY THE CITY OF BELLFLOWER. THE COST OF CONSTRUCTION INSPECTION AND RECORD PLANS SHALL BE PAID BY THE CITY OF BELLFLOWER.  
 THE LOCATION OF OR THE EXISTENCE OR NON-EXISTENCE OF ANY UNDERGROUND UTILITY PIPE, OR STRUCTURE WITHIN THE LIMITS OF THIS PROJECT, THIS NOTE APPLIES TO ALL PAGES.  
 IF WORK IS TO BE DONE IN A STATE HIGHWAY, A PERMIT MUST BE OBTAINED FROM THE STATE OF CALIFORNIA, DIVISION OF HIGHWAYS, 128 SOUTH SPRING STREET.

CITY OF BELLFLOWER, CALIFORNIA

APPROVED, JOHN A. LAMBE, CITY ENGINEER  
 APPROVED, L.R. COFFIN, CHIEF ENGINEER  
 BY: *[Signature]* BY: *[Signature]*  
 SANITATION PROGRAM OFFICE ENGINEER  
 CHECKED BY: *[Signature]* 6-24-59  
 OFFICE OF CITY ENGINEER, REG. C. E. NO. 9406

SUBMITTED BY: *[Signature]* 6-24-59  
 LOS CERRITOS REGIONAL ENGINEER, R.C.E. No. 5871

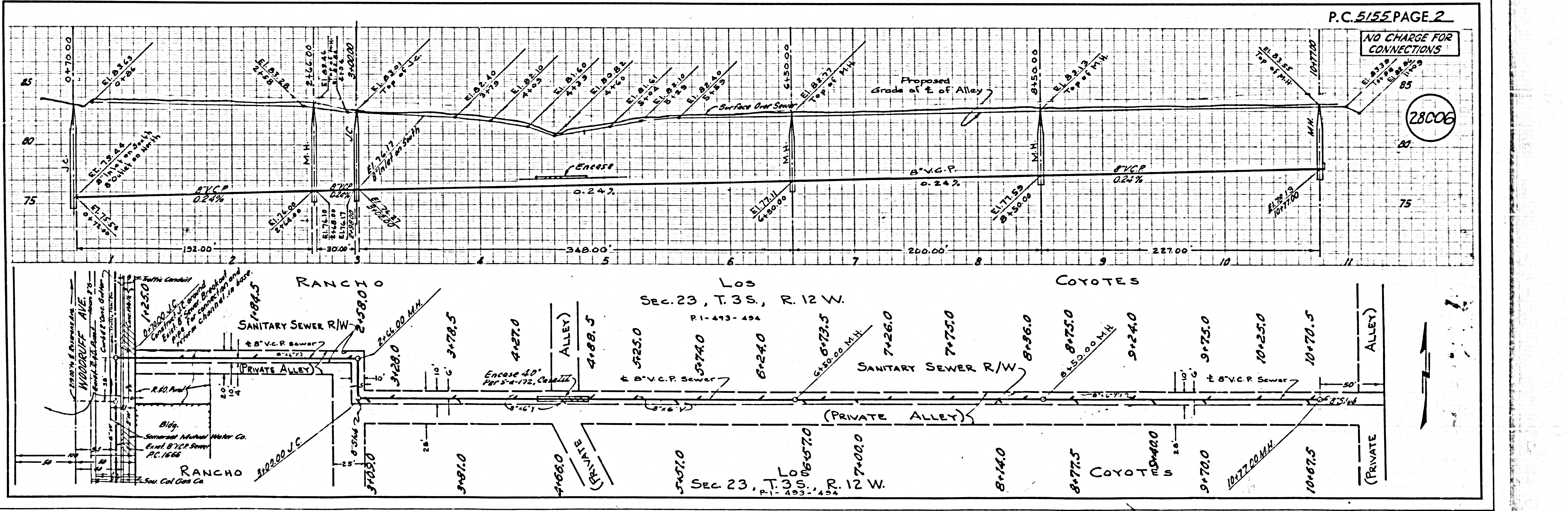

P.C. 5155 PAGE 2

NO CHARGE FOR  
 CONNECTIONS

28006

RANCHO LOS COYOTES  
 SEC. 23, T. 35, R. 12 W.  
 R. 1-493-494

RANCHO LOS COYOTES  
 SEC. 23, T. 35, R. 12 W.  
 R. 1-493-494

WOODRUFF AVE.  
 ROSECRANS AVE.  
 SANITARY SEWER R/W  
 PRIVATE ALLEY  
 ALLEY  
 ALLEY  
 ALLEY

MANHOLE ELEVATIONS:  
 81.250, 81.260, 81.270, 81.280, 81.290, 81.300, 81.310, 81.320, 81.330, 81.340, 81.350, 81.360, 81.370, 81.380, 81.390, 81.400, 81.410, 81.420, 81.430, 81.440, 81.450, 81.460, 81.470, 81.480, 81.490, 81.500, 81.510, 81.520, 81.530, 81.540, 81.550, 81.560, 81.570, 81.580, 81.590, 81.600, 81.610, 81.620, 81.630, 81.640, 81.650, 81.660, 81.670, 81.680, 81.690, 81.700, 81.710, 81.720, 81.730, 81.740, 81.750, 81.760, 81.770, 81.780, 81.790, 81.800, 81.810, 81.820, 81.830, 81.840, 81.850, 81.860, 81.870, 81.880, 81.890, 81.900, 81.910, 81.920, 81.930, 81.940, 81.950, 81.960, 81.970, 81.980, 81.990, 82.000, 82.010, 82.020, 82.030, 82.040, 82.050, 82.060, 82.070, 82.080, 82.090, 82.100, 82.110, 82.120, 82.130, 82.140, 82.150, 82.160, 82.170, 82.180, 82.190, 82.200, 82.210, 82.220, 82.230, 82.240, 82.250, 82.260, 82.270, 82.280, 82.290, 82.300, 82.310, 82.320, 82.330, 82.340, 82.350, 82.360, 82.370, 82.380, 82.390, 82.400, 82.410, 82.420, 82.430, 82.440, 82.450, 82.460, 82.470, 82.480, 82.490, 82.500, 82.510, 82.520, 82.530, 82.540, 82.550, 82.560, 82.570, 82.580, 82.590, 82.600, 82.610, 82.620, 82.630, 82.640, 82.650, 82.660, 82.670, 82.680, 82.690, 82.700, 82.710, 82.720, 82.730, 82.740, 82.750, 82.760, 82.770, 82.780, 82.790, 82.800, 82.810, 82.820, 82.830, 82.840, 82.850, 82.860, 82.870, 82.880, 82.890, 82.900, 82.910, 82.920, 82.930, 82.940, 82.950, 82.960, 82.970, 82.980, 82.990, 83.000, 83.010, 83.020, 83.030, 83.040, 83.050, 83.060, 83.070, 83.080, 83.090, 83.100, 83.110, 83.120, 83.130, 83.140, 83.150, 83.160, 83.170, 83.180, 83.190, 83.200, 83.210, 83.220, 83.230, 83.240, 83.250, 83.260, 83.270, 83.280, 83.290, 83.300, 83.310, 83.320, 83.330, 83.340, 83.350, 83.360, 83.370, 83.380, 83.390, 83.400, 83.410, 83.420, 83.430, 83.440, 83.450, 83.460, 83.470, 83.480, 83.490, 83.500, 83.510, 83.520, 83.530, 83.540, 83.550, 83.560, 83.570, 83.580, 83.590, 83.600, 83.610, 83.620, 83.630, 83.640, 83.650, 83.660, 83.670, 83.680, 83.690, 83.700, 83.710, 83.720, 83.730, 83.740, 83.750, 83.760, 83.770, 83.780, 83.790, 83.800, 83.810, 83.820, 83.830, 83.840, 83.850, 83.860, 83.870, 83.880, 83.890, 83.900, 83.910, 83.920, 83.930, 83.940, 83.950, 83.960, 83.970, 83.980, 83.990, 84.000, 84.010, 84.020, 84.030, 84.040, 84.050, 84.060, 84.070, 84.080, 84.090, 84.100, 84.110, 84.120, 84.130, 84.140, 84.150, 84.160, 84.170, 84.180, 84.190, 84.200, 84.210, 84.220, 84.230, 84.240, 84.250, 84.260, 84.270, 84.280, 84.290, 84.300, 84.310, 84.320, 84.330, 84.340, 84.350, 84.360, 84.370, 84.380, 84.390, 84.400, 84.410, 84.420, 84.430, 84.440, 84.450, 84.460, 84.470, 84.480, 84.490, 84.500, 84.510, 84.520, 84.530, 84.540, 84.550, 84.560, 84.570, 84.580, 84.590, 84.600, 84.610, 84.620, 84.630, 84.640, 84.650, 84.660, 84.670, 84.680, 84.690, 84.700, 84.710, 84.720, 84.730, 84.740, 84.750, 84.760, 84.770, 84.780, 84.790, 84.800, 84.810, 84.820, 84.830, 84.840, 84.850, 84.860, 84.870, 84.880, 84.890, 84.900, 84.910, 84.920, 84.930, 84.940, 84.950, 84.960, 84.970, 84.980, 84.990, 85.000, 85.010, 85.020, 85.030, 85.040, 85.050, 85.060, 85.070, 85.080, 85.090, 85.100, 85.110, 85.120, 85.130, 85.140, 85.150, 85.160, 85.170, 85.180, 85.190, 85.200, 85.210, 85.220, 85.230, 85.240, 85.250, 85.260, 85.270, 85.280, 85.290, 85.300, 85.310, 85.320, 85.330, 85.340, 85.350, 85.360, 85.370, 85.380, 85.390, 85.400, 85.410, 85.420, 85.430, 85.440, 85.450, 85.460, 85.470, 85.480, 85.490, 85.500, 85.510, 85.520, 85.530, 85.540, 85.550, 85.560, 85.570, 85.580, 85.590, 85.600, 85.610, 85.620, 85.630, 85.640, 85.650, 85.660, 85.670, 85.680, 85.690, 85.700, 85.710, 85.720, 85.730, 85.740, 85.750, 85.760, 85.770, 85.780, 85.790, 85.800, 85.810, 85.820, 85.830, 85.840, 85.850, 85.860, 85.870, 85.880, 85.890, 85.900, 85.910, 85.920, 85.930, 85.940, 85.950, 85.960, 85.970, 85.980, 85.990, 86.000, 86.010, 86.020, 86.030, 86.040, 86.050, 86.060, 86.070, 86.080, 86.090, 86.100, 86.110, 86.120, 86.130, 86.140, 86.150, 86.160, 86.170, 86.180, 86.190, 86.200, 86.210, 86.220, 86.230, 86.240, 86.250, 86.260, 86.270, 86.280, 86.290, 86.300, 86.310, 86.320, 86.330, 86.340, 86.350, 86.360, 86.370, 86.380, 86.390, 86.400, 86.410, 86.420, 86.430, 86.440, 86.450, 86.460, 86.470, 86.480, 86.490, 86.500, 86.510, 86.520, 86.530, 86.540, 86.550, 86.560, 86.570, 86.580, 86.590, 86.600, 86.610, 86.620, 86.630, 86.640, 86.650, 86.660, 86.670, 86.680, 86.690, 86.700, 86.710, 86.720, 86.730, 86.740, 86.750, 86.760, 86.770, 86.780, 86.790, 86.800, 86.810, 86.820, 86.830, 86.840, 86.850, 86.860, 86.870, 86.880, 86.890, 86.900, 86.910, 86.920, 86.930, 86.940, 86.950, 86.960, 86.970, 86.980, 86.990, 87.000, 87.010, 87.020, 87.030, 87.040, 87.050, 87.060, 87.070, 87.080, 87.090, 87.100, 87.110, 87.120, 87.130, 87.140, 87.150, 87.160, 87.170, 87.180, 87.190, 87.200, 87.210, 87.220, 87.230, 87.240, 87.250, 87.260, 87.270, 87.280, 87.290, 87.300, 87.310, 87.320, 87.330, 87.340, 87.350, 87.360, 87.370, 87.380, 87.390, 87.400, 87.410, 87.420, 87.430, 87.440, 87.450, 87.460, 87.470, 87.480, 87.490, 87.500, 87.510, 87.520, 87.530, 87.540, 87.550, 87.560, 87.570, 87.580, 87.590, 87.600, 87.610, 87.620, 87.630, 87.640, 87.650, 87.660, 87.670, 87.680, 87.690, 87.700, 87.710, 87.720, 87.730, 87.740, 87.750, 87.760, 87.770, 87.780, 87.790, 87.800, 87.810, 87.820, 87.830, 87.840, 87.850, 87.860, 87.870, 87.880, 87.890, 87.900, 87.910, 87.920, 87.930, 87.940, 87.950, 87.960, 87.970, 87.980, 87.990, 88.000, 88.010, 88.020, 88.030, 88.040, 88.050, 88.060, 88.070, 88.080, 88.090, 88.100, 88.110, 88.120, 88.130, 88.140, 88.150, 88.160, 88.170, 88.180, 88.190, 88.200, 88.210, 88.220, 88.230, 88.240, 88.250, 88.260, 88.270, 88.280, 88.290, 88.300, 88.310, 88.320, 88.330, 88.340, 88.350, 88.360, 88.370, 88.380, 88.390, 88.400, 88.410, 88.420, 88.430, 88.440, 88.450, 88.460, 88.470, 88.480, 88.490, 88.500, 88.510, 88.520, 88.530, 88.540, 88.550, 88.560, 88.570, 88.580, 88.590, 88.600, 88.610, 88.620, 88.630, 88.640, 88.650, 88.660, 88.670, 88.680, 88.690, 88.700, 88.710, 88.720, 88.730, 88.740, 88.750, 88.760, 88.770, 88.780, 88.790, 88.800, 88.810, 88.820, 88.830, 88.840, 88.850, 88.860, 88.870, 88.880, 88.890, 88.900, 88.910, 88.920, 88.930, 88.940, 88.950, 88.960, 88.970, 88.980, 88.990, 89.000, 89.010, 89.020, 89.030, 89.040, 89.050, 89.060, 89.070, 89.080, 89.090, 89.100, 89.110, 89.120, 89.130, 89.140, 89.150, 89.160, 89.170, 89.180, 89.190, 89.200, 89.210, 89.220, 89.230, 89.240, 89.250, 89.260, 89.270, 89.280, 89.290, 89.300, 89.310, 89.320, 89.330, 89.340, 89.350, 89.360, 89.370, 89.380, 89.390, 89.400, 89.410, 89.420, 89.430, 89.440, 89.450, 89.460, 89.470, 89.480, 89.490, 89.500, 89.510, 89.520, 89.530, 89.540, 89.550, 89.560, 89.570, 89.580, 89.590, 89.600, 89.610, 89.620, 89.630, 89.640, 89.650, 89.660, 89.670, 89.680, 89.690, 89.700, 89.710, 89.720, 89.730, 89.740, 89.750, 89.760, 89.770, 89.780, 89.790, 89.800, 89.810, 89.820, 89.830, 89.840, 89.850, 89.860, 89.870, 89.880, 89.890, 89.900, 89.910, 89.920, 89.930, 89.940, 89.950, 89.960, 89.970, 89.980, 89.990, 90.000, 90.010, 90.020, 90.030, 90.040, 90.050, 90.060, 90.070, 90.080, 90.090, 90.100, 90.110, 90.120, 90.130, 90.140, 90.150, 90.160, 90.170, 90.180, 90.190, 90.200, 90.210, 90.220, 90.230, 90.240, 90.250, 90.260, 90.270, 90.280, 90.290, 90.300, 90.310, 90.320, 90.330, 90.340, 90.350, 90.360, 90.370, 90.380, 90.390, 90.400, 90.410, 90.420, 90.430, 90.440, 90.450, 90.460, 90.470, 90.480, 90.490, 90.500, 90.510, 90.520, 90.530, 90.540, 90.550, 90.560, 90.570, 90.580, 90.590, 90.600, 90.610, 90.620, 90.630, 90.640, 90.650, 90.660, 90.670, 90.680, 90.690, 90.700, 90.710, 90.720, 90.730, 90.740, 90.750, 90.760, 90.770, 90.780, 90.790, 90.800, 90.810, 90.820, 90.830, 90.840, 90.850, 90.860, 90.870, 90.880, 90.890, 90.900, 90.910, 90.920, 90.930, 90.940, 90.950, 90.960, 90.970, 90.980, 90.990, 91.000, 91.010, 91.020, 91.030, 91.040, 91.050, 91.060, 91.070, 91.080, 91.090, 91.100, 91.110, 91.120, 91.130, 91.140, 91.150, 91.160, 91.170, 91.180, 91.190, 91.200, 91.210, 91.220, 91.230, 91.240, 91.250, 91.260, 91.270, 91.280, 91.290, 91.300, 91.310, 91.320, 91.330, 91.340, 91.350, 91.360, 91.370, 91.380, 91.390, 91.400, 91.410, 91.420, 91.430, 91.440, 91.450, 91.460, 91.470, 91.480, 91.490, 91.500, 91.510, 91.520, 91.530, 91.540, 91.550, 91.560, 91.570, 91.580, 91.590, 91.600, 91.610, 91.620, 91.630, 91.640, 91.650, 91.660, 91.670, 91.680, 91.690, 91.700, 91.710, 91.720, 91.730, 91.740, 91.750, 91.760, 91.770, 91.780, 91.790, 91.800, 91.810, 91.820, 91.830, 91.840, 91.850, 91.860, 91.870, 91.880, 91.890, 91.900, 91.910, 91.920, 91.930, 91.940, 91.950, 91.960, 91.970, 91.980, 91.990, 92.000, 92.010, 92.020, 92.030, 92.040, 92.050, 92.060, 92.070, 92.080, 92.090, 92.100, 92.110, 92.120, 92.130, 92.140, 92.150, 92.160, 92.170, 92.180, 92.190, 92.200, 92.210, 92.220, 92.230, 92.240, 92.250, 92.260, 92.270, 92.280, 92.290, 92.300, 92.310, 92.320, 92.330, 92.340, 92.350, 92.360, 92.370, 92.380, 92.390, 92.400, 92.410, 92.420, 92.430, 92.440, 92.450, 92.460, 92.470, 92.480, 92.490, 92.500, 92.510, 92.520, 92.530, 92.540, 92.550, 92.560, 92.570, 92.580, 92.590, 92.600, 92.610, 92.620, 92.630, 92.640, 92.650, 92.660, 92.670, 92.680, 92.690, 92.700, 92.710, 92.720, 92.730, 92.740, 92.750, 92.760, 92.770, 92.780, 92.790, 92.800, 92.810, 92.820, 92.830, 92.840, 92.850, 92.860, 92.870, 92.880, 92.890, 92.900, 92.910, 92.920, 92.930, 92.940, 92.950, 92.960, 92.970, 92.980, 92.990, 93.000, 93.010, 93.020, 93.030, 93.040, 93.050, 93.060, 93.070, 93.080, 93.090, 93.100, 93.110, 93.120, 93.130, 93.140, 93.150, 93.160, 93.170, 93.180, 93.190, 93.200, 93.210, 93.220, 93.230, 93.240, 93.250, 93.260, 93.270, 9