

WHITTIER BLDG. DIST. NO. 11

TRACT No 24852

PRIVATE CONTRACT NO. 5185

W.S. 34  
 2 SHEETS, 3 PAGES

SCALE: VERT. 1" = 4' HORIZ. 1" = 40' JUNE, 1959. 28282

PREPARED IN THE OFFICES OF  
 THOMAS W. DAVIS  
 Licensed Surveyor  
 Frank C. Hansen  
 REG. C. E. NO. 1011

FOR LEGEND SEE PLAN NO. S-A-64

- NOTES
1. PROVIDE STAKES ON THE PROPERTY LINE OR PROPERTY LINES PRODUCED AT RIGHT ANGLES TO THE SEWER LINE AT THE CENTER LINE OF EACH MANHOLE.
  2. NO DIMENSIONS OF THE COUNTY ENGINEER WILL SURVEY OR LAY OFF ANY PORTION OF THE WORK.
  3. THE OWNER OR HIS APPLICABLE REPRESENTATIVE SHALL FURNISH THE COUNTY ENGINEER WITH THE GRADE SHEETS AND STAKING FOR ALL HOUSE LATERALS AND BRANCHES AND SHALL PROVIDE STAKES FOR THESE AT THEIR PROPER LOCATIONS WITH STATIONING PLAINLY MARKED. ANY CHANGE IN LOCATION SHALL BE REQUESTED IN WRITING BY THE OWNER OR HIS REPRESENTATIVE.
  4. THE PRIVATE ENGINEER SHALL FURNISH THE HOUSE LATERAL SUPPLY AT THE PROPERTY LINE BELOW THE TOP OF CURB ELEVATION FOR EACH HOUSE LATERAL ON THE GRADE SHEET.
  5. NO DIVERSION SHALL BE MADE IN THESE PLANS WITHOUT THE APPROVAL OF THE COUNTY ENGINEER.
  6. THE STANDARD MANHOLE FRAMES AND COVERS, S-117.
  7. USE STANDARD STRENGTH PIPE.
  8. USE STANDARD MOUNTING OR "WISDOM SOCKET" OR "BIRD'S-NEST" FOR ALL V.C.P. JOINTS PER SPEC., SECT. 8 & 9.
  9. INSURANCE ALL TRENCHES WITHIN PAVED AREA TO MEET L.A. COUNTY ROAD DEPT. OR CALIF. STATE HIGHWAY REQUIREMENTS IN ACCORDANCE WITH PERMITS.
  10. ENCASE POLE PIPE C7 SEWER AT POINTS OF INTERFERENCE WITH POLES, CANE, ETC., PER SPEC.
  11. HOUSE LATERALS TO BE CONSTRUCTED WITH INVERTS AT PROPERTY LINE 18" FEET BELOW CURB GRADE EXCEPT AS NOTED.
  12. ALL STRUCTURES SHALL BE BRICK REWER STRUCTURES, S-104.
  13. FOR ALLOWABLE BRIDGE TEST USE FORMULA NO. 1-14 SPEC., SEC. 12.
  14. MANHOLE TOPS IN UNIMPROVED RIGHTS-OF-WAY TO BE 36 INCHES ABOVE FINISHED GRADE.
  15. THE CONTRACTOR SHALL NOTIFY THE CONSTRUCTION & BROWN BRUSH DIVISION BY TELEPHONE, MARSHAL 9-67, EXT. 10, AT LEAST TWENTY-FOUR HOURS BEFORE STARTING ANY WORK UNDER THIS CONTRACT.
  16. STANDARD SPECIFICATIONS DATED MAY 11, 1952 APPLY TO THE CONSTRUCTION OF THIS PROJECT.

B.M. Elev. 152.073 1955 adjustment.  
 S.Y. 1251- Vol. 3 Pg. 577  
 L. & T. ± 1" W. of curb return at S.W. cor.  
 of Victoria Ave. and Broadway,  
 Santa Fe Quad.

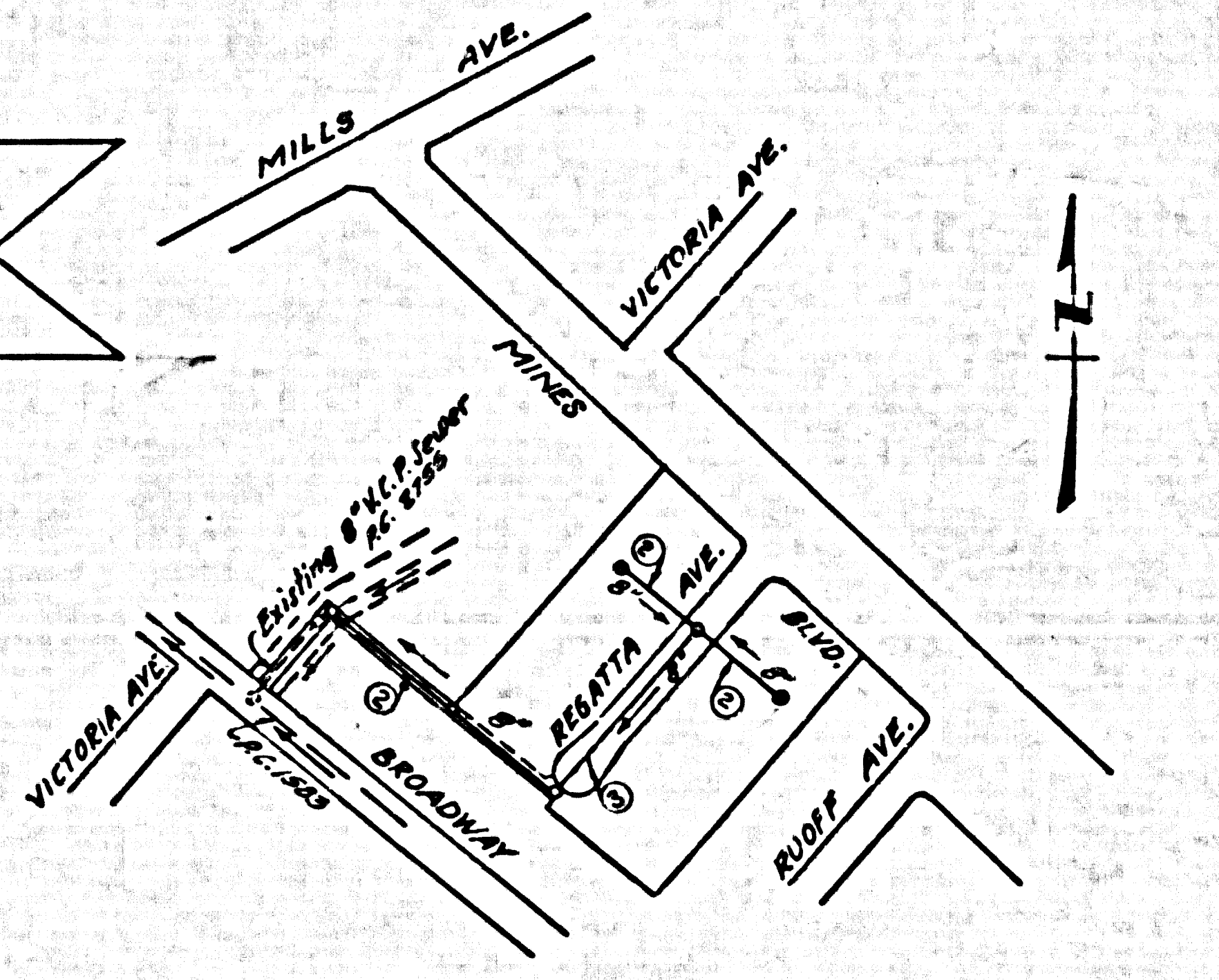

INDEX MAP  
 SCALE 1"=300'  
 TRACT No 24852  
 R.C. 505

CONNECTION CHARGES  
 AS INDICATED  
 7-22-59

NOTES  
 GRADES TO WHICH THE IMPROVEMENT IS TO BE CONSTRUCTED ARE SHOWN ON PLANS AND PROFILES. GRADE POINTS FOR TOP OF CURB, CENTER LINE OF STREET, OR CENTER LINE OF ALLEY ARE SHOWN BY CIRCLES ON PROFILES. AT ALL POINTS BETWEEN INFORMATION POINTS THE GRADE SHALL BE ESTABLISHED SO AS TO COMFORM TO A STRAIGHT LINE BETWEEN SAID INFORMATION POINTS.  
 ELEVATIONS ARE IN FEET ABOVE U.S.C. & G.S. SEA LEVEL DATUM OF 1929.  
 THE DRAWING AND THE DATA HEREON ARE HEREBY MADE A PART OF THE SPECIFICATIONS.  
 WORK SHALL BE CONSTRUCTED ACCORDING TO SPECIFICATIONS ON FILE IN THE OFFICE OF THE COUNTY ENGINEER AND SHALL BE PROSECUTED ONLY IN THE PRESENCE OF THE COUNTY ENGINEER.  
 BEFORE WORK CAN BE STARTED, THE CONTRACTOR MUST OBTAIN A PERMIT TO EXCAVATE IN COUNTY STREETS FROM THE L.A. COUNTY ROAD DEPT., DISTRICT OFFICE NO. 4, AND MAKE A DEPOSIT WITH THE COUNTY ENGINEER, ROOM 234 PAVAN CAMP BUILDING, 300 SO. BRADWAY, SUFFICIENT TO COVER THE COST OF CONSTRUCTION INSPECTION AND RECORD PLANS.  
 APPROVAL OF THIS PLAN BY THE COUNTY OF LOS ANGELES DOES NOT CONSTITUTE A REPRESENTATION AS TO THE ACCURACY OF THE LOCATION OF OR THE EXISTENCE OR NON-EXISTENCE OF ANY UNDERGROUND UTILITY PIPE, OR STRUCTURE WITHIN THE LIMITS OF THIS PROJECT. THE NOTE APPLIES TO ALL PAGES.  
 IF WORK IS TO BE DONE IN A STATE HIGHWAY, A PERMIT MUST BE OBTAINED FROM THE STATE OF CALIFORNIA, DIVISION OF HIGHWAYS, 120 SOUTH BRIDGE STREET.

COUNTY OF LOS ANGELES, CALIFORNIA

APPROVED, JOHN A. LAMBE, COUNTY ENGINEER  
 APPROVED, C.E. CASPARI, CHIEF ENGINEER  
 BY *[Signature]* BY *[Signature]*  
 SANITATION ENGINEER OFFICE ENGINEER  
 CHECKED BY *[Signature]* 7-22-59  
 OFFICE OF COUNTY ENGINEER, REG. C. E. NO. 13,677

SUBMITTED BY *[Signature]* 7-22-59  
 US CREDIT REGIONAL ENGINEER, REG. C.E. 387

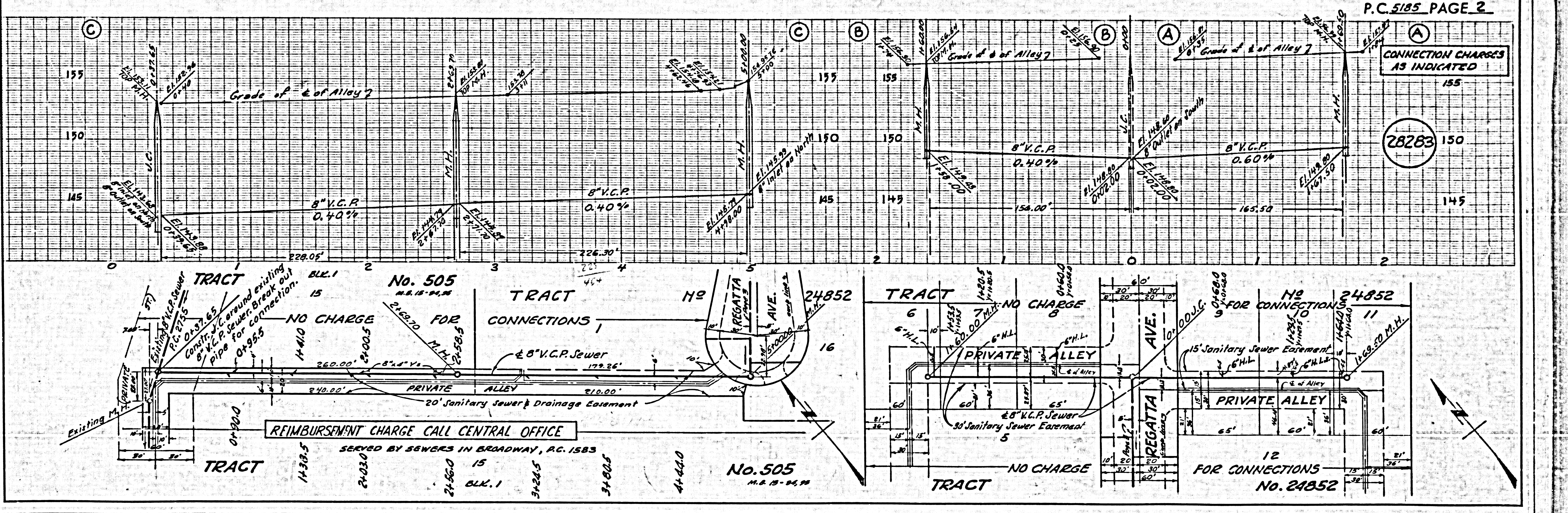

CONNECTION CHARGES  
 AS INDICATED

28283



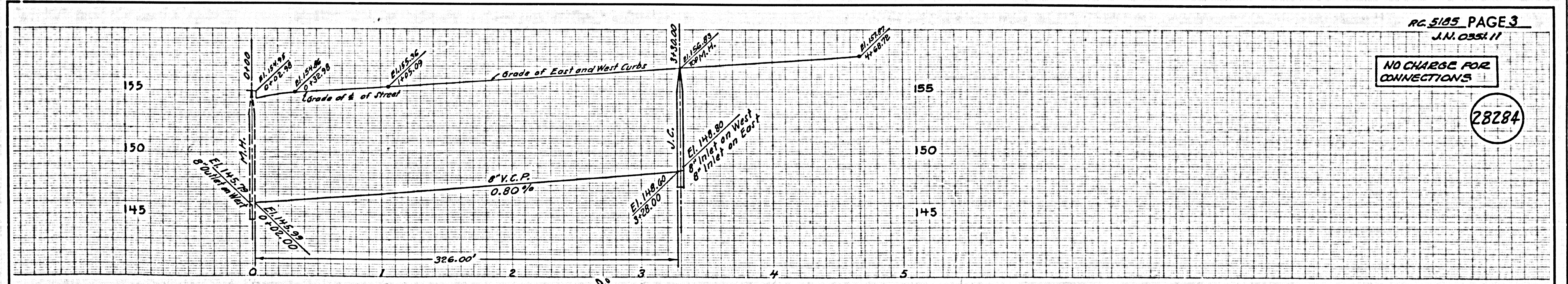

PG. 5185 PAGE 3  
J.N. 0351 11

NO CHARGE FOR CONNECTIONS

28284

