

B.M. 5Y 2232 Elev. 77.699 (1955)  
 L.C.T. in S. curb of Parkway 21'E. of catch  
 basin E.T.N. & Excelsior Dr. 6' x 40' W  
 & Graystone Ave. prop. (Artesia Quad).

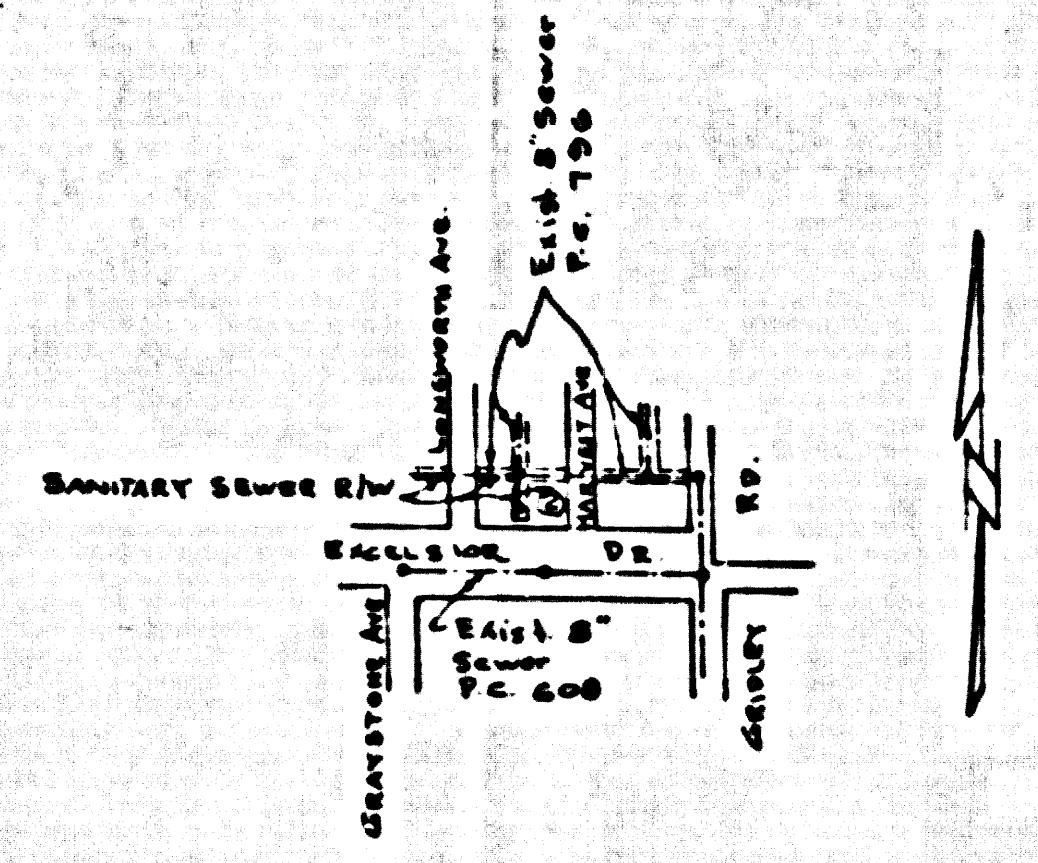

INDEX MAP  
 Scale 1"=600'  
 P.C. 5192

### NORWALK BLDG. DIST. NO. 4.06

- NOTES**
1. PROVIDE STAKES ON THE PROPERTY LINE OR PROPERTY LINES PRODUCED AT RIGHT ANGLES TO THE SEWER LINE AT THE CENTER LINE OF EACH MANHOLE.
  2. NO REPRESENTATIVE OF THE CITY ENGINEER WILL SURVEY OR LAY OUT ANY PORTION OF THE WORK.
  3. THE OWNER OR HIS AUTHORIZED REPRESENTATIVE SHALL FURNISH THE CITY ENGINEER WITH GRADE SHEETS AND STATIONING FOR ALL HOUSE LATERALS AND Y BRANCHES AND SHALL PROVIDE STAKES FOR THEM AT THEIR PROPER LOCATIONS WITH STATIONING PLAINLY MARKED. ANY CHANGE IN LOCATION SHALL BE REQUESTED BY WRITING BY THE OWNER OR HIS REPRESENTATIVE.
  4. THE CONTRACTOR SHALL BE RESPONSIBLE FOR THE PROTECTION OF ALL EXISTING UTILITIES AND SHALL BE RESPONSIBLE FOR THE PROTECTION OF ALL EXISTING UTILITIES FOR EACH HOUSE LATERAL ON THE GRADE SHEET.
  5. NO REVISIONS SHALL BE MADE IN THESE PLANS WITHOUT THE APPROVAL OF THE CITY ENGINEER.
  6. USE STANDARD MANHOLE FRAMES AND COVERS, S-117.
  7. USE STANDARD 6" RING SIZE PIPE.
  8. USE CEMENT MORTAR OR "WEDGE LOCK" OR "SPYER-SEAL" FOR ALL V.C.P. JOINTS PER SPECS. SECS. 36 & 38.
  9. RESURFACE ALL TRINCHES WITHIN PAVED AREA TO MEET CITY OF NORWALK OR CALIF. STATE HIGHWAY BROWNEMENTS IN ACCORDANCE WITH PERMITS.
  10. INCREASE FOUR FEET OF SEWER AT POINTS OF INTERFERENCE WITH POLES, CASE NO. S-172.
  11. INCREASE FOUR FEET OF SEWER AT POINTS OF INTERFERENCE WITH POLES, CASE NO. S-172.
  12. ALL STRUCTURES SHALL BE BRICK SEWER STRUCTURES, S-194.
  13. FOR ALLOWABLE LEAKAGE PER USE FORMULA NO. 1 PER SPECS. SEC. 34.
  14. MANHOLE TOPS IN UNIMPROVED RIGHTS-OF-WAY TO BE SIX INCHES ABOVE FINISHED GRADE.
  15. THE CONTRACTOR SHALL NOTIFY THE CONSTRUCTION & STORM DRAIN DIVISION BY TELEPHONE, MADISON 9747, EXT. 342, AT LEAST TWENTY FOUR HOURS BEFORE STARTING ANY WORK UNDER THIS CONTRACT.

**No Charge  
 For Connections**  
*Stickland 9-22-59*

PROFILE ALIGNMENT AND GRADE OF **P.C. 5192**  
**SANITARY SEWERS PAGE 1**

TO BE CONSTRUCTED IN  
**R/W. NORTH OF  
 EXCELSIOR DRIVE**  
**PRIVATE CONTRACT NO. 5192**

W.S. 33  
 1 SHEET, 2 PAGES  
 SCALE:  $\frac{1}{4}$ " = 1' JULY, 1959 **28,175**  
 PREPARED IN THE OFFICES OF

**OLSON SURVEYING SERVICE**  
 By: *Frank J. Carlson*  
 REG. C. E. NO. 1820  
 FOR LEGEND SEE PLAN NO. S-A-64

**NOTE:**  
 GRADES TO WHICH THIS IMPROVEMENT IS TO BE CONSTRUCTED ARE SHOWN ON PLANS AND PROFILES. GRADE POINTS FOR TOP OF CURB, CENTER LINE OF STREET, OR CENTER LINE OF ALLEYS ARE SHOWN BY CIRCLES ON PROFILES. AT ALL POINTS BETWEEN INDICATED POINTS THE GRADE SHALL BE ESTABLISHED SO AS TO CONFORM TO A STRAIGHT LINE BETWEEN SAID INDICATED POINTS.  
 ELEVATIONS ARE IN FEET ABOVE U.S.C. & G.S. MEAN SEA LEVEL DATUM OF 1929.  
 THE DRAWINGS AND THE DATA HEREON ARE HEREBY MADE A PART OF THE SPECIFICATIONS.  
 WORK SHALL BE CONSTRUCTED ACCORDING TO SPECIFICATIONS ON FILE IN THE OFFICE OF THE CITY ENGINEER AND SHALL BE PROSECUTED ONLY IN THE PRESENCE OF THE CITY ENGINEER.  
 BEFORE WORK CAN BE STARTED, THE CONTRACTOR MUST OBTAIN A PERMIT TO EXCAVATE IN CITY STREETS FROM THE CITY OF NORWALK.  
 THE CONTRACTOR SHALL MAKE A DEPOSIT WITH THE CITY OF NORWALK, 151-525 S. WALNUT AVE., NORWALK, CALIF., TWENTY PER CENT OF CONSTRUCTION INSPECTION AND RECORD PLANS.  
 APPROVAL OF THIS PLAN BY THE CITY OF NORWALK DOES NOT CONSTITUTE A REPRESENTATION AS TO THE ACCURACY OF THE LOCATION OR OF THE EXISTENCE OR NON-EXISTENCE OF ANY UNDERGROUND UTILITY PIPE, OR STRUCTURE WITHIN THE LIMITS OF THIS PROJECT. THIS NOTE APPLIES TO ALL PAGES.  
 IF WORK IS TO BE DONE IN A STATE HIGHWAY, A PERMIT MUST BE OBTAINED FROM THE STATE OF CALIFORNIA, DIVISION OF HIGHWAYS, 126 SOUTH SPRING STREET.

**CITY OF NORWALK, CALIFORNIA**  
 APPROVED, JOHN A. LAMBE, CITY ENGINEER  
 APPROVED, C.R. CAMPBELL, CHIEF ENGINEER  
 CO. SAN. ENG. NO. 2  
 BY: *S.P. Duval* SANITATION ENGINEER  
 BY: *S.P. Duval* OFFICE ENGINEER  
 CHECKED BY: *W. Under*  
 OFFICE OF CITY ENGINEER, REG. C. E. NO. 3466

Submitted By: *John J. Ester* 8-25-59  
 Joe Carrillo Regional Engineer, Reg. C.E. No. 3811

P.C. 5192 PAGE 2

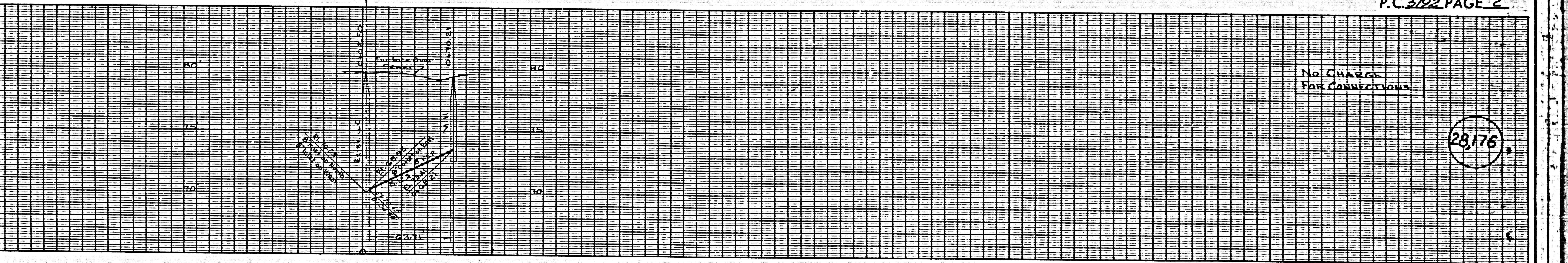

**No Charge  
 For Connections**

**28,175**

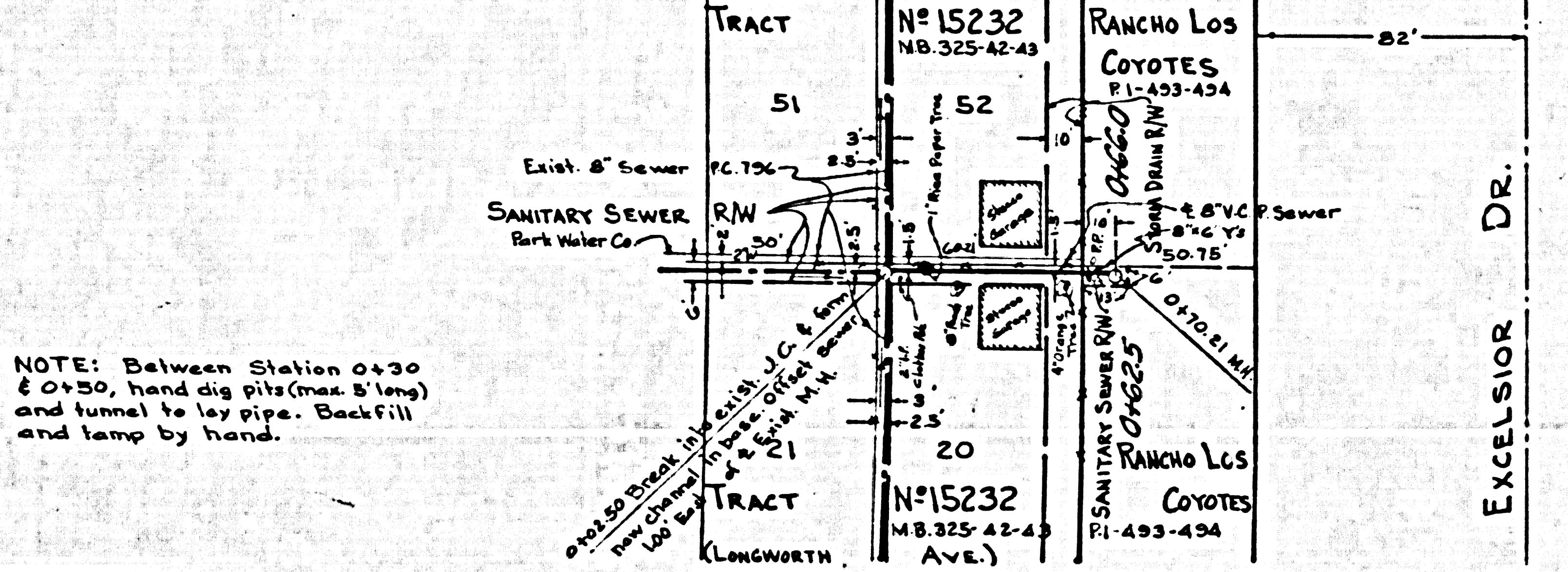

NOTE: Between Station 0+30 & 0+50, hand dig pits (max. 8' long) and tunnel to lay pipe. Backfill and tamp by hand.

EXCELSIOR DR.