

INDEX MAP
1"=200'

ESTIMATED QUANTITIES

1. 6" V.C.R. Sewer Main (with manholes) -- 500 lin. ft.
2. Standard Manholes (3ea) ----- 234 sq. ft.
3. 6" V.C.R. House Connection ----- 87 lin. ft.

CONSTRUCTION NOTES

1. Construct 6" V.C.R. Sewer Main and 6" V.C.R. Pipes as shown on Plan. (NOTE: Lay all pipes flat.)
2. Construct Standard Manhole.
3. Construct 6" V.C.R. House Connection. (See Typical Section)

BENCH MARK

On East Rim of existing Manhole (5th 0100),
ref. Boyle Engineering P.B. # 20 1/2 10. ELEV. = 341.43.

LA PUENTE BLDG. DIST. NO. 2

NO REVISIONS SHALL BE MADE IN THESE PLANS WITHOUT THE APPROVAL OF THE PROJECT ENGINEER.
USE STANDARD MANHOLE FRAMES AND COVERS, S-117, EXCEPT THAT THE COVERS SHALL READ "CITY OF LA PUENTE".
USE STANDARD STRENGTH PIPE EXCEPT AS NOTED.
USE CONCRETE MANHOLE OR "MUNICIPAL" OR "PUB. SEW." FOR ALL V.C.R. JOINTS PER S.P.C.S., SECS. 24 & 25.
SURFACE ALL TRENCH WITHIN PAVED AREA TO MEET L.A. COUNTY ROAD DEPT. OF CALIF. STATE HIGHWAY REQUIREMENTS IN ACCORDANCE WITH PERMITS.
BENCH MARK SHALL BE SET AT POINTS OF INTERFERENCE WITH POLES, CASE NO. S-172.
HOUSE LATERALS TO BE CONSTRUCTED WITH BRICKS AT PROPERTY LINE AND PHYSICAL ASSESSOR CONNECTION DETAIL.
ALL STRUCTURES SHALL BE BRICK SEWER STRUCTURES, S-194, EXCEPT AS NOTED.
FOR ALLOWABLE LEAKAGE TEST USE FORMULA NO. 1 S.P.C.S., SEC. 24.
MANHOLE TOPS IN UNIMPROVED RIGHTS OF WAY TO BE SIX INCHES ABOVE FINISHED GRADE.
THE CONTRACTOR SHALL NOTIFY THE OFFICE OF BOYLE ENGINEERING BY TELEPHONE, IN 76472, AT LEAST TWENTY-FOUR HOURS BEFORE STARTING ANY WORK UNDER THIS CONTRACT.

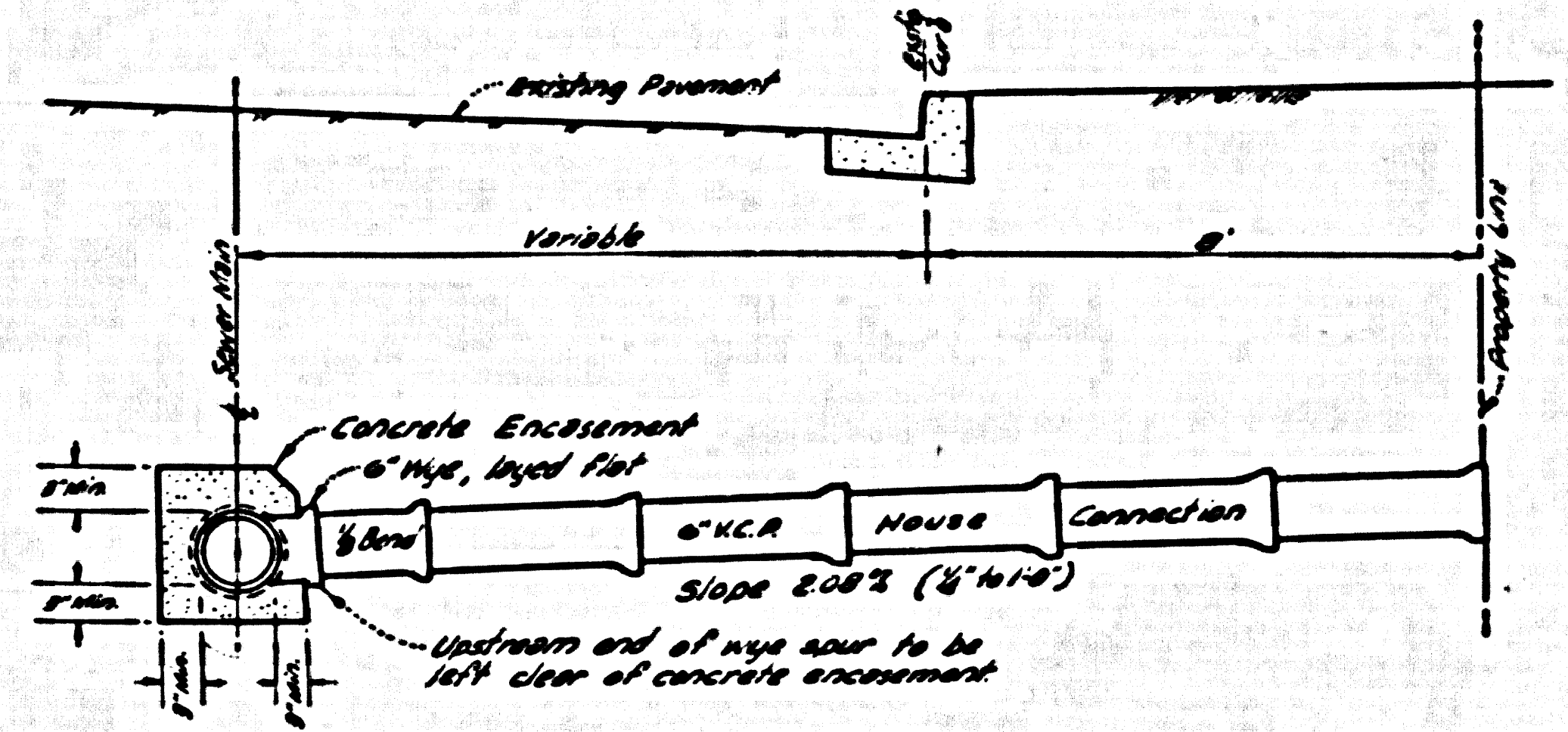

TYPICAL HOUSE CONNECTION
1/4" = 1"

CONSTRUCTED IN
GLENDORA AVENUE
CITY OF LA PUENTE
PRIVATE CONTRACT NO. 5212

W.S.
1 SHEETS, 2 PAGES

SCALE: HORIZ. 1"=40' VERT. 1"=4'

JULY, 1959

PREPARED BY THE OFFICES OF

BOYLE ENGINEERING

PROJECT ENGINEER CITY OF LA PUENTE

By: *William A. Boyle*

42311

REG. C. E. NO. 5201

FOR LEGEND SEE PLAN NO. S-A-64

NOTE:
GRADES TO WHICH THIS IMPROVEMENT IS TO BE CONSTRUCTED ARE SHOWN ON PLANS AND PROFILE GRADE POINTS FOR TOP OF CURBS, CENTER LINE OF STREETS, OF CENTER LINE OF ALLEYS ARE SHOWN BY CIRCLES ON PROFILES AT ALL POINTS BETWEEN INDICATED POINTS THE GRADE SHALL BE ESTABLISHED SO AS TO COME UP TO A STRAIGHT LINE BETWEEN SAID INDICATED POINTS.
THIS DRAWING AND THE DATA HEREON ARE HEREBY MADE A PART OF THE SPECIFICATIONS.
WORK SHALL BE CONSTRUCTED ACCORDING TO THE SPECIFICATIONS ON FILE IN THE OFFICE OF THE COUNTY ENGINEER AND SHALL BE PROSECUTED ONLY IN THE PRESENCE OF THE PROJECT ENGINEER.
IF WORK SHALL BE CONSTRUCTED ACCORDING TO THE SPECIFICATIONS ON FILE IN THE OFFICE OF THE COUNTY ENGINEER AND SHALL BE PROSECUTED ONLY IN THE PRESENCE OF THE PROJECT ENGINEER.
L. A. COUNTY ROAD DEPT. STREET OFFICE NO. 1, 4747 EAST SHAWAN BLVD., GLENDORA, CALIF. AND GRADE
APPROVAL OF THE PROJECT ENGINEER SHALL BE NECESSARY INCLUDING PRODUCTION CHECKS.
APPROVAL OF THIS PLAN BY THE CO. OF LA PUENTE AND THE CITY OF LA PUENTE SHALL CONSTITUTE A WAIVER OF THE LIABILITY OF THE LOCATION OF OR THE DISTANCE OR THE PROXIMITY OF ANY IMPROVEMENTS TO ANY STRUCTURE OR TO THE LINES OF THE PROJECT. THIS WAIVER SHALL BE IN FULL FORCE AND EFFECT.
IF WORK IS TO BE DONE IN A STATE HIGHWAY, A PERMIT MUST BE OBTAINED FROM THE STATE OF CALIFORNIA, DIVISION OF HIGHWAYS, 130 SOUTH SHAWAN BLVD.

CITY OF LA PUENTE, CALIFORNIA

APPROVED, GORDON L. DEHL, CITY MANAGER

APPROVED, C. R. CAMPBELL, CHIEF ENGINEER

Gordon L. Dehl

C. R. Campbell

CHECKED BY

REFERENCE PRIVATE CONTRACT NO. 5212

APPROVED, JOHN A. LAMBIE, COUNTY ENGINEER

By: *John A. Lambie* DATE: 7/30/59

SANITATION ENGINEER

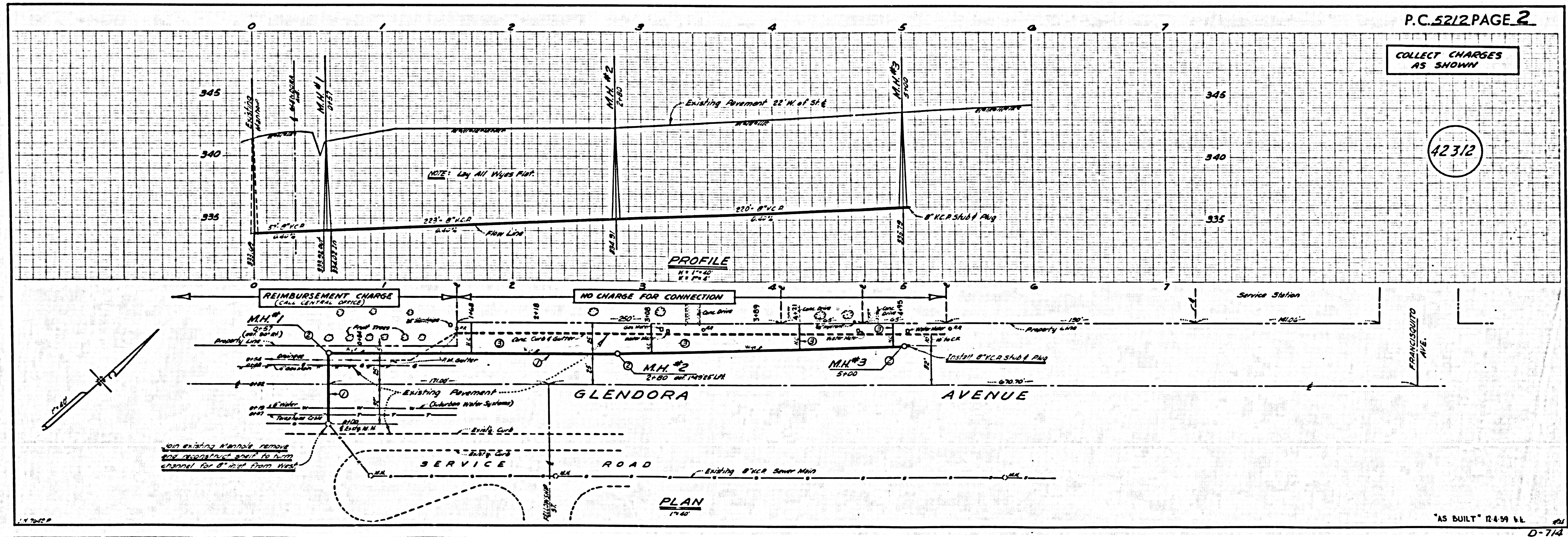

COLLECT CHARGES AS SHOWN

42312