

PC 5226

PORTION PAGE 1
P.C. 5226

BM TE 229 FB 1485 P.134
GARIBALDI AVE. & PUTNEY AVE.
S.E. COR. ST. SP. IN CURB 6' 30"
OF SO. END OF CR. ELEV. 451.768

NOTE: TEMPLE CITY BLDG. DIST. NO-5
Provide stakes on the property lines or property lines produced at right angles to the sewer line at the center line of each manhole.
No representative of the County Engineer will survey or layout any portion of the work.

The owner or his authorized representative shall furnish the County Engineer with grade sheets and stations for all house laterals and Y branches and shall provide stakes for them at their proper locations with stationing plainly marked. Any change in location shall be requested in writing by the owner or his representative.

- No revisions shall be made in these plans without the approval of the County Engineer.
1. Use standard manhole frames and covers, S-a-117.
 2. Use standard strength pipe
 3. Use cement mortar OR WEDGE-LOCK OR SPEED-SEAL FOR ALL V.C.P. JOINTS PER. SPECS. SEC. 36 & 48
 4. Resurface all trench within paved area to meet L.A. County Road Dept. or California State Highway Dept. requirements in accordance with permit.
 5. Encase four feet of sewer at points of interference with poles, S-A-172 CASE III
 6. House laterals to be constructed with inverts at property line 6 feet below curb grade
 7. All structures shall be brick sewer structures, S-a-104.
 8. For allowable leakage test, use Formula No. 1, Spec's, Sec. 54
 9. THE PRIVATE ENGINEER SHALL FURNISH THE HOUSE LATERAL DEPTH AT THE PROPERTY LINE BELOW THE TOP OF CURB ELEVATION FOR EACH HOUSE LATERAL ON THE GRADE SHEET.
 10. THE CONTRACTOR SHALL NOTIFY THE CONSTRUCTION & STORM DRAIN DIVISION BY TELEPHONE MADISON 9-4767 EXT. 362 AT LEAST 24 HOURS BEFORE STARTING ANY WORK UNDER THIS CONTRACT.
 11. STANDARD SPECS DATED MAY 16, 1959 APPLY IN THE CONSTRUCTION OF THIS PROJECT.

CONNECTION CHARGES AS INDICATED
S.M. Caldwell 6-26-57

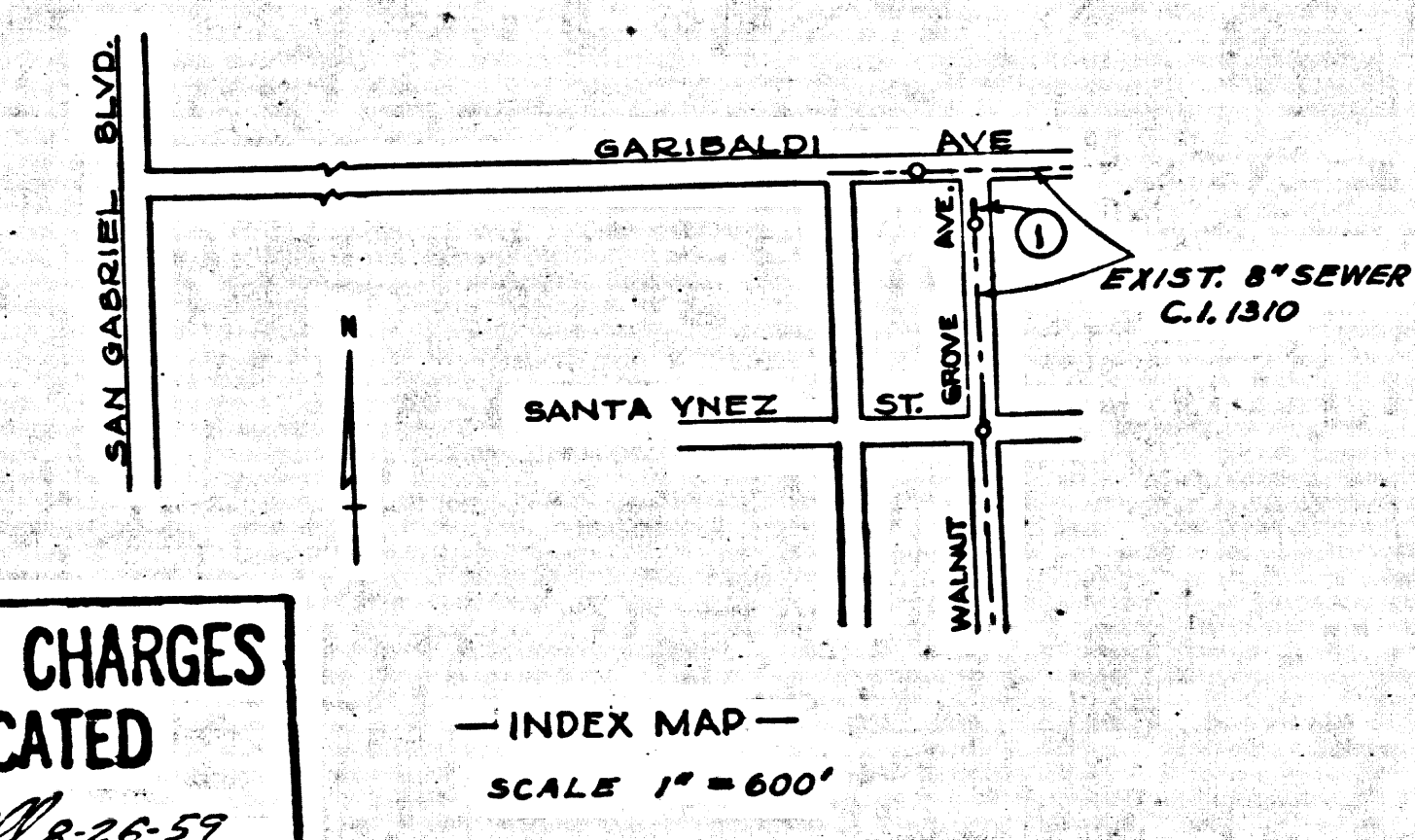

PROFILE, ALIGNMENT AND GRADE OF
SANITARY SEWERS
TO BE CONSTRUCTED IN

WALNUT GROVE AVE.
BETWEEN GARIBALDI AVE. & SANTA YNEZ ST.
(EXTENSION)

PRIVATE CONTRACT NO. 5226
W. S. 44
ONE SHEET

Scale: VERT. 1"=40'
HORIZ. 1"=40' JULY 1959
PREPARED IN THE OFFICES OF

Walter J. Hughes
Reg. C. E. No. 2-3796

FOR LEGEND SEE PLAN NO. S-a-64

P.C. 5226
PAGE 1
J.N. 0351.35

28,195

NOTE:
Grades to which this improvement is to be constructed are shown on plans and profiles. Grade points for top of curbs, center line of streets, or center line of alleys are shown by circles on profiles. At all points between designated points the grade shall be established so as to conform to a straight line drawn between said designated points.
Elevations are in feet above U.S.C. & G.S. SEA LEVEL DATUM OF 1929.
This drawing and the data hereon are hereby made a part of the specifications.
Work shall be constructed according to specifications on file in the office of the County Engineer and shall be prosecuted only in the presence of the County Engineer.
Before work can be started, the contractor must obtain a permit to excavate in County streets from the L.A. County Road Dept. DIST. NO. 1 and make a deposit with the County Engineer, RM. 324 PAN. AM. BLDG. 253 S.O. BROADWAY sufficient to cover the cost of construction inspection and record plans.
Approval of this plan by the County of Los Angeles does not constitute a representation as to the accuracy of the location of or the existence or non-existence of any underground utility, pipe, or structure within the limits of this project. This note applies to all sheets.
If work is to be done in a State Highway, a permit must be obtained from the State of California, Division of Highways, 120 South Spring Street.

COUNTY OF LOS ANGELES, CALIFORNIA
Approved, JOHN A. LIMBART, County Engineer
Approved, C.R. CONNOR
CHIEF ENGR. CO. SAN DIST. NO. 15
Walter J. Hughes
Office Engineer
Checked by *W. J. Wanda*
Office Engineer
Office of County Engineer, Reg. C. E. No. 2-406
SUBMITTED *H. F. Bransford*
SAN GABRIEL VALLEY REGIONAL ENGINEER