

WHITTIER BLDG. DIST. NO. 11

PROFILE ALIGNMENT AND GRADE OF
SANITARY SEWERS P.C. 5257
 TO BE CONSTRUCTED IN PAGE 1
COLIMA ROAD J.N. 0351.54
 (28,333)

PRIVATE CONTRACT NO. 5257
 J.N. 0351.54
 W.S. 34

1 SHEET, 2 PAGES
 SCALE: VERT. 1" = 4' HORIZ. 1" = 40'

AUG. 1959
 PREPARED IN THE OFFICES OF

HANS C. THOMSEN - CIVIL ENGINEER

REG. C. E. NO. 3742

FOR LEGEND SEE PLAN NO. S-A-84

NOTES
 GRADES TO WHICH THIS IMPROVEMENT IS TO BE CONSTRUCTED ARE SHOWN ON PLANS AND PROFILES. GRADE POINTS FOR TOP OF CURBS, CENTER LINE OF STREETS, OR CENTER LINE OF ALLEYS ARE SHOWN BY CIRCLES ON PROFILES. AT ALL POINTS BETWEEN DESIGNATED POINTS THE GRADE SHALL BE RECONSTRUCTED AS TO CONFORM TO A STRAIGHT LINE BEYOND SAID DESIGNATED POINTS.
 ELEVATIONS ARE IN FEET ABOVE U.S.C. & G.S. SEA LEVEL DATUM OF 1929.
 THIS DRAWING AND THE DATA HEREON ARE HEREBY MADE A PART OF THE SPECIFICATIONS.
 WORK SHALL BE CONSTRUCTED ACCORDING TO SPECIFICATIONS ON FILE IN THE OFFICE OF THE COUNTY ENGINEER AND SHALL BE PROSECUTED ONLY IN THE PRESENCE OF THE COUNTY ENGINEER.
 BEFORE WORK CAN BE STARTED, THE CONTRACTOR MUST OBTAIN A PERMIT TO EXCAVATE IN COUNTY STREETS FROM THE L.A. COUNTY ROAD DEPT., DISTRICT OFFICE NO. 11 AND MAKE A DEPOSIT WITH THE COUNTY ENGINEER, 1500 SAN ANTONIO BUILDING, 250 SO. BROADWAY SUFFICIENT TO COVER THE COST OF CONSTRUCTION INSPECTION AND RECORD PLANS.
 APPROVAL OF THIS PLAN BY THE COUNTY OF LOS ANGELES DOES NOT CONSTITUTE A REPRESENTATION AS TO THE ACCURACY OF THE LOCATION OF OR THE EXISTENCE OR NON-EXISTENCE OF ANY UNRECORDED UTILITY PIPES OR STRUCTURE WITHIN THE LIMITS OF THIS PROJECT. THIS NOTE APPLIES TO ALL PAGES.
 IF WORK IS TO BE DONE IN A STATE HIGHWAY, A PERMIT MUST BE OBTAINED FROM THE STATE OF CALIFORNIA, DIVISION OF HIGHWAYS, 128 SOUTH SPRING STREET.

COUNTY OF LOS ANGELES, CALIFORNIA

APPROVED, JOHN A. LAMBE, COUNTY ENGINEER

APPROVED, C.E. THOMSEN, CIVIL ENGINEER

BY [Signature] ASSISTANT INITIATION ENGINEER

BY [Signature] OFFICE ENGINEER

CHECKED BY [Signature] 9-21-59

OFFICE OF CIVIL ENGINEER, REG. C. E. NO. 9426

SUBMITTED BY: [Signature] 9-17-59
 CONCESSIONS REGIONAL ENGINEER REG. C.E. NO. 3871

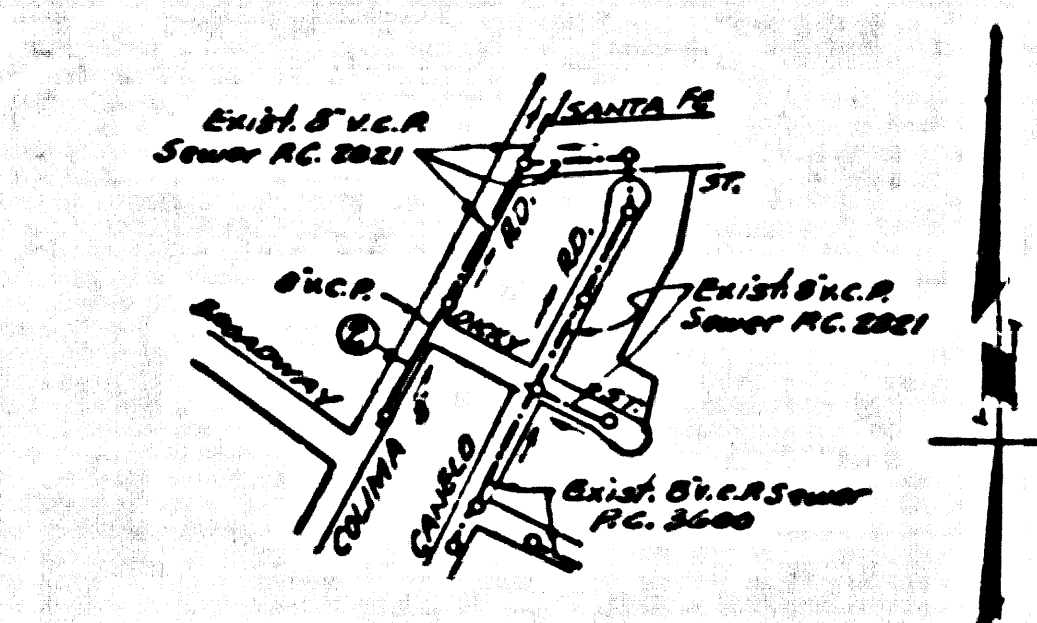

• INDEX MAP •
 P.C. 5257 SCALE: 1" = 400'

B.M. 5 X 1228 - L.E.T. Ch. of Conc. Handwall
 30' end of drain pipe 68' 2" N. of Santa
 Fe & 10' West of Colima Road
 (ELEV. 196.665 1958 Adj. Southern Survey)

CONNECTION CHARGES
 AS INDICATED
 [Signature] 9-17-59

P.C. 5257 PAGE 2

CONNECTION CHARGES
 AS INDICATED

(28,334)

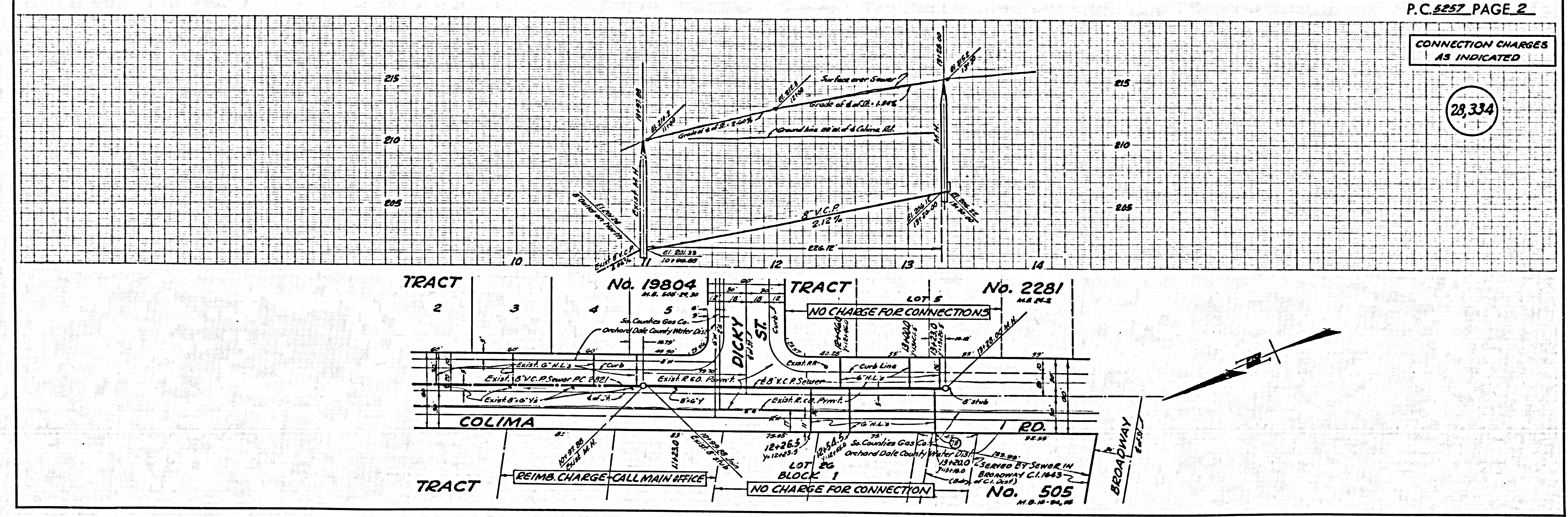

U. S. G. 100 000 1:62,500 (CAL. BLUE PRINT) SHEET 5-A-1