

PART OF PAGE 1
P.C. 5258
J.N. 0351.55

NO CHARGE FOR CONNECTIONS

R 5258

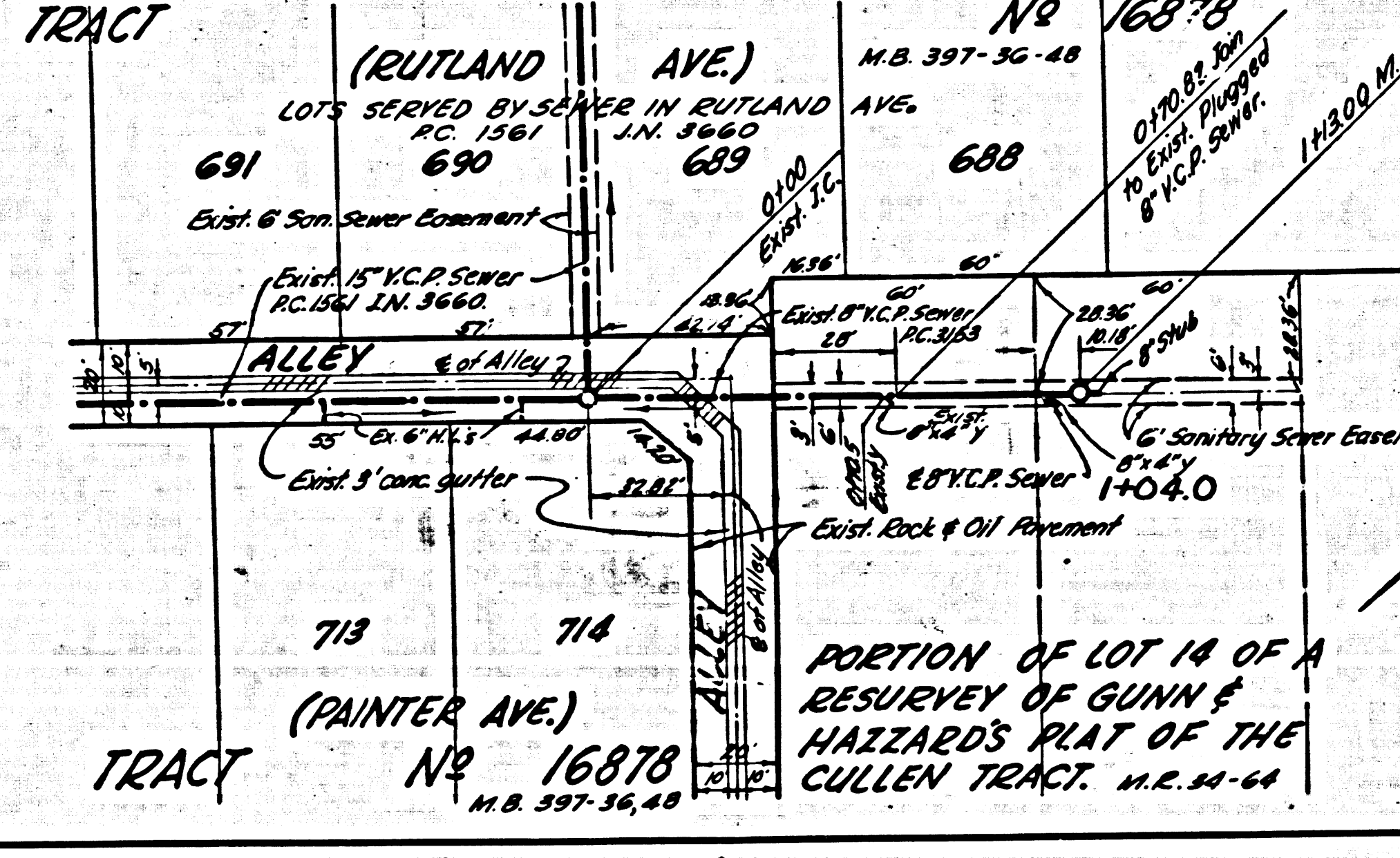

WHITTIER BLDG. DIST. NO. 11

- NOTES:**
- PROVIDE STAKES ON THE PROPERTY LINE OR PROPERTY LINES PRODUCED AT RIGHT ANGLES TO THE SEWER LINE AT THE CENTER LINE OF EACH MANHOLE.
 - NO REPRESENTATIVE OF THE COUNTY ENGINEER WILL SURVEY OR LAYOUT ANY PORTION OF THE WORK.
 - THE OWNER OR HIS AUTHORIZED REPRESENTATIVE SHALL FURNISH THE COUNTY ENGINEER WITH GRADE SHEETS AND STATIONING FOR ALL HOUSE LATERALS AND Y BRANCHES AND SHALL PROVIDE STAKES FOR THEM AT THEIR PROPER LOCATIONS WITH STATIONING PLAINLY MARKED. ANY CHANGE IN LOCATION SHALL BE REQUESTED IN WRITING BY THE OWNER OR HIS REPRESENTATIVE.
 - NO REVISIONS SHALL BE MADE IN THESE PLANS WITHOUT THE APPROVAL OF THE COUNTY ENGINEER.
 - USE STANDARD MANHOLE FRAMES AND COVERS, S.A-117.
 - USE STANDARD STRENGTH PIPE.
 - USE CEMENT MORTAR "WEDGE-LOCK" OR "SPEED-SEAL" FOR ALL VITRIFIED CLAY PIPE JOINTS PER SPACES SECTION 26 & 48.
 - RESURFACE ALL TRENCH WITHIN PAVED AREA TO MEET L.A. COUNTY ROAD DEPT., OR CALIF. STATE HIGHWAY DEPT. REQUIREMENTS IN ACCORDANCE WITH PERMITS.
 - ENCASE FOUR FEET OF SEWER AT POINTS OF INTERFERENCE WITH POLES, CASE #1, #4 & 7.
 - ENCASE SAFER-ROAD-TO-SEWER CONNECTIONS WITH 12-INCH-THICK-CONCRETE-PIPE-OR-EQUIV. 48-INCH-ODD-SHAFT-TO-18-INCH-ODD-SHAFT-TO-SEWER STRUCTURE, S.A-104, EXCEPT AS NOTED.
 - FOR ALLOWABLE LEAKAGE TEST USE FORMULA NO. 1 PER S.P.C.E., SEC. 54.
 - MANHOLE TOPS IN UNIMPROVED RIGHTS-OF-WAY TO BE 6" ABOVE FINISHED GRADE.
 - THE CONTRACTOR SHALL NOTIFY THE CONSTRUCTION & DEMOLITION DIVISION BY TELEPHONE IMMEDIATELY UPON THE START OF WORK AT LEAST 24 HOURS BEFORE STARTING ANY WORK UNDER THIS CONTRACT.
 - STANDARD SPECIFICATIONS DATED MAY 16, 1929 APPLY IN THE CONSTRUCTION OF THIS PROJECT.

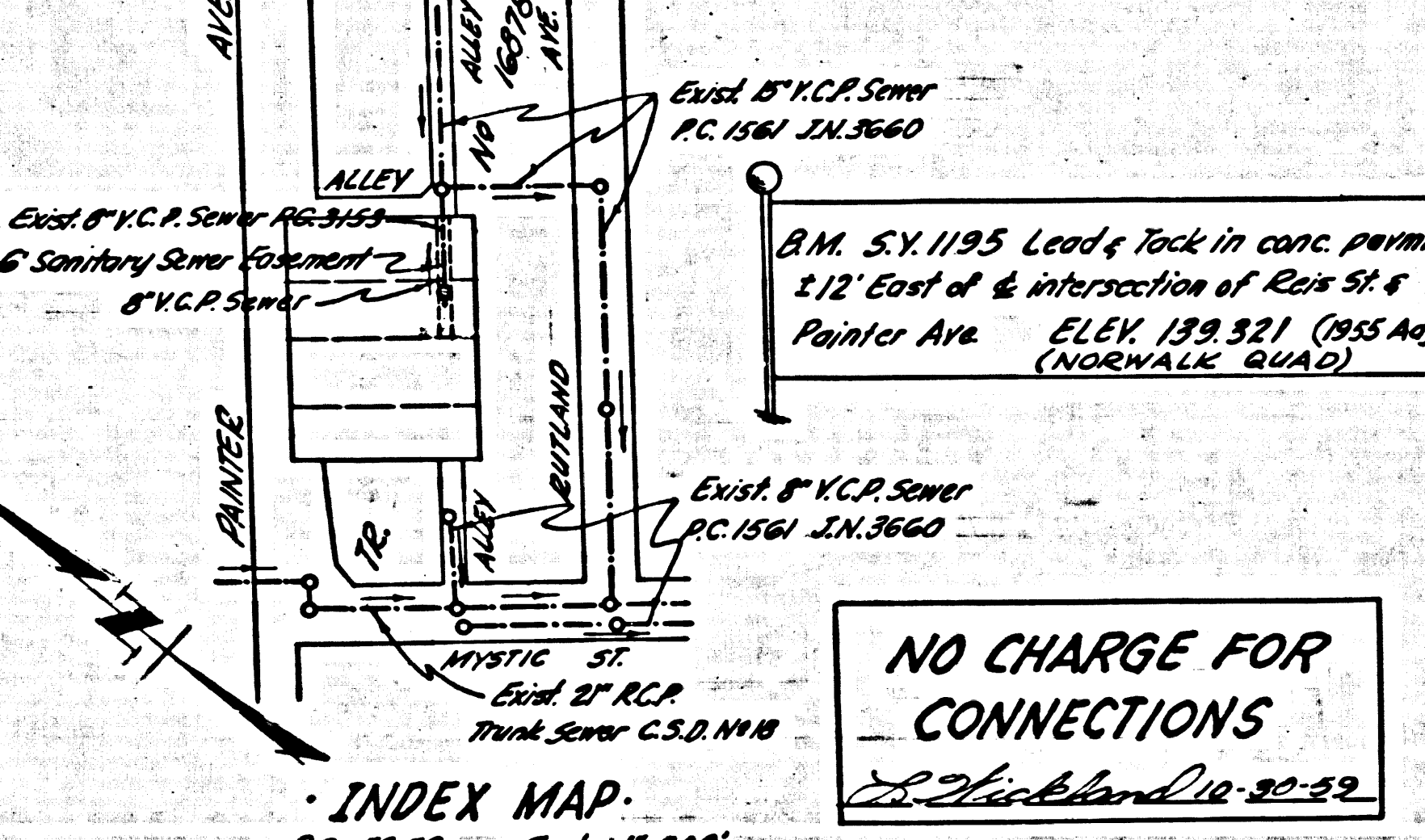

NO CHARGE FOR CONNECTIONS

INDEX MAP:
P.C. 5258 Scale: 1" = 200'
J.N. 0351.55

PROFILE ALIGNMENT AND GRADE OF **P.C. 5258**
SANITARY SEWERS PAGE **1**
TO BE CONSTRUCTED IN **J.N. 0351.55**

R/W SOUTH OF PAINTER AVE.

PRIVATE CONTRACT NO. 5258
J.N. 0351.55
W.S. 34

1 SHEET OF 1 PAGE
SCALE: VERT. 1" = 4'
HORIZ. 1" = 40' AUG. 1959
PREPARED IN THE OFFICES OF

KEMMERER ENGR. CO. INC.
BY: *Robert R. Flores*
REG. C. E. NO. 11662

FOR LEGEND SEE PLAN NO. S-A-64

NOTE:
GRADES TO WHICH THIS IMPROVEMENT IS TO BE CONSTRUCTED ARE SHOWN ON PLANS AND PROFILE. GRADE POINTS FOR TOP OF CURBS, CENTER LINE OF STREETS, OR CENTER LINE OF ALLEYS ARE SHOWN BY CIRCLES ON PROFILES. AT ALL POINTS BETWEEN DESIGNATED POINTS THE GRADE SHALL BE ESTABLISHED SO AS TO CONFORM TO A STRAIGHT LINE DRAWN BETWEEN SAID DESIGNATED POINTS.
ELEVATIONS ARE IN FEET ABOVE U.S.C. & G.S. MEAN SEA LEVEL DATUM OF 1929.
THIS DRAWING AND THE DATA HEREON ARE HEREBY MADE A PART OF THE SPECIFICATIONS.
IF WORK SHALL BE CONSTRUCTED ACCORDING TO SPECIFICATIONS ON FILE IN THE OFFICE OF THE COUNTY ENGINEER AND SHALL BE PROSECUTED ONLY IN THE PRESENCE OF THE COUNTY ENGINEER.
L.A. COUNTY ROAD DEPT., 106 W. 2ND ST. AND WALK & BOARD WITH THE COUNTY ENGINEER, ROOM 224 PAN AMERICAN BLDG., INC. 222 SO. BRIDGEMAN AVENUE TO COVER THE COST OF CONSTRUCTION INSPECTION AND RECORD PLANS.
APPROVAL OF THIS PLAN BY THE COUNTY OF LOS ANGELES DOES NOT CONSTITUTE A REPRESENTATION AS TO THE ACCURACY OF THE LOCATION OR THE EXISTENCE OR NON-EXISTENCE OF ANY UNDERGROUND UTILITY PIPE, OR STRUCTURE WITHIN THE LIMITS OF THIS PROJECT. THIS NOTE APPLIES TO ALL PAGES.
IF WORK IS TO BE DONE IN A STATE HIGHWAY, A PERMIT MUST BE OBTAINED FROM THE STATE OF CALIFORNIA, DIVISION OF HIGHWAYS, 126 SOUTH SPRING STREET.

COUNTY OF LOS ANGELES, CALIFORNIA
APPROVED, JOHN A. LAMBE, COUNTY ENGINEER
APPROVED, *C. P. Conroy*, CHIEF ENGINEER
BY: *C. E. Fisher*, ASSISTANT SANITATION ENGINEER
BY: *J. L. ...*, OFFICE ENGINEER
CHECKED BY: *310 Dale 11-3-59*
OFFICE OF COUNTY ENGINEER, REG. C. E. NO. 9406

SUBMITTED BY: *John L. Blevins* 10-30-59
SUPERVISOR, REGIONAL ENGINEER, REG. C. E. NO. 8771

P.C. 5258 R/W SOUTH OF PAINTER AVE.

28,460