

BENCH MARK - Top of 2" I.P. 650's
N. of E. Rosecrans & 50' N. of E. Garfield
Elev. 74.84
This Bench established from invert elevations
of manholes on San. Dist. Trunk Line.

CITY OF PARAMOUNT BLDG. DIST. NO. 4.04

PROFILE ALIGNMENT AND GRADE OF P.C. 5288
SANITARY SEWERS PAGE 1
TO BE CONSTRUCTED IN
SANITARY SEWER RIGHT OF WAY
N/O ROSECRANS AVE.

PRIVATE CONTRACT NO. 5288

W.S. 32
1 SHEETS, 2 PAGES

SCALE: VERT. 1" = 4' HORIZ. 1" = 40'

AUGUST, 1960

30,127

PREPARED IN THE OFFICES OF
CAL ENGINEERS

By: Russell G. Ludwig
REG. C. E. NO. 6222

FOR LEGEND SEE PLAN NO. S-A-84

- NOTES:
1. PROVIDE STAKES ON THE PROPERTY LINE OR PROPERTY LINES "PRODUCED AT RIGHT ANGLES TO THE SEWER LINE AT THE CENTER LINE OF EACH MANHOLE.
 2. NO REPRESENTATIVE OF THE CITY ENGINEER WILL SURVEY OR LAY OUT ANY PORTION OF THE WORK.
 3. THE OWNER OR HIS AUTHORIZED REPRESENTATIVE SHALL FURNISH THE CITY ENGINEER WITH GRAB SHEETS AND STATIONING FOR ALL HOUSE LATERALS AND T BRANCHES AND SHALL PROVIDE STAKES FOR THEM AT THEIR PROPER LOCATIONS WITH STATIONING PLAINLY MARKED. ANY CHANGE IN LOCATION SHALL BE REQUESTED IN WRITING BY THE OWNER OR HIS REPRESENTATIVE.
 4. THE PRIVATE ENGINEER SHALL FURNISH THE HOUSE LATERAL DEPTH AT THE PROPERTY LINE BELOW THE TOP OF CURB ELEVATION FOR EACH HOUSE LATERAL ON THE GRADE SHEET.
 5. NO REVISIONS SHALL BE MADE IN THESE PLANS WITHOUT THE APPROVAL OF THE CITY ENGINEER.
 6. USE STANDARD MANHOLE FRAMES AND COVERS, S-117, COVER TO ROAD SEWER.
 7. USE STANDARD STRENGTH PIPE EXCEPT AS NOTED.
 8. USE CEMENT MORTAR OR "WEDGE-LOCK" OR "SPRUE-SEAL" FOR ALL V.C.P. JOINTS PER SPEC., SECS. 26 & 41.
 9. RESURFACE ALL TRENCH WITHIN PAVED AREA TO MEET L.A. COUNTY ROAD DEPT. OR CALIF. STATE HIGHWAY REQUIREMENTS IN ACCORDANCE WITH PERMITS.
 10. ENCASE FOUR FEET OF SA. 75 AT POINTS OF INTERFERENCE WITH POLES, CASE III, S-172.
 11. "UNDESIRABLE" AND "UNDESIRABLE" SHALL BE AS DEFINED IN THE STANDARD SPECIFICATIONS.
 12. ALL STRUCTURES SHALL BE BRICK SEWER STRUCTURES, S-194, EXCEPT AS NOTED.
 13. FOR ALLOWABLE LEAKAGE TEST USE FORMULA NO. 1, SPEC'S, SEC. 54.
 14. MANHOLE TOPS IN UNIMPROVED RIGHTS-OF-WAY TO BE LEVEL WITH FINISHED GRADE.
 15. THE CONTRACTOR SHALL NOTIFY THE CONSTRUCTION DIVISION BY TELEPHONE, MADISON 9-88, EXT 81-551 AT LEAST TWENTY-FOUR HOURS BEFORE STARTING ANY WORK UNDER THIS CONTRACT.
 16. STANDARD SPECIFICATION DATED JANUARY 1, 1960 ON FILE IN CITY APPLY IN THE CONSTRUCTION OF THIS PROJECT.

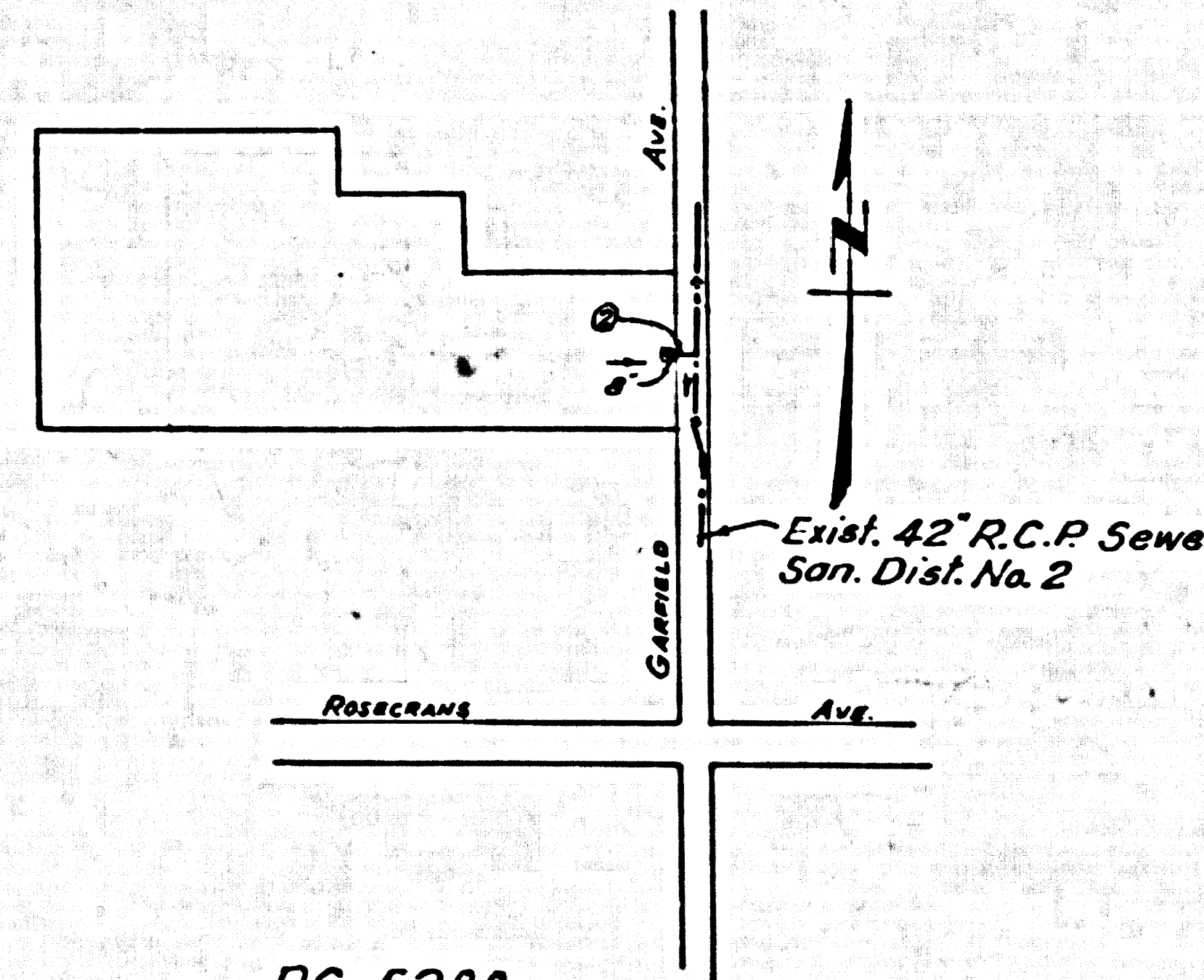

NO CHARGE FOR CONNECTIONS
D. J. Hubler 9-19-60

P.C. 5288
INDEX MAP
Scale 1" = 400'

Before breaking into any existing structure
and before final acceptance of this work,
County Sanitation District (SD 6-1961) shall
be notified in order that required inspection
can be made.

CITY OF PARAMOUNT, CALIFORNIA
APPROVED, JOHN A. LAMBE, CITY ENGINEER
APPROVED, C.R. COMPTON, CIVIL ENG'G.
BY: *R. G. Ludwig* SANITATION ENGINEER
BY: *M. J. ...* OFFICE ENGINEER
CHECKED BY: *C.E. ...*
OFFICE OF CITY ENGINEER, REG. C. E. NO. 6222
SUBMITTED BY: *John A. ...* 9-19-60
LOS CERRITOS REGIONAL ENGINEER, REG. C. E. NO. 3871

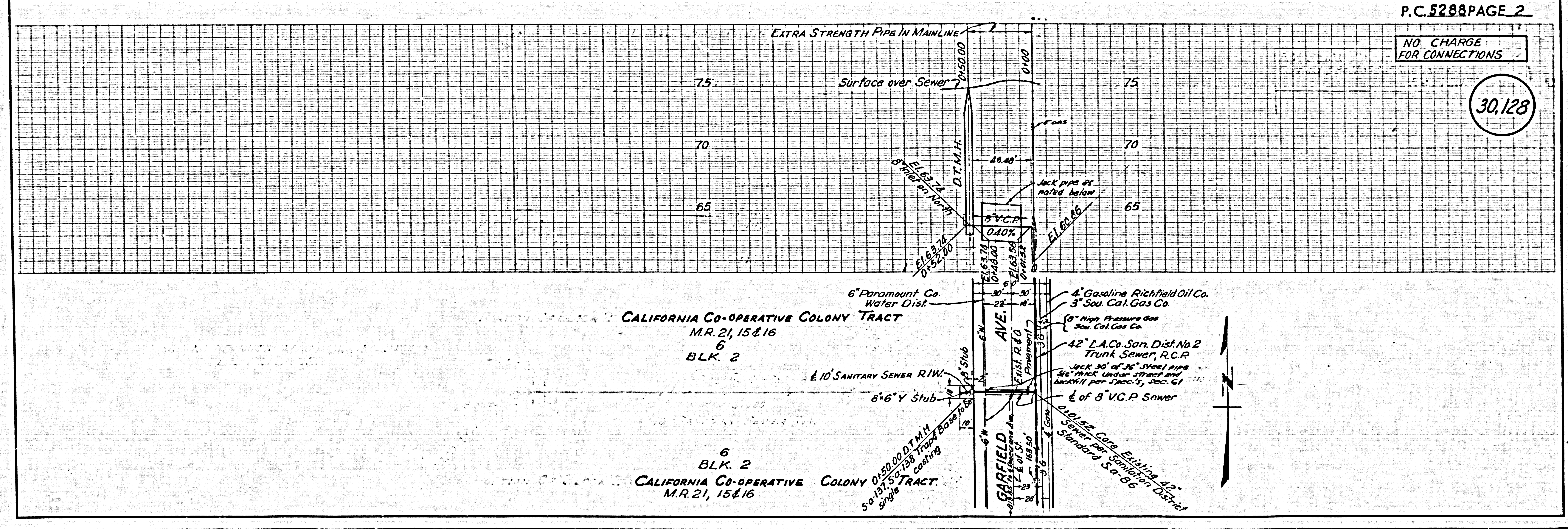

P.C. 5288 PAGE 2

NO CHARGE FOR CONNECTIONS

30,128

CALIFORNIA CO-OPERATIVE COLONY TRACT
M.R. 21, 15 & 16
BLK. 2
6
BLK. 2
CALIFORNIA CO-OPERATIVE COLONY TRACT
M.R. 21, 15 & 16

6" Paramount Co. Water Dist.
4" Gasoline Richfield Oil Co. 3" Sou. Cal. Gas Co.
8" High Pressure Gas Sou. Cal. Gas Co.
42" L.A. Co. San. Dist. No. 2 Trunk Sewer, R.C.P.
Jack 30' of 36" steel pipe 4 1/2" thick under street and backfill per Spec's, Sec. 61
6" of 8" V.C.P. Sewer
0.20% Grade Existing 42" Sewer per Sanitation District Standard S-A-84