

B.M. 8 Elev. 172.238  
 Set in lead in curb, 3 3/4" of 3" curb  
 return, S.E. Cor. of Alicante Rd. &  
 Nanyang Dr. R.B. 220-107

DOUBLE SCALE  
 NORWALK BLDG. DIST. NO. 42

PROFILE ALIGNMENT AND GRADE OF P.C. 5289  
 SANITARY SEWERS PAGE 1  
 TO BE CONSTRUCTED IN

O CASO AVENUE

PRIVATE CONTRACT NO. 5289  
 J.N. 0351.80  
 W.S. 34

2 SHEETS 3 PAGES

SCALE: VERT. 1" = 4' HORIZ. 1" = 40'

DATE: OCTOBER, 1959

PREPARED IN THE OFFICES OF

KISTNER, WRIGHT & WRIGHT

By: *H.C. VanderBrugg*

REG. C. E. NO. 6617

FOR LEGEND SEE PLAN NO. S-A-64

28,803

- NOTES:
- PROVIDE STAKES ON THE PROPERTY LINE OR PROPERTY LINES PRODUCED AT RIGHT ANGLES TO THE SEWER LINE AT THE CENTER LINE OF EACH MANHOLE.
  - NO REPRESENTATIVE OF THE COUNTY ENGINEER WILL SURVEY OR LAYOUT ANY PORTION OF THE WORK.
  - THE OWNER OR HIS AUTHORIZED REPRESENTATIVE SHALL FURNISH THE COUNTY ENGINEER WITH GRADE SHEETS AND STATION FOR A HOUSE LATERALS AND Y BRANCHES AND SHALL PROVIDE STAKES FOR THEM AT THEIR PROPER LOCATIONS WITH STATIONING AND PLAINLY MARKED. ANY CHANGE IN LOCATION SHALL BE INDICATED BY THE OWNER OR HIS REPRESENTATIVE.
  - NO DIVISIONS SHALL BE MADE IN THESE PLANS WITHOUT THE APPROVAL OF THE COUNTY ENGINEER.
  - USE STANDARD MANHOLE FRAMES AND COVERS, S-A-117, EXCEPT AS NOTED.
  - USE STANDARD STRENGTH PIPE EXCEPT AS NOTED.
  - USE CEMENT MORTAR "WADDER-LOCK" OR "SPEED-SEAL" FOR ALL U.C.P. JOINTS PER SPEC. SECS. 346 & 40.
  - RESURFACE ALL TRINCH WITHIN PAVED AREA TO MEET L.A. COUNTY ROAD DEPT. OR CALIF. STATE HIGHWAY DEPT. REQUIREMENTS IN ACCORDANCE WITH PERMITS.
  - SHADE FOUR FEET OF SEWER AT POINTS OF INTERFERENCE WITH POLES, CASE XII, S-A-172.
  - HOUSE LATERALS TO BE CONSTRUCTED WITH INVERTS AT PROPERTY LINE. PLOT SHOW CURB GRADE EXCEPT AS NOTED.
  - ALL STRUCTURES SHALL BE SINCE SEWER STRUCTURES, S-A-104, EXCEPT AS NOTED.
  - FOR ALLOWABLE LEAKAGE TEST USE FORMULA NO. 1 SPEC. S, SEC. 346.
  - MANHOLE TOPS IN UNIMPROVED RIGHTS-OF-WAY TO BE LEVEL WITH FINISHED GRADE.
  - THE CONTRACTOR SHALL NOTIFY THE CONSTRUCTION AND STORM DRAIN DIVISION BY TELEPHONE, NUMBER 9-9999 EXT. 352, AT LEAST TWENTY FOUR HOURS BEFORE STARTING ANY WORK UNDER THIS CONTRACT.
  - STANDARD SPECIFICATIONS DATED MAY 15, 1959 APPLY IN THE CONSTRUCTION OF THIS PROJECT.

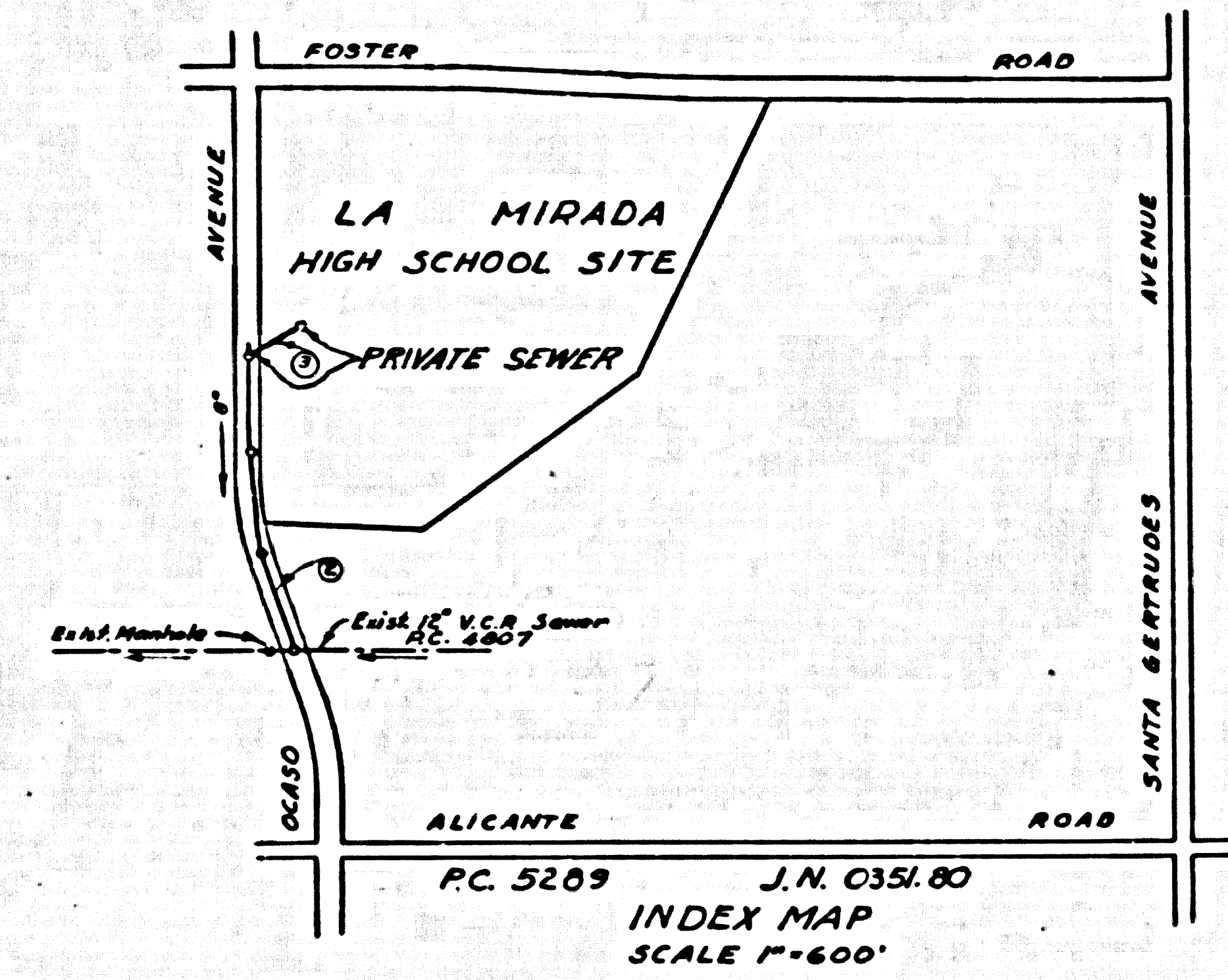

ISSUE NO PERMITS UNTIL  
 P.C. 4807 IS ACCEPTED

NO CHARGE FOR CONNECTIONS

*E. J. Hickland* 12-15-59

NOTES:  
 GRADES TO WHICH THIS IMPROVEMENT IS TO BE CONSTRUCTED ARE SHOWN ON PLANS AND PROFILE GRADE POINTS FOR TOP OF CURB, CENTER LINE OF STREETS, OR CENTER LINE OF ALLEYS ARE SHOWN BY CIRCLES ON "B" PLANS. AT ALL POINTS BETWEEN DESIGNATED POINTS THE GRADE SHALL BE ESTABLISHED SO AS TO CONFORM TO A STRAIGHT LINE DRAWN BETWEEN SAID DESIGNATED POINTS.  
 ELEVATIONS ARE IN FEET ABOVE U.S.C. & G.S. MEAN SEA LEVEL. DATE OF THIS PLAN IS 10-15-59.  
 THIS DRAWING AND THE DATA HEREON ARE HEREBY MADE A PART OF THE SPECIFICATION.  
 WORK SHALL BE CONSTRUCTED ACCORDING TO SPECIFICATIONS ON FILE IN THE OFFICE OF THE COUNTY ENGINEER AND SHALL BE PROSECUTED ONLY IN THE PRESENCE OF THE COUNTY ENGINEER.  
 BEFORE WORK CAN BE STARTED, THE CONTRACTOR MUST OBTAIN A PERMIT TO EXCAVATE IN COUNTY STREETS FROM THE L.A. COUNTY ROAD DEPT., DIST. 10, AND FROM A PERMIT WITH THE COUNTY ENGINEER ROOM 234 PALM AVENUE, BUILDING 523 SO. BROADWAY SUFFICIENT TO COVER THE COST OF CONSTRUCTION INSPECTION AND RECORD PLANS.  
 APPROVAL OF THIS PLAN BY THE COUNTY OF LOS ANGELES DOES NOT CONSTITUTE A REPRESENTATION AS TO THE ACCURACY OF THE LOCATION OF OR THE EXISTENCE OR NON-EXISTENCE OF ANY UNDERGROUND UTILITY PIPE, OR STRUCTURE WITHIN THE LIMITS OF THIS PROJECT. THE NOTER ASSUMES NO LIABILITY FOR SUCH MATTERS.  
 IF WORK IS TO BE DONE IN A STATE HIGHWAY, A PERMIT MUST BE OBTAINED FROM THE STATE OF CALIFORNIA, DIVISION OF HIGHWAYS, 120 SOUTH SPRING STREET.

COUNTY OF LOS ANGELES, CALIFORNIA

APPROVED, JOHN A. LAMBE, COUNTY ENGINEER

APPROVED, C.R. CONNOR, CHIEF ENGINEER

BY: *E.E. Dwyer* 12-18-59  
 ASST. SANITATION ENGINEER

CHECKED BY: *B.T. Worley* 12-18-59  
 OFFICE OF COUNTY ENGINEER, BLDG. 11636

SUBMITTED BY: *John L. Eyster* 12-15-59  
 LOS CERRITOS REGIONAL ENGINEER REG. C.E. NO. 3871

P.C. 5289 PAGE 2

DOUBLE SCALE  
 NO CHARGE  
 FOR CONNECTIONS

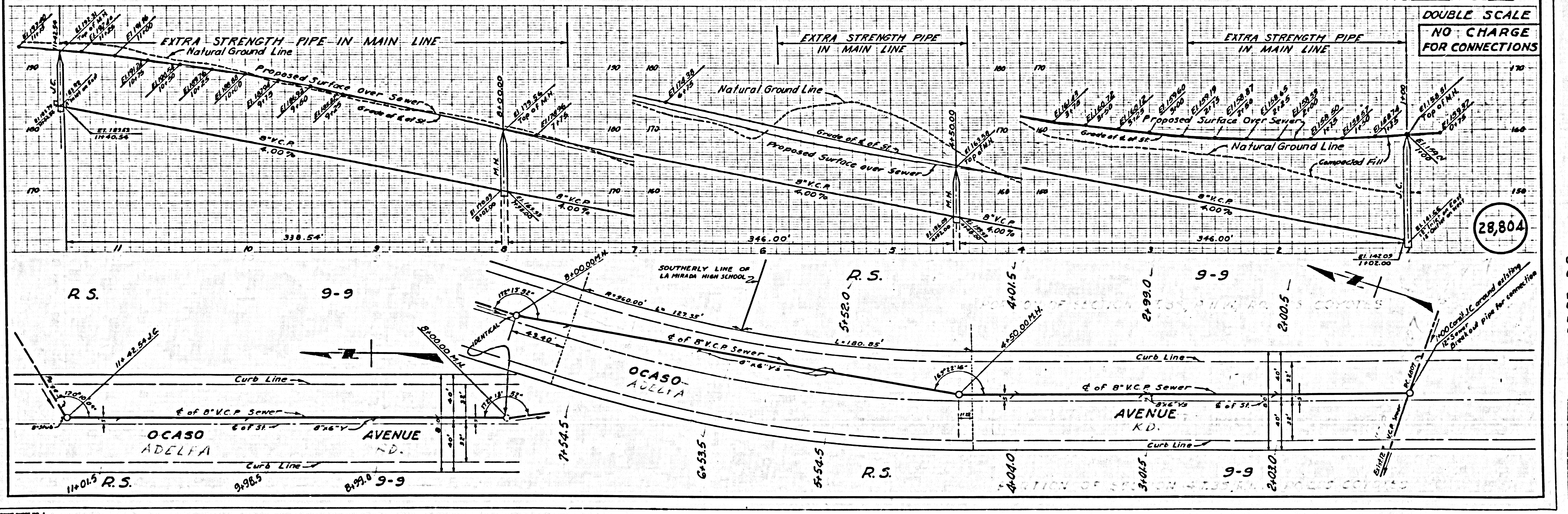

28,804

P.C. 5289

P.C. 5289 PAGE 3

DOUBLE SCALE  
NO CHARGE  
FOR CONNECTIONS

MAIN LINE SEWER AS  
SHOWN ON THIS PAGE  
IS A PRIVATE SEWER

28,805

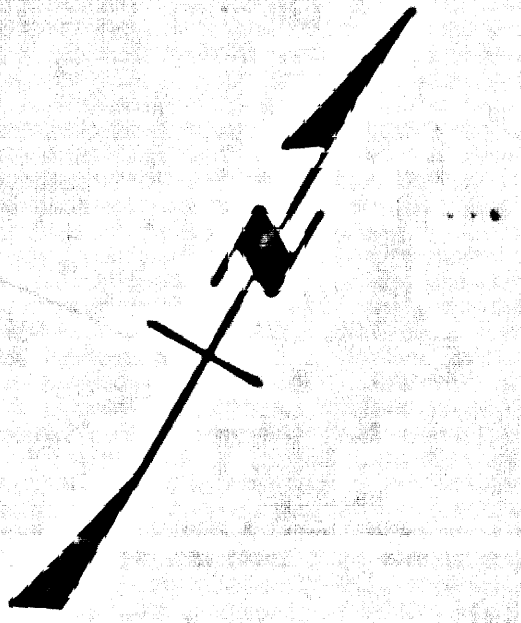
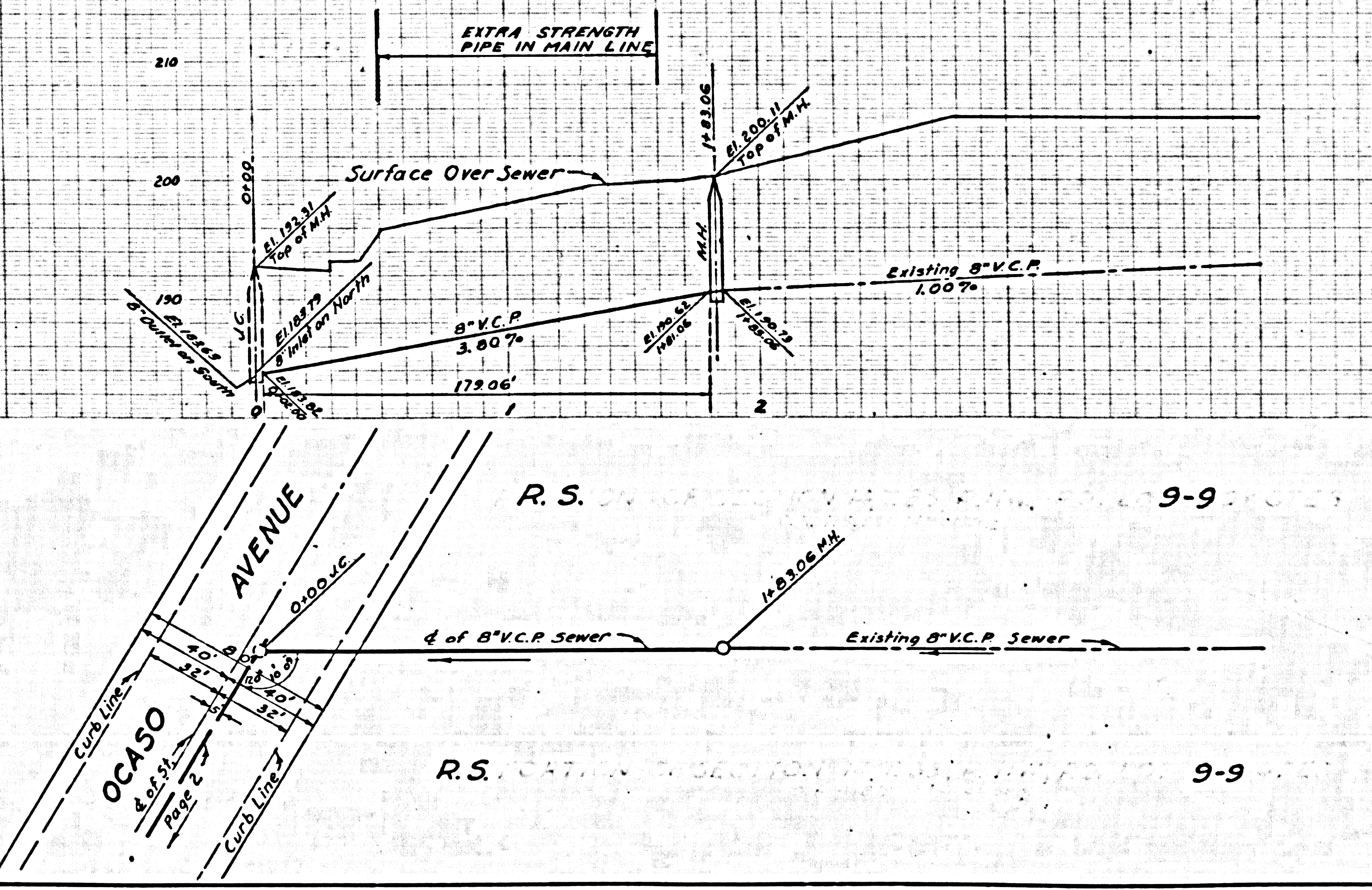

OCASO