

**NO CHARGE FOR CONNECTIONS**

**SANTA FE SPRINGS BLDG. DIST. NO. 405  
WHITTIER BLDG. DIST. NO. 11**

- NOTES**
1. PROVIDE STAKES ON THE PROPERTY LINE OR PROPERTY LINES PRODUCED AT RIGHT ANGLES TO THE SEWER LINE AT THE CENTER LINE OF EACH MANHOLE.
  2. NO REPRESENTATIVE OF THE COUNTY ENGINEER WILL SURVEY OR LAYOUT ANY PORTION OF THE WORK.
  3. THE OWNER OR HIS AUTHORIZED REPRESENTATIVE SHALL FURNISH THE COUNTY ENGINEER WITH GRADE SHEETS AND STATION FOR ALL HOUSE LATERALS AND Y BRANCHES AND SHALL PROVIDE STAKES FOR THEM AT THEIR PROPER LOCATIONS WITH STATIONING PLAINLY MARKED. ANY CHANGE IN LOCATION SHALL BE REQUESTED IN WRITING BY THE OWNER OR HIS REPRESENTATIVE. NO REVISIONS SHALL BE MADE IN THESE PLANS WITHOUT THE APPROVAL OF THE COUNTY ENGINEER.
  4. USE STANDARD MANHOLE FRAMES AND COVERS, S.A.-117, EXCEPT AS NOTED.
  5. USE STANDARD STRENGTH PIPE.
  6. USE CEMENT MORTAR, "NEED-LOCK" OR "SAND-SAL" FOR ALL WETTED JOINTS AND JOINTS ARE SPEC. 314-36 & 44.
  7. RESURFACE ALL TRENCH WITHIN PAVED AREA TO MEET L. A. COUNTY ROAD DEPT. OR CALIF. STATE HIGHWAY DEPT. REQUIREMENTS IN ACCORDANCE WITH PERMITS.
  8. INCREASE POLE FEET OF SEWERS AT POINTS OF INTERFERENCE WITH POLES, S.A.-172 - CASE II.
  9. MANHOLE SADDLES TO BE CONSTRUCTED WITH INVERTS AT PROPERTY LINE - SEE BELOW - SEE GRADE SHEET AS NOTED.
  10. ALL STRUCTURES SHALL BE BRICK SEWER STRUCTURES, S.A.-104, EXCEPT AS NOTED.
  11. FOR ALLOWABLE LEAKAGE TEST USE FORMULA NO. 1 SPEC. 314, SEC. III.
  12. MANHOLE TOPS IN UNIMPROVED RIGHTS-OF-WAY TO BE LEVEL WITH FINISH GRADE.
  13. THE CONTRACTOR SHALL VERIFY THE CONSTRUCTION AND STATION MARKS OBTAINED BY TELEPHONE MAPS AND BY FIELD SURVEY, AT LEAST 24 HOURS BEFORE STARTING ANY WORK UNDER THIS CONTRACT.
  14. STANDARD SPECIFICATIONS DATED JAN. 1, 1958 APPLY IN THE CONSTRUCTION OF THIS PROJECT.

**NOTE**  
KEMMEER ENGINEERING CO., INC. ASSUMES NO RESPONSIBILITY FOR THE LOCATION OF EXISTING UTILITY LINES. A PROPERTY OWNER HAS BEEN ADVISED BY THE COUNTY ENGINEER TO HAVE THIS DRAWING MADE WITH UTILITY COMPANIES AT HIS OWNERS RISK AND LIABILITY TO THE COUNTY OF LOS ANGELES. THE COUNTY ENGINEER SHALL VERIFY LOCATION AND DEPTH OF ALL UTILITY LINES.

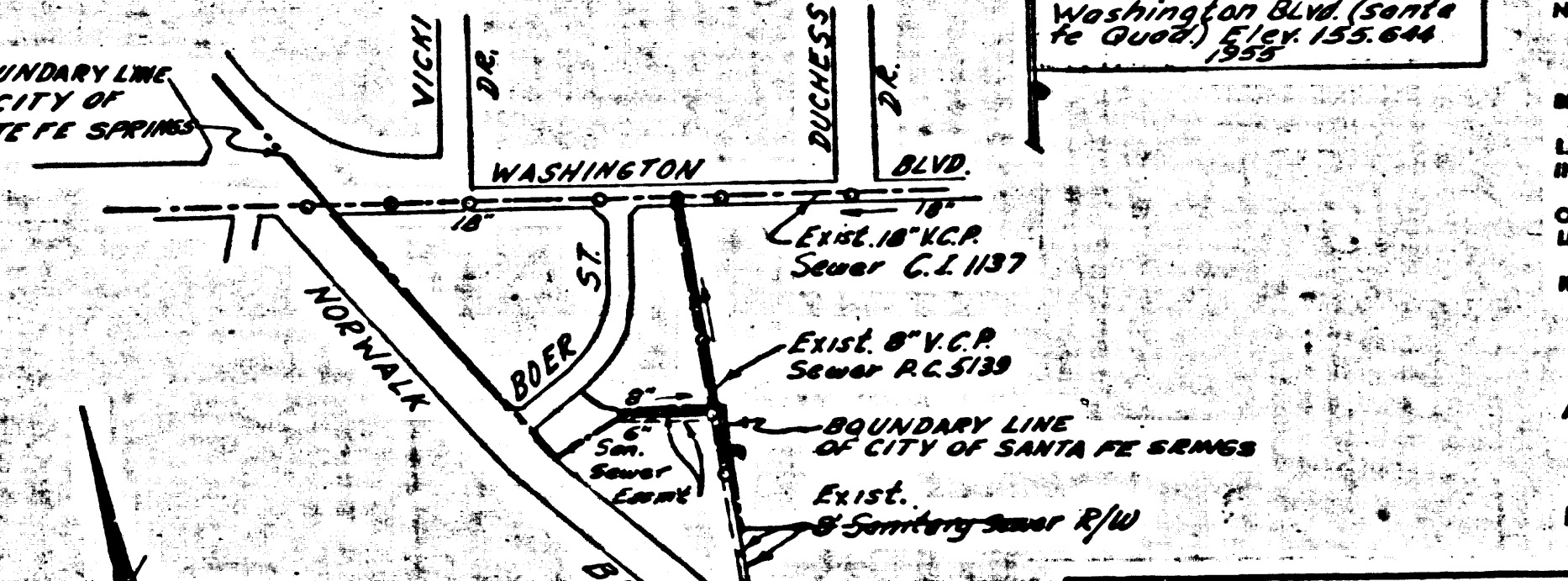

**NO CHARGE FOR CONNECTIONS**  
Estimated 1.5-60

PROFILE ALIGNMENT AND GRADE OF  
**SANITARY SEWERS**  
TO BE CONSTRUCTED IN

**R/W 50 WASHINGTON BLVD**

**PRIVATE CONTRACT NO. 5304**

W.S. 57  
SHEET 1 PAGE 1

SCALE: VERT. 1" = 4'  
HORIZ. 1" = 40'

DATE: OCT. 1959  
PREPARED IN THE OFFICES OF  
**KEMMEER ENGINEERING CO., INC.**

*Robert R. Flores*  
REG. C. E. NO. 11869

FOR LEGEND SEE PLAN NO. S-A-64

**COUNTY OF LOS ANGELES, CALIFORNIA**

APPROVED, JOHN A. LAMBE, COUNTY ENGINEER  
APPROVED, C. C. CAMPBELL, CHIEF ENGINEER

CHECKED BY *W. W. ...*  
OFFICE OF COUNTY ENGINEER, REG. C. E. NO. 3496

SUBMITTED BY *John L. Estor* 1-5-60  
REGISTERED PROFESSIONAL ENGINEER REG. C. E. NO. 3871

PC 5304

PC 5304  
R/W 50 WASHINGTON BLVD

28,698