

B.M. 57.3636, 1/2" E. Curb of Orizaba Avenue 1/2" South of curb return S.E. Cor. of Orizaba Ave & South St. Elev. 52763. Bellflower Quad 1955 A-1; Subtract .39 From all elevations to agree with this bench.

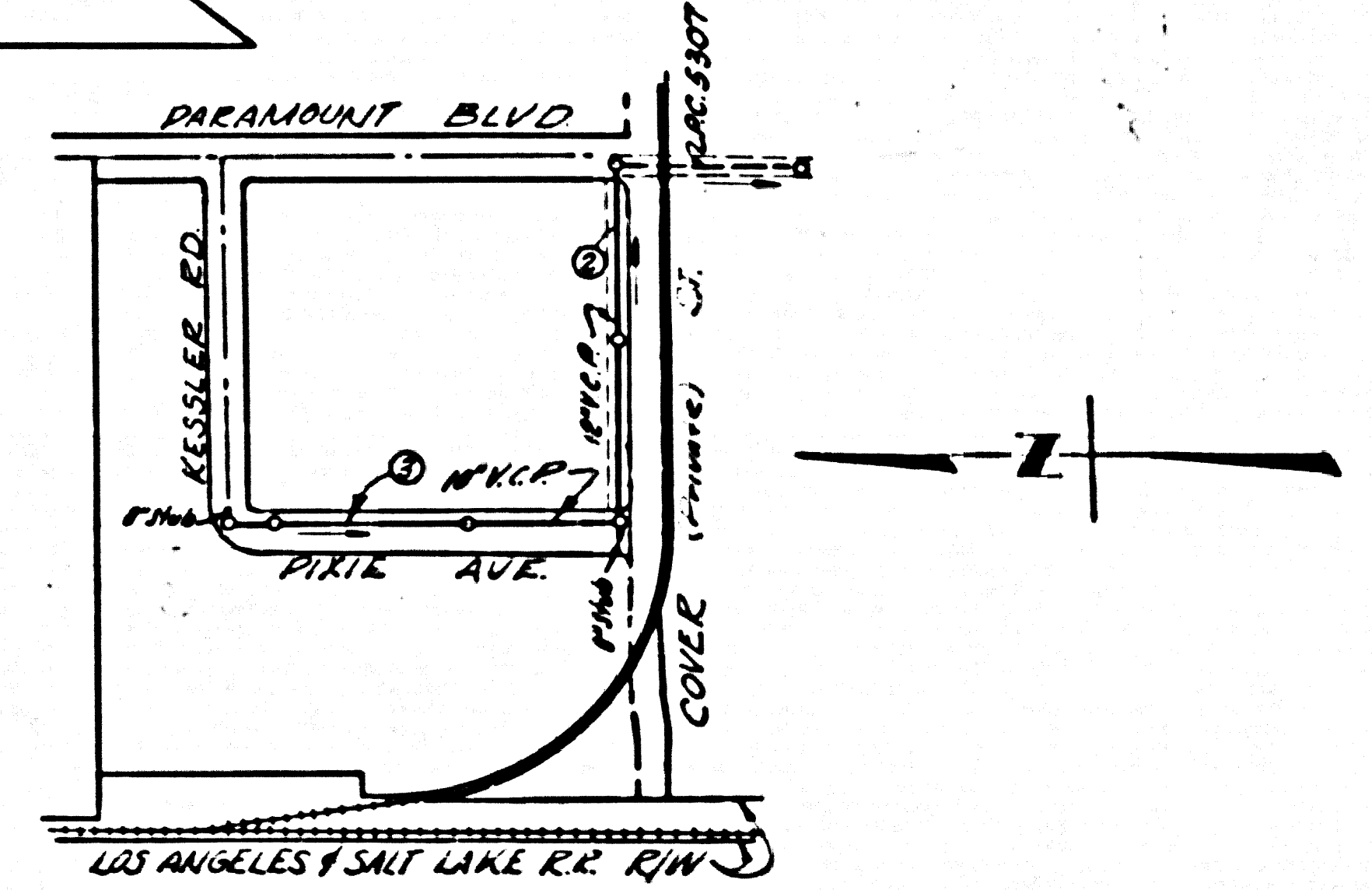

INDEX MAP
TRACT NO 24164
SCALE 1" = 400'
P.C. 5328

NO CHARGE
FOR CONNECTIONS

Revised Alignment in Cover St. 11-10-59
Approved: *R. Duda* 11-23-59
Office of County Engineer

DO NOT ISSUE PERMITS
UNTIL OUTLET IS CONSTRUCTED

LAKWOOD BLDG. DIST. NO. 401

- NOTES:
1. PROVIDE STAKES ON THE PROPERTY LINE OR PROPERTY LINES PRODUCED AT RIGHT ANGLES TO THE SEWER LINE AT THE CENTER LINE OF EACH MANHOLE.
 2. NO REPRESENTATIVE OF THE CITY ENGINEER WILL SURVEY OR LAY OUT ANY PORTION OF THE WORK.
 3. THE OWNER OR HIS AUTHORIZED REPRESENTATIVE SHALL FURNISH THE CITY ENGINEER WITH GRADE SHEETS AND STATIONING FOR ALL HOUSE LATERALS AND Y BRANCHES AND SHALL PROVIDE STAKES FOR THESE AT THEIR PROPER LOCATIONS WITH STATIONING PLAINLY MARKED. ANY CHANGE IN LOCATION SHALL BE REQUESTED IN WRITING BY THE OWNER OR HIS REPRESENTATIVE.
 4. THE PRIVATE ENGINEER SHALL FURNISH THE HOUSE LATERAL DEPTH AT THE PROPERTY LINE BELOW THE TOP OF CURB ELEVATION FOR EACH HOUSE LATERAL ON THE GRADE SHEET.
 5. NO REVISIONS SHALL BE MADE IN THESE PLANS WITHOUT THE APPROVAL OF THE CITY ENGINEER.
 6. USE STANDARD MANHOLE FRAMES AND COVERS, S-117.
 7. USE STANDARD STRENGTH PIPE EXCEPT AS NOTED.
 8. USE CEMENT MORTAR OR "WEDGE-LOCK" OR "SPED-BEAL" FOR ALL V.C.P. JOINTS PER SPCC, BKCS. 36 & 4.
 9. RESURFACE ALL TRENCH WITHIN PAVED AREA TO MEET L.A. COUNTY ROAD DEPT. OR CALIF. STATE HIGHWAY REQUIREMENTS IN ACCORDANCE WITH PERMITS.
 10. INDICATE FOUR FEET OF SEWER AT POINTS OF INTERFERENCE WITH POLES, C&M, S-173.
 11. HOUSE LATERALS TO BE CONSTRUCTED WITH INVERTS AT PROPERTY LINE ... 8' ... FEET BELOW CURB GRADE EXCEPT AS NOTED.
 12. ALL STRUCTURES SHALL BE BRICK SEWER STRUCTURES, S-104.
 13. FOR ALLOWABLE LEAKAGE TEST USE FORMULA NO. 1, SPCC, SEC. 34.
 14. MANHOLE TOPS IN UNIMPROVED RIGHTS-OF-WAY TO BE LEVELED WITH FINISHED GRADE.
 15. THE CONTRACTOR SHALL NOTIFY THE CONSTRUCTION & STORM DRAIN DIVISION BY TELEPHONE, MADISON 6-40, EXT. 343, AT LEAST TWENTY-FOUR HOURS BEFORE STARTING ANY WORK UNDER THIS CONTRACT.

FIGURES IN CIRCLES AT ENDS OF HOUSE LATERALS INDICATE DEPTH BELOW CURB GRADE.

ENGINEERING SERVICE CORPORATION 1127 W. WASHINGTON BLVD. LOS ANGELES 15, CALIF. RI. 9-7281					
REVISIONS			TRACED BY: <i>HK</i>		
			DES'G'D BY: <i>CME</i>		
			CK'D BY: <i>AAMC</i>		
			SUBMITTED:		
SUB STRUCTURES OK'D					
W. O. NO.	DWG. NO.	DATE	SCALE	L. B.	P. B.
6835-12		Oct 1959	As Noted	L/L	

PROFILE ALIGNMENT AND GRADE OF **P.C. 5328**
SANITARY SEWERS PAGE **L**
TO BE CONSTRUCTED IN

TRACT No 24164
PRIVATE CONTRACT NO. 5328
W.S. 30
2 SHEETS, 3 PAGES

SCALE: VERT. 1" = 4' HORIZ. 1" = 40' DATE: 1959
PREPARED IN THE OFFICES OF
ENGINEERING SERVICE CORPORATION
By: *E. F. King*
REG. C. E. NO. 3422
FOR LEGEND SEE PLAN NO. S-A-64

28818

NOTE:
GRADES TO WHICH THIS IMPROVEMENT IS TO BE CONSTRUCTED ARE SHOWN ON PLANS AND RELEVANT GRADE POINTS FOR TOP OF CURBS, CENTER LINE OF STREETS, OR CENTER LINE OF ALLEYS ARE SHOWN BY CIRCLES ON PROFILES AT ALL POINTS BETWEEN DESIGNATED POINTS THE GRADE SHALL BE ESTABLISHED SO AS TO COMFORM TO A STRAIGHT LINE BETWEEN SAID DESIGNATED POINTS.
ELEVATIONS ARE IN FEET ABOVE U.S.C. & G.S. SEA LEVEL DATUM OF 1929.
THIS DRAWING AND THE DATA HEREON ARE HEREBY MADE A PART OF THE SPECIFICATIONS.
WORK SHALL BE CONSTRUCTED ACCORDING TO SPECIFICATIONS ON FILE IN THE OFFICE OF THE CITY ENGINEER AND SHALL BE PRODUCED ONLY IN THE PRESENCE OF THE CITY ENGINEER.
BEFORE WORK CAN BE STARTED, THE CONTRACTOR MUST OBTAIN A PERMIT TO EXCAVATE IN CITY STREETS FROM THE L.A. COUNTY ROAD DEPT., DISTRICT OFFICE NO. 4, AND MAKE A DEPOSIT WITH THE CITY OF LAKEWOOD, 2000 S. CLAREMONT AVE., LAKEWOOD, CALIF., SUFFICIENT TO COVER THE COST OF CONSTRUCTION INSPECTION AND RECORD PLANS.
APPROVAL OF THIS PLAN BY THE CITY OF LAKEWOOD DOES NOT CONSTITUTE A REPRESENTATION AS TO THE ACCURACY OF THE LOCATION OF OR THE EXISTENCE OR NON-EXISTENCE OF ANY UNDERGROUND UTILITY PIPE, OR STRUCTURE WITHIN THE LIMITS OF THIS PROJECT THIS NOTE APPLIES TO ALL PAGES.
IF WORK IS TO BE DONE IN A STATE HIGHWAY, A PERMIT MUST BE OBTAINED FROM THE STATE OF CALIFORNIA, DIVISION OF HIGHWAYS, 120 SOUTH SPRING STREET.

CITY OF LAKEWOOD, CALIFORNIA
APPROVED, JOHN A. LAMBE, CITY ENGINEER
APPROVED, *G. E. Gannon*, CHIEF ENGINEER
CO. SAN. DIST. NO. 3
BY: *E. F. King* ASSISTANT SANITATION ENGINEER
BY: *R. Duda* OFFICE ENGINEER
CHECKED BY: *R. Duda* 11-16-59
OFFICE OF CITY ENGINEER, REG. C. E. NO. 3422
SUBMITTED BY: *John L. Borton* 11-18-59
LOS ANGELES REGIONAL ENGINEER REG. C. E. NO. 3871

NO CHARGE FOR CONNECTIONS

28,819

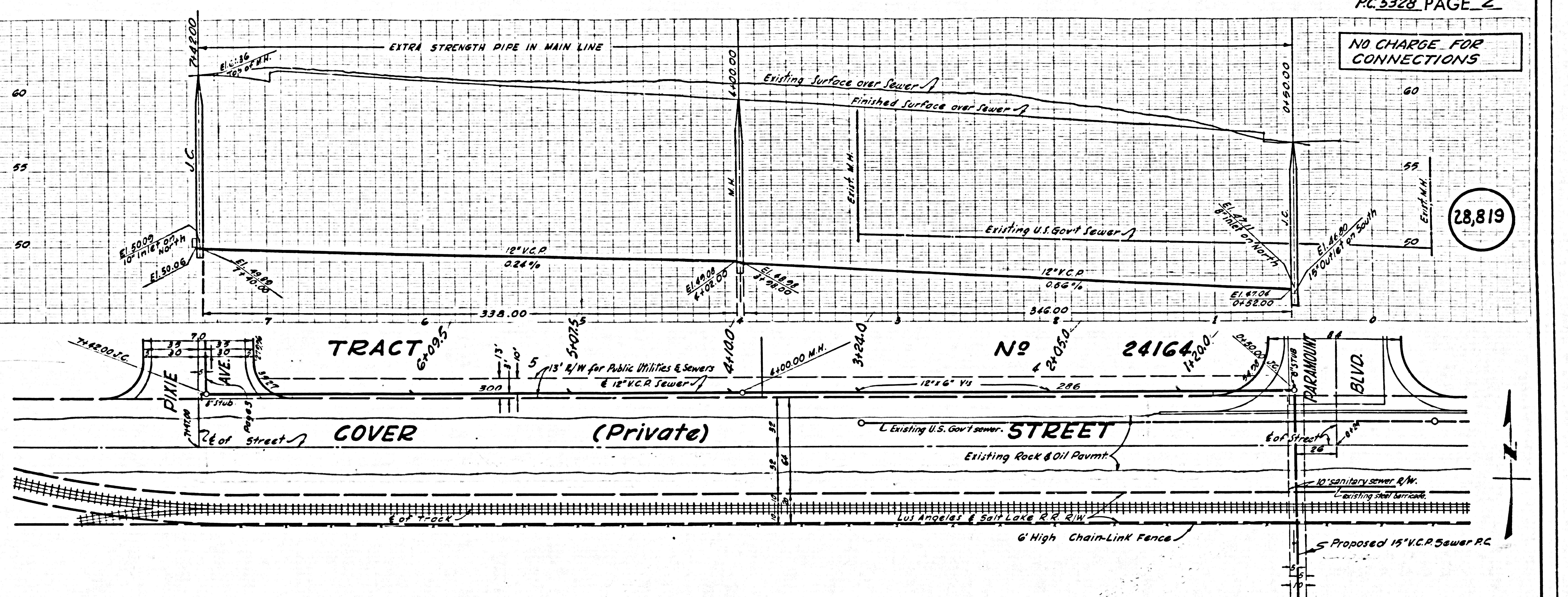

NO CHARGE FOR CONNECTIONS

28,820

