

DOUBLE SCALE WHITTIER BUILDING DISTRICT NO. 11

CASH CONTRACT NO. 40931
 PROFILE, ALIGNMENT AND GRADE OF
SANITARY SEWERS
 TO BE CONSTRUCTED BY
PAINTER AVENUE
 BETWEEN CULLEN AVE. & 1ST AVE SWLY OF WHITTIER BLVD.
PRIVATE CONTRACT NO. 5339
JOB NUMBER 0718.87
 PAGE 1 OF 2 PAGES

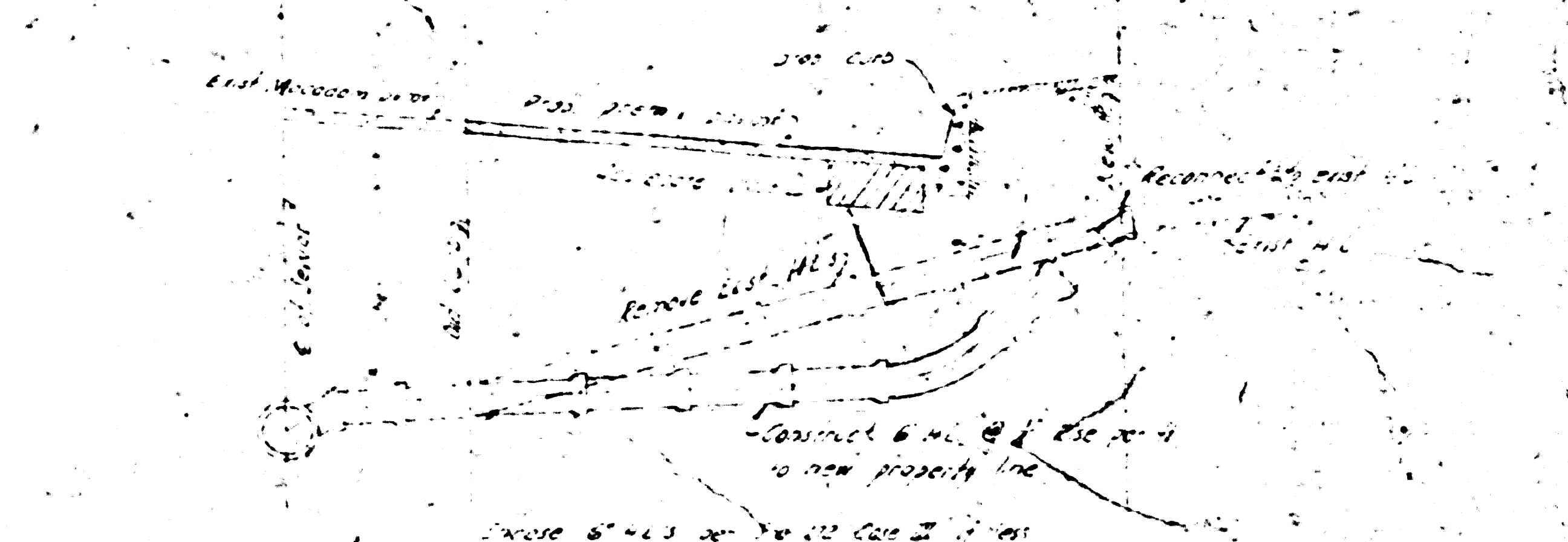

TYPICAL SECTION FOR RECONSTRUCTION OF EXISTING HOUSE LATERALS
(No Scale)

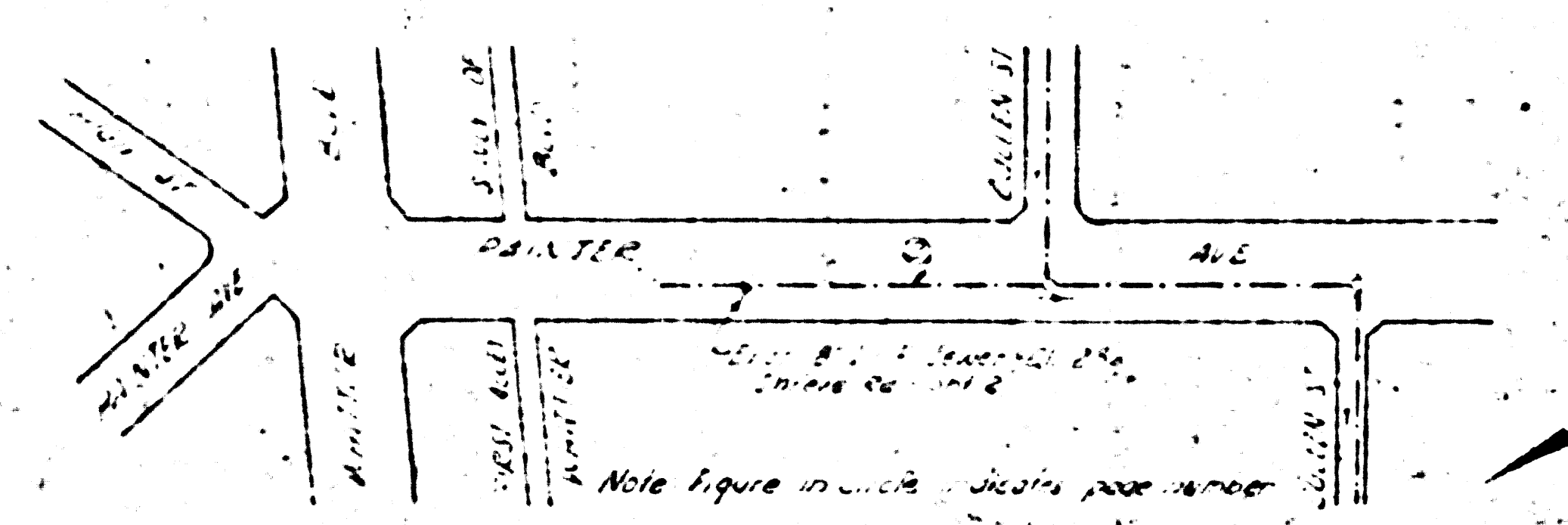

INDEX MAP
P.C. 5339 J.N. 0718.87
Scale: 1" = 200'

- USE STANDARD STRENGTH PIPE EXCEPT AS NOTED.
- USE CEMENT MORTAR FOR ALL VITRIFIED CLAY PIPE JOINTS.
- ALL STRUCTURES SHALL BE 12" HIGH EXCEPT AS NOTED.
- USE STANDARD MANHOLE FRAMES AND COVERS AS PER PLAN NO. 5-A-44 EXCEPT AS NOTED.
- RESURFACE TRENCH WITHIN PAVED AREA WITH PREMIX ROCK AND OR INCHES IN THICKNESS EXCEPT AS NOTED.
- USE FORMULA NO. 1 SEC. 54 OF SPECIFICATIONS TO COMPUTE ALLOWABLE LEAKAGE.
- THE CONTRACTOR SHALL NOTIFY THE CONSTRUCTION AND STORM DRAIN DIVISION BY TELEPHONE MADISON 9-4747, EXT. 362 AT LEAST 24 HOURS BEFORE STARTING ANY WORK UNDER THIS CONTRACT.
- CONSTRUCT HOUSE LATERALS WITH INVERTS AT PROPERTY LINE 6 FEET BELOW CURB GRADE OR GRADE OF CEA PER LINE OF STREET EXCEPT AS NOTED.
- FIGURES IN CIRCLES AT ENDS OF HOUSE LATERALS INDICATE DEPTH BELOW CURB GRADE OR GRADE OF CENTER LINE OF STREET.
- FIGURES IN CIRCLES AT ENDS OF HOUSE LATERALS INDICATE HOUSE LATERALS SHALL BE EXTENDED WITH 1/4" RISE PER FOOT TO NEW PROPERTY LINE.
- WORDS IN CIRCLES AT ENDS OF HOUSE LATERALS INDICATE THEY SHALL BE DAD HORIZONTAL AND HOUSE LATERALS SHALL BE CONSTRUCTED WITH 1/4" RISE PER FOOT TO PROPERTY LINE.
- CONSTRUCTION IN STATE HIGHWAYS SHALL CONFORM WITH STATE HIGHWAY PERMIT.
- MANHOLE TOPS TO BE ADJUSTED TO FINISHED GRADE.

SCALE: VERT. 1" = 8' FT
HORIZ. 1" = 40' FT
NOVEMBER 1958
 COUNTY OF LOS ANGELES, CALIFORNIA
 JOHN A. LAMBIE COUNTY ENGINEER
 SUBMITTED: [Signature] APPROVED: [Signature]
 DESIGN ENGINEER ASSISTANT COUNTY ENGINEER

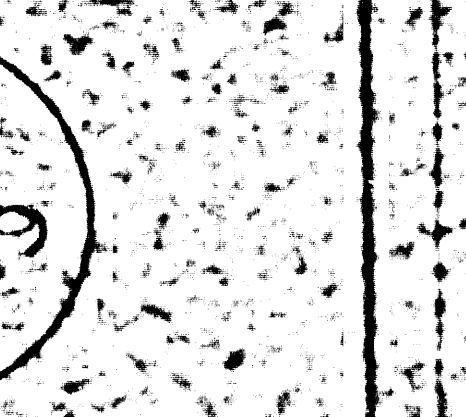

FOR LEGEND
SEE PLAN NO. 5-A-44
 NOTE: GRADES TO WHICH THIS IMPROVEMENT IS TO BE CONSTRUCTED ARE SHOWN ON PLANS AND PROFILE. GRADE POINTS FOR TOP OF CURB, CENTER LINE OF STREET OR CENTER LINE OF ALLEY ARE SHOWN BY CIRCLES ON PROFILE. AT ALL POINTS BETWEEN DESIGNATED POINTS THE GRADE SHALL BE ESTABLISHED BY A 1% GRADE TO A STRAIGHT LINE BETWEEN SAID DESIGNATED POINTS.
 ELEVATIONS ARE IN FEET ABOVE U.S.C. & G.S. 89 SEA LEVEL UNLESS OTHERWISE NOTED.
 UNIT PRICES FOR ADDITIONAL WORK WHICH MAY BE REQUIRED, BUT WHICH CANNOT BE ASSUMED IN ADVANCE, SHALL BE SUBMITTED IN THE PROPOSAL.
 THIS DRAWING AND THE DATA HEREON ARE HEREBY MADE A PART OF THE SPECIFICATIONS.

REFERENCES		
W.S. 33	DESIGNED	7 JANU 1958
A.B. 355	TRACED	17 FEBRU 1958
P.B. 1318, 1592, 1598	CHECKED	17 FEBRU 1958

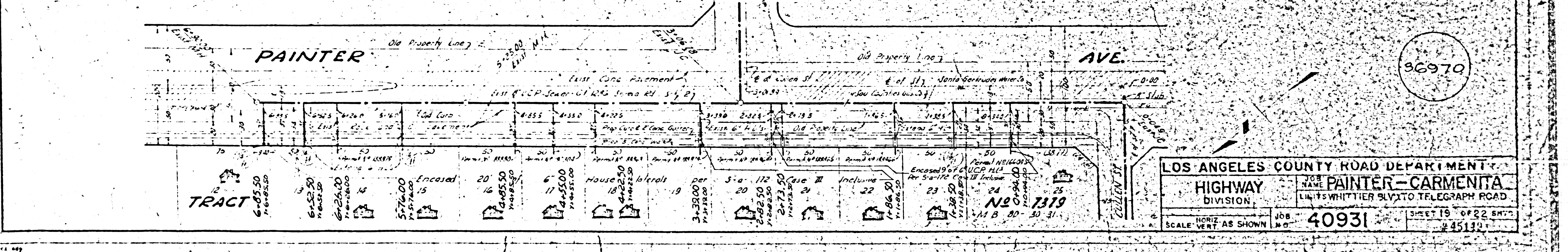
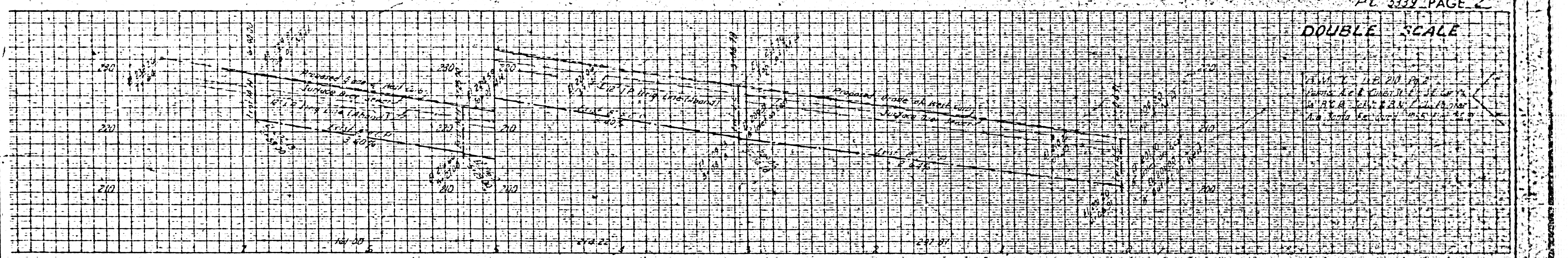

LOS ANGELES COUNTY ROAD DEPARTMENT
 HIGHWAY DIVISION
 JOB NAME: PAINTER-CARMENTA
 DIVISION: LIGHTS WHITTIER BLVD. TO TELEGRAPH ROAD
 SCALE: VERT. AS SHOWN HORIZ. 1" = 40' JOB NO. 40931 SHEET 19 OF 22 SHEETS
 DATE: 11-19-58

