

LOMITA BLDG. DIST. NO. 71

PROFILE ALIGNMENT AND GRADE OF P.C. 5355
 SANITARY SEWERS PAGE 1
 TO BE CONSTRUCTED IN J.N. 0352.25

VERMONT AVE. R/W.
 PRIVATE CONTRACT NO. 5355

W.S. 28
 1 SHEET, 2 PAGES

SCALE: VERT. 1"=4' HORIZ. 1"=40' DEC., 1959

PREPARED IN THE OFFICES OF

BARCLAY-PEARSON CO. INC.

BY: Edward J. Pearson
 REG. C. E. NO. 9783

FOR LEGEND SEE PLAN NO. S-A-64

29245

NO CHARGE FOR CONNECTIONS
 Arthur B. Reedy

- NOTES
- PROVIDE STAKES ON THE PROPERTY LINE OR PROPERTY LINES PRODUCED AT RIGHT ANGLES TO THE SEWER LINE AT THE CENTER LINE OF EACH MANHOLE.
 - NO REPRESENTATIVE OF THE COUNTY ENGINEER WILL SURVEY OR LAYOUT ANY PORTION OF THE WORK.
 - THE OWNER OR HIS AUTHORIZED REPRESENTATIVE SHALL FURNISH THE COUNTY ENGINEER WITH GRADE SHEETS AND STATIONING FOR ALL HOUSE LATERALS AND V BRANCHES AND SHALL PROVIDE STAKES FOR THEM AT THEIR PROPER LOCATIONS WITH STATIONING PLAINLY MARKED. ANY CHANGE IN LOCATION SHALL BE REQUESTED IN WRITING BY THE OWNER OR HIS REPRESENTATIVE.
 - NO REVISIONS SHALL BE MADE IN THESE PLANS WITHOUT THE APPROVAL OF THE COUNTY ENGINEER.
 - USE STANDARD MANHOLE FRAMES AND COVERS, S-A-117, EXCEPT AS NOTED.
 - USE STANDARD STRENGTH PIPE EXCEPT AS NOTED.
 - USE CEMENT MORTAR "OR" USE "WADGE LOCK" OR "SPREAD BRAC" FOR ALL V.C.P. JOINTS PER SPEC. SECS 564 & 48.
 - RESURFACE ALL TRENCH WITHIN PAVED AREA TO MEET L. A. COUNTY ROAD DEPT., OR CALIF. STATE HIGHWAY DEPT. REQUIREMENTS IN ACCORDANCE WITH PERMITS.
 - ENCASE FOUR FEET OF SEWER AT POINTS OF INTERFERENCE WITH POLES, SEE 172 CASE III.
 - ALL STRUCTURES SHALL BE BRICK SEWER STRUCTURES, S-A-104, EXCEPT AS NOTED.
 - FOR ALLOWABLE LEAKAGE TEST USE FORMULA NO. 1, VEC'S, SEC. 3.
 - MANHOLE TOPS IN UNIMPROVED RIGHTS-OF-WAY TO BE 6" ABOVE FINISHED GRADE.
 - The private engineer shall furnish the house lateral depth at the property line below the top of curb elevation for each house lateral on the gross sheet.
 - The contractor shall notify the construction of storm drain division by telephone, Madison 9-4471, at least twenty-four hours before starting any work under this contract.
 - All the locations shown for existing substructures have been taken from records and their correctness and completeness is in no way guaranteed. It shall be the contractor's responsibility to actively locate all underground lines of every nature, whether shown hereon or not and protect them from damage. The contractor shall bear the full expense of repair to any line damaged by any operation in connection with the prosecution of the work.
 - The private engineer is to furnish the house lateral depth at the property line below the top of curb elevation for each house lateral on the gross sheet.
 - Standard Specifications dated Jan 1, 1950 apply in the construction of this project.

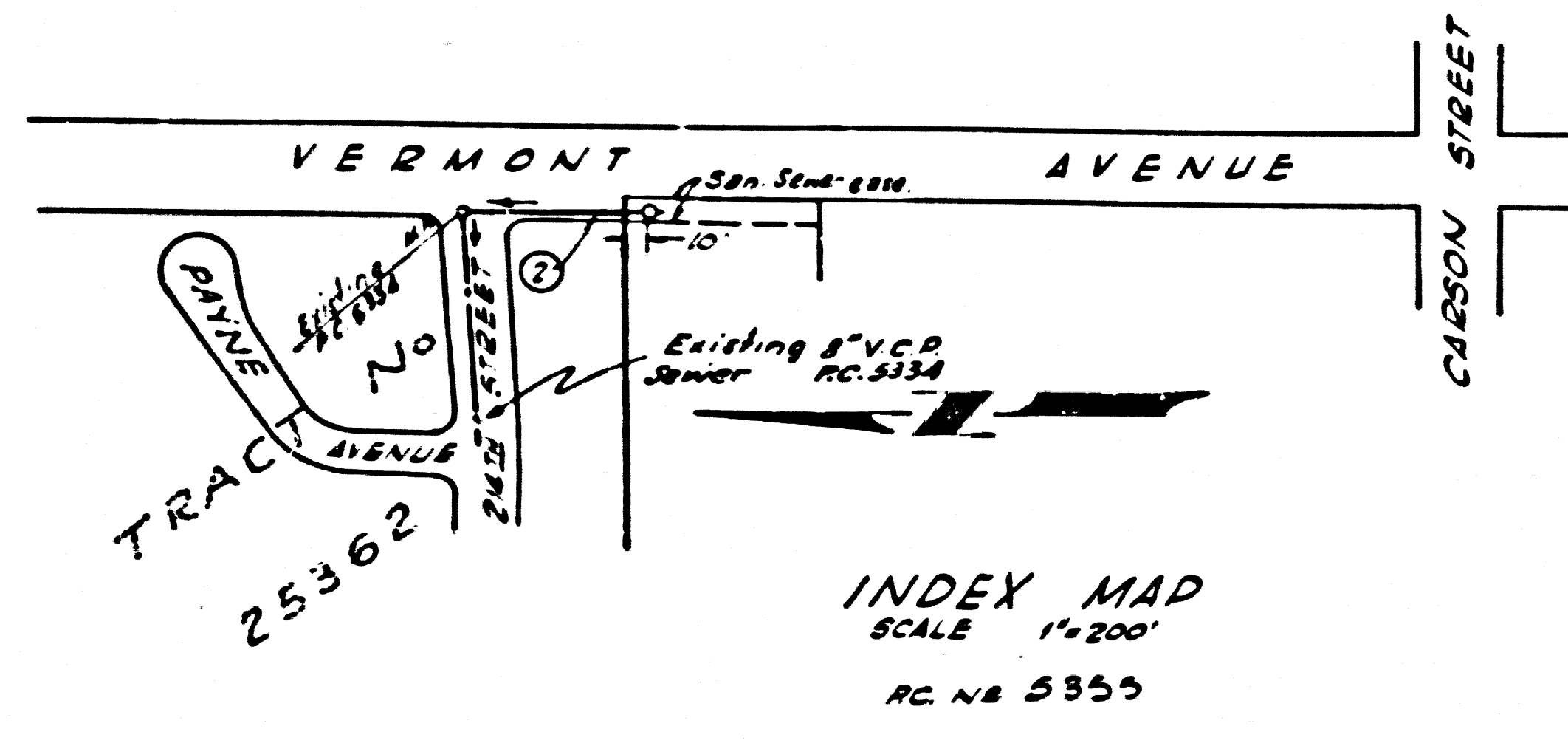

BENCH MARK
 SY 3046 Elev. 41.559
 L & T. west curb Normandie Avenue opposite power pole NE 279522E. (4th power pole N. Carson St.) Gardena Quad 1955 Adj.

NOTE: GRADES TO WHICH THIS IMPROVEMENT IS TO BE CONSTRUCTED ARE SHOWN ON PLANS AND PROFILE. GRADE POINTS FOR TOP OF CURBS, CENTER LINE OF STREETS, OR CENTER LINE OF ALLEYS ARE SHOWN BY CIRCLES ON PROFILES. AT ALL POINTS BETWEEN DESIGNATED POINTS THE GRADE SHALL BE ESTABLISHED SO AS TO CONFORM TO A STRAIGHT LINE DRAWN BETWEEN SAID DESIGNATED POINTS.

ELEVATIONS ARE IN FEET ABOVE U.S.C. DATUM OR MEAN SEA LEVEL.

THIS DRAWING AND THE DATA HEREON BE HEREBY MADE A PART OF THE SPECIFICATIONS.

WORK SHALL BE CONSTRUCTED ACCORDING TO SPECIFICATIONS ON FILE IN THE OFFICE OF THE COUNTY ENGINEER AND SHALL BE PROSECUTED ONLY IN THE PRESENCE OF THE COUNTY ENGINEER.

BEFORE WORK CAN BE STARTED, THE CONTRACTOR MUST OBTAIN A PERMIT TO EXCAVATE IN COUNTY STREETS FROM THE L. A. COUNTY ROAD DEPT., DIST. OFF. 9, AND PART 4 PER. TO THE COUNTY ENGINEER, ROOM 224 PALM AVENUE, BLDG. 228 SO. BROADWAY SUFFICIENT TO COVER THE COST OF CONSTRUCTION INSPECTION AND RECORD PLANS.

APPROVAL OF THIS PLAN BY THE COUNTY OF LOS ANGELES DOES NOT CONSTITUTE A REPRESENTATION AS TO THE ACCURACY OF THE LOCATION OF OR THE EXISTENCE OR NON-EXISTENCE OF ANY UNDERGROUND UTILITY PIPE, OR STRUCTURE WITHIN THE LIMITS OF THIS PROJECT. THIS NOTE APPLIES TO ALL PAGES.

IF WORK IS TO BE DONE IN A STATE HIGHWAY, A PERMIT MUST BE OBTAINED FROM THE STATE OF CALIFORNIA, DIVISION OF HIGHWAYS, 120 SOUTH SPRING STREET.

COUNTY OF LOS ANGELES, CALIFORNIA

APPROVED, JOHN A. LAMBIE, COUNTY ENGINEER

APPROVED, C. E. COMPTON, CHIEF ENGINEER
 CO. SAN. DIST. NO. 8

BY: C. E. Pearson, ASST. SANITATION ENGINEER

BY: J. Posthumus, OFFICE ENGINEER

CHECKED BY: J. K. Underhill, OFFICE OF COUNTY ENGINEER, REG. C. E. NO. 9406

SUBMITTED BY: Jack C. Lansing, Chief Verdes-Centinel Valley Regional Engineer

P.C. 5355 PAGE 2

NO CHARGE FOR CONNECTIONS

29246

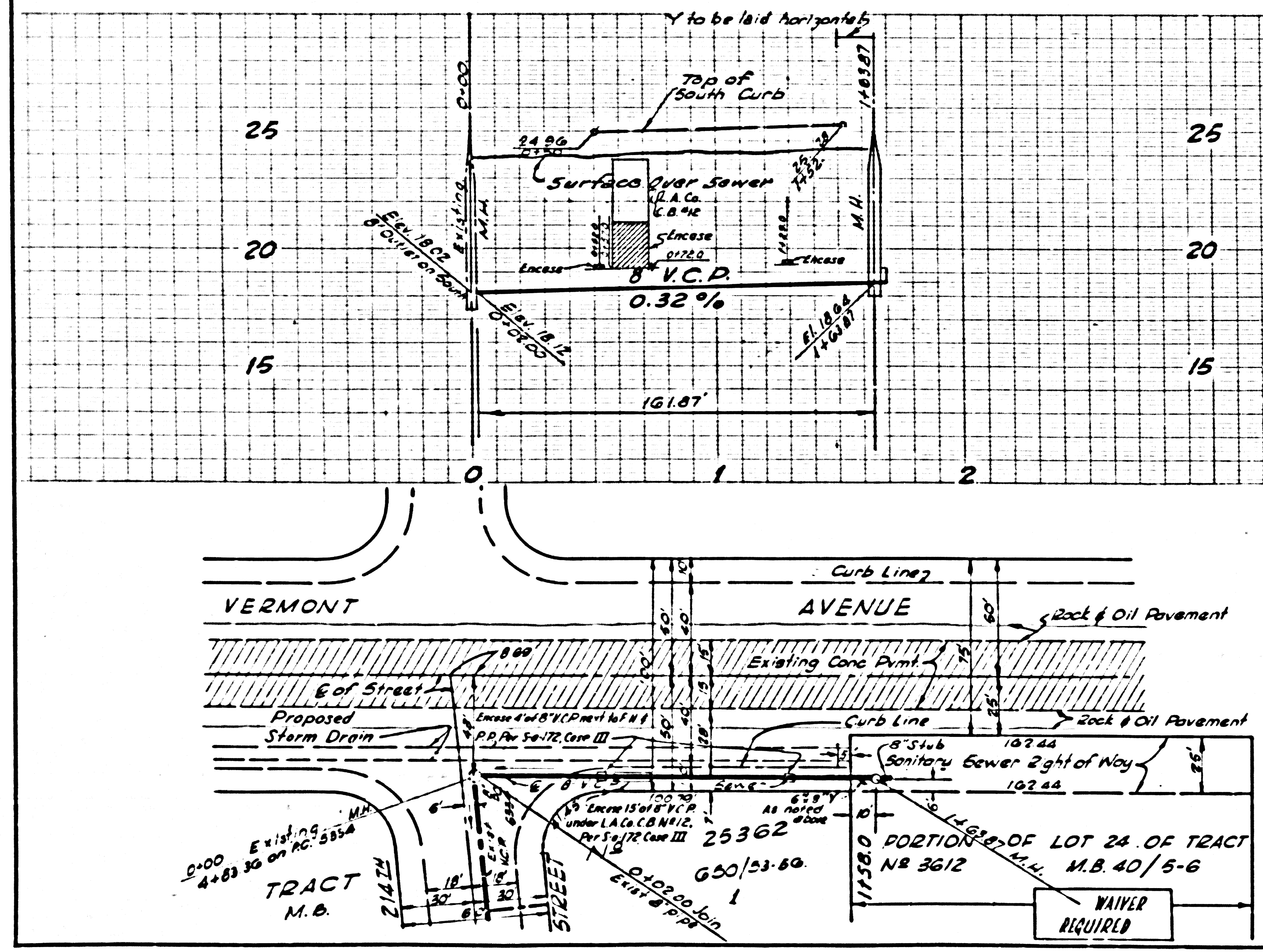

Note: Main line sewer cannot be extended until easement is clear.