

BM 5-5 Elev. 285.25 C.S.F.B. 1641-20, F.B. 2256-14
 Brass Cap Set Flush 170 ft. North of E of Third St.,
 180 ft. West of E of Ferris Ave. (now vacated),
 Southwest corner of park.

EAST L.A. BUILDING DISTRICT NO. 6

CAPITAL PROJECT NO. 7173.02
 PROFILE, ALIGNMENT AND GRADE OF
SANITARY SEWERS
 TO BE CONSTRUCTED TO SERVE
EAST L.A. BUILDING & SAFETY DIVISION BUILDING
 PC. NO. 5362
 PAGE 1 OF 2 PAGES

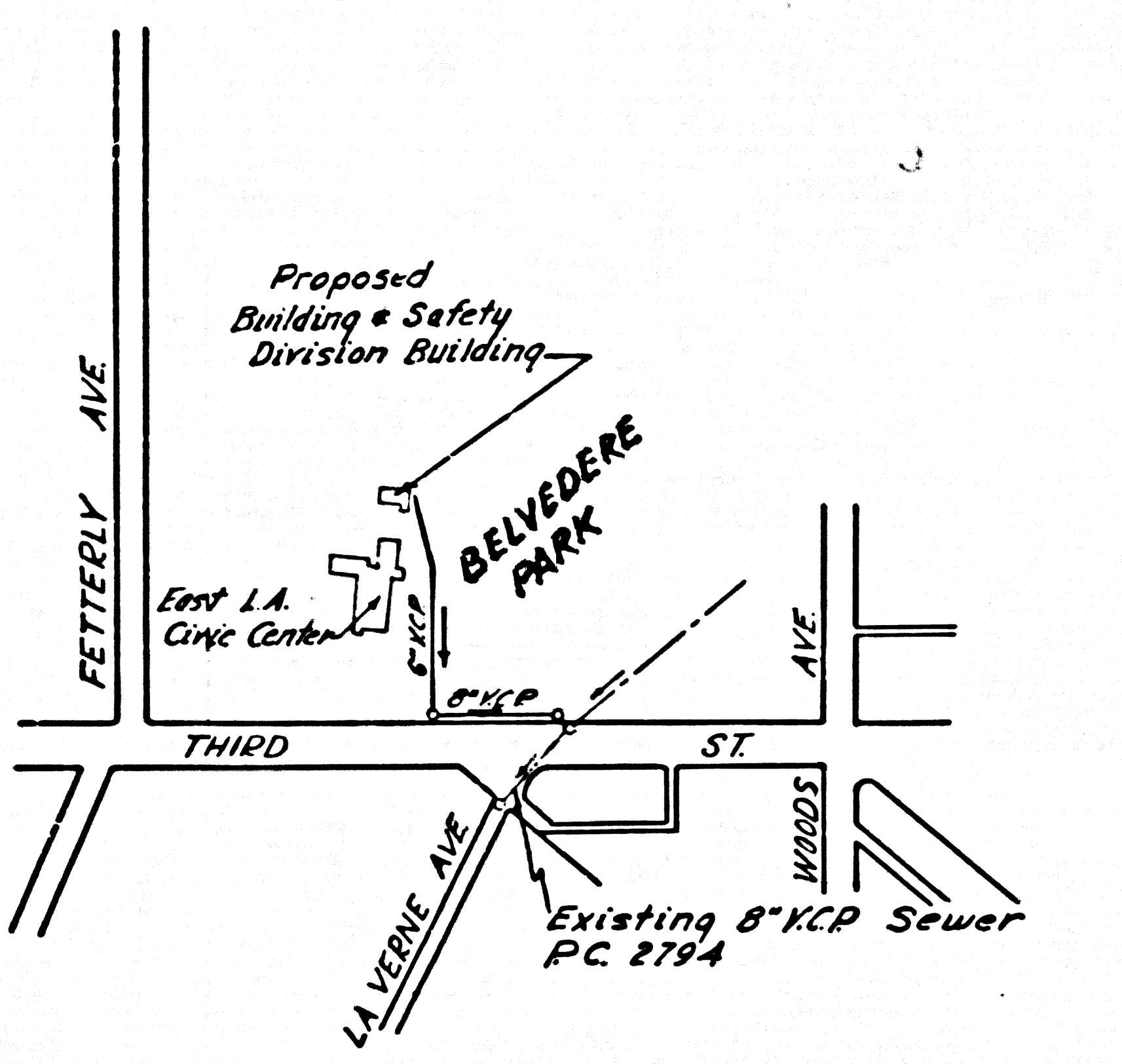

Scale: 1" = 400'
 Capital Project No. 7173.02
 PC. No. 5362

NO CHARGE FOR CONNECTIONS

USE STANDARD STRENGTH PIPE EXCEPT AS NOTED
 USE PLASTISOL FOR ALL VITRIFIED CLAY PIPE JOINTS.
 ALL STRUCTURES SHALL BE BRICK SEWER STRUCTURES AS PER PLAN NO. S-A-104, EXCEPT AS NOTED.
 USE STANDARD MANHOLE FRAMES AND COVERS AS PER PLAN NO. S-A-117, EXCEPT AS NOTED.
 REQUIRE TRENCH WIDTH PAVED AREA WITH FRESH ROCK AND CURBS IN THICKNESS EXCEPT AS NOTED.
 USE FORMULA NO. 1 SEC. 54 OF SPECIFICATIONS TO COMPUTE ALLOWABLE LEAKAGE.
DESIGN
 THE CONTRACTOR SHALL NOTIFY THE CONSTRUCTION AND STORM DRAIN DIVISION BY TELEPHONE MADISON 9-4747, EXT. 362 AT LEAST 24 HOURS BEFORE STARTING ANY WORK UNDER THIS CONTRACT.

- FIGURES IN CIRCLES AT ENDS OF HOUSE LATERALS INDICATE DEPTH BELOW CURB GRADE, OR GRADE OF CENTER LINE OF STREET.
- FIGURES IN CIRCLES AT ENDS OF HOUSE LATERALS INDICATE HOUSE LATERALS SHALL BE CONSTRUCTED WITH $\frac{1}{2}$ " RISE PER FOOT TO PROPERTY LINE.
- WORDS IN CIRCLES AT ENDS OF HOUSE LATERALS INDICATE $\frac{1}{2}$ " SHALL BE Laid HORIZONTAL AND HOUSE LATERALS SHALL BE CONSTRUCTED WITH $\frac{1}{2}$ " RISE PER FOOT TO PROPERTY LINE.

CONSTRUCTION IN STATE HIGHWAYS SHALL CONFORM WITH STATE HIGHWAY PERMIT.
 Approval of this plan by the County of Los Angeles does not constitute a representation as to the accuracy of the location of an existence or non-existence of any underground utility pipe or structure within the limits of this project.

SCALE: HORIZ. 1" = 40 FT.
 VERT. 1" = 4 FT.
 JANUARY 1960
 COUNTY OF LOS ANGELES, CALIFORNIA
 JOHN A. LAMBIE COUNTY ENGINEER
 SUBMITTED BY: *[Signature]* ASSISTANT SANITARIAN - ENGINEER
 APPROVED BY: *[Signature]* SANITARIAN
 C. R. COMPTON CHIEF ENGINEER OF COUNTY SANITATION DISTRICT NO. 2
 BY: *[Signature]* OFFICE ENGINEER

FOR LEGEND SEE PLAN NO. S-A-64

NOTE: GRADES TO WHICH THIS IMPROVEMENT IS TO BE CONSTRUCTED ARE SHOWN ON PLANS AND PROFILES. GRADE POINTS FOR TOP OF CURB, CENTER LINE OF STREET OR CENTER LINE OF ALLEY ARE SHOWN BY CHECKS ON PROFILES AT ALL POINTS BETWEEN DESIGNATED POINTS. THE GRADE SHALL BE ESTABLISHED SO AS TO CONFORM TO A STRAIGHT LINE DRAWN BETWEEN SAID DESIGNATED POINTS.
 ELEVATIONS ARE IN FEET ABOVE U.S.C. & G.S. 1929 DATUM AS OF 1959.
 UNIT PRICES FOR ADDITIONAL WORK WHICH MAY BE REQUIRED BUT WHICH CANNOT BE ASCERTAINED IN ADVANCE, SHALL BE SUBMITTED IN THE PROPOSAL.
 THIS DRAWING AND THE DATA HEREON ARE HEREBY MADE A PART OF THE SPECIFICATIONS.

REFERENCES	DESIGNED	W. Y. TEN	JAN. 1960
W. S. 36 A-2	TRACED	W. Y. TEN	JAN. 1960
A. B. 5251-1,2,3	CHECKED	R. SCHAFER	FEB. 1960
F. B.			

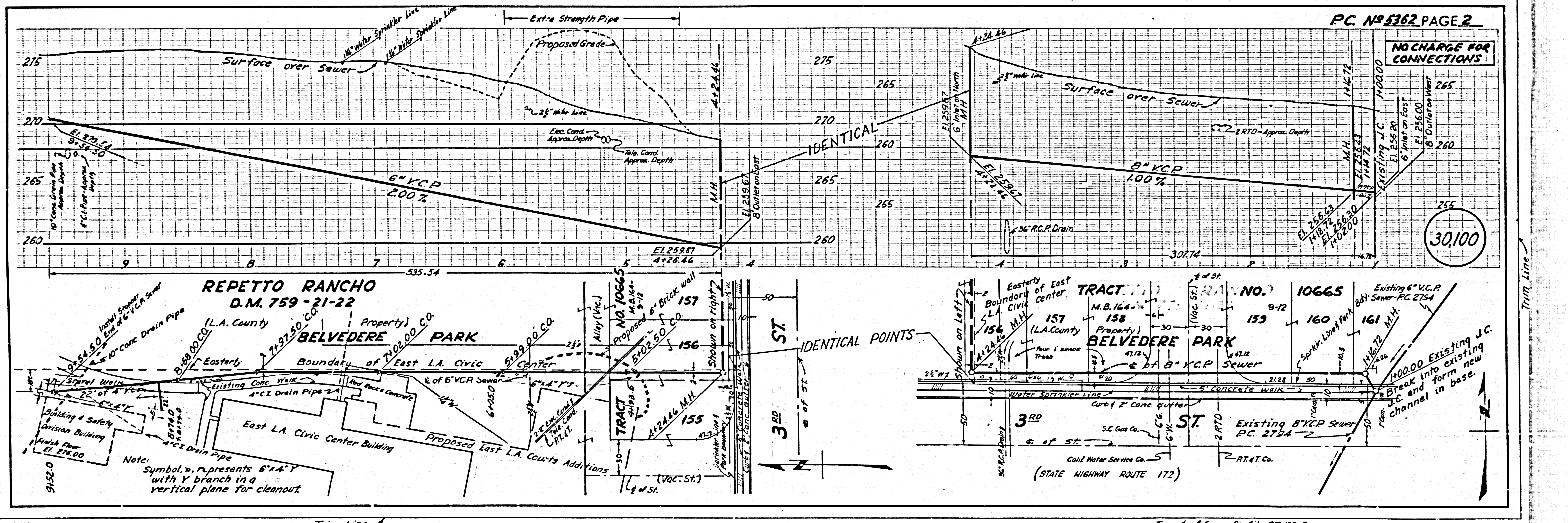

PC NO 5362 EAST LOS ANGELES BUILDING & SAFETY DIVISION BUILDING

Trim Line

Trim Line

PC. NO. 5362 PAGE 2

NO CHARGE FOR CONNECTIONS