

LENNOX BUILDING DISTRICT NO. 7

CASH CONTRACT NO. 30917

PROFILE, ALIGNMENT AND GRADE OF
SANITARY SEWERS

TO BE CONSTRUCTED IN
COMPTON BOULEVARD
FROM HAWTHORNE BLVD. TO 243 FT. EAST OF INGLEDWOOD AVE.
P. C. 5395
J. N. 0778.91
PAGE 1 OF 4 PAGES

SCALE: VERT. 1" = 4' HORIZ. 1" = 40' FEBRUARY 1960

COUNTY OF LOS ANGELES, CALIFORNIA

JOHN A. LAMMIE COUNTY ENGINEER
DESIGNED BY: [Signature] DESIGN ENGINEER
APPROVED BY: [Signature] ASSISTANT SANITARIAN ENGINEER

Where encasement is specified for the existing house lateral on plan but field inspection during construction reveals that there is actually less than two feet of clearance between the proposed aggregate base of the street and the top of the existing house lateral, such house lateral shall be reconstructed in accordance with the Typical Section for Reconstruction of Existing House Laterals specified and the contractor shall be paid in accordance with the stipulated unit price for the 6 inch standard strength vitrified clay pipe house lateral sewer in the proposal.

B.M. 9 L.B. 231 P. 170 L&I in S. end of 1st conc. slip to hse. # 15103 Hawthorne Blvd. @ S.W. cor. Hawthorne Blvd. and Compton Blvd. Elev. 56.90

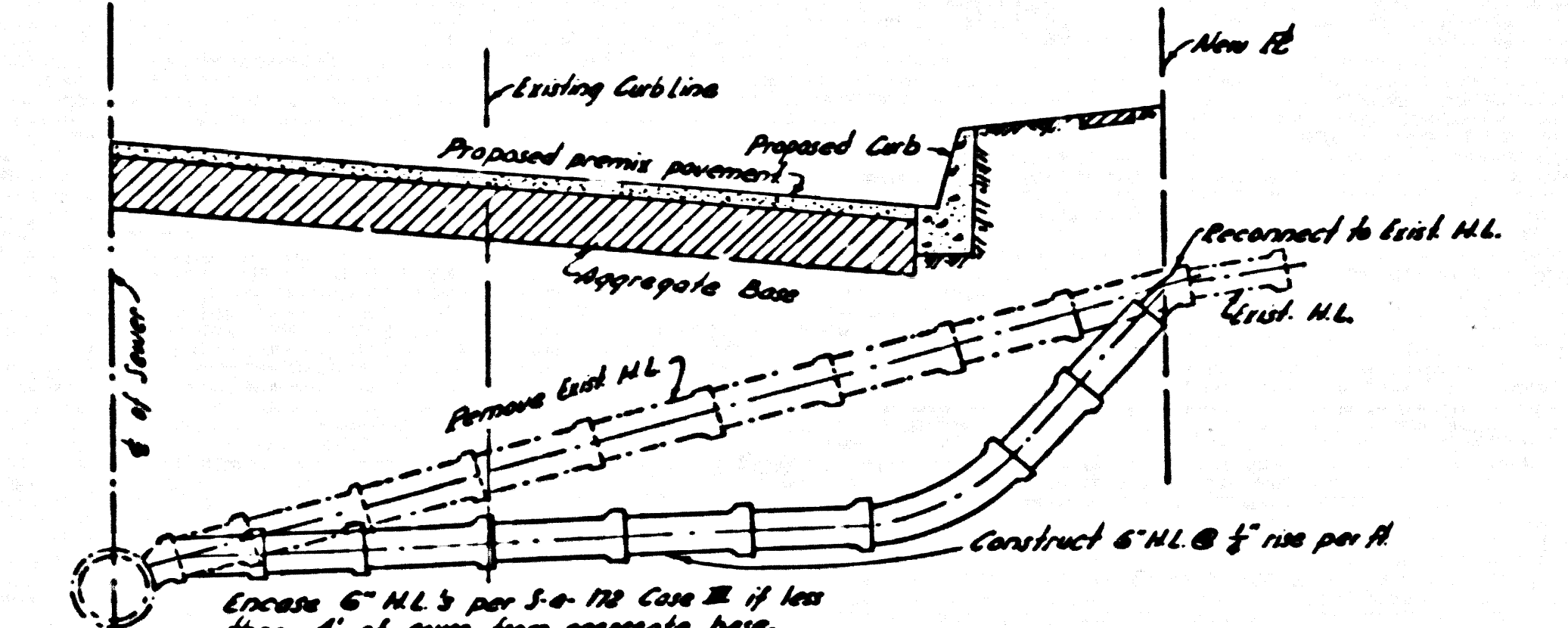

TYPICAL SECTION FOR RECONSTRUCTION OF EXISTING HOUSE LATERALS (NO SCALE)

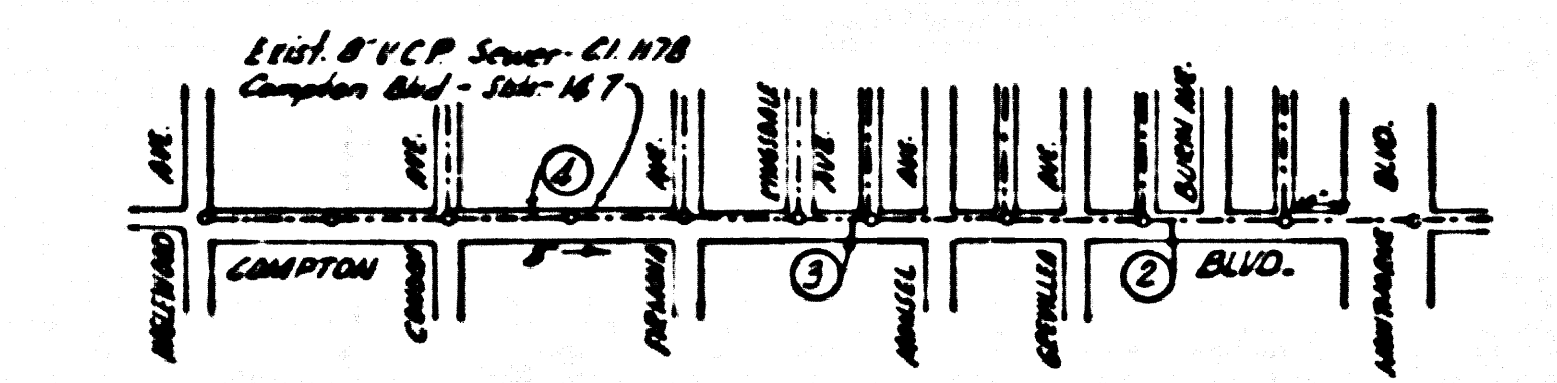

Note: Figure in circles indicates page numbers.
INDEX MAP
P. C. 5395 J. N. 0778.91
Scale: 1" = 600'

- USE STANDARD STRENGTH PIPE EXCEPT AS NOTED.
USE CEMENT MORTAR FOR ALL VITRIFIED CLAY PIPE JOINTS.
ALL STRUCTURES SHALL BE BRICK-SEWER STRUCTURES AS PER PLAN NO. S-A-104, EXCEPT AS NOTED.
USE STANDARD MANHOLE FRAMES AND COVERS AS PER PLAN NO. S-A-117, EXCEPT AS NOTED.
RESURFACE TRENCH WITHIN PAVED AREA WITH PREMIUM ROCK AND OIL 2 INCHES IN THICKNESS EXCEPT AS NOTED.
USE FORMULA NO. 1 SEC. 54 OF SPECIFICATIONS TO COMPUTE ALLOWABLE LEAKAGE.
THE CONTRACTOR SHALL NOTIFY THE CONSTRUCTION AND STORM DRAIN DIVISION BY TELEPHONE MADISON 9-4747, EXT. 362 AT LEAST 24 HOURS BEFORE STARTING ANY WORK UNDER THIS CONTRACT.
CONSTRUCT HOUSE LATERALS WITH INVERTS AT PROPERTY LINE 8 FEET BELOW CURB GRADE, OR GRADE OF CENTER LINE OF STREET EXCEPT AS NOTED.
FIGURES IN CIRCLES AT ENDS OF HOUSE LATERALS INDICATE DEPTH-BELOW CURB GRADE, OR GRADE OF CENTER LINE OF STREET.
FIGURES IN CIRCLES AT ENDS OF HOUSE LATERALS INDICATE HOUSE LATERALS SHALL BE EXTENDED WITH 1/4" RISE PER FOOT TO PROPERTY LINE.
WORDS IN CIRCLES AT ENDS OF HOUSE LATERALS INDICATE Y'S SHALL BE LAID HORIZONTAL AND HOUSE LATERALS SHALL BE CONSTRUCTED WITH 1/4" RISE PER FOOT TO PROPERTY LINE.
CONSTRUCTION IN STATE HIGHWAYS SHALL CONFORM WITH STATE HIGHWAY PERMIT.
MANHOLE TOPS TO BE ADJUSTED TO FINISHED GRADE EXCEPT AS NOTED.

- UTILITY LINE OWNERS
(1) - SOUTHERN CALIFORNIA GAS COMPANY
(2) - SOUTHERN CALIFORNIA WATER COMPANY
(3) - SHELCOIL OIL COMPANY
(4) - PACIFIC TELEPHONE COMPANY

FOR LEGEND SEE PLAN NO. S-A-44

NOTE: GRADES TO WHICH THIS IMPROVEMENT IS TO BE CONSTRUCTED ARE SHOWN ON PLANS AND PROFILES. GRADE POINTS FOR TOP OF CURB, CENTER LINE OF STREET OR COVER LINE OF ALLEY ARE SHOWN BY CIRCLES ON PROFILES. AT ALL POINTS BETWEEN DESIGNATED POINTS THE GRADE SHALL BE ESTABLISHED SO AS TO CONFORM TO A STRAIGHT LINE BEING BETWEEN SAID DESIGNATED POINTS. ELEVATIONS ARE IN FEET ABOVE U.S.C. & G.S. SEA LEVEL DATUM AS OF 1929. UNIT PRICES FOR ADDITIONAL WORK WHICH MAY BE REQUIRED BUT WHICH CANNOT BE ASCERTAINED IN ADVANCE, SHALL BE DETERMINED IN THE PROPOSAL. THIS DRAWING AND THE DATA HEREON ARE HEREBY MADE A PART OF THE SPECIFICATIONS.

REFERENCES		
W. S. 25	DESIGNED	T. HONDA FEB 1960
A. B. 476-479	TRACED	T. HONDA FEB 1960
F. B. 1241	CHECKED	H. LEE FEB 1960

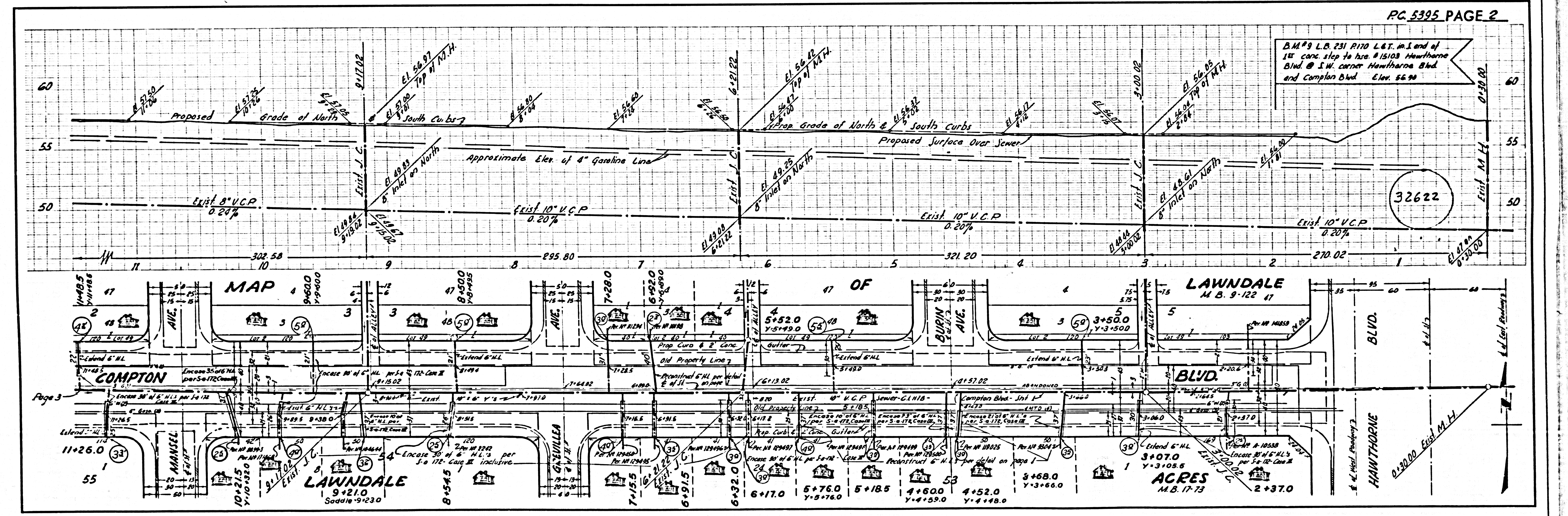

B.M. 9 L.B. 231 P. 170 L&I in S. end of 1st conc. slip to hse. # 15103 Hawthorne Blvd. @ S.W. corner Hawthorne Blvd. and Compton Blvd. Elev. 56.90

32622

