

B.M.S. 2466 L&T E. Curb of Orisaba Avenue 1/2 South of Curb of Orisaba S.E. Cor. of Orisaba Ave. & South St. Elev. 50.763. Subtract 0.39 from all elevations to agree with this bench.

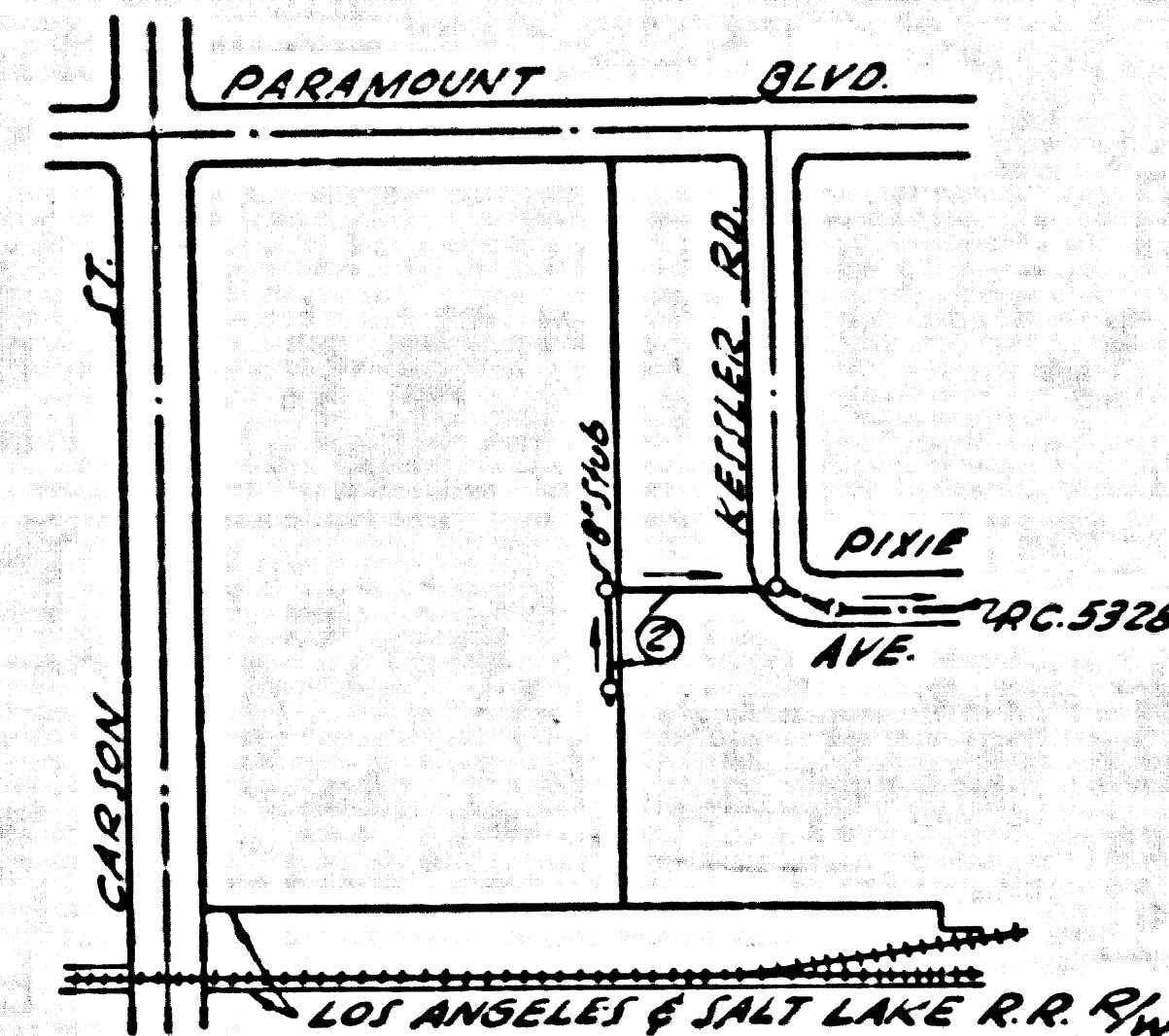

INDEX MAP
SCALE: 1"=400'
P.C. 5419

CONNECTION CHARGES AS INDICATED.
Raymond Long 2-4-60

DO NOT ISSUE PERMIT UNTIL OUTLET, P.C. 5307, IS CONSTRUCTED

Ann E. Gentry 2-4-60

LAKWOOD BLDG. DIST. NO. 401

- NOTES:
- PROVIDE STAKES ON THE PROPERTY LINE OR PROPERTY LINES PRODUCED AT RIGHT ANGLES TO THE SEWER LINE AT THE CENTER LINE OF EACH MANHOLE.
 - NO REPRESENTATIVE OF THE CITY ENGINEER WILL SURVEY OR LAY OUT ANY PORTION OF THE WORK.
 - THE OWNER OR HIS AUTHORIZED REPRESENTATIVE SHALL FURNISH THE CITY ENGINEER WITH GRADE SHEETS AND STATIONING FOR ALL HOUSE LATERALS AND Y BRANCHES AND SHALL PROVIDE STAKES FOR THEM AT THEIR PROPER LOCATIONS WITH STATIONING PLAINLY MARKED. ANY CHANGE IN LOCATION SHALL BE REQUESTED BY WRITING BY THE OWNER OR HIS REPRESENTATIVE.
 - THE PRIVATE ENGINEER SHALL FURNISH THE HOUSE LATERAL DEPTH AT THE PROPERTY LINE SHOW THE TOP OF CURB ELEVATION FOR EACH HOUSE LATERAL ON THE GRADE SHEET.
 - NO REVISIONS SHALL BE MADE IN THESE PLANS WITHOUT THE APPROVAL OF THE CITY ENGINEER.
 - USE STANDARD MANHOLE FRAMES AND COVERS, S-117.
 - USE STANDARD STRENGTH PIPE EXCEPT AS NOTED.
 - USE CEMENT MORTAR OR "WEDGE-LOCK" OR "SPEED-SEAL" FOR ALL V.C.P. JOINTS PER SPEC'S, SECT. 26 & 41.
 - RESURFACE ALL TRENCH WITHIN PAVED AREA TO MEET L.A. COUNTY ROAD DEPT. OR CALIF. STATE HIGHWAY REQUIREMENTS IN ACCORDANCE WITH PERMITS.
 - ENCASE FOUR FEET OF SEWER AT POINTS OF INTERFERENCE WITH POLES, CASE III, S-172.
 - ALL STRUCTURES SHALL BE BRICK SEWER STRUCTURES, S-104.
 - FOR ALLOWABLE LEAKAGE TEST USE FORMULA NO. 1, SPEC'S, SEC. 54.
 - MANHOLE TOPS IN UNIMPROVED RIGHTS-OF-WAY TO BE SIX INCHES ABOVE FINISHED GRADE.
 - THE CONTRACTOR SHALL NOTIFY THE CONSTRUCTION & STORM DRAIN DIVISION BY TELEPHONE, MESSAGE 9-474, EXT. 262, AT LEAST TWENTY-FOUR HOURS BEFORE STARTING ANY WORK UNDER THIS CONTRACT.

ENGINEERING SERVICE CORPORATION
1127 W. WASHINGTON BLVD.
LOS ANGELES 15, CALIF. RI. 9-7281

REVISIONS		TRACED BY <i>P.H.B.</i>
		DES'G'D BY <i>P.H.B.</i>
		CHK'D BY <i>A.A.M.P.</i>
		SUBMITTED
SUB STRUCTURES OK'D		
W. O. NO.	DWG. NO.	DATE
6835-12		JAN. 50

PROFILE ALIGNMENT AND GRADE OF P.C. 5419
SANITARY SEWERS PAGE 1
TO BE CONSTRUCTED IN
SAN. SEWER RIGHT OF WAY
NORTH OF KESSLER ROAD

PRIVATE CONTRACT NO. 5419

W.S.
1 SHEETS; 2 PAGES
SCALE: VERT. 1"=4' HORIZ. 1"=40'
January, 1960
PREPARED IN THE OFFICES OF
ENGINEERING SERVICE CORPORATION

28,670

By: *E.J. King*
REG. C. E. NO. 2657

FOR LEGEND SEE PLAN NO. S-A-64

NOTES:
GRADES TO WHICH THIS IMPROVEMENT IS TO BE CONSTRUCTED ARE SHOWN ON PLANS AND PROFILES. GRADE POINTS FOR TOP OF CURBS, CENTER LINE OF STREETS, OR CENTER LINE OF ALLEYS ARE SHOWN BY CIRCLES ON PROFILES. AT ALL POINTS BETWEEN DESIGNATED POINTS THE GRADE SHALL BE ESTABLISHED SO AS TO CONFORM TO A STRAIGHT LINE DRAWN BETWEEN SAID DESIGNATED POINTS.
ELEVATIONS ARE IN FEET ABOVE U.S.C. & G.S. MEAN SEA LEVEL DATUM OF 1929.
THIS DRAWING AND THE DATA HEREON ARE HEREBY MADE A PART OF THE SPECIFICATIONS.
WORK SHALL BE CONSTRUCTED ACCORDING TO SPECIFICATIONS ON FILE IN THE OFFICE OF THE CITY ENGINEER AND SHALL BE PROSECUTED ONLY IN THE PRESENCE OF THE CITY ENGINEER.
BEFORE WORK CAN BE STARTED, THE CONTRACTOR MUST OBTAIN A PERMIT TO EXCAVATE IN CITY STREETS FROM THE L.A. COUNTY ROAD DEPT., DISTRICT OFFICE NO. 8, AND MAKE A DEPOSIT WITH THE CITY OF LAKWOOD, 1240 S. GLEN AVE., LAKWOOD, CALIF., SUFFICIENT TO COVER THE COST OF CONSTRUCTION INSPECTION AND RECORD PLANS.
APPROVAL OF THIS PLAN BY THE CITY OF LAKWOOD DOES NOT CONSTITUTE A REPRESENTATION AS TO THE ACCURACY OF THE LOCATION OR OF THE EXISTENCE OR NON-EXISTENCE OF ANY UNDERGROUND UTILITY PIPE, OR STRUCTURE WITHIN THE LIMITS OF THIS PROJECT. THIS NOTE APPLIES TO ALL PAGES.
IF WORK IS TO BE DONE IN A STATE HIGHWAY, A PERMIT MUST BE OBTAINED FROM THE STATE OF CALIFORNIA, DIVISION OF HIGHWAYS, 130 SOUTH SPRING STREET.

COUNTY OF LOS ANGELES, CALIFORNIA

APPROVED, JOHN A. LAMBE, CITY ENGINEER
APPROVED, C.R. COMPTON, CHIEF ENGINEER
BY: *E.E. Pinsky* ASST. SANITATION ENGINEER
BY: *J. Hoffmann* OFFICE ENGINEER
CHECKED BY: *W.K. O'Neil*
OFFICE OF CITY ENGINEER, REG. C. E. NO. 2456

SUBMITTED BY: *John L. Eaton*
LOS ANGELES REGIONAL ENGINEER, REG. C. E. NO. 387

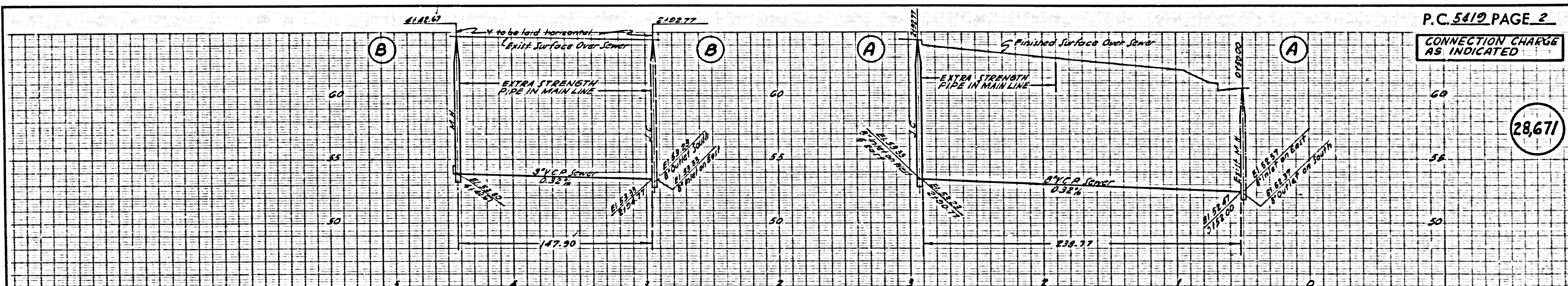

P.C. 5419 PAGE 2

CONNECTION CHARGE AS INDICATED

28,671

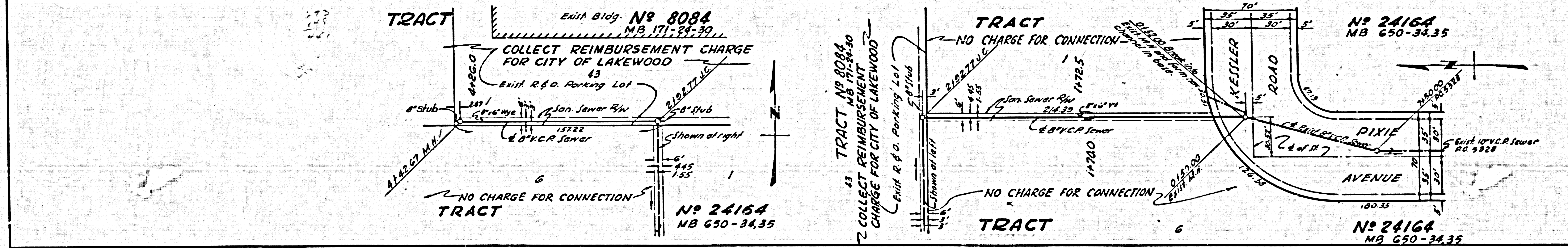

No 24164 MB 650-34,35

No 24164 MB 650-34,35