

LAWDALE BLDG. DIST. NO. 704

PROFILE ALIGNMENT AND GRADE OF P.C. 5440  
 SANITARY SEWERS PAGE 1  
 TO BE CONSTRUCTED IN J.N. 0873-93.

OSAGE AVENUE  
 PRIVATE CONTRACT NO. 5440

W.S. 25  
 1 SHEET 2 PAGES  
 SCALE: HORIZ. 1" = 40' VERT. 1" = 4'  
 FEBRUARY, 1960  
 PREPARED IN THE OFFICES OF  
 BARCLAY-PEARSON CO., INC.  
 REG. C. E. NO. 2783

29,128

BENCH MARK: SV 2818, E1 53353 LET IN  
 NE CORNER ON NLY GAS PUMP  
 ISLAND 2 40' SW. OF 4. 154TH ST.  
 2 46' W. OF W. CURB LINE OF W.  
 DRIVE HAWTHORNE BLVD. TORRANCE QUD.

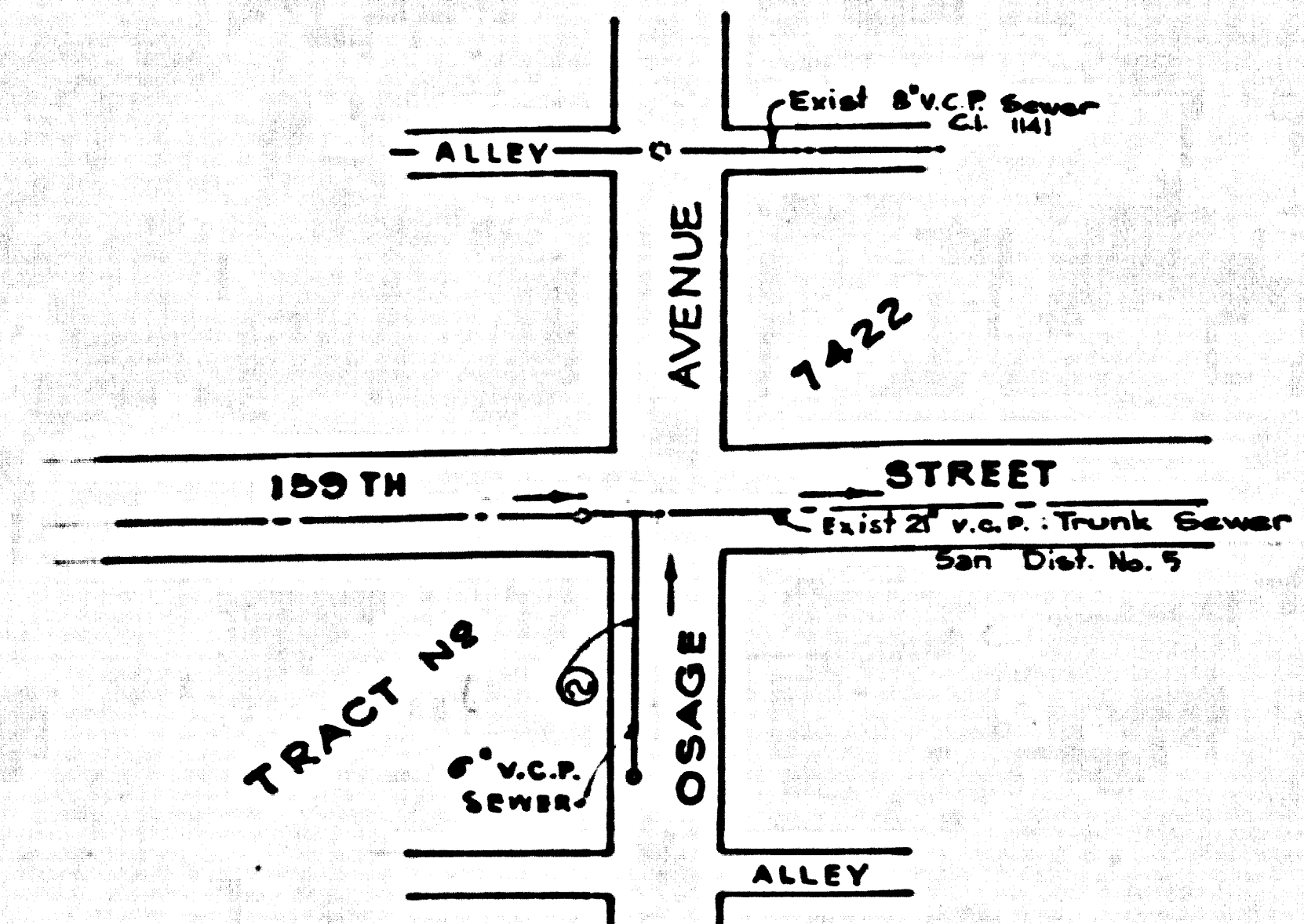

INDEX MAP  
 SCALE 1" = 100'  
 P.C. 5440

REVISION - moved sewer into driveway  
 and changed 8" V.C.P. to 6" V.C.P.  
 and sodded trunk sewer.  
 APPROVED BY J.K. Duda 4-6-60  
 REG. C. E. NO. 2446  
 APPROVED, C.E. COMPTON, CHIEF ENGINEER  
 BY J. J. [Signature]  
 OFFICE ENGINEER

NO CHARGE FOR  
 CONNECTION  
 L. Duda 2-19-60

- NOTES:
1. PROVIDE STAKES ON THE PROPERTY LINE OR PROPERTY LINES PRODUCED AT RIGHT ANGLES TO THE SEWER LINE AT THE CENTER LINE OF EACH MANHOLE.
  2. NO REPRESENTATIVE OF THE CITY ENGINEER WILL SURVEY OR LAY OUT ANY PORTION OF THE WORK.
  3. THE OWNER OR HIS AUTHORIZED REPRESENTATIVE SHALL FURNISH THE CITY ENGINEER WITH GRADE SHEETS AND STATIONING FOR ALL HOUSE LATERALS AND Y BRANCHES AND SHALL PROVIDE STAKES FOR THEM AT THEIR PROPER LOCATIONS WITH STATIONING PLAINLY MARKED. ANY CHANGE IN LOCATION SHALL BE REQUESTED IN WRITING BY THE OWNER OR HIS REPRESENTATIVE.
  4. THE PRIVATE ENGINEER SHALL FURNISH THE HOUSE LATERAL DEPTH AT THE PROPERTY LINE BELOW THE TOP OF CURB ELEVATION FOR EACH HOUSE LATERAL ON THE GRADE SHEET.
  5. NO REVISIONS SHALL BE MADE IN THESE PLANS WITHOUT THE APPROVAL OF THE CITY ENGINEER.
  6. USE STANDARD MANHOLE FRAMES AND COVERS, S-117, EXCEPT AS NOTED.
  7. USE STANDARD STRENGTH PIPE EXCEPT AS NOTED.
  8. USE CEMENT MORTAR OR "WEDGE-LOCK" OR "SPEED-SEAL" FOR ALL V.C.P. JOINTS PER SPEC. SECS. M & N.
  9. RESURFACE ALL TRENCH WITHIN PAVED AREA TO MEET CITY ROAD DEPT. OR CALIF. STATE HIGHWAY REQUIREMENTS IN ACCORDANCE WITH PERMITS.
  10. ENCASE FOUR FEET OF SEWER AT POINTS OF INTERFERENCE WITH POLES, CASE BY S-172.
  11. HOUSE LATERALS TO BE CONSTRUCTED WITH INVERTS AT PROPERTY LINE 6 FEET BELOW CURB GRADE.
  12. ALL STRUCTURES SHALL BE BRICK SEWER STRUCTURES, S-104.
  13. FOR ALLOWABLE LEAKAGE TEST USE FORMULA NO. 1, SPEC. SEC. 84.
  14. THE CONTRACTOR SHALL NOTIFY THE CONSTRUCTION & STORM DRAIN DIVISION BY TELEPHONE, MADISON 5-4700, EXT. 302, AT LEAST 16 HOURS BEFORE STARTING ANY WORK UNDER THIS CONTRACT. ALL THE LOCATIONS SHOWN FOR EXISTING SUBSTRUCTURES HAVE BEEN TAKEN FROM RECORDS AND THEIR CORRECTNESS AND COMPLETENESS IS IN NO WAY GUARANTEED. IT SHALL BE THE CONTRACTOR'S RESPONSIBILITY ALONE TO DEFINITELY LOCATE ALL SUBSTRUCTURES AT ALL TIMES OF EVERY NATURE WHETHER SHOWN HEREON OR NOT AND PROTECT THEM FROM DAMAGE. THE CONTRACTOR SHALL BEAR THE TOTAL EXPENSE OF REPAIR TO ANY LINE DAMAGED BY ANY OPERATION IN CONNECTION WITH THE PROSECUTION OF THIS WORK.
  15. SPECIFICATIONS DATED JAN. 1, 1960 APPLY IN THE CONSTRUCTION OF THIS PROJECT.

Before breaking into any existing structure  
 and before final acceptance of this work,  
 County Sanitation District (DU 4-1281) shall  
 be notified in order that required inspection  
 can be made.

NOTE:  
 GRADES TO WHICH THIS IMPROVEMENT IS TO BE CONSTRUCTED ARE SHOWN ON PLANS AND PROFILE. GRADE POINTS FOR TOP OF CURBS, CENTER LINE OF STREETS, OR CENTER LINE OF ALLEYS ARE SHOWN BY CIRCLES ON PROFILES. AT ALL POINTS BETWEEN DESIGNATED POINTS THE GRADE SHALL BE ESTABLISHED SO AS TO CONFORM TO A STRAIGHT LINE DRAWN BETWEEN SAID DESIGNATED POINTS.  
 ELEVATIONS ARE IN FEET ABOVE B.S.C. & S.S. SEA LEVEL DATUM OF 1929.  
 THIS DRAWING AND THE DATA HEREON ARE HEREBY MADE A PART OF THE SPECIFICATIONS.  
 WORK SHALL BE CONSTRUCTED ACCORDING TO SPECIFICATIONS ON FILE IN THE OFFICE OF THE CITY ENGINEER AND SHALL BE PROSECUTED ONLY IN THE PRESENCE OF THE CITY ENGINEER.  
 BEFORE WORK CAN BE STARTED THE CONTRACTOR MUST OBTAIN A PERMIT TO EXCAVATE IN CITY STREETS FROM THE CITY ROAD DEPT., DISTRICT OFFICE NO. 3, AND MAKE A DEPOSIT WITH THE CITY ENGINEER \$700.00 MAIN HAWTHORNE BLVD., LAWDALE, CALIF. SUFFICIENT TO COVER THE COST OF CONSTRUCTION INSPECTION AND RECORD PLANS.  
 APPROVAL OF THIS PLAN BY THE CITY OF LAWDALE DOES NOT CONSTITUTE A REPRESENTATION AS TO THE ACCURACY OF THE LOCATION OR OF THE EXISTENCE OR NON-EXISTENCE OF ANY UNDERGROUND UTILITY PIPE, OR STRUCTURE WITHIN THE LIMITS OF THIS PROJECT. THIS NOTE APPLIES TO ALL PAGES.  
 IF WORK IS TO BE DONE IN A STATE HIGHWAY, A PERMIT MUST BE OBTAINED FROM THE STATE OF CALIFORNIA, DIVISION OF HIGHWAYS, 128 SOUTH SPRING STREET.  
 CITY OF LAWDALE, CALIFORNIA  
 APPROVED, JOHN A. LAWBE, CITY ENGINEER APPROVED, C. R. COMPTON, CHIEF ENGINEER  
 BY C. E. [Signature] ASST. SANITATION ENGINEER BY J. J. [Signature] OFFICE ENGINEER  
 CHECKED BY J.K. Duda 2-2-60 OFFICE OF CITY ENGINEER, REG. C. E. NO. 2446  
 SUBMITTED BY Jackie C. Lansing  
 PACOS VERDES, CENTINELA VALLEY REGIONAL ENGINEER

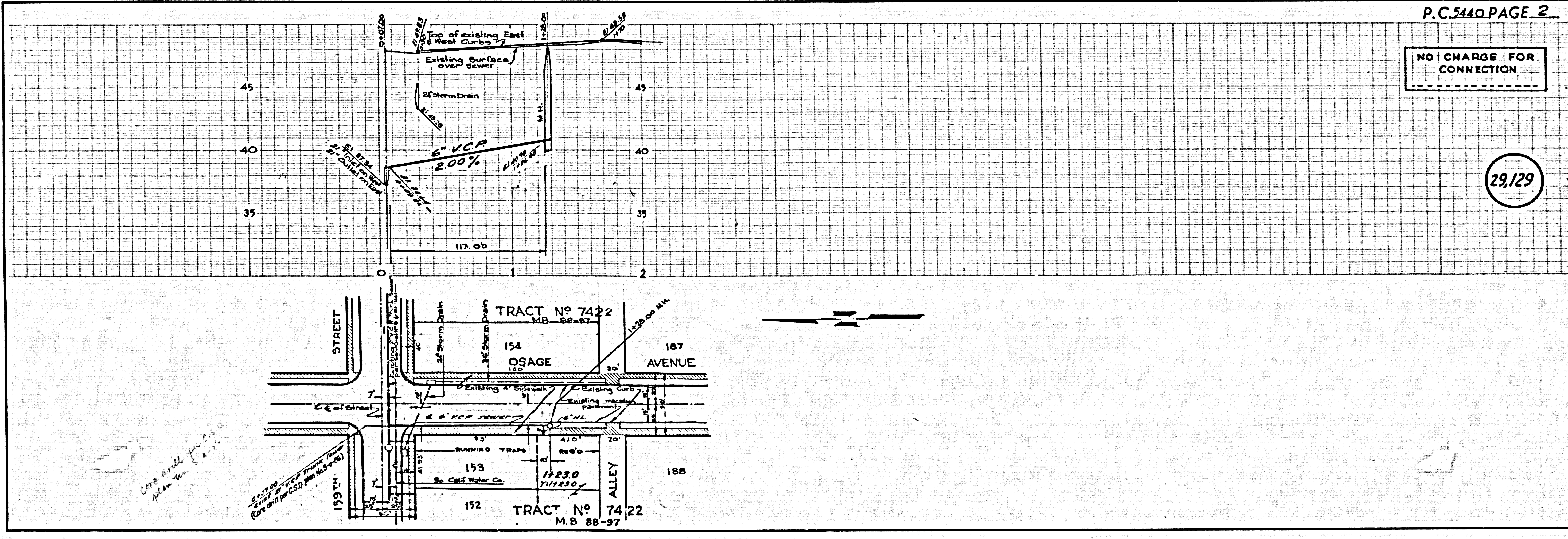

NO CHARGE FOR  
 CONNECTION

29,129