

D.R. - 67-4070 ELEV. 150.000 441 R.R. DEPT. D.M. THE RES. IN C.B. 2 30' N. OF TELEGRAPH RD. 1 1/2' S. OF DRIVE TO CHERRY GARDENS FIDUCIALS B.L.P.S. 9533 TELEGRAPH RD. APPROX. 414 105-40 10534 QUIL

CITY OF COMMERCE BLDG. DIST. NO. 6.01

PROFILE ALIGNMENT AND GRADE OF P.C. 5444
SANITARY SEWERS PAGE 1
TO BE CONSTRUCTED IN

SEWER R/W NORTH OF SANTA ANA FREEWAY

PRIVATE CONTRACT NO. 5444

W.S. 36

1 SHEET 2 PAGES

SCALE: VERT. 1" = 4' HORIZ. 1" = 40' FEBRUARY, 1960

PREPARED IN THE OFFICES OF

L. M. PEREYBAUM

By Lewis M. Perenbaum
REG. C. E. NO. 6856

FOR LEGEND SEE PLAN NO. S-A-64

29,062

- NOTES
1. PROVIDE STAKES ON THE PROPERTY LINE OR PROPERTY LINES PRODUCED AT RIGHT ANGLES TO THE SEWER LINE AT THE CENTER LINE OF EACH MANHOLE.
 2. NO REPRESENTATIVE OF THE CITY ENGINEER WILL SURVEY OR LAY OUT ANY PORTION OF THE WORK.
 3. THE OWNER OR HIS AUTHORIZED REPRESENTATIVE SHALL FURNISH THE CITY ENGINEER WITH GRADE SHEETS AND STATIONING FOR ALL HOUSE LATERALS AND Y BRANCHES AND SHALL PROVIDE STAKES 1/2" THIN AT THEIR PROPER LOCATIONS WITH STATIONING PLAINLY MARKED. ANY CHANGE IN LOCATION SHALL BE REQUESTED IN WRITING BY THE OWNER OR HIS REPRESENTATIVE.
 4. THE PRIVATE ENGINEER SHALL FURNISH THE HOUSE LATERAL DEPTH AT THE PROPERTY LINE BELOW THE TOP OF CURB ELEVATION FOR EACH HOUSE LATERAL ON THE GRADE SHEET.
 5. NO REVISIONS SHALL BE MADE IN THESE PLANS WITHOUT THE APPROVAL OF THE CITY ENGINEER.
 6. USE STANDARD MANHOLE FRAMES AND COVERS, S-117.
 7. USE STANDARD STRENGTH PIPE.
 8. USE CEMENT MORTAR OR "WEDGE LOCK" OR "SPED-SPAL" FOR ALL V.C.P. JOINTS PER SPEC., SECS. 94 & 95.
 9. REINFORCE ALL TRENCH WITHIN PAVED AREA TO MEET L.A. COUNTY ROAD DEPT. OR CALIF. STATE HIGHWAY REQUIREMENTS IN ACCORDANCE WITH PERMITS.
 10. ENCASE FOUR FEET OF SEWER AT POINTS OF INTERFERENCE WITH POLES, CASE III, S-173.
 11. STANDARD SPECIFICATIONS DATED JAN. 1, 1960 APPLY IN THE CONSTRUCTION OF THIS PROJECT.
 12. ALL STRUCTURES SHALL BE BRICK SEWER STRUCTURES, S-104.
 13. FOR ALLOWABLE LEAKAGE TEST USE FORMULA NO. 1, SPEC. 5, SEC. 54.
 14. MANHOLE TOPS IN UNIMPROVED RIGHTS-OF-WAY TO BE LEVEL WITH PROPOSED FINISHED GRADE.
 15. THE CONTRACTOR SHALL NOTIFY THE DESIGN DIVISION BY TELEPHONE, MADISON 9-4747, EXT. 343, AT LEAST TWENTY-FOUR HOURS BEFORE STARTING ANY WORK UNDER THIS CONTRACT.

NO CHARGE FOR CONNECTIONS
A.S. Albertson

APPROVED, INDUSTRIAL WASTE DIVISION
BY J.H. Stewart DATE 2/21/60

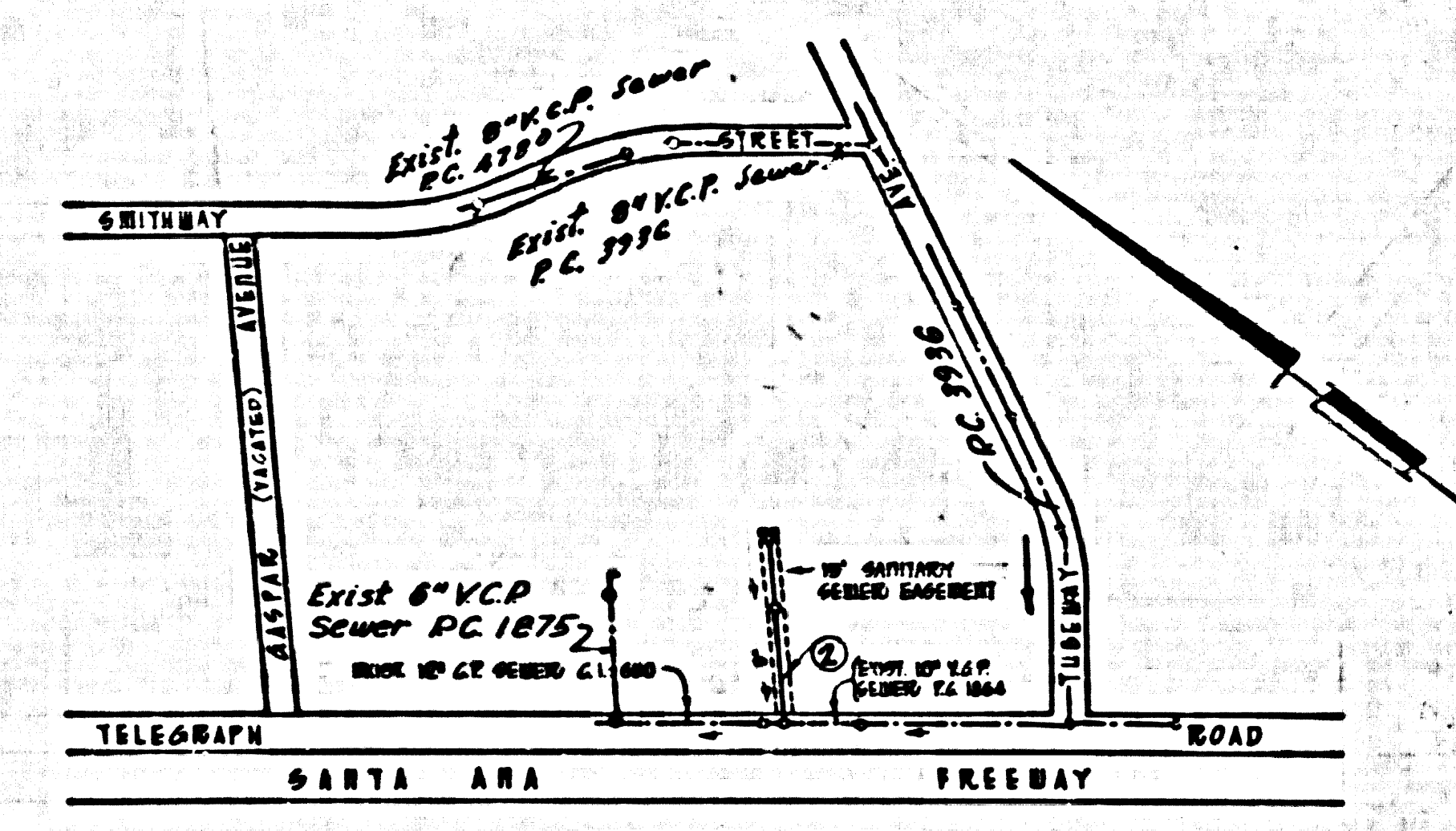

NOTE
GRADES TO WHICH THIS IMPROVEMENT IS TO BE CONSTRUCTED ARE SHOWN ON PLANS AND PROFILES. GRADE POINTS FOR TOP OF CURB, CENTER LINE OF STREETS, OR CENTER LINE OF ALLEYS ARE SHOWN BY CIRCLES ON PROFILES. AT ALL POINTS BETWEEN DESIGNATED POINTS THE GRADE SHALL BE ESTABLISHED SO AS TO CONFORM TO A STRAIGHT LINE DRAWN BETWEEN SAID DESIGNATED POINTS.
ELEVATIONS ARE IN FEET ABOVE U.S.C. & G.S. SEA LEVEL DATUM OF 1929.
THIS DRAWING AND THE DATA HEREON ARE HEREBY MADE A PART OF THE SPECIFICATIONS.
WORK SHALL BE CONSTRUCTED ACCORDING TO SPECIFICATIONS ON FILE IN THE OFFICE OF THE COUNTY ENGINEER AND SHALL BE PROSECUTED ONLY IN THE PRESENCE OF THE CITY ENGINEER.
BEFORE WORK CAN BE STARTED, THE CONTRACTOR MUST OBTAIN A PERMIT TO EXCAVATE IN COUNTY STREETS FROM THE L.A. COUNTY ROAD DEPT., DISTRICT OFFICE NO. 2, AND MAKE A DEPOSIT WITH THE CITY ENGINEER, CITY OF COMMERCE, SUFFICIENT TO COVER THE COST OF CONSTRUCTION INSPECTION AND RECORD PLANS.
APPROVAL OF THIS PLAN BY THE CITY OF COMMERCE DOES NOT CONSTITUTE A REPRESENTATION AS TO THE ACCURACY OF THE LOCATION OR OF THE EXISTENCE OR NON-EXISTENCE OF ANY UNDERGROUND UTILITY PIPE, OR STRUCTURE WITHIN THE LIMITS OF THIS PROJECT. THIS NOTE APPLIES TO ALL PAGES.
IF WORK IS TO BE DONE IN A STATE HIGHWAY, A PERMIT MUST BE OBTAINED FROM THE STATE OF CALIFORNIA, DIVISION OF HIGHWAYS, 128 SOUTH BRIDGE STREET.

CITY OF COMMERCE, CALIFORNIA

APPROVED, JOHN A. LAMBE, CITY ENGINEER

APPROVED, C. R. COMPTON, CHIEF ENGINEER

BY C.E. Priddy DISTRICT SANITATION ENGINEER

BY J. Albertson OFFICE ENGINEER

CHECKED BY S.K. Dunder 4-12-60

OFFICE OF CITY ENGINEER, BLDG. C. E. NO. 5444

SUBMITTED: N.F. Bravender
SAN GABRIEL VALLEY REGIONAL ENGINEER

P.C. 5444 PAGE 2

NO CHARGE FOR CONNECTIONS

29,063

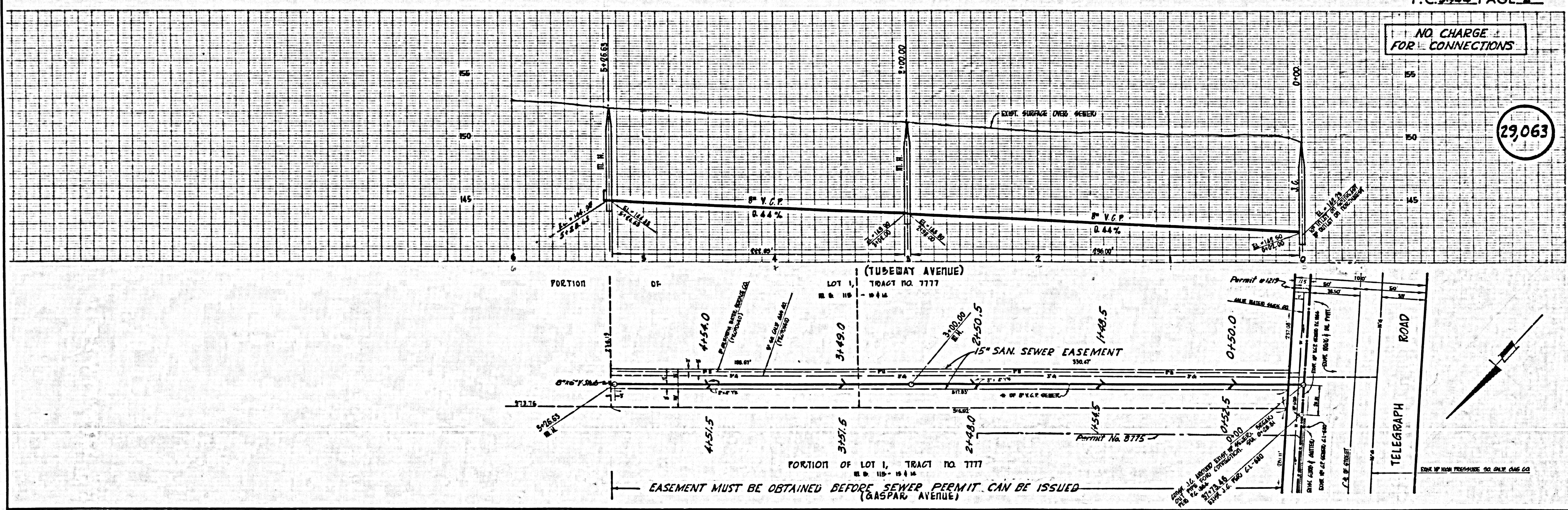

EASEMENT MUST BE OBTAINED BEFORE SEWER PERMIT CAN BE ISSUED (GASPAR AVENUE)