

DENCH MARK-SV3889 Elev. 43.718
 L & B. Nail south side concrete base
 of signal lights 30' east of centerline of
 Broadway & 45' north of centerline of
 Olive Street Gardena Quad.

LENNOX BLDG. DIST. NO. 7

PROFILE ALIGNMENT AND GRADE OF P.C. 5452
 SANITARY SEWERS PAGE 1
 TO BE CONSTRUCTED IN J.N.035295

ALONDRA BOULEVARD
 AND SANITARY SEWER R/W
 PRIVATE CONTRACT NO. 5452

W.S. 26
 1 SHEET, 2 PAGES

SCALE: VERT. 1"=4'
 HORIZ. 1"=40' MARCH, 1960

29,449

PREPARED IN THE OFFICES OF
 CONLEY ENGINEERS, INC.

By *W. Conley*

REG. C. E. NO. 10193

FOR LEGEND SEE PLAN NO. S-A-64

- NOTES:
- PROVIDE STAKES ON THE PROPERTY LINES OR PROPERTY LINES PROVIDED AT RIGHT ANGLES TO THE SEWER LINE AT THE CENTER LINE OF EACH MANHOLE.
 - NO REPRESENTATIVE OF THE COUNTY ENGINEER WILL SURVEY OR LAYOUT ANY PORTION OF THE WORK.
 - THE OWNER OR HIS AUTHORIZED REPRESENTATIVE SHALL FURNISH THE COUNTY ENGINEER WITH GRADE SHEETS AND STATION FOR ALL HOUSE LATERALS AND Y BRANCHES AND SHALL PROVIDE STAKES FOR THEM AT THEIR PROPOSED LOCATIONS WITH STATIONING PLAINLY MARKED. ANY CHANGE IN LOCATION SHALL BE RECEIVED IN WRITING BY THE OWNER OR HIS REPRESENTATIVE.
 - NO REVISIONS SHALL BE MADE IN THESE PLANS WITHOUT THE APPROVAL OF THE COUNTY ENGINEER.
 - USE STANDARD MANHOLE FRAMES AND COVERS, S-A-117, EXCEPT AS NOTED.
 - USE STANDARD STRENGTH PIPE EXCEPT AS NOTED.
 - USE CEMENT MORTAR OR "WEDGE LOCK" OR "SPIDER-SEAL" FOR ALL V.C.P. JOINTS PER SPEC. SEC. 26 & 48.
 - RESURFACE ALL TRENCH WITHIN PAVED AREA TO MEET L.A. COUNTY ROAD DEPT., OR CALIF. STATE HIGHWAY DEPT. REQUIREMENTS IN ACCORDANCE WITH PERMITS.
 - ENCASE FOUR FEET OF SEWER AT POINTS OF INTERFERENCE WITH POLES, S-A-119.
 - SPECIFICATIONS DATE JAN. 1, 1960 APPLY IN THE CONSTRUCTION OF THIS PROJECT EXCEPT AS NOTED.
 - ALL STRUCTURES SHALL BE BRICK SEWER STRUCTURES, S-A-194, EXCEPT AS NOTED.
 - FOR ALLOWABLE LEAKAGE TEST USE FORMULA NO. 1 PER SPEC. SEC. 54.
 - MANHOLE TOPS IN UNIMPROVED RIGHTS-OF-WAY TO BE 6" ABOVE FINISHED GRADE.
 - THE CONTRACTOR SHALL NOTIFY THE CONSTRUCTION DIVISION BY TELEPHONE, RA. 9-6767 EXT. 121 AT LEAST TWENTY-FOUR HOURS BEFORE STARTING ANY WORK UNDER THIS PROJECT.

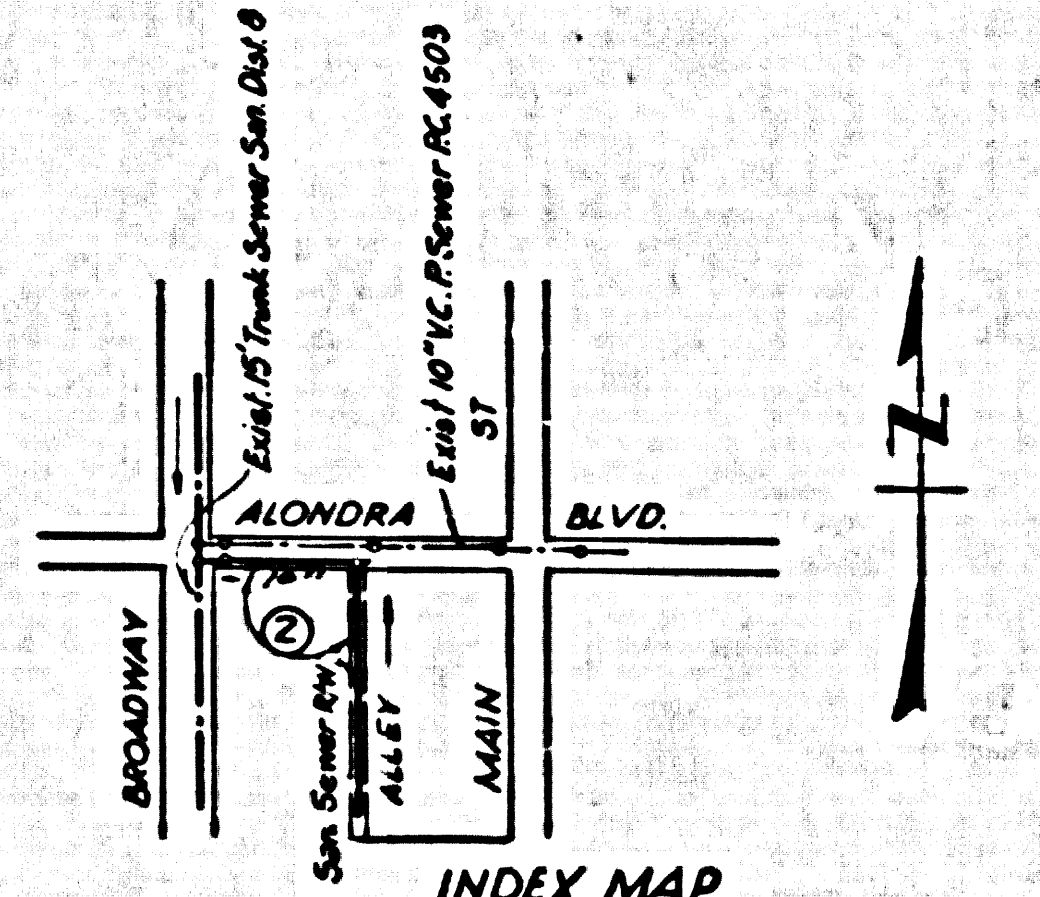

Future Bldg. plans submitted for approval to the
 INDUSTRIAL WASTE DIVISION will contain
 THE REQUIRED PRETREATMENT FACILITIES.
Joe Knight
 IND. WASTE DIV.
 5-12-60

NO CHARGE
 FOR CONNECTIONS
L. Curtis 7-12-60

Before breaking into any existing structure
 and before final acceptance of this work,
 County Sanitation District (DU 4-1583) shall
 be notified in order that required inspection
 can be made.

NOTE:
 GRADES TO WHICH THIS DRAWING IS TO BE CONSTRUCTED ARE SHOWN ON PLANS AND PROFILE. GRADE POINTS FOR
 TOP OF CURBS, CENTER LINE OF STREETS, OR CENTER LINE OF ALLEYS ARE SHOWN BY CIRCLES ON PROFILES. AT ALL POINTS BETWEEN
 DESIGNATED POINTS THE GRADE SHALL BE ESTABLISHED SO AS TO CONFORM TO A STRAIGHT LINE DRAWN BETWEEN SAID DESIGNATED
 POINTS.
 ELEVATIONS ARE IN FEET ABOVE U.S.C.E. DATUM OR MEAN SEA LEVEL.
 THIS DRAWING AND THE DATA HEREON ARE HEREBY MADE A PART OF THE SPECIFICATIONS.
 WORK SHALL BE CONSTRUCTED ACCORDING TO SPECIFICATIONS ON FILE IN THE OFFICE OF THE COUNTY ENGINEER AND SHALL
 BE PROSECUTED ONLY IN THE PRESENCE OF THE COUNTY ENGINEER.
 BEFORE WORK CAN BE STARTED, THE CONTRACTOR MUST OBTAIN A PERMIT TO EXCAVATE IN COUNTY STREETS FROM THE
 L.A. COUNTY ROAD DEPT., DIST. OFFICE OF E. AND PAY A FEE TO THE COUNTY ENGINEER, ROOM 104 MAIN AMERICAN BLDG.,
 BLDG. 333 SO. BROADWAY SUFFICIENT TO COVER THE COST OF CONSTRUCTION INSPECTION AND RECORD PLANS.
 APPROVAL OF THIS PLAN BY THE COUNTY OF LOS ANGELES DOES NOT CONSTITUTE A REPRESENTATION AS TO THE ACCURACY
 OF THE LOCATION OF OR THE EXISTENCE OR NON-EXISTENCE OF ANY UNDERGROUND UTILITY PIPE, OR STRUCTURE WITHIN THE
 LIMITS OF THIS PROJECT. THIS NOTE APPLIES TO ALL PAGES.
 IF WORK IS TO BE DONE IN A STATE HIGHWAY, A PERMIT MUST BE OBTAINED FROM THE STATE OF CALIFORNIA, DIVISION OF
 HIGHWAYS, 128 SOUTH SPRING STREET.

COUNTY OF LOS ANGELES, CALIFORNIA

APPROVED, JOHN A. LAMBIE, COUNTY ENGINEER
 APPROVED, C.R. COMPTON, CHIEF ENGINEER
 BY *C.E. Priddy* ASST. SANITATION ENGINEER
 BY *M. Northman* OFFICE ENGINEER
 CHECKED BY *P.F. Harley* 7-13-60
 OFFICE OF COUNTY ENGINEER, DIST. NO. 116-26
 SUBMITTED BY *Jack C. Lansing*
 PALOS VERDES, CATHLETT VALLEY REGIONAL ENGINEER

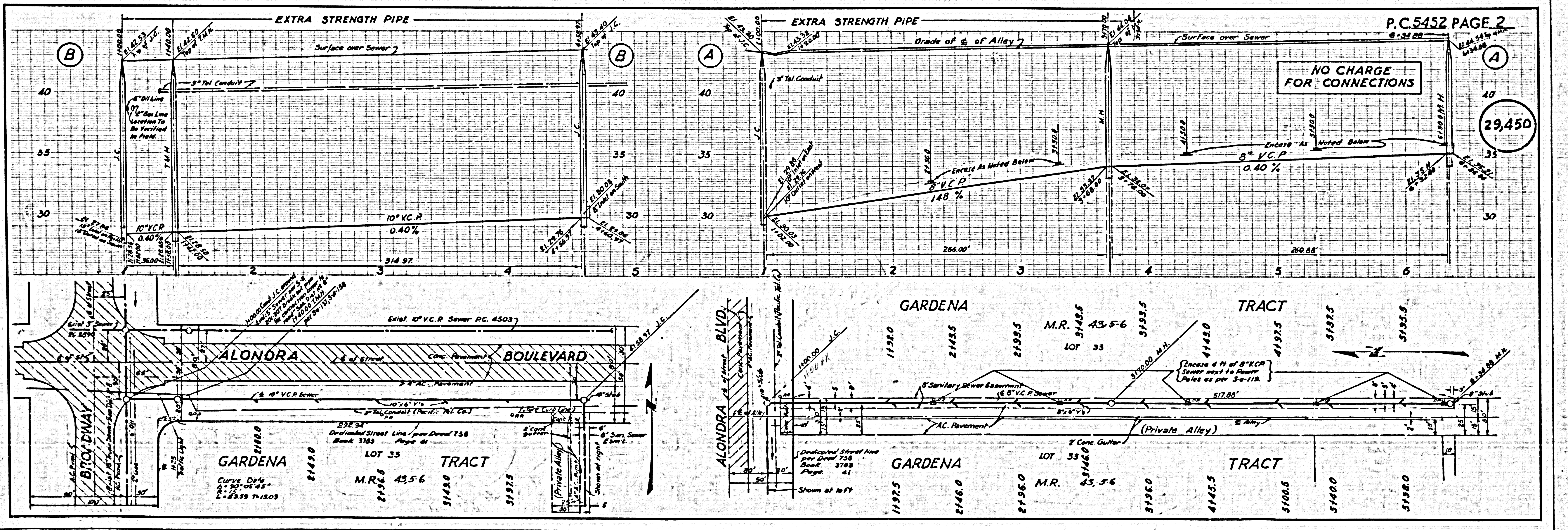

NO CHARGE
 FOR CONNECTIONS

29,450

P.C. 5452 PAGE 2
 6-24-60