

B.M. 5719G1A Elev. 71.041 (1955) Adj.  
 S. & L. in E. cb. Gibson St. & 12' S. of cb. rat. at  
 S.E. cor. Gibson St. & San Juan St. (Mkd. "F-423") South Gate Quad.

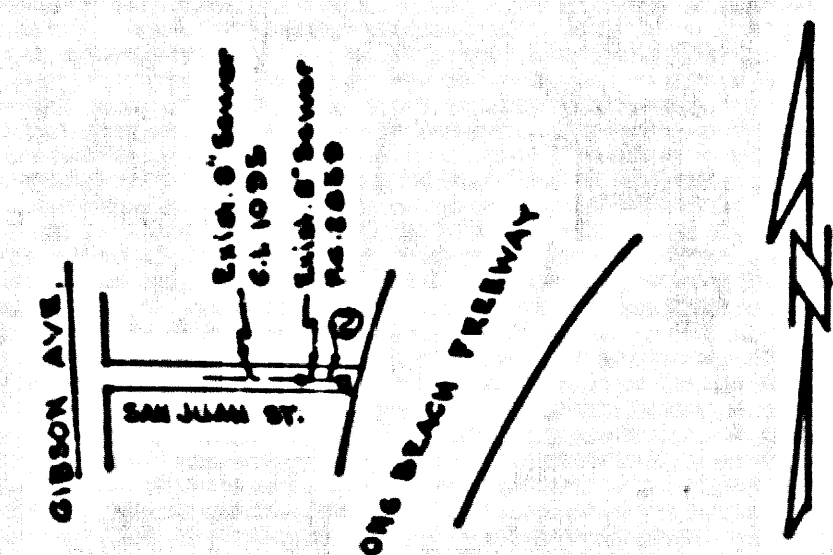

INDEX MAP  
 Scale 1"=600'  
 P.C. 547G  
 SAN JUAN ST.

FIRESTONE BLDG. DIST. NO. 1

- NOTES:
1. PROVIDE STAKES ON THE PROPERTY LINE OR PROPERTY LINES PRODUCED AT RIGHT ANGLES TO THE SEWER LINE AT THE CENTER LINE OF EACH MANHOLE.
  2. NO REPRESENTATIVE OF THE COUNTY ENGINEER WILL SURVEY OR LAY OUT ANY PORTION OF THE WORK.
  3. THE OWNER OR HIS AUTHORIZED REPRESENTATIVE SHALL FURNISH THE COUNTY ENGINEER WITH GRADE SHEETS AND STATIONING FOR ALL HOUSE LATERALS AND Y BRANCHES AND SHALL PROVIDE STAKES FOR THEM AT THEIR PROPER LOCATIONS WITH STATIONING PLAINLY MARKED. ANY CHANGE IN LOCATION SHALL BE REQUESTED IN WRITING BY THE OWNER OR HIS REPRESENTATIVE.
  4. THE PRIVATE ENGINEER SHALL FURNISH THE HOUSE LATERAL DEPTH AT THE PROPERTY LINE BELOW THE TOP OF CURB ELEVATION FOR EACH HOUSE LATERAL ON THE GRADE SHEET.
  5. NO REVISIONS SHALL BE MADE IN THESE PLANS WITHOUT THE APPROVAL OF THE COUNTY ENGINEER.
  6. USE RECTANGULAR MANHOLE FRAMES AND COVERS, 3'-0" DIA.
  7. USE STANDARD STRENGTH RIM.
  8. USE CEMENT MORTAR OR "WEDGE-LOCK" OR "SPREAD-SEAL" FOR ALL V.C.P. JOINTS PER SPECS. SECS. 14 & 15.
  9. RESURFACE ALL TRENCH WITHIN PAVED AREA TO MEET L.A. COUNTY ROAD DEPT. OR CALIF. STATE HIGHWAY REQUIREMENTS IN ACCORDANCE WITH PERMITS.
  10. ENCASE FOUR FEET OF SEWER AT POINTS OF INTERFERENCE WITH POLES, CASE III, 5-0-172.
  11. HOUSE LATERALS TO BE CONSTRUCTED WITH INVERTS AT PROPERTY LINE AS NOTED IN PROFILE, SHEET 2.
  12. ALL STRUCTURES SHALL BE BRICK SEWER STRUCTURES, 5'-12".
  13. FOR ALLOWABLE LEAKAGE TEST USE FORMULA NO. 1, SPECS. SEC. 24.
  14. MANHOLE TOPS IN UNIMPROVED AREAS SHALL BE 18" TO 24" HIGHER THAN FINISHED GRADE.
  15. THE CONTRACTOR SHALL NOTIFY THE CONSTRUCTION & STORM DRAIN DIVISION BY TELEPHONE, MADISON 3477, EXT. 32, AT LEAST TWENTY-FOUR HOURS BEFORE STARTING ANY WORK UNDER THIS CONTRACT.
  16. STANDARD SPECIFICATIONS DATED JAN. 1, 1960 APPLY IN THE CONSTRUCTION OF THIS PROJECT.

COLLECT CHARGES  
 AS INDICATED  
 Arthur B. Reedy

PROFILE ALIGNMENT AND GRADE OF P.C. 547G  
 SANITARY SEWERS PAGE 1  
 TO BE CONSTRUCTED IN J.N. 0353.15

SAN JUAN STREET  
 PRIVATE CONTRACT NO. 547G

W.S. 32  
 1 SHEET OF 2 PAGES

SCALE: VERT. 1"=4'  
 HORIZ. 1"=40' MARCH, 1960  
 PREPARED IN THE OFFICES OF

OLSON SURVEYING SERVICE

By: *Frank A. Olson*  
 REG. C. E. NO. 7820

FOR LEGEND SEE PLAN NO. S-A-61

NOTE:  
 GRADES TO WHICH THIS IMPROVEMENT IS TO BE CONSTRUCTED ARE SHOWN ON PLANS AND PROFILES. GRADE POINTS FOR TOP OF CURBS, CENTER LINE OF STREETS OR COVER LINE OF ALLEYS ARE SHOWN BY CIRCLES ON PROFILES. AT ALL POINTS BETWEEN DESIGNATED POINTS THE GRADE SHALL BE ESTABLISHED SO AS TO CONFORM TO A STRAIGHT LINE DRAWN BETWEEN SAID DESIGNATED POINTS.  
 ELEVATIONS ARE IN FEET ABOVE U.S.C. & G.S. SEA LEVEL DATUM OF 1929.  
 THIS DRAWING AND THE DATA HEREON ARE HEREBY MADE A PART OF THE SPECIFICATIONS.  
 WORK SHALL BE CONSTRUCTED ACCORDING TO SPECIFICATIONS ON FILE IN THE OFFICE OF THE COUNTY ENGINEER AND SHALL BE PROSECUTED ONLY IN THE PRESENCE OF THE COUNTY ENGINEER.  
 BEFORE WORK CAN BE STARTED THE CONTRACTOR MUST OBTAIN A PERMIT TO EXCAVATE IN COUNTY STREETS FROM THE L.A. COUNTY ROAD DEPT., DISTRICT OFFICE NO. 3 AND PAY A FEE TO THE COUNTY ENGINEER ROOM 224 SAN AMERICAN BUILDING, 222 SO. BROADWAY SUFFICIENT TO COVER THE COST OF CONSTRUCTION INSPECTION AND RECORD PLANS.  
 APPROVAL OF THIS PLAN BY THE COUNTY OF LOS ANGELES DOES NOT CONSTITUTE A REPRESENTATION AS TO THE ACCURACY OF THE LOCATION OF OR THE EXISTENCE OR NON-EXISTENCE OF ANY UNDERGROUND UTILITY PIPE, OR STRUCTURE WITHIN THE LIMITS OF THIS PROJECT. THIS NOTE APPLIES TO ALL PAGES.  
 IF WORK IS TO BE DONE IN A STATE HIGHWAY, A PERMIT MUST BE OBTAINED FROM THE STATE OF CALIFORNIA, DIVISION OF HIGHWAYS, 126 SOUTH SPRING STREET.

COUNTY OF LOS ANGELES, CALIFORNIA  
 APPROVED, JOHN A. LAMBIE, COUNTY ENGINEER APPROVED, C.E. COMPTON, CHIEF ENGINEER  
 D.O. SAN. DIST. NO. 2  
 BY: *C.E. Compton* ASST. SANITATION ENGINEER BY: *J. Compton* OFFICE ENGINEER  
 CHECKED BY: *B. J. Marking* 5-9-60  
 OFFICE OF COUNTY ENGINEER, REG. C. E. NO. 11636  
 Submitted By: *Jack C. Lansing*  
 P.O. Box 7000, Compton Valley Regional Engineer

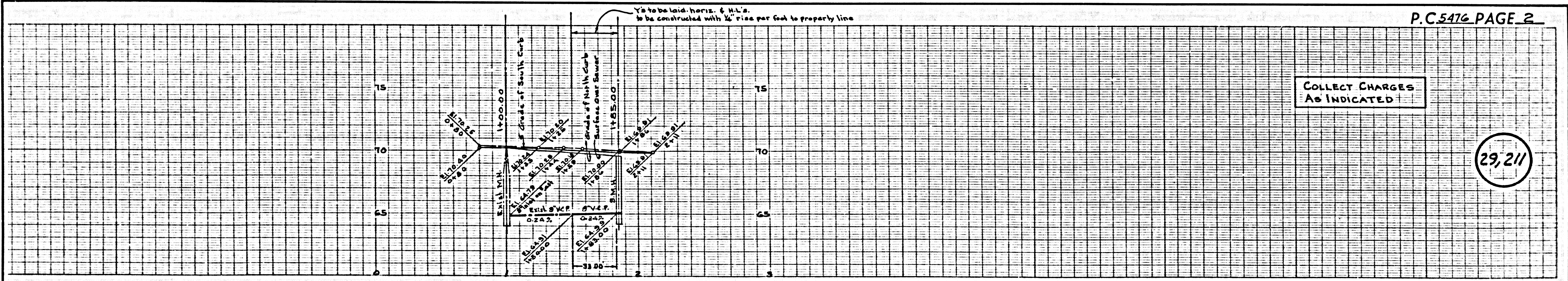

COLLECT CHARGES  
 AS INDICATED

29,211

P.C. 547G PAGE 2

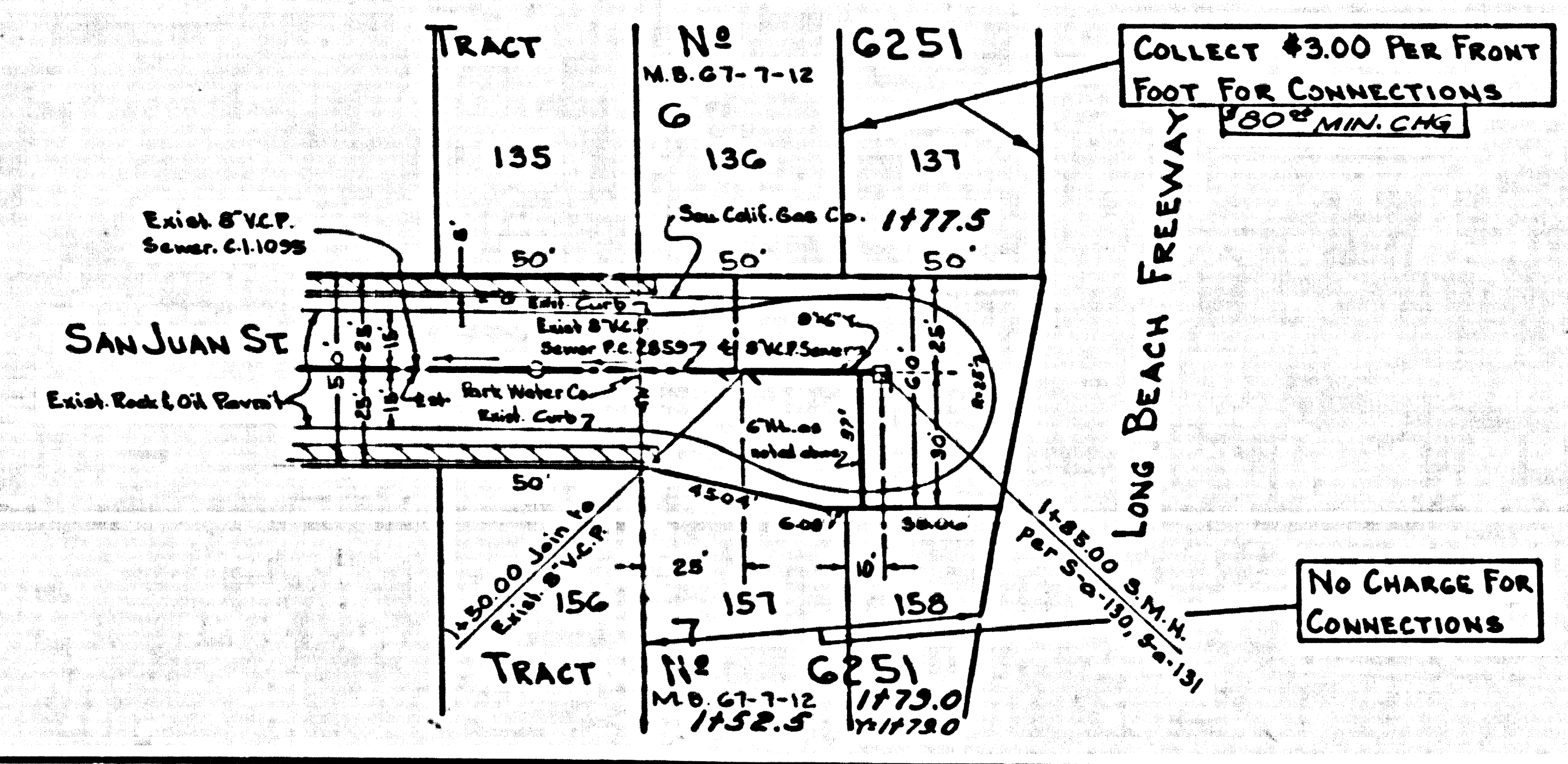

COLLECT \$3.00 PER FRONT  
 FOOT FOR CONNECTIONS  
 180" MIN. C.M.S.

No Charge For  
 CONNECTIONS