

DOUBLE SCALE  
WEST HOLLYWOOD BLDG. DIST. NO. 9

PROFILE ALIGNMENT AND GRADE OF P.C. 5480  
SANITARY SEWERS PAGE 1  
TO BE CONSTRUCTED IN J.N. 0353.19

SWEETZER AVENUE  
PRIVATE CONTRACT NO. 5480

W.S. 22  
1 SHEETS; 2 PAGES  
SCALE: VERT. 1"=4'-0" HORIZ. 1"=40'-0" FEBRUARY 1961

PREPARED IN THE OFFICES OF  
SULLIVAN, PSOMAS AND YOUNG

By: *C.F. Sullivan*  
REG. C. E. NO. 1518

30813

FOR LEGEND SEE PLAN NO. S-A-64

NOTES:  
GRADES TO WHICH THIS IMPROVEMENT IS TO BE CONSTRUCTED ARE SHOWN ON PLANS AND PROFILE. GRADE POINTS FOR TOP OF CURBS, CENTER LINE OF STREETS, OR CENTER LINE OF ALLEYS ARE SHOWN BY CIRCLES ON PROFILE AT ALL POINTS BETWEEN DESIGNATED POINTS THE GRADE SHALL BE ESTABLISHED SO AS TO CONFORM TO A STRAIGHT LINE DRAWN BETWEEN SAID DESIGNATED POINTS.  
ELEVATIONS ARE IN FEET ABOVE U.S.C. DATUM OR MEAN SEA LEVEL.  
THE DRAWING AND THE DATA HEREON ARE HEREBY MADE A PART OF THE SPECIFICATIONS.  
WORK SHALL BE CONSTRUCTED ACCORDING TO SPECIFICATIONS ON FILE IN THE OFFICE OF THE COUNTY ENGINEER AND SHALL BE PROSECUTED ONLY IN THE PRESENCE OF THE COUNTY ENGINEER.  
BEFORE WORK CAN BE STARTED, THE CONTRACTOR MUST OBTAIN A PERMIT TO EXCAVATE IN COUNTY STREETS FROM THE L. & COUNTY ROAD DEPT., BUREAU OF HIGHWAYS, AND MAKE A DEPOSIT WITH THE COUNTY ENGINEER, ROOM 311, 118 WEST 4TH ST., SUFFICIENT TO COVER THE COST OF CONSTRUCTION INSPECTION AND RECORD PLANS.  
APPROVAL OF THIS PLAN BY THE COUNTY OF LOS ANGELES DOES NOT CONSTITUTE A REPRESENTATION AS TO THE ACCURACY OF THE LOCATION OR OF THE EXISTENCE OR NON-EXISTENCE OF ANY UNDERGROUND UTILITY PIPE, OR STRUCTURE WITHIN THE LIMITS OF THE PROJECT. THIS NOTE APPLIES TO ALL PLANS.  
IF WORK IS TO BE DONE IN A STATE HIGHWAY, A PERMIT MUST BE OBTAINED FROM THE STATE OF CALIFORNIA, DIVISION OF HIGHWAYS, 138 SOUTH SPRING STREET.

COUNTY OF LOS ANGELES, CALIFORNIA

APPROVED, JOHN A. LAMBE, COUNTY ENGINEER APPROVED, A. M. BAWN, CHIEF ENGINEER

By: *C.E. Spang* ASST. SANITATION ENGINEER By: *C.F. Sullivan* CHIEF ENGINEER  
CHECKED BY: *W. G. Under* OFFICE ENGINEER

OFFICE OF COUNTY ENGINEER, BLDG. C. E. NO. 2426

NO CONNECTIONS FOR THE DISPOSAL OF INDUSTRIAL WASTES SHALL BE MADE TO SEWERS SHOWN ON THESE DRAWINGS WITHOUT WRITTEN PERMISSION FROM THE CHIEF ENGINEER AND GENERAL MANAGER OF THE COUNTY SANITATION DISTRICTS.

- NOTES:  
PROVIDE STAKES ON THE PROPERTY LINE OR PROPERTY LINES PRODUCED AT RIGHT ANGLES TO THE E.W. LINE AT THE CENTER LINE OF EACH MANHOLE.  
NO REPRESENTATIVE OF THE COUNTY ENGINEER WILL SURVEY OR LAYOUT ANY PORTION OF THE WORK.  
THE OWNER OR HIS AUTHORIZED REPRESENTATIVE SHALL FURNISH THE COUNTY ENGINEER WITH GRADE SHEETS AND STATIONING FOR ALL HOUSE LATERALS AND Y BRANCHES AND SHALL PROVIDE STAKES FOR THEM AT THEIR PROPER LOCATIONS WITH STATIONING AND PLAINLY MARKED. ANY CHANGE IN LOCATION SHALL BE REQUESTED IN WRITING BY THE OWNER OR HIS REPRESENTATIVE.  
NO REVISIONS SHALL BE MADE IN THESE PLANS WITHOUT THE APPROVAL OF THE COUNTY ENGINEER.
1. USE STANDARD MANHOLE FRAMES AND COVERS, S-A-117, EXCEPT AS NOTED.
  2. USE STANDARD STRENGTH PIPE EXCEPT AS NOTED.
  3. USE SPEED SEAL OR WEDGE LOCK TYPE JOINTS PER SECTIONS 34 AND 46 OF SPECIFICATIONS.
  4. RESURFACE ALL TRENCH WITHIN PAVED AREA TO MEET L. & COUNTY ROAD DEPT. OR CALIF. STATE HIGHWAY DEPT. REQUIREMENTS IN ACCORDANCE WITH PERMITS.
  5. ENCASE FOUR FEET OF SEWER AT POINTS OF INTERFERENCE WITH POLES, S-A-119.
  6. ALL STRUCTURES SHALL BE BRICK SAWER STRUCTURES, S-A-104, EXCEPT AS NOTED.
  7. FOR ALLOWABLE LEAKAGE TEST USE FORMULA NO. 7 SPEC'S, SEC. 31.
  8. SPECIFICATIONS DATED OCTOBER 10, 1950 APPLY IN THE CONSTRUCTION OF THIS PROJECT.
  9. MAKE NO CONNECTIONS TO THIS CONSTRUCTION.

B.M. M.W. 27 Elev. 2606.72 per FB. 2197 Page 14  
Santa Monica Blvd. & Sweetzer Ave., N.W. Cor. Bolt Spike in curb 17 feet West of West end curb return.

NO CHARGES FOR CONNECTIONS  
*Lawrence J. Jones*

ISSUE NO PERMITS UNTIL P.C. NO. 5728 IS CONSTRUCTED

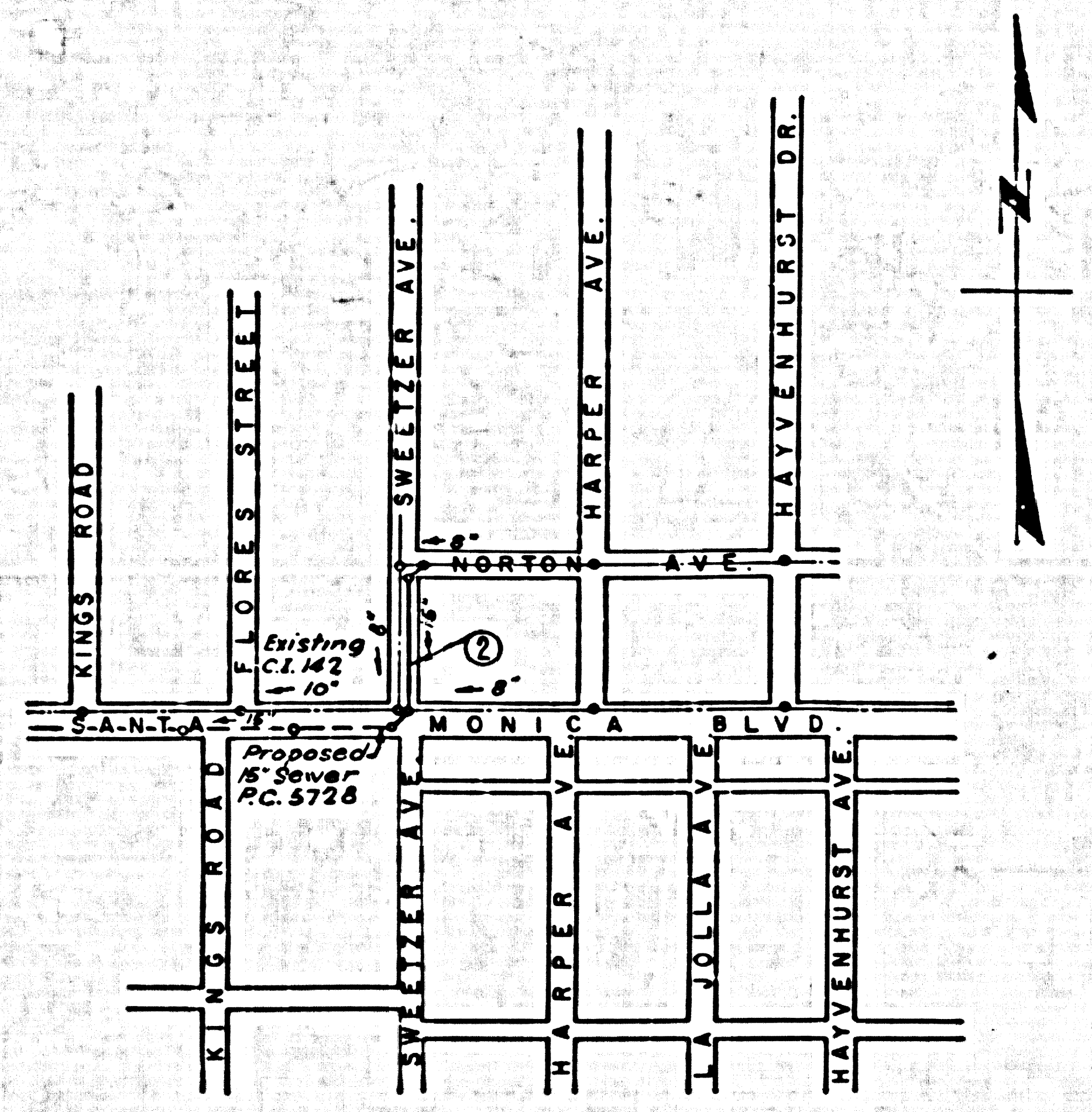

INDEX MAP  
P.C. 5480 SWEETZER AVENUE  
SCALE: 1"=300'

REVISION  
Relocated M.L. Sewer from 7th E. of E. of Sweetzer Ave. to 5.5 ft E of E.  
CHECKED BY: *C.F. Sullivan* 3-22-61  
OFFICE OF COUNTY ENGINEER REG. C. E. NO. 11636

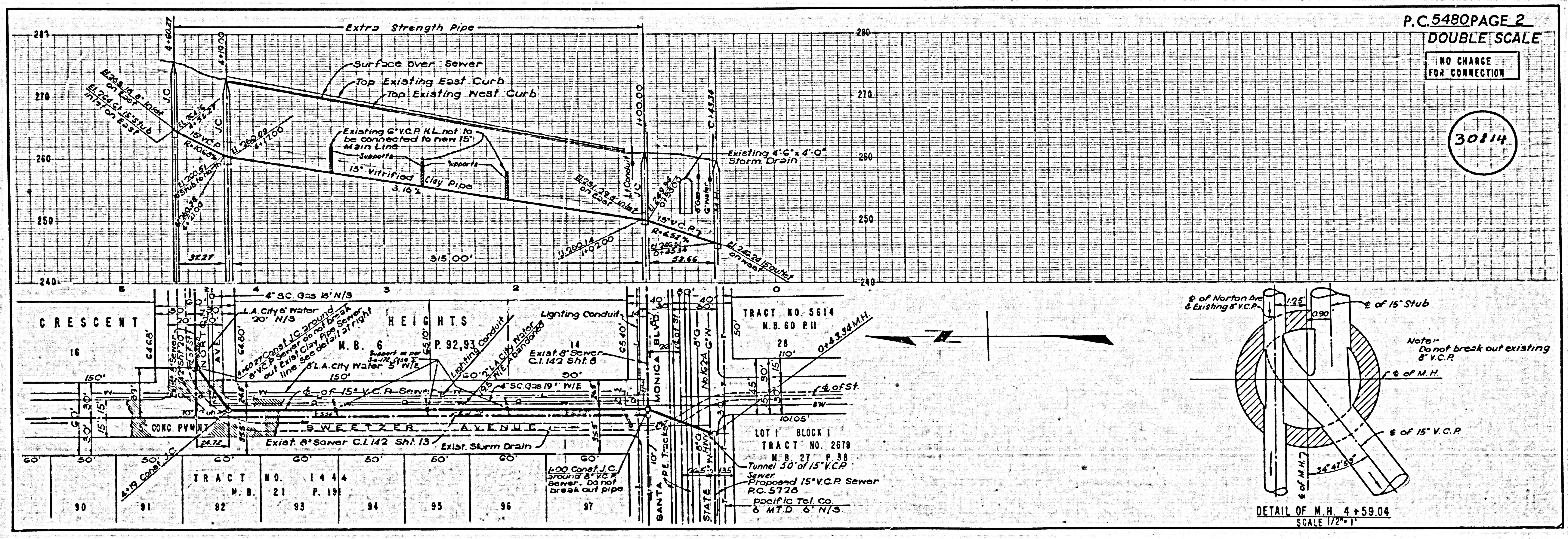

P.C. 5480 PAGE 2  
DOUBLE SCALE

NO CHARGE FOR CONNECTION

30814

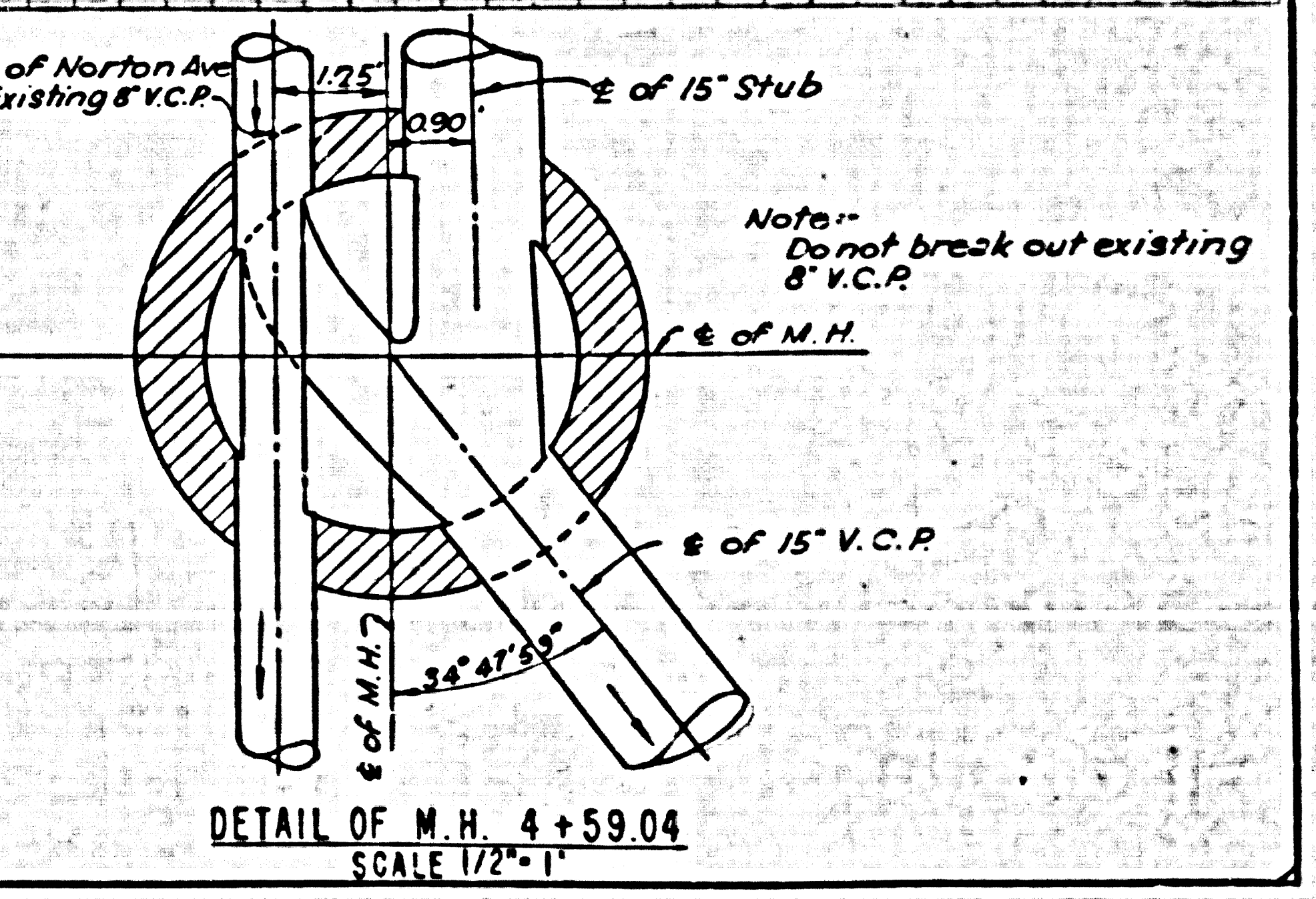

DETAIL OF M.H. 4+59.04  
SCALE 1/2"=1'