

LOMITA BUILDING DISTRICT No. 7.I

- NOTE:**
- Provide stakes on the property lines or property lines produced at right angles to the sewer line at the center line of each manhole.
 - No representative of the County Engineer will survey or layout any portion of the work.
 - The owner or his authorized representative shall furnish the County Engineer with grade sheets and stations for all house laterals and Y branches and shall provide stakes for them at their proper locations with stationing plainly marked. Any change in location shall be requested in writing by the owner or his representative.
 - No revisions shall be made in these plans without the approval of the County Engineer.
- Use standard manhole frames and covers, S-a-117.
 - Use standard strength pipe except as noted.
 - Use cement mortar or "Wedge-lock" or "Speed-seal" for all V.C.P. joints per specs, Sec. 5G & 4B.
 - Resurface all trench within paved area to meet L.A. County Road Dept. or California State Highway Dept. requirements in accordance with permit.
 - Encase four feet of sewer at points of interference with poles, S-a-119.
 - House laterals to be constructed with inverts at property line 6 feet below curb grade except as noted.
 - All structures shall be brick sewer structures, S-a-104.
 - For allowable leakage test, use Formula No. 1, Spec's, Sec. 51.
 - Manhole tops in unimproved Rights-Of-Way to be 4" above finish grade.
 - The Contractor shall notify the Construction & Storm Drain Division by telephone Madison 5-4747, Ext. 362, at least 24 hours before starting any work under this contract.
 - Standard specifications dated Jan. 1, 1960 apply in the construction of this project.
 - The Private Engineer shall furnish the house lateral depth at the property line below the top of curb elevation for each house lateral on the grade sheet.

PC 5499
PAGE 1
J.N. 0353.34

TRACT No. 25567

PRIVATE CONTRACT NO. 5499
W. S. 28
1 SHEET; 2 PAGES
Scale: VERT. 1"=4'
HORIZ. 1"=40'
APRIL 1960
PREPARED IN THE OFFICES OF
GILBERT ENGINEERING CO.
FOR LEGEND SEE PLAN NO. S-a-64

29,214

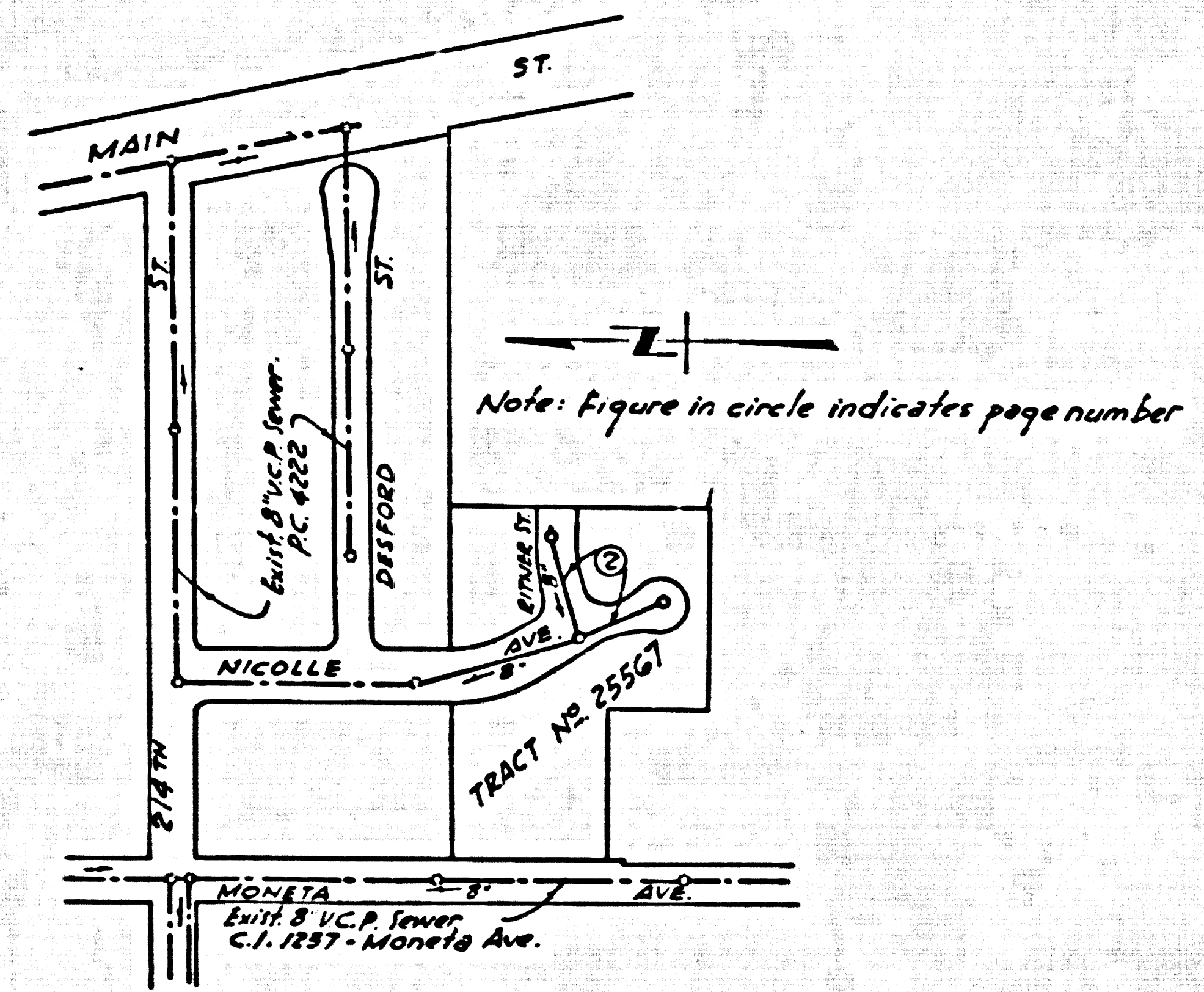

INDEX MAP
TRACT No. 25567 P.C. 5499
SCALE: 1"=200'

B.M. 5Y 3378 Elev. 33.446
Spk. in lead 9' E. of curb return N.E. Corner 26th & Main St.

NO CHARGE FOR CONNECTIONS
Cuthbert B. Reedy

NOTE:

Grades to which this improvement is to be constructed are shown on plans and profiles. Grade points for top of curbs, center line of streets, or center line of alleys are shown by circles on profiles. At all points between designated points the grade shall be established so as to conform to a straight line drawn between said designated points.

Elevations are in feet above U.S.C. & G.S. sea level datum of 1929.

This drawing and the data hereon are hereby made a part of the specifications.

Work shall be constructed according to specifications on file in the office of the County Engineer and shall be prosecuted only in the presence of the County Engineer.

Before work can be started, the contractor must obtain a permit to excavate in County streets from the L.A. County Road Dept., District Office No. 3, and pay a fee to the County Engineer, Room 524, San America Building, 253 S. Broadway, sufficient to cover the cost of construction inspection and record plans.

Approval of this plan by the County of Los Angeles does not constitute a representation as to the accuracy of the location of or the existence or non-existence of any underground utility, pipe, or structure within the limits of this project. This note applies to all sheets.

If work is to be done in a State Highway, a permit must be obtained from the State of California, Division of Highways, 120 South Spring Street.

COUNTY OF LOS ANGELES, CALIFORNIA

Approved, John A. Lambie, County Engineer
Approved, C.R. Compton, CHIEF ENGR. CO-OP. DIST. NO. 8

Checked by *S.K. Onda* 5-10-60
Submitted by *Jack C. Lenzing*
Office of County Engineer, Reg. C. E. No. 5406.
Palop Verdes-Cerritos Valley Regional Engineer

